

**View 1
Not To
Scale**

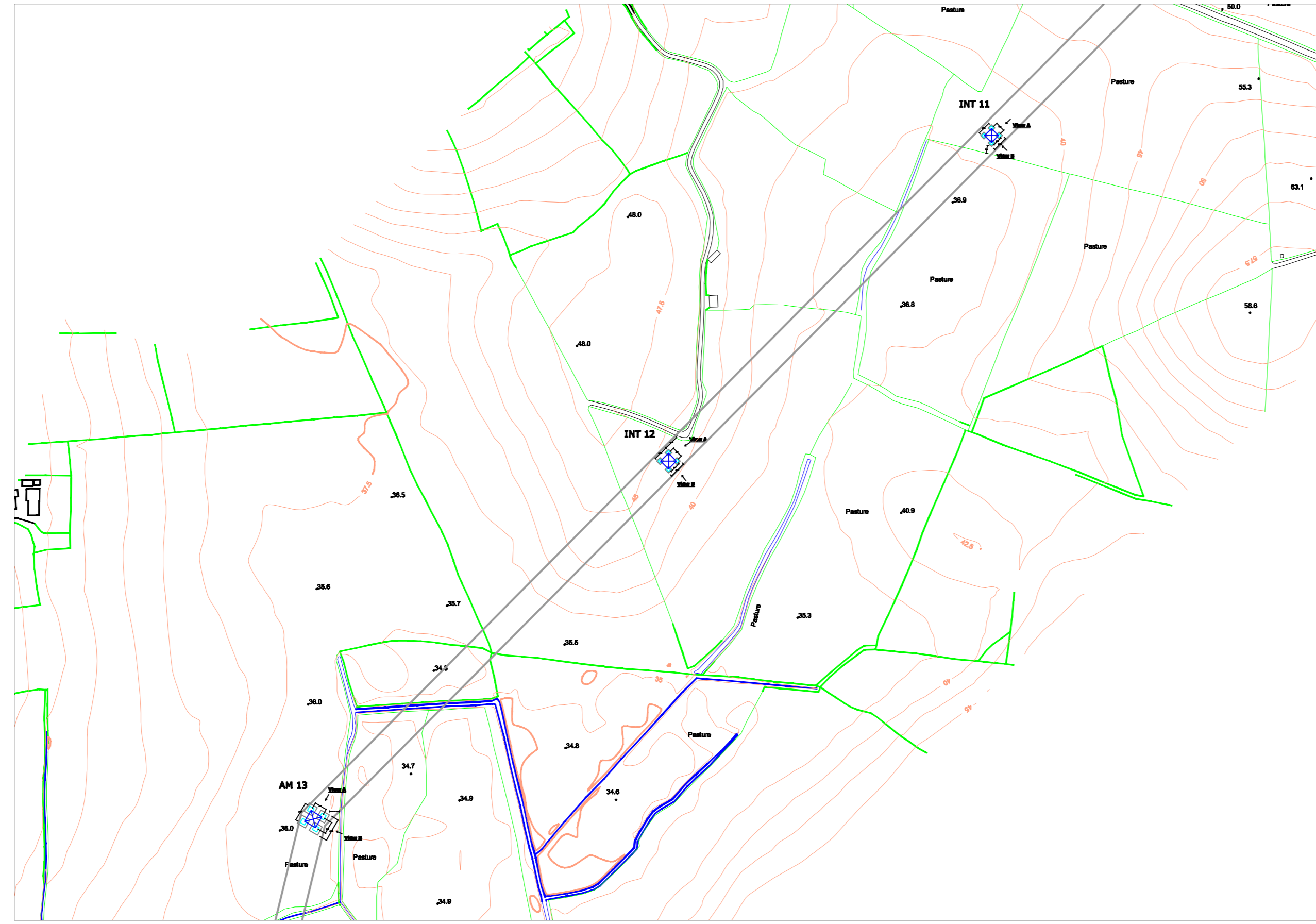

View 2: 1/100

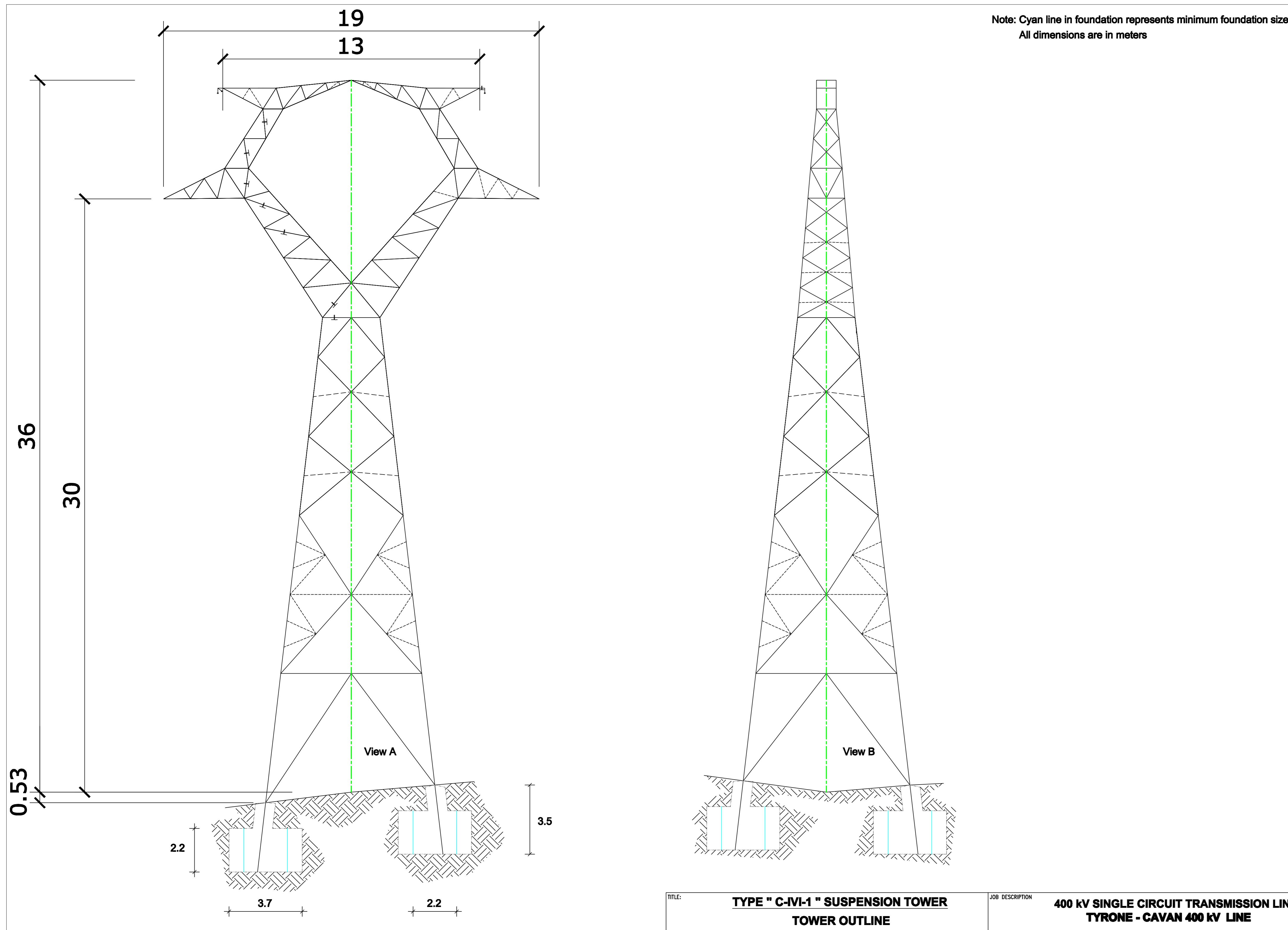

View 3: Not To Scale



View 4: Not To Scale

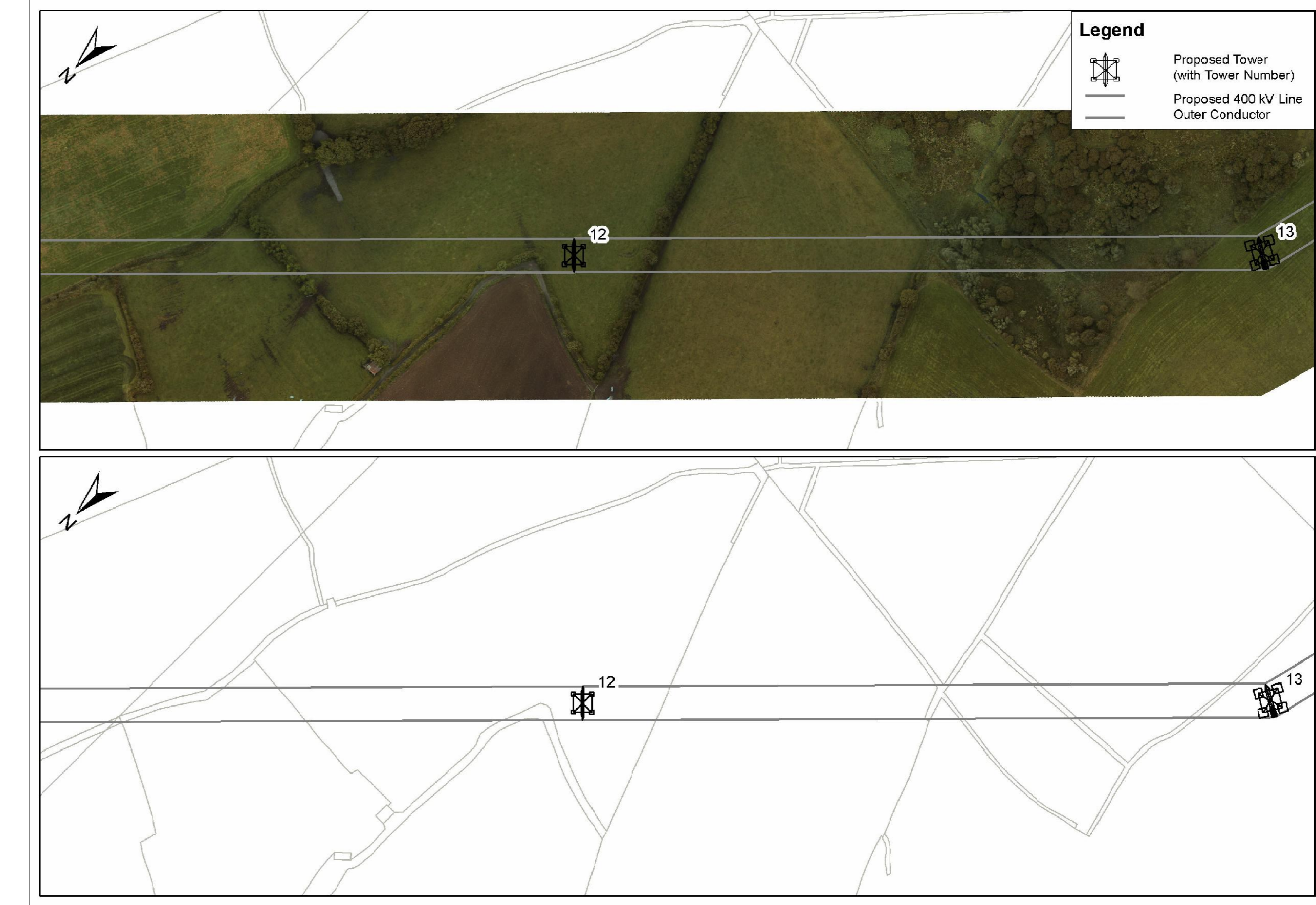

View 5: 1/500

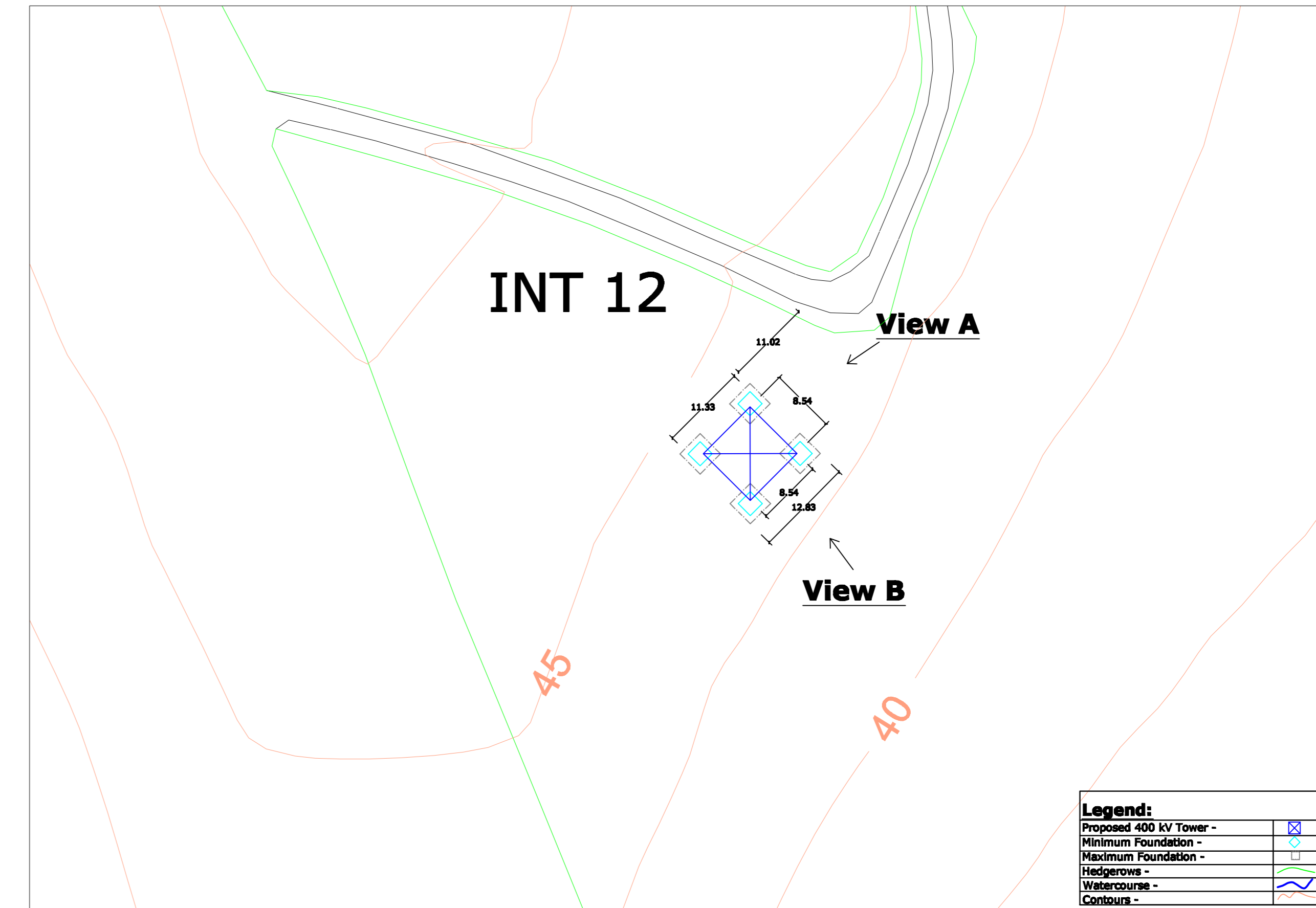

- View 1 - Site Location Map
- View 2 - Tower Drawing
- View 3 - Associated Works Drawing
- View 4 - Overhead Line Route Map
- View 5 - Tower & Foundation Layout

Note:
All foundations and towers are square in plan.

0	00.00.00	ISSUED FOR		AB	AB	AB	AB	AB	AB
REV.	DATE	REVISION DESCRIPTION		DRN	PRD	VER	APP		
PURPOSE OF ISSUE - PRELIMINARY UNLESS INDICATED									
TENDER	<input type="checkbox"/>	CLIENT	<input type="checkbox"/>	APPROVAL	<input type="checkbox"/>	CONSTRUCTION	<input type="checkbox"/>	AS-BUILT	<input type="checkbox"/>
Client	N.I.E.								
Project	Tyrone - Cavan 400 kV Interconnector								
Contract									
Drawing Title	Proposed 400 kV Line Structure Location No 12 Composite Drawing								
Production Unit	High Voltage								
<small>ES&I Engineering Solutions, Stephen Court, 18-21 St. Stephen's Green, Dublin 2, Ireland. Tel: +353 (0)1 708 8000 Fax: +353 (0)1 708 7188 Email: marketing@es&i.ie Web: www.es&i.ie ES&I Engineering Solutions is a trading name of ES&I Engineering & Facility Management Limited. Registered Office in Dublin. Registered in Ireland No. 103946.</small>									
OWNER	JW	PROCESSOR	JW	DESIGNED	CM	APPROVED	JD	DATE	April 2013
CLIENT REF		SCALE	1:100	REV	102	AD	AS SHOWN		
DRAWING NUMBER	PE687-D141-093-012-000								

COPYRIGHT © ES&I ENGINEERING & FACILITY MANAGEMENT LIMITED.
All rights reserved. No part of this work may be reproduced or stored in any form or by any means - graphic, electronic or mechanical, including photocopying, recording, taping or information-retrieval systems, or used for any purpose other than the original purpose, without the written permission of ES&I Engineering & Facility Management Ltd.