

View 1
Not To
Scale

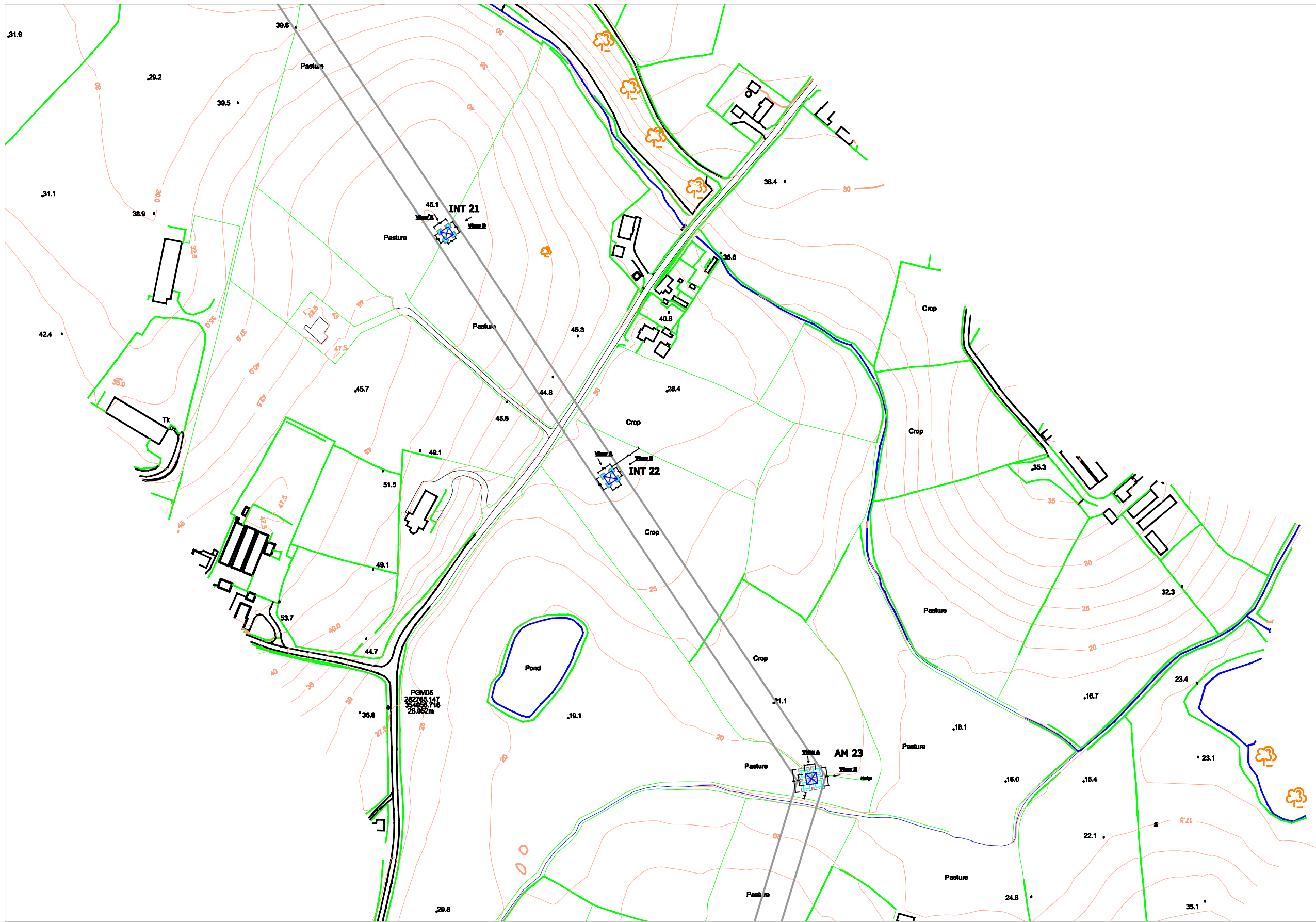

View 2: 1/100

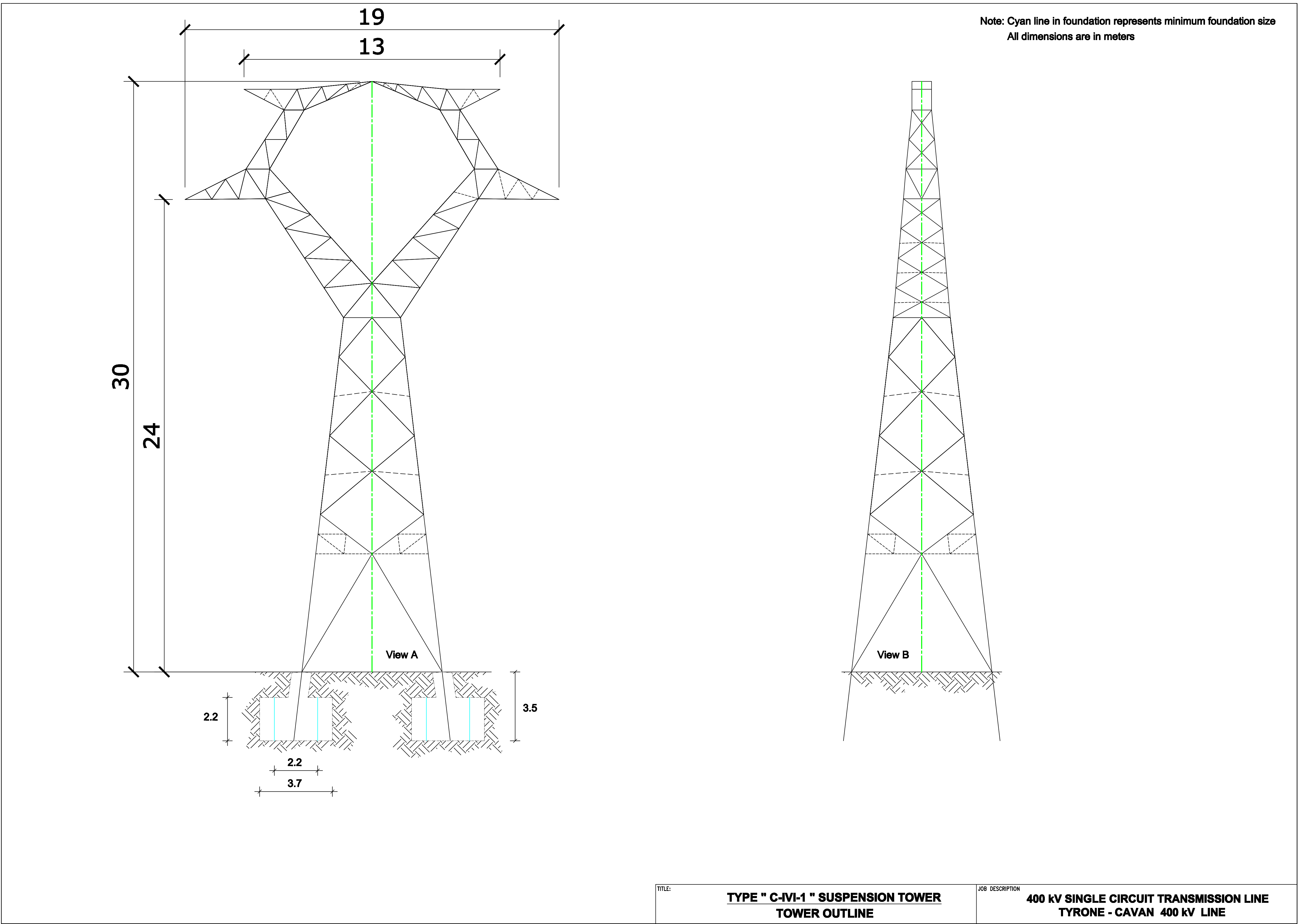

View 3: Not To Scale



View 4: Not To Scale

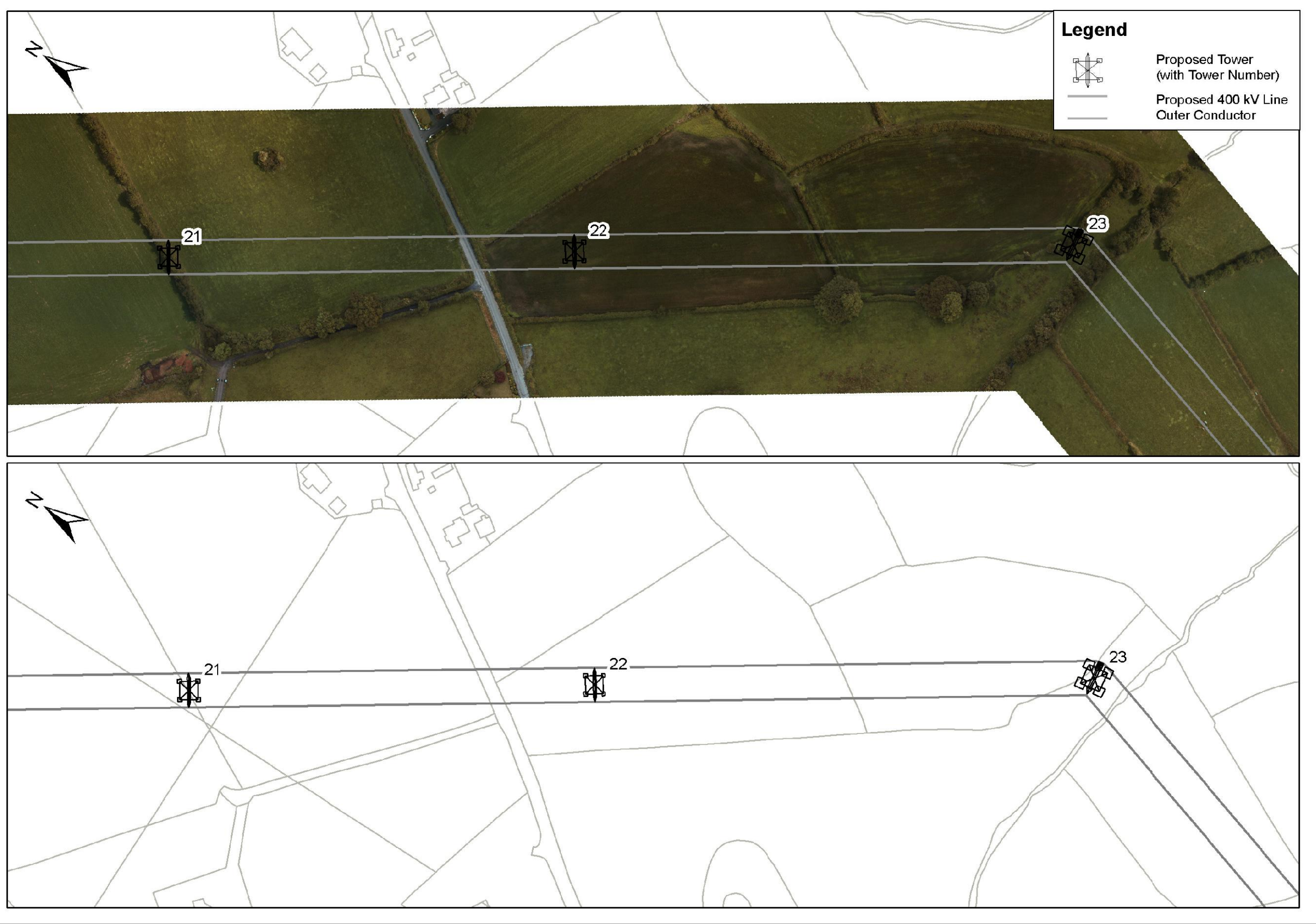

View 5: 1/500

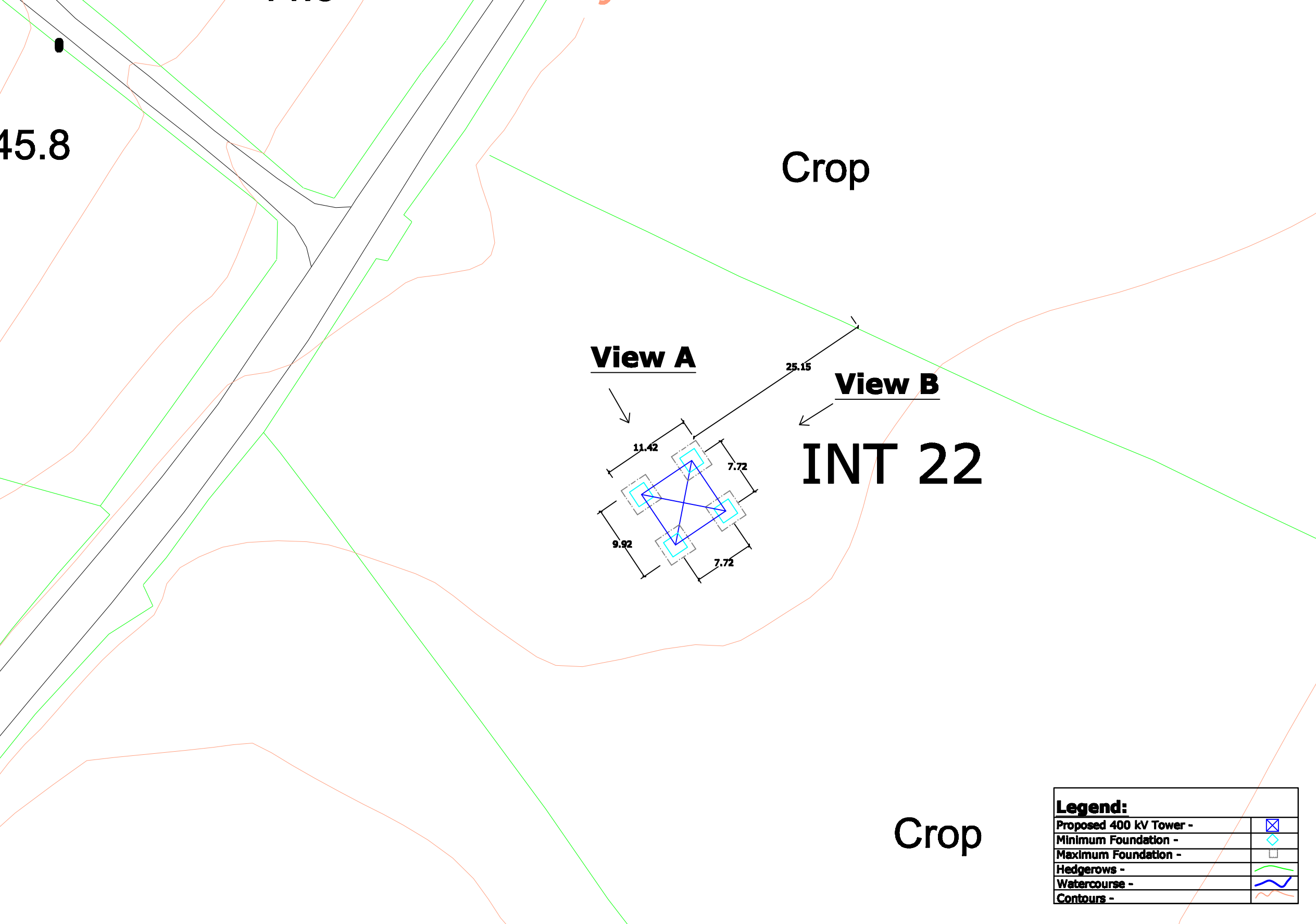

View 1 - Site Location Map
View 2 - Tower Drawing
View 3 - Associated Works Drawing
View 4 - Overhead Line Route Map
View 5 - Tower & Foundation Layout

Note:
All foundations and towers are square in plan.

0	00.00.00	ISSUED FOR	AS	AS	AS	AS			
REV.	DATE	REVISION DESCRIPTION	OWN	PROJ	VER	APP			
PURPOSE OF ISSUE - PRELIMINARY UNLESS INDICATED									
TENDER	<input type="checkbox"/>	CLIENT APPROVAL	<input type="checkbox"/>	CONSTRUCTION	<input type="checkbox"/>	AS-BUILT	<input type="checkbox"/>	REVISED	<input type="checkbox"/>
Client							N.I.E.		
Project							Tyrone - Cavan 400 kV Interconnector		
Contract									
Drawing Title							Proposed 400 kV Line Structure Location No 22 Composite Drawing		
Production Unit							High Voltage		
ES&I International							ES&I Energy Innovation		
ES&I Engineering Solutions, Stephen Court, 16-21 St. Stephens Green, Dublin 2, Ireland. Tel: +353 (0)1 708 8000 Fax: +353 (0)1 708 7188 Email: marketing@es&i.ie Web: www.es&i.ie ES&I Engineering Solutions is a trading name of ES&I Engineering & Facility Management Limited. Registered Office as above Registered in Ireland No. 112254									
OWNER	JW	PROCESSED	JW	ISSUED	CM	APPROVED	JD	DATE	April 2013
CLIENT REP	102	102	AD	AD	AD	AD	AD	AS SHOWN	
DRAWING NUMBER							PE687-D141-093-022-000		