

View 1
Not To
Scale

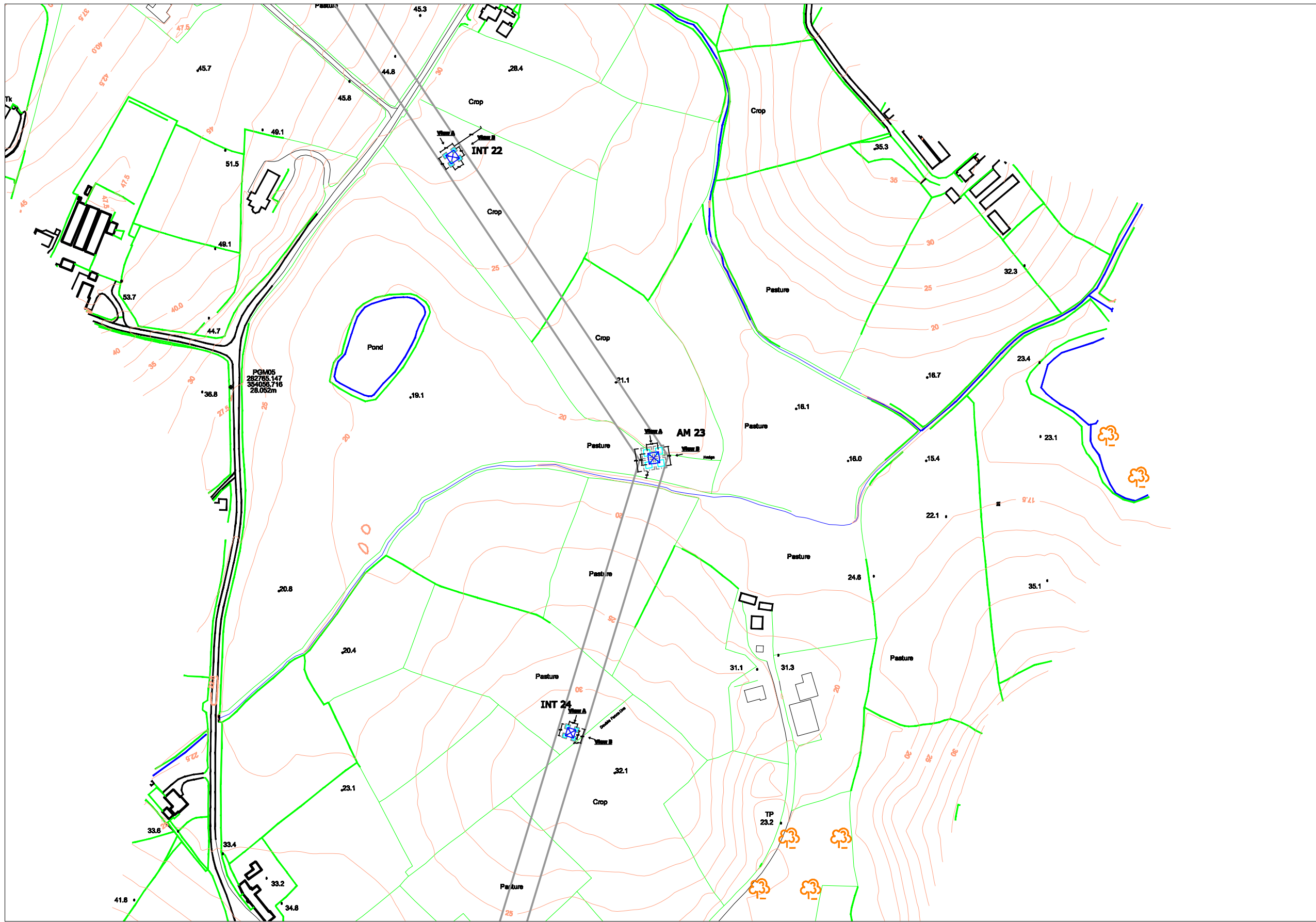

View 2: 1/100

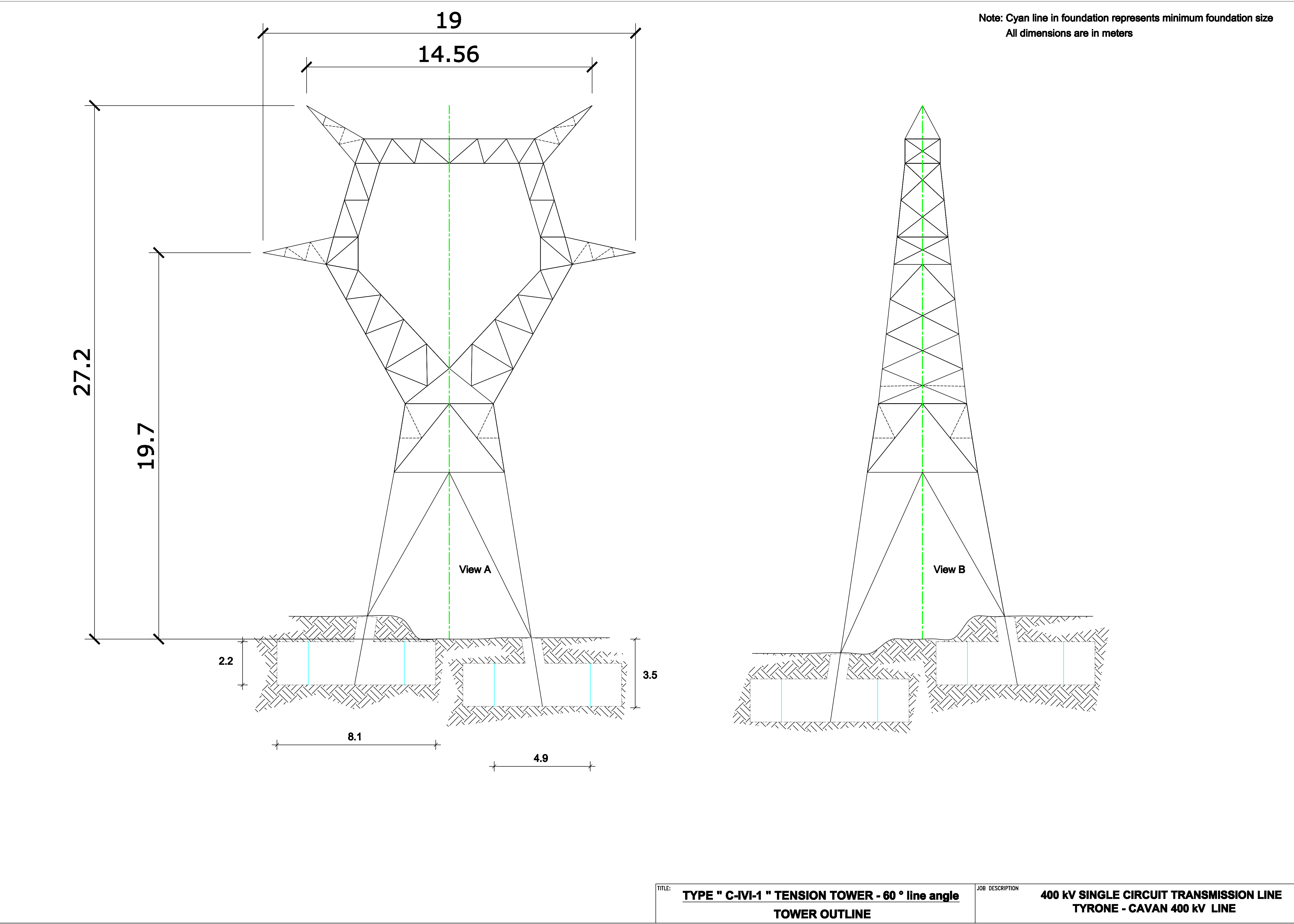

View 3: Not To Scale



View 4: Not To Scale

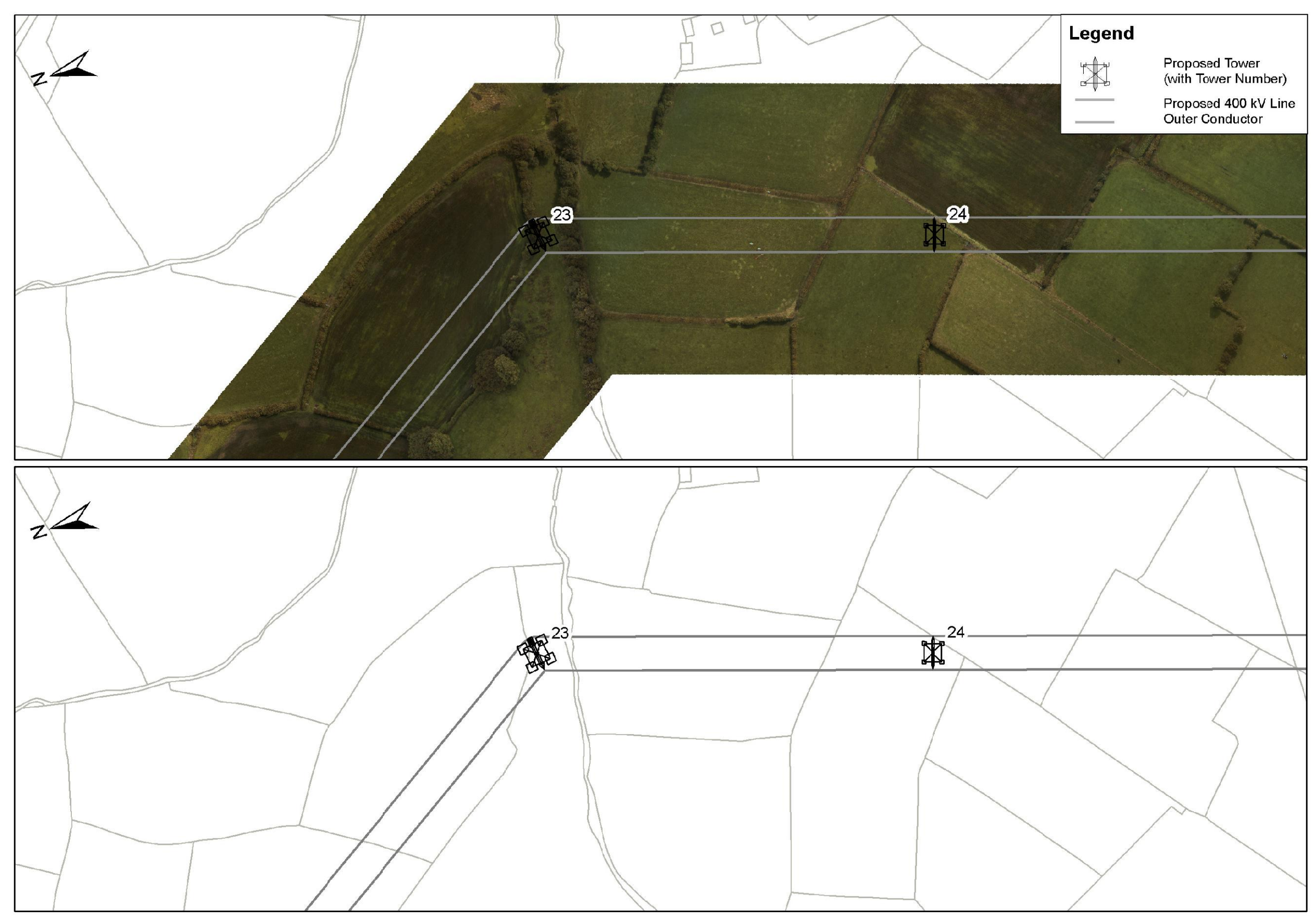

View 5: 1/500

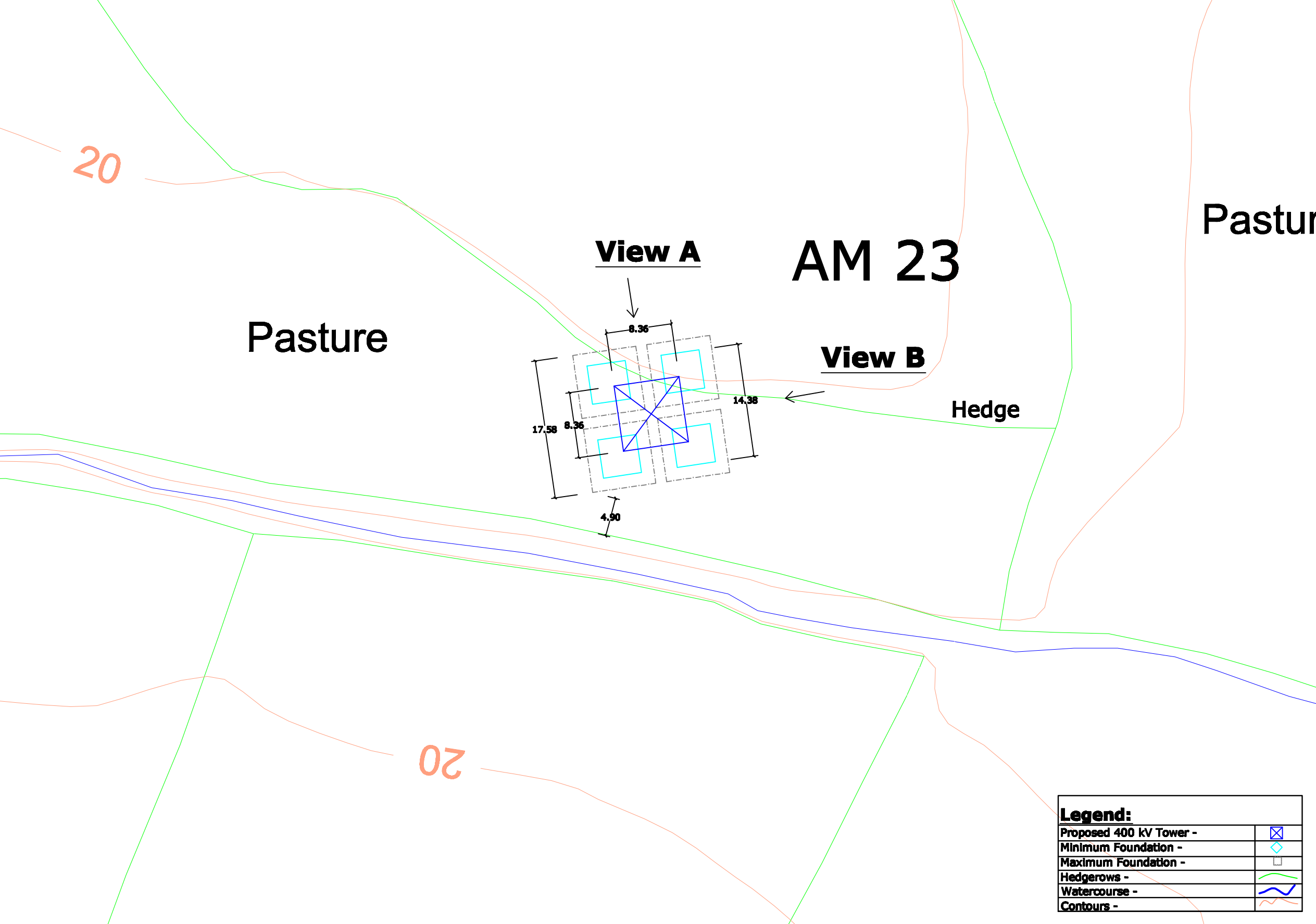

View 1 - Site Location Map
View 2 - Tower Drawing
View 3 - Associated Works Drawing
View 4 - Overhead Line Route Map
View 5 - Tower & Foundation Layout

Note:
All foundations and towers are square in plan.

0	00.00.00	ISSUED FOR	AS	AS	AS	AS			
REV.	DATE	REVISION DESCRIPTION	DRN	PROJ	VER	APP			
PURPOSE OF ISSUE - PRELIMINARY UNLESS INDICATED									
TENDER	<input type="checkbox"/>	CUSTOMER APPROVAL	<input type="checkbox"/>	CONSTRUCTION	<input type="checkbox"/>	AS-BUILT	<input type="checkbox"/>	REVISED	<input type="checkbox"/>
Client	N.I.E.								
Project	Tyrone - Cavan 400 kV Interconnector								
Contract									
Drawing Title	Proposed 400 kV Line Structure Location No 23 Composite Drawing								
Production Unit	High Voltage								
ES&I Engineering Solutions, Stephen Court, 16-21 St. Stephens Green, Dublin 2, Ireland. Tel: +353 (0)1 700 8000 Fax: +353 (0)1 700 7198 Email: marketing@es-i.ie Web: www.es-i.ie ES&I Engineering Solutions is a trading name of ES&I Engineering & Facility Management Limited. Registered Office as above. Registered in Ireland No. 112554									
DRWN	JW	PROJ	JW	VER	CM	APP	JD	DATE	April 2013
QUANT	REP	102	AD	AS SHOWN					
DRAWING NUMBER							PE687-D141-093-023-000		