

View 1  
Not To  
Scale

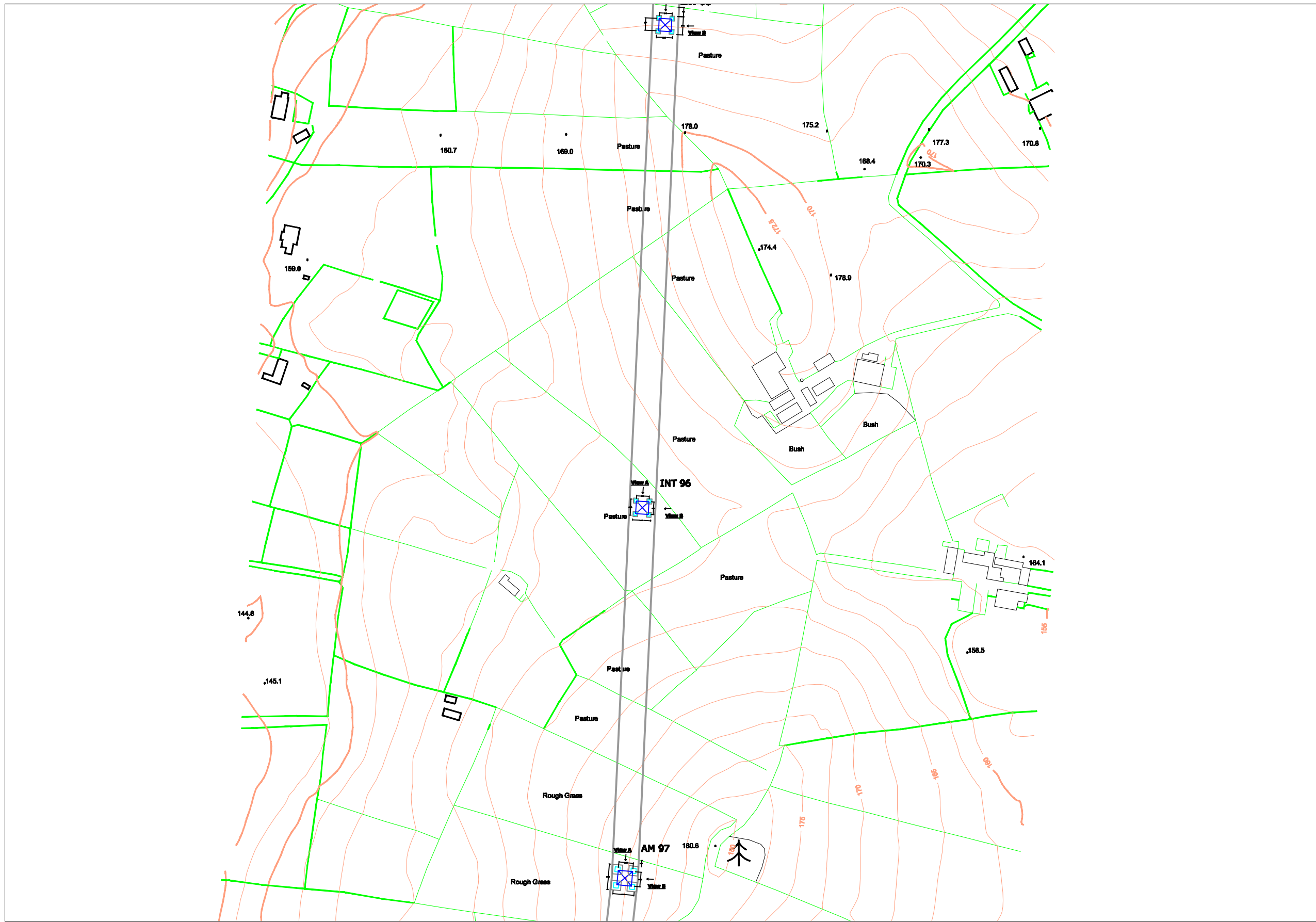

View 2: 1/100

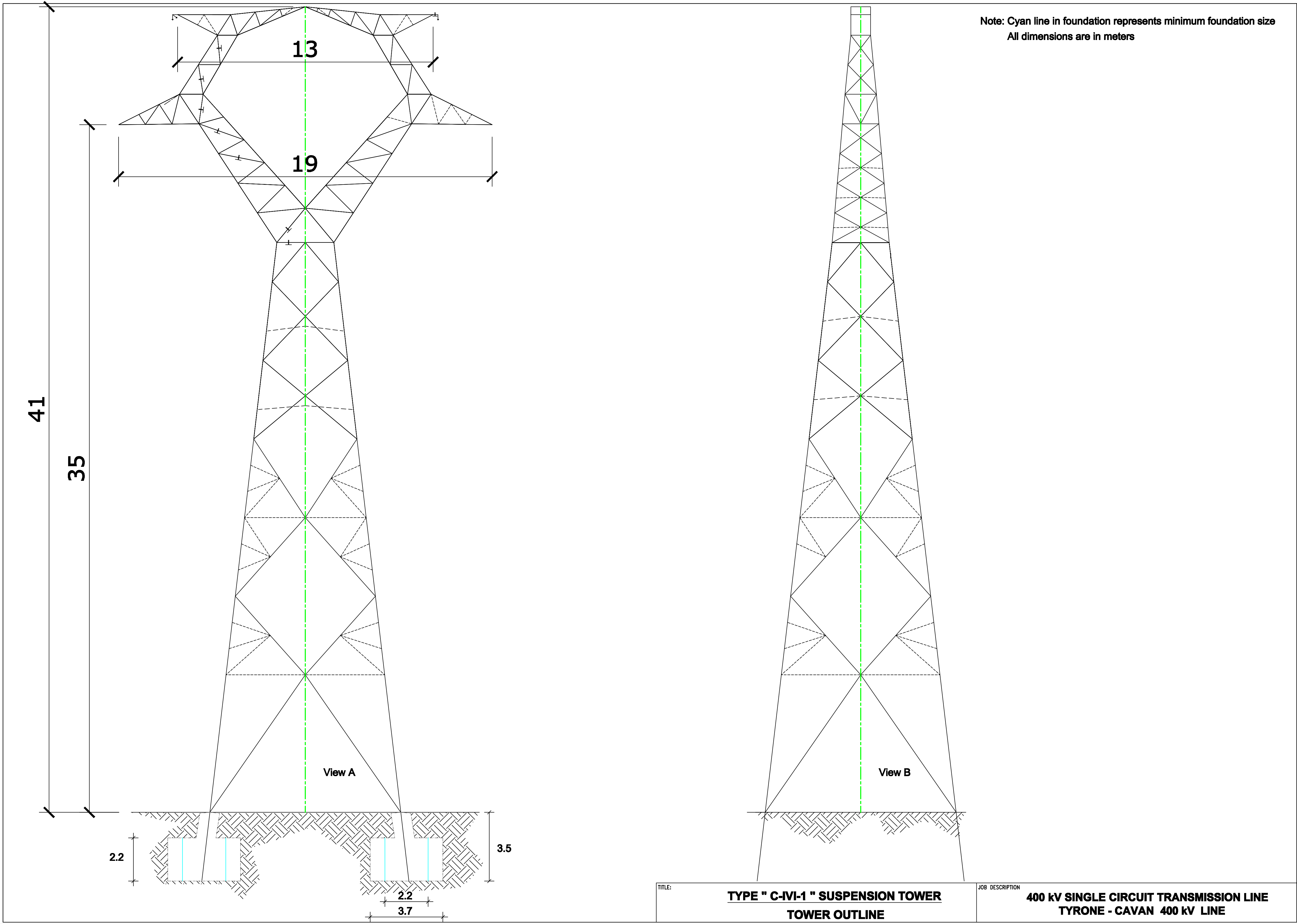

View 3: Not To Scale



View 4: Not To Scale

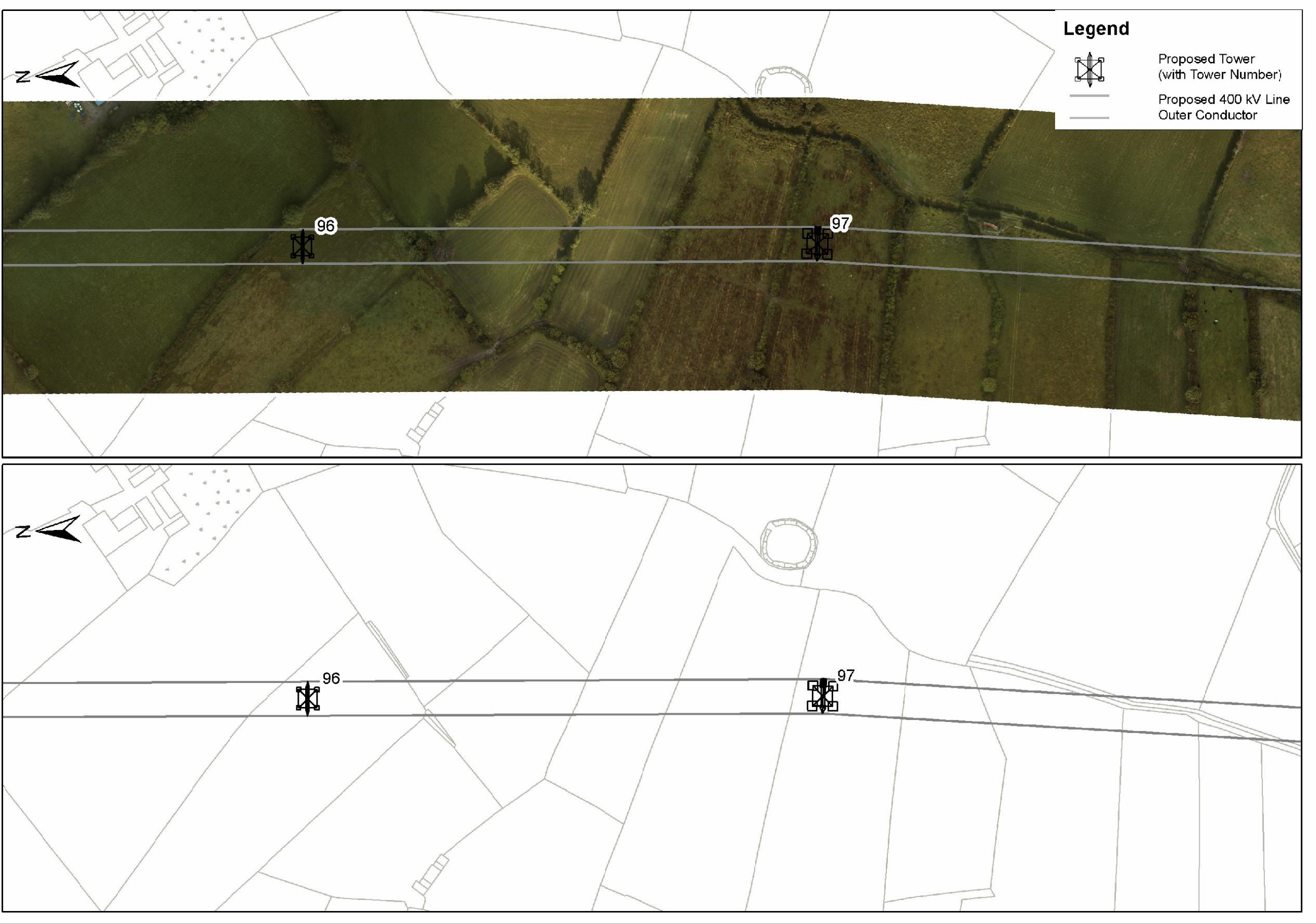

View 1 - Site Location Map  
View 2 - Tower Drawing  
View 3 - Associated Works Drawing  
View 4 - Overhead Line Route Map  
View 5 - Tower & Foundation Layout

View 5: 1/500

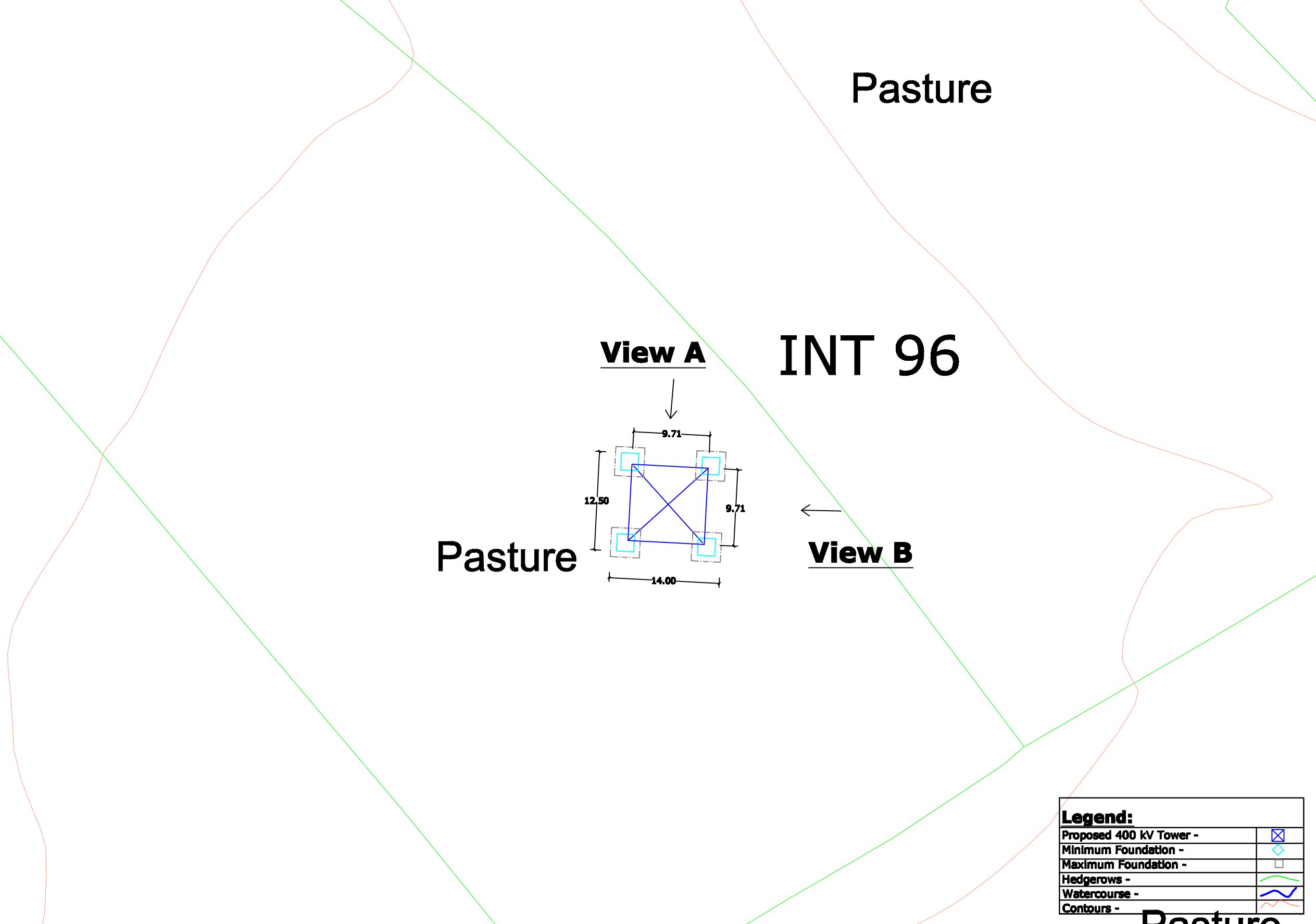

**Note:**  
All foundations and towers are square in plan.

|  |                          |                      |                          |              |                          |          |                          |         |                          |
|--|--------------------------|----------------------|--------------------------|--------------|--------------------------|----------|--------------------------|---------|--------------------------|
| 0  | 00.00.00                 | ISSUED FOR --        | AS                       | AS           | AS                       | AS       |                          |         |                          |
| REV.   | DATE                     | REVISION DESCRIPTION | DRN                      | PROJ         | VER                      | APP      |                          |         |                          |
| PURPOSE OF ISSUE - PRELIMINARY UNLESS INDICATED  |                          |                      |                          |              |                          |          |                          |         |                          |
| TENDER   | <input type="checkbox"/> | CUSTOMER APPROVAL    | <input type="checkbox"/> | CONSTRUCTION | <input type="checkbox"/> | AS-BUILT | <input type="checkbox"/> | REVISED | <input type="checkbox"/> |
| Client   |                          |                      |                          |              |                          |          |                          |         |                          |
| N.I.E.   |                          |                      |                          |              |                          |          |                          |         |                          |
| Project  |                          |                      |                          |              |                          |          |                          |         |                          |
| Tyrone - Cavan 400 kV Interconnector   |                          |                      |                          |              |                          |          |                          |         |                          |
| Contract   |                          |                      |                          |              |                          |          |                          |         |                          |
| Drawing Title  |                          |                      |                          |              |                          |          |                          |         |                          |
| Proposed 400 kV Line<br>Structure Location No 96<br>Composite Drawing  |                          |                      |                          |              |                          |          |                          |         |                          |
| Production Unit  |                          |                      |                          |              |                          |          |                          |         |                          |
| High Voltage   |                          |                      |                          |              |                          |          |                          |         |                          |
|  |                          |                      |                          |              |                          |          |                          |         |                          |
| ESB Engineering Solutions, Stephen Court, 16-21 St. Stephen's Green,<br>Dublin 2, Ireland. Tel: +353 (0)1 708 8000 Fax: +353 (0)1 708 7198<br>Email: marketing@esb.ie Web: www.esb.ie<br>ESB Engineering Solutions is a trading name of ESB Engineering & Facility Management Limited.<br>Registered Office as above. Registered in Ireland No. 122546 |                          |                      |                          |              |                          |          |                          |         |                          |
| DRN  | JN                       | PROJ                 | JN                       | VER          | CM                       | JD       | AS                       | APR     | 2013                     |
| QUANT  | REP                      | JN                   | AD                       | 102          | AD                       | AS       | SHOWN                    |         |                          |
| DRAWING NUMBER   |                          |                      |                          |              |                          |          |                          |         |                          |
| PE687-D141-093-096-000   |                          |                      |                          |              |                          |          |                          |         |                          |