

NTS FIGURE 19B XC219 - BUTTEVANT



NOTES:
1. ALL DIMENSIONS ARE IN METRES UNLESS OTHERWISE STATED

EXISTING XC219 BUTTEVANT LEVEL CROSSING
EXTINGUISHMENT OF PUBLIC RIGHT OF WAY

LEGEND

- PROPOSED ROAD ALIGNMENT
- PROPOSED PAVEMENT / VERGE
- PROPOSED STRUCTURE
- WAYLEAVE - RIGHT OF WAY
- RED LINE BOUNDARY
- IRISH RAIL LAND OWNERSHIP
- PROPOSED SAFETY BARRIER
- PROPOSED FENCELINE
- PROPOSED GATE
- LAMP POST
- MASONRY WALL
- PROPOSED MASONRY WALL
- IR BARRIER
- EXISTING IR BARRIER
- PALISADE GATE
- EXISTING PALISADE GATE

DRAWING PREPARED BY:
NAME: JOHN ROCKS
COMPANY: JACOBS ENGINEERING UK LTD.
ADDRESS: SECOND FLOOR, ROCHESTER BUILDING, 28 ADELAIDE STREET, BELFAST

LOCATION PLAN

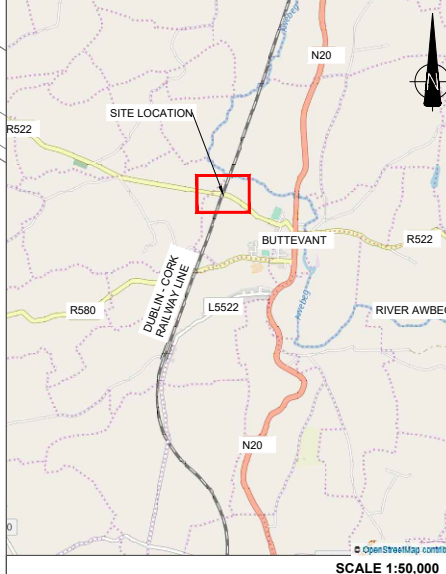

SCALE 1:50,000
© Ordnance Survey Ireland. All rights reserved. Licence number EN 0039719

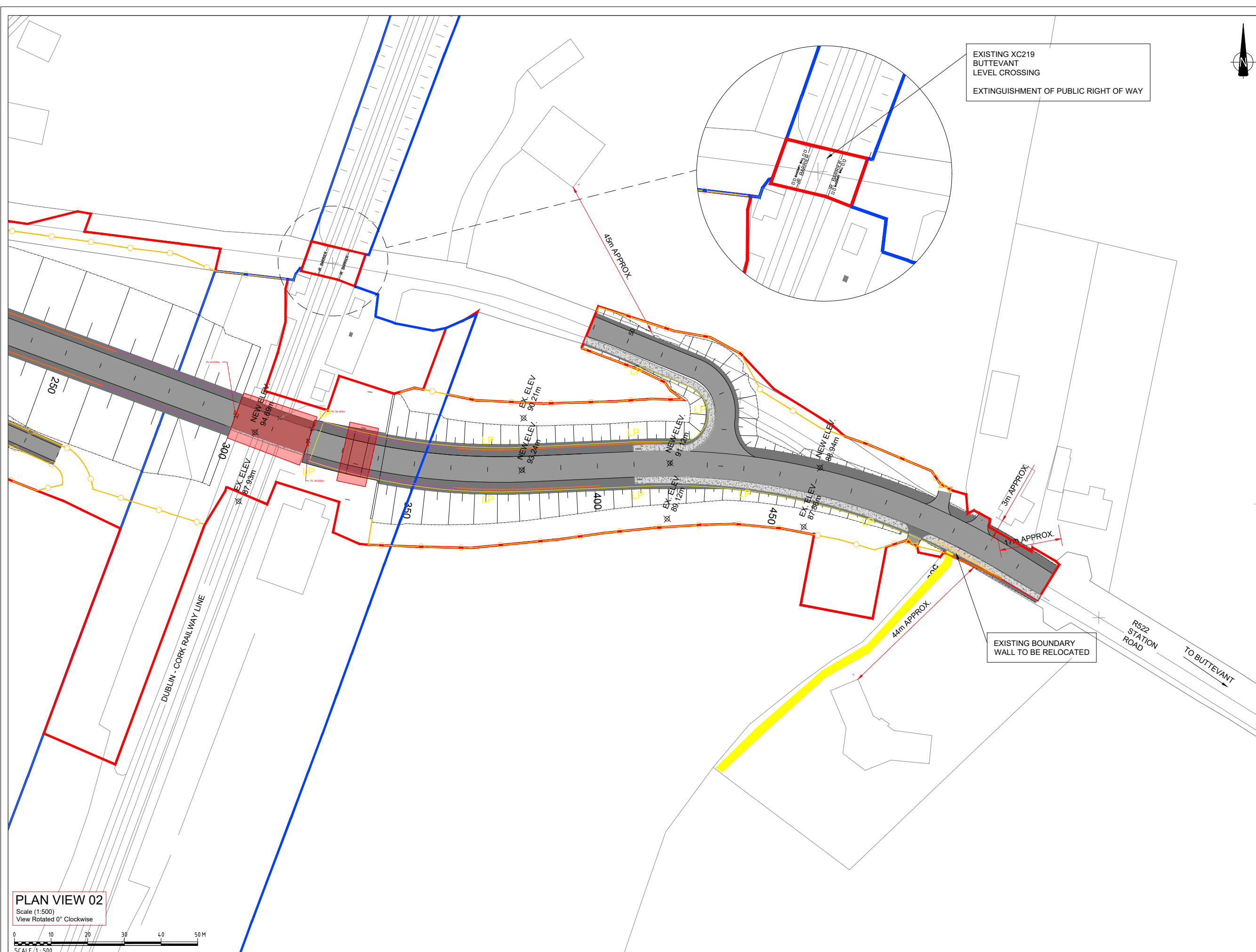

EXISTING BOUNDARY WALL TO BE RELOCATED

PLAN VIEW 02
Scale (1:500)
View Rotated 0° Clockwise

SCALE 1:500



Rev	By	Date	Description
0	JR	OCT '20	DRAFT ISSUE FOR COMMENT
1	AB	DEC '20	MINOR REVISIONS

Project:	CORK LINE LEVEL CROSSINGS		
Component:	RAILWAY ORDER SCHEME DRAWING		
Title:	PROPOSED SITE PLAN - XC219 BUTTEVANT - SHEET 2 OF 2		
Designed:	SK	File Name:	-
Drawn:	JR	Original scales:	PLAN 1:500 @ A1
Checked:	FMD	Date:	DEC '20
Drawing No.:	32111000-JAC-LUH-XC219-DR-CH-0004(ii)		