

FIGURE 3M XC201 - THOMASTOWN

NOTES:
1. ALL DIMENSIONS ARE IN METRES UNLESS OTHERWISE STATED

LEGEND

- 9 x 9 CRANE MAT AREA
- PHASE 1
- PHASE 2
- PHASE 3
- TIE IN NEW AND EXISTING ROADS
- TEMPORARY LAND ACQUISITION

CONSTRUCTION SEQUENCE

- PHASE 1**
1. STRIP / EXCAVATE EXISTING GROUND FOR NEW ROAD FORMATION.
 2. FORM TEMPORARY ROAD ACCESS TO NEW BRIDGE LOCATION FOR PLANT ACCESS (INCLUDING TEMPORARY WORKS CRANE MAT).
- PHASE 2 'RAIL POSSESSIONS REQUIRED'**
3. INSTALL FOUNDATION AND FORM CAPPING BEAM.
 4. INSTALL BRIDGE SUPPORT FOUNDATION USING MOBILE CRANE.
 5. INSTALL PRE CAST BRIDGE BEAMS AND CONCRETE INFILL DURING RAIL POSSESSION AND APPLY BRIDGE DECK WATERPROOFING.
- PHASE 3**
6. FORM NEW REINFORCED EARTH RAMP APPROACH ROADS ON EACH SIDE.
 7. COMPLETE NEW ROAD SURFACE, MARKINGS AND SIGNAGE.
 8. TIE IN NEW AND EXISTING ROADS.
 9. DECANT FROM SITE AND OPEN ROAD TO PUBLIC.

DRAWING PREPARED BY:

NAME: JOHN ROCKS
COMPANY: JACOBS ENGINEERING UK LTD.
ADDRESS: SECOND FLOOR, ROCHESTER BUILDING, 28 ADELAIDE STREET, BELFAST

LOCATION PLAN

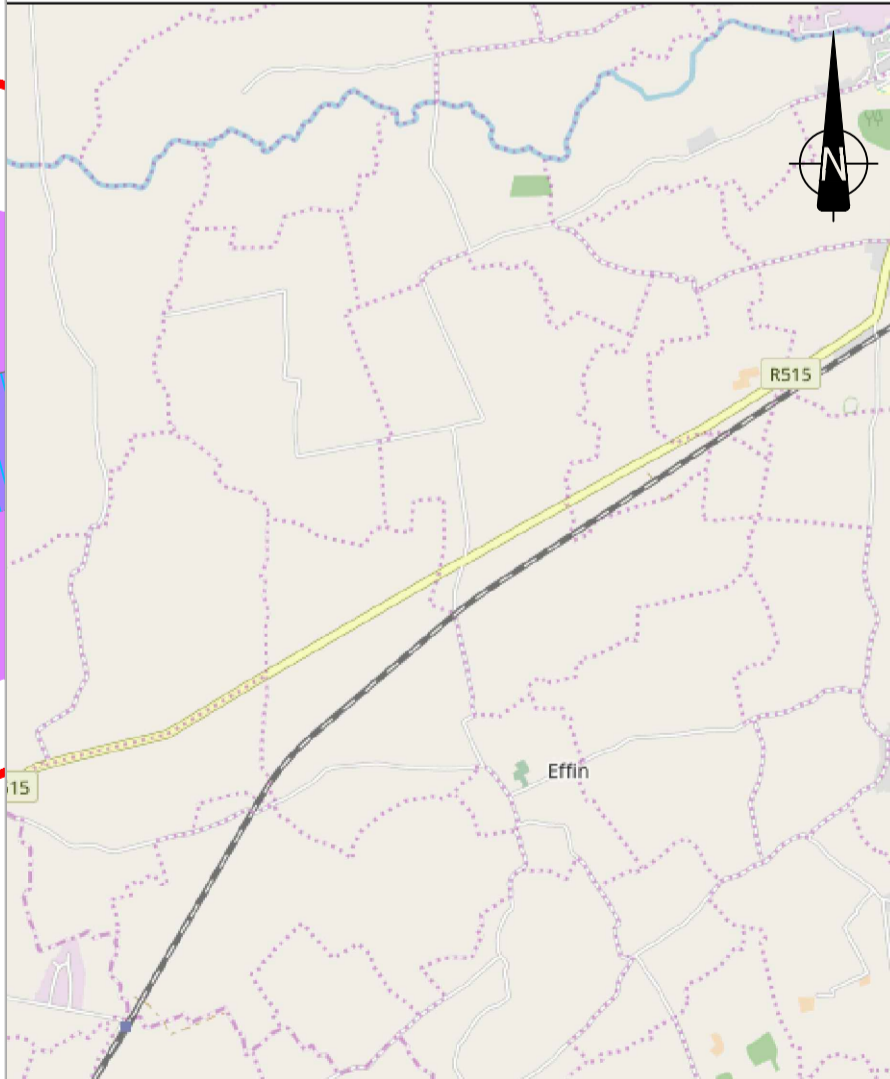

© Ordnance Survey Ireland. All rights reserved. Licence number EN 0039719

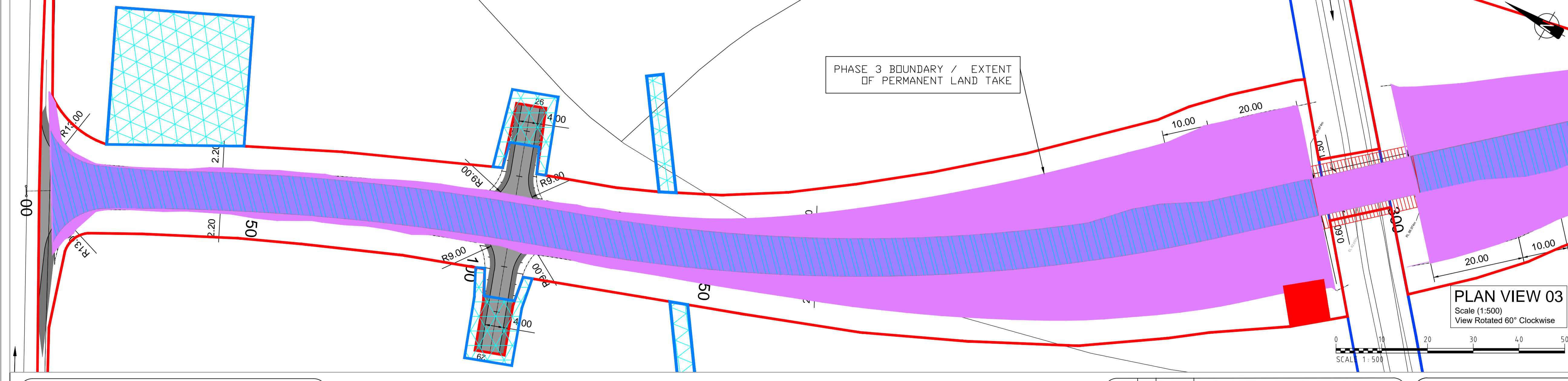
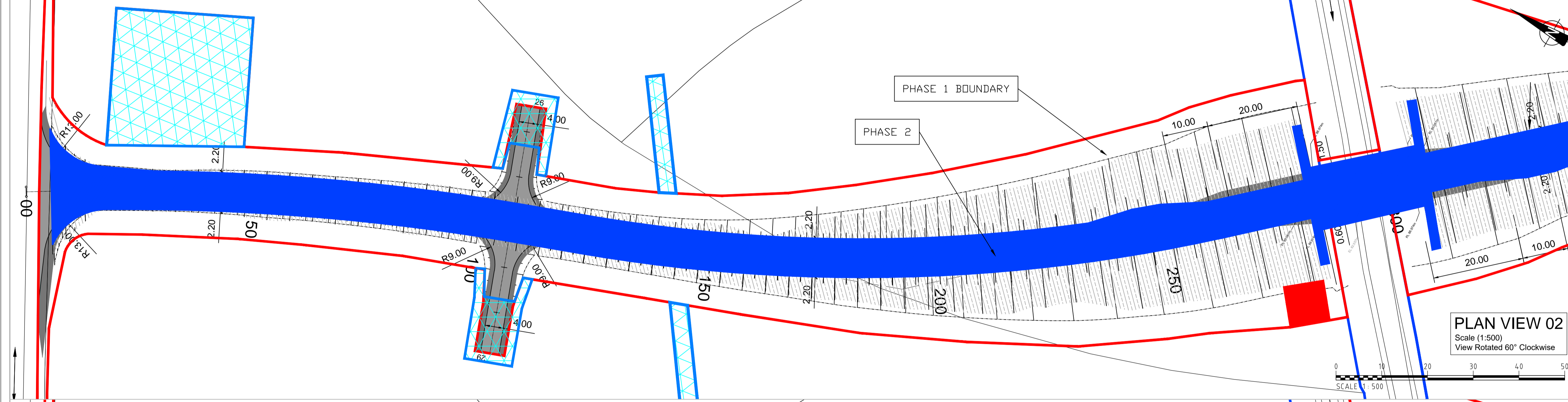
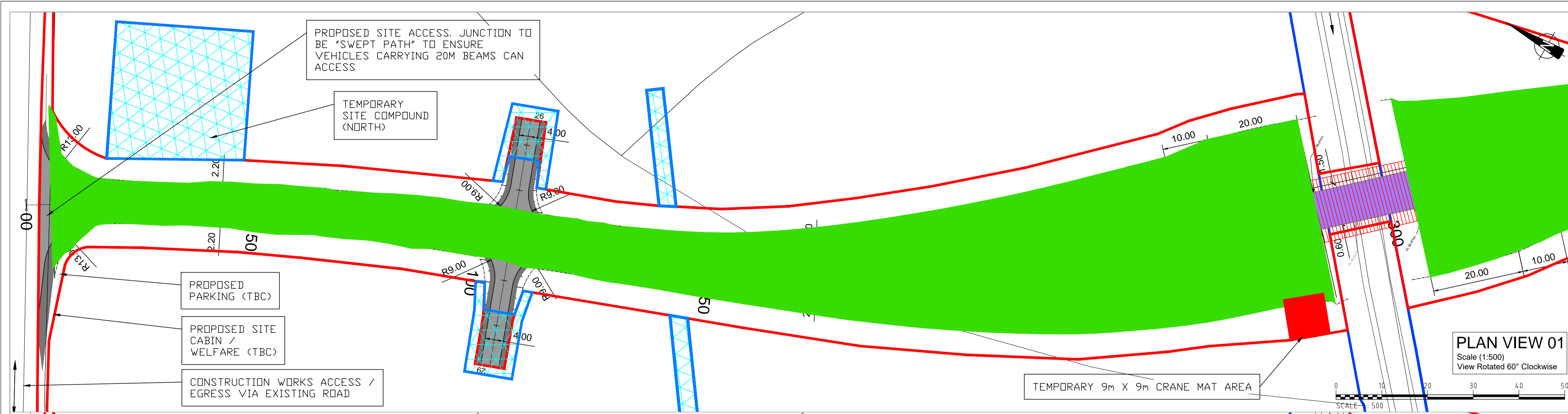

Rev	By	Date	Description
0	CH	SEP 20	ISSUE FOR COMMENT

Project:	CORK LINE LEVEL CROSSINGS		
Component:	RAILWAY ORDER EIA		
Title:	CONSTRUCTION PHASING - XC201 THOMASTOWN - SHEET 1 OF 2		
Design:	SK	File Name:	
Drawn:	CH	Original scales:	PLAN 1:500 @ A1
Checked:	FMD	Date:	SEP 20
Drawing No.:	32111000-JAC-GCN-XC201-DR-CO-00011		