

ALL DIMENSIONS TO BE CHECKED ON SITE
NO DIMENSIONS TO BE SCALED FROM THIS DRAWING
DRAWINGS TO BE READ IN CONJUNCTION WITH RELEVANT CONSULTANT DRAWINGS

A0

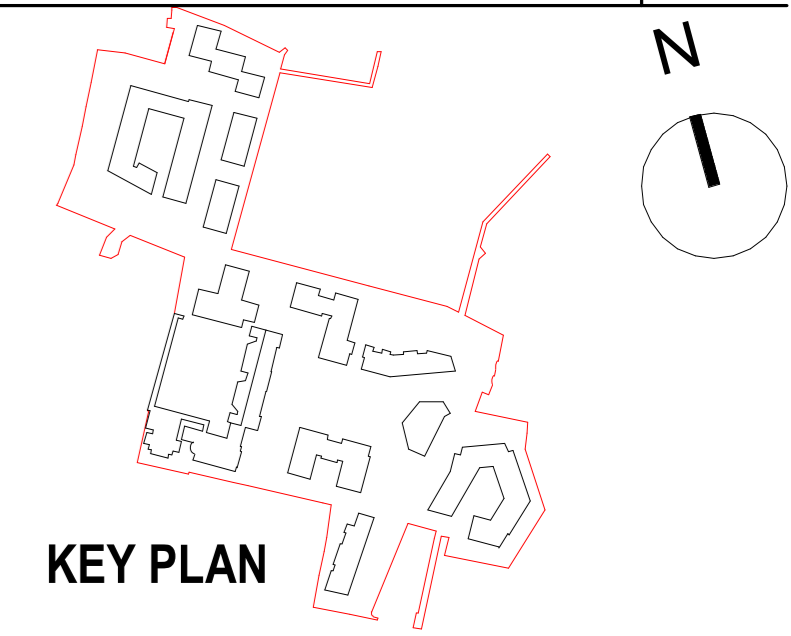

Car Parking Summary

Central Basement
Car Spaces 158
Accessible Spaces 8
Motorcycle Spaces 3

D2 Eastern Basement
Car Spaces 86
Accessible Spaces 4
Motorcycle Spaces 6

Cycle Parking Summary

Central Basement 786
D2 Eastern Basement 324

REV	DATE	DESCRIPTION	BY	CHK
P2	May 2021	Issued for Planning	BG	BF
P1	Nov 2020	Issued for Pre-application consultation	BG	BF

STATUS CODE DESCRIPTION

ISSUED FOR PLANNING APPROVAL

APPLICANT NAME

CWTC Multi Family ICAV acting on behalf of its sub-kind DBTR DR1 Fund

PROJECT NAME

Holy Cross College S&D

LOCATION

Holy Cross College, Clonliffe Road, Dublin 3 and Drumcondra Road Lower, Drumcondra, Dublin 9

DRAWING

CENTRAL BASEMENT PROPOSED LAYOUT PLAN

PROJECT NUMBER

90004

DATE

Nov 20

SCALE @ A0

1:200

DRAWN/CHECKED

BG/BF

STATUS CODE

A1

DRAWING NUMBER

CLN-HLL-SW-B1-DR-A-1021

REVISION

P2

Henry J Lyons
Architecture + Interiors
henryjlyons.com



O'Donnell+Tuomey

mcculloughmulvinarchitects

