

No additional lands to be taken in charge by Dublin City Council.

1 Existing Site Plan
1 : 500

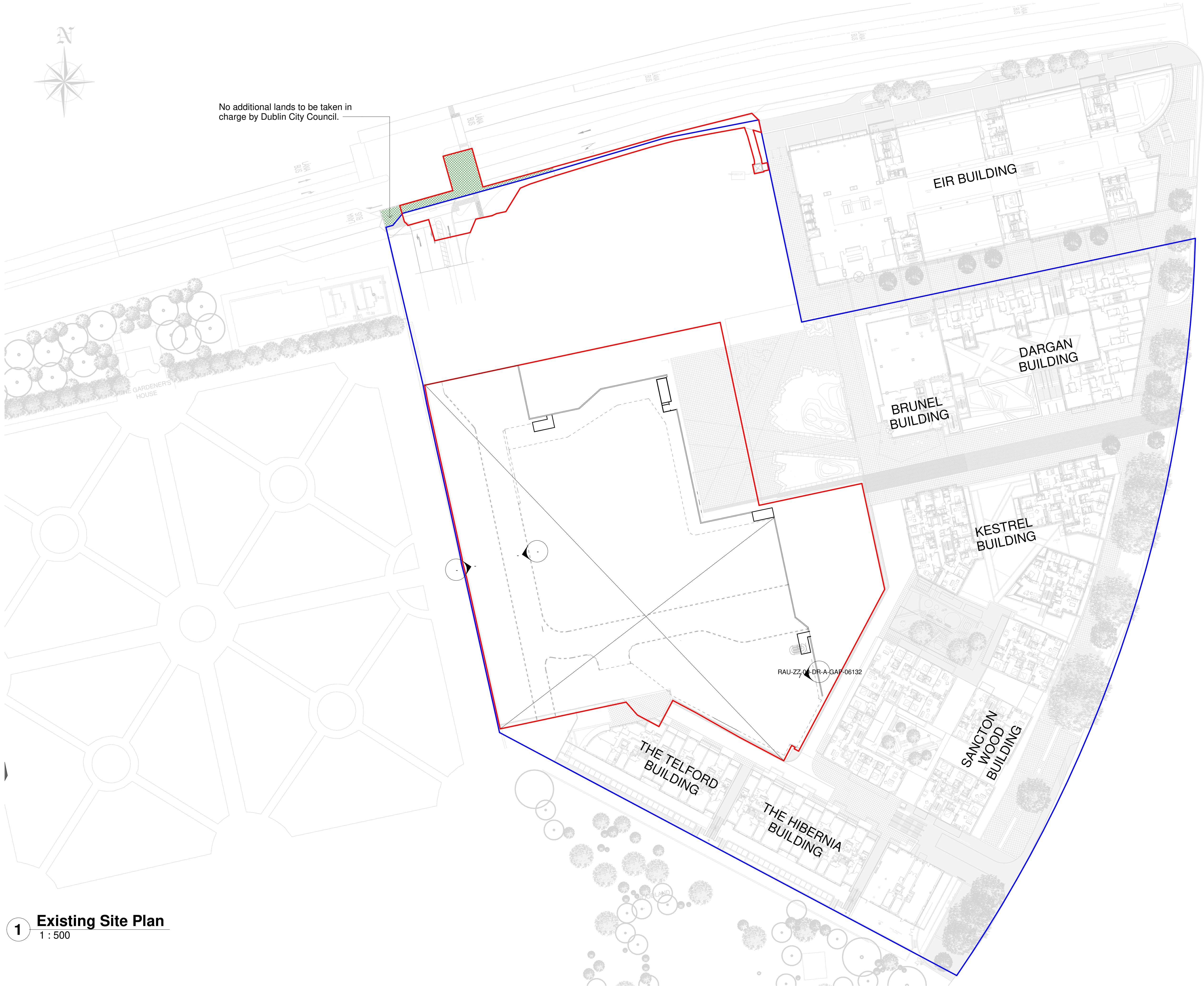

Notes:
- Do not scale from this drawing. Use figured dimensions in all cases.
- Verify dimensions on site and report any discrepancies to the Architect immediately.
- This drawing is to be read in conjunction with the Architect's Specification.
- © This drawing is copyright and may only be reproduced with the Architect's permission.

Drawing Notes:

N
I

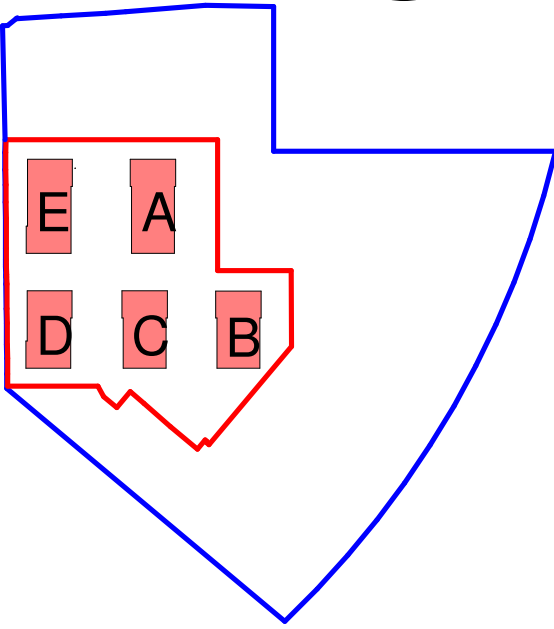

— SHD Site Boundary
— Site Ownership
--- Part 5



Area subject to this planning application that does not form part of the title deeds of the applicant.

Rev.	Date	Drawn	Details of Issue / Revision
P01	02/07/21	EOB	Issued for Planning



W: www.reddyarchitecture.com
E: info@reddyarchitecture.com

Client Details:
HPREF HSQ Investments Limited

Project Details:
HSQ Feasibility
Heuston South Quarter, St John's Rd W,
Kilmainham, Dublin 8

Drawing Title:
Existing Site Plan

Job No.	Sheet Size:	Scale @A1:
P19-213D	A1	1:500
Issue Date:	Drawn By:	Reviewed By:
17/09/21	IOB	EOB

Status	Purpose of Issue	For Information
Project-Originator-Zone-Level-Type-Role-Classification-Number	Revision	
RAU-ZZ-ZZ-DR-A-MPL-0002	P01	