

Notes:
 DO NOT SCALE FROM THIS DRAWING. USE FIGURED DIMENSIONS
 IN ALL CASES. VERIFY DIMENSIONS ON SITE AND REPORT ANY
 DISCREPANCIES TO THE ARCHITECTS IMMEDIATELY. THIS
 DRAWING TO BE READ IN CONJUNCTION WITH THE ARCHITECTS
 SPECIFICATION. © THIS DRAWING IS COPYRIGHT AND MAY ONLY
 BE REPRODUCED WITH THE ARCHITECTS PERMISSION.

001 License Number: A/0002219
 Projection / Spatial Reference:
 Projection: IRTN TRN, Irish Transverse Mercator
 Centre Point Coordinates:
 X Y: 71623.168, 73478.1383
 Reference Index:
 Map Series / Map Sheets
 1:1,000 1283-08
 1:1,000 1284-06
 1:1,000 1285-04
 1:1,000 1284-01
 1:1,000 1285-05
 1:1,000 1283-10
 Vertical Datum:
 MALIN HEAD

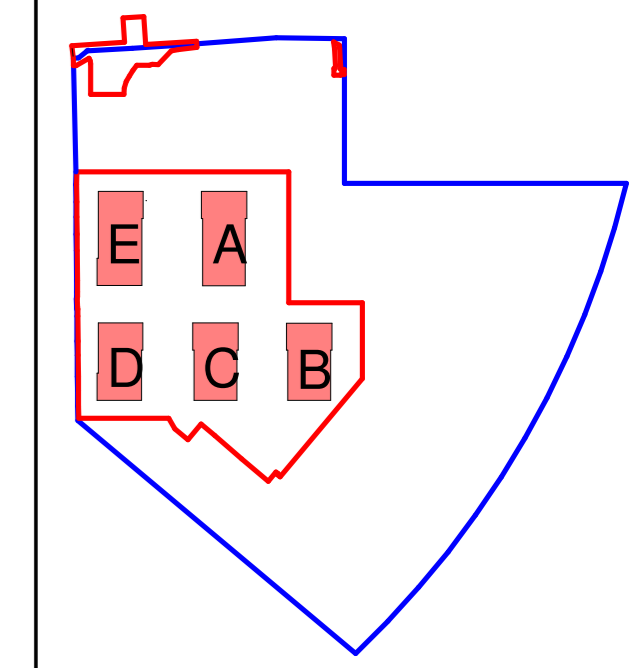

— SHD Site Boundary
 — Site Ownership
 — Part 5

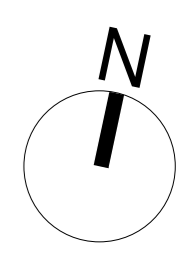
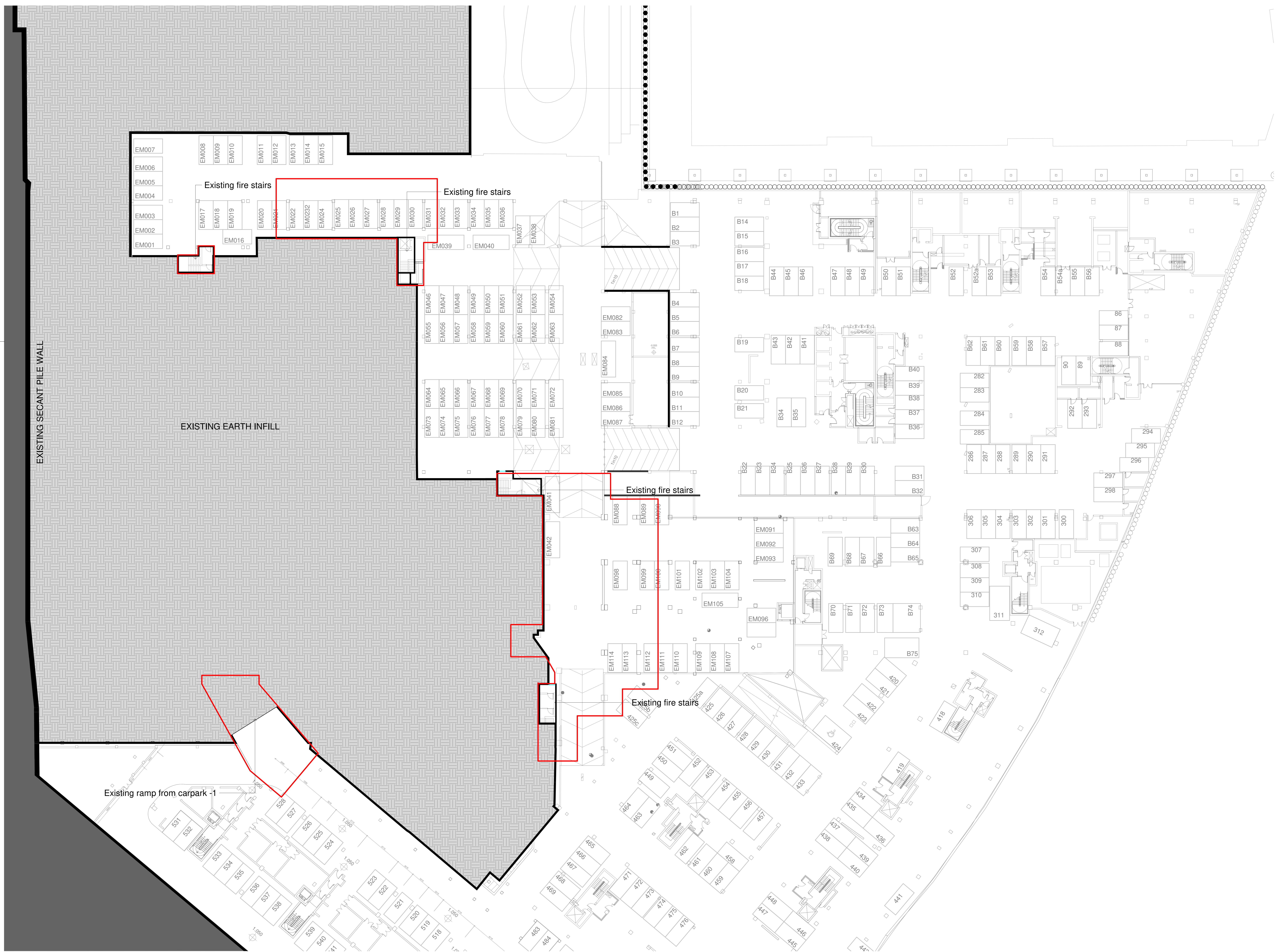

Existing Carpark Level -2
 1:200

P01 02/07/21 EOB Issued for Planning

Rev	Date	DRN	Description



Client Details:
 HPREF HSQ Investments Limited

Project Details:
 HSQ Feasibility
 Houston South Quarter, St John's Rd W,
 Kilmsham, Dublin 8

Drawing Title:
 Existing Car Park Level -2

Job No: P19-213D	Date: 30/07/21	Scale(s): 1:200
Status:	Drawn By: IOB	

Purpose: Planning permission	Checked By: EOB
---------------------------------	--------------------

Drawing Number: RAU-ZZ-00-DR-A-GAP-06094
 Revision: P 01