



APPENDIX 4-5

DRAINAGE DRAWINGS

POLLUTION PREVENTION NOTES:

- SITE MANAGEMENT PROPOSALS ARE INTENDED TO ENSURE PROTECTION AGAINST SURFACE WATER AND GROUNDWATER POLLUTION, SURFACE WATER SILTATION, AND STREAM BANK AND LAND EROSION.
 - SUITABLE DRAINAGE CONTROL MEASURES SHOULD BE IN PLACE AT ALL TIMES TO PREVENT CONVEYANCE OF SIGNIFICANT VOLUMES OF SILT TO OFF SITE RECEIVING WATERCOURSES.
 - SILTY WATER CAN ARISE FROM DEWATERING EXCAVATIONS, EROSION OF EXPOSED/DISTURBED GROUND, EROSION OF TEMPORARY STOCKPILES, PLANT AND WHEEL WASH WATER, RUNOFF FROM SITE ROADS/TRACKS, AND DISTURBANCE OF EXISTING FIELD DRAINS AND DITCHES.
- DISCHARGES**
- WATER CONTAINING SILT WILL NOT BE PUMPED DIRECTLY TO ANY NATURAL WATERCOURSE. ALL DISCHARGES TO BE MADE OVER OPEN GROUND OR INTO EXISTING FIELD DRAIN WITH SILT TRAP A MINIMUM 20M FROM NEAREST WATERCOURSE UNLESS OTHERWISE STATED.
 - NO EXCAVATED MATERIAL IS TO BE STORED WITHIN ANY SURFACE WATER BUFFER ZONE.
 - PUMPED WATER WILL BE DIRECTED INTO TRACK SIDE DITCHES AND TREATED IN SETTLEMENT PONDS AND VEGETATION SWALES PRIOR TO OVERLAND DISCHARGE.
 - PUMPING OF CLEAN WATER FROM EXCAVATIONS / OR OVER-PUMPING INTO FIELD DRAINS/DITCHES/STREAMS WILL BE COMPLETED IN A MANNER THAT DOES NOT CAUSE SCOUR OR EROSION AT THE POINT OF RELEASE/DISCHARGE. THIS WILL BE DONE BY REDUCING THE FLOW VELOCITIES OR BY USE OF SPLASH PLATES, AND OTHER SIMILAR DISCHARGE CONTROLS.
 - VEGETATION WILL NOT BE STRIPPED FROM EXISTING FIELD DRAINS/DITCHES UNLESS ABSOLUTELY NECESSARY.
- EXCAVATIONS**
- WHERE DEEP EXCAVATIONS ARE PROPOSED CUT-OFF DRAINS WILL BE USED TO REDUCE THE AMOUNT OF SURFACE WATER ENTERING THE EXCAVATION. THIS WILL BE THE CASE AROUND TURBINE BASE EXCAVATIONS.
- EXPOSED GROUND & STOCKPILES**
- THE AMOUNT OF EXPOSED GROUND AND TEMPORARY STOCKPILES OPEN AT ANY ONE TIME WILL BE MINIMISED, AS FAR AS PRACTICABLE.
- SITE TRACKS**
- USE OF TRACK SIDE SWALES WITH CHECK DAMS, AND/OR FILTRATION CHECK DAMS WILL REDUCE SILT IN RUNOFF WATER AS REQUIRED.
 - CHECK DAMS TO BE INSPECTED AND CLEANED REGULARLY.
- REFUELLING**
- REFUELLING WILL BE COMPLETED IN LINE WITH CEMP REQUIREMENTS AND AWAY FROM FIELD DRAINS / DITCHES AND WATERCOURSES / WATERBODIES.
 - SPILL KITS AND DRIP TRAYS WILL BE AVAILABLE ON SITE FOR USE AS REQUIRED.
- CONCRETE**
- CARE WILL BE TAKEN WHEN COMPLETING CONCRETE WORKS ON SITE TO ENSURE NO DISCHARGES OF CONCRETE OR WASH WATER OCCURS.
 - CONCRETE WASH WATER, AND WASTE CONCRETE WILL BE MANAGED APPROPRIATELY ON SITE.
- IF WATER POLLUTION IS IDENTIFIED THE FOLLOWING STEPS WOULD BE ADHERED TO:**
- STOP** - WORK IN THE IMMEDIATE AREA SHOULD BE STOPPED AND THE SOURCE OF THE POLLUTION IDENTIFIED.
- CONTAIN** - THE SOURCE OF THE POLLUTION SHOULD BE BUNDED USING A SUITABLE METHOD. NATURAL WATERCOURSES SHOULD BE TEMPORARILY DIVERTED AROUND THE SOURCE OF POLLUTION.
- NOTIFY** - THE RELEVANT AUTHORITIES (SITE MANAGER / INLAND FISHERIES IRELAND / NPWS / LOCAL AUTHORITY ETC.) SHOULD BE NOTIFIED IMMEDIATELY TO ENSURE THAT MEASURES CAN BE IMPLEMENTED DOWNSTREAM TO PROTECT FISHERIES AND OTHER SENSITIVE AREAS, IF REQUIRED.
- DRAINAGE NOTES:**
- ROADWAY SURFACING DESIGN AND CONSTRUCTION TO ENGINEER'S SPECIFICATION.
 - SPARE STRAW BALES/SILT FENCING/ OR SIMILAR, TO BE STORED ON SITE. THE LEVEL OF SILT IN RUNOFF DURING CONSTRUCTION IS TO BE MONITORED VISUALLY AND EXCESSIVE SILT LEVELS IN ANY AREA TO BE TEMPORARILY MANAGED BY PLACING SILT FENCES, STRAW BALES / OR SIMILAR OR ADDITIONAL CHECK DAMS AT THE PROBLEM AREAS.
 - SUDS SYSTEM TO BE CONSTRUCTED PRIOR TO, OR AT THE SAME TIME AS THE ACCESS TRACKS. INTERIM MEASURES SUCH AS THE PLACEMENT OF STRAW BALES/SILT FENCING/OR SIMILAR APPROVED METHOD OR ADDITIONAL CHECK DAMS AND SILT FENCES TO BE EMPLOYED IN ALL INSTANCES WHERE WORK CARRIED OUT TO CONSTRUCT THE ACCESS TRACKS IS LIKELY TO CAUSE ADVERSE ENVIRONMENTAL EFFECTS THROUGH INCREASED SILT LOADINGS BEING GENERATED DURING THE CONSTRUCTION PHASE.
 - SUITABLE PREVENTION MEASURES SHOULD BE IN PLACE AT ALL TIMES TO PREVENT THE CONVEYANCE OF SIGNIFICANT VOLUMES OF SILT TO RECEIVING WATERCOURSES. SEE NOTES ON POLLUTION PREVENTION.
 - INTERCEPTOR SWALES / DITCHES TO BE USED TO COLLECT UPSTREAM SURFACE WATER FLOWS. REGULAR CROSS DRAINS / DISCHARGE TO FIELD DITCHES WILL BE REQUIRED TO TRANSFER / DISCHARGE SURFACE WATER IN INTERCEPTOR DRAINS TO SUITABLE FIELD DRAIN OUTFALL POINTS.
 - DRAINAGE SWALES / DITCHES TO BE EXCAVATED ADJACENT TO THE ACCESS TRACKS. REGULAR CROSS DRAINS TO BE LOCATED ALONG ACCESS TRACKS TO PREVENT EXCESSIVE VOLUMES OF WATER COLLECTING IN THE SWALES / DITCHES. LOCATIONS OF CROSS DRAINS TO BE AGREED WITH THE ENGINEER ON SITE. SURFACE WATER WILL NOT BE ALLOWED TO DISCHARGE DIRECTLY INTO EXISTING WATERCOURSES.
 - WHERE POSSIBLE, A BUFFER ZONE OF >20M TO ANY EXISTING WATERCOURSE WILL BE REQUIRED WHERE OVER LAND DISCHARGES ARE PROPOSED FROM ACCESS TRACK SWALES / DITCHES.
 - BATTERS OF ALL PROPOSED SWALES / DITCHES TO HAVE A SLOPE OF BETWEEN 1 : 1.5 TO 1 : 2 DEPENDING UPON DEPTH OF SWALE/DITCH AND WILL BE LEFT AS CUT TO RE-VEGETATE WITH LOCAL SPECIES.
 - TRACK SIDE SWALES / DITCHES TO BE SHALLOW WITH MODERATE GRADIENTS TO PREVENT SCOURING. IN STEEP AREAS CHECK DAMS SHOULD BE INSTALLED TO REDUCE FLOW VELOCITIES AND PROVIDE SOURCE CONTROL OF SILT CONTAINMENT. WHERE NECESSARY THESE HAVE BEEN DESIGNATED IN CONJUNCTION WITH SETTLEMENT PONDS AND SILT TRAPS, PRIOR TO DISCHARGE.
 - SETTLEMENT PONDS TO BE CONSTRUCTED FOR SILT REMOVAL AT TURBINE BASES AND HARD STAND AREAS. POND SIZES DEPENDS ON CATCHMENT AREA SERVED. SAMPLE POND SIZES SHOWN ON DRAWING D501.
 - STRAW BALES / OR SIMILAR AND SILT FENCES TO BE USED ALSO AROUND SPOIL HEAPS TO MITIGATE SILT RUNOFF. SILT FENCES MAY BE REMOVED WHEN SUITABLE VEGETATION COVER IS ESTABLISHED.
 - SILT FENCES TO BE PROVIDED ALONG EDGE OF EXISTING WATERCOURSE WHERE WORKS COMES WITHIN <20M OF EDGE OF ANY DITCH / EPHEMERAL CHANNELS.
 - SLOPES OF THE SWALES / DITCHES TO BE VEGETATED OR PROTECTED FROM EROSION UNTIL VEGETATION HAS BEEN ESTABLISHED. STRIPPED VEGETATIVE LAYER (PEAT 'SOD' OR 'SCRAW') FROM EXCAVATIONS TO BE STORED LOCALLY AND USED TO LINE SLOPES AND BASE OF SWALES / DITCHES OR LONGITUDINAL MOUNDS OF VEGETATION SWALES AT FIELD DRAIN DISCHARGE POINTS.
 - AREAS STRIPPED OF VEGETATION SHOULD BE KEPT TO A MINIMUM.
 - CLEAN STONE FLOW CONTROL CHECK DAMS TO BE MADE OF LOCALLY WON / GEOLOGICALLY SIMILAR WELL GRADED STONE. AGGREGATE SIZE FOR STONE CHECK DAMS TO BE TYPICALLY 20- 40MM CLEAN STONE. ON SLOPING SECTIONS OF THE ACCESS TRACKS, 40MM CHECK DAMS TO BE PROTECTED FROM WASHING AWAY THROUGH THE PLACEMENT OF 100M STONE ON THE DOWNHILL FACE OF THE CHECK DAM AND BY WRAPPING IN GEOTEXTILE.
 - BUILD UP OF SILT LEVELS AT CHECK DAMS TO BE REMOVED AND DISPOSED OF APPROPRIATELY. SILT LEVELS AT CHECK DAMS TO BE VISUALLY INSPECTED AS PART OF AN ONGOING DRAINAGE MAINTENANCE PROGRAMME DURING THE CONSTRUCTION PHASE. WHERE CHECK DAMS BECOME CLOGGED WITH SILT OR VEGETATION, STONE CHECK DAM TO BE REMOVED AND REPLACED SUBSEQUENT TO THE REMOVAL OF SILT.
 - SPACING AND FREQUENCY OF CHECK DAMS WILL BE DEPENDENT UPON LONGITUDINAL GRADIENT OF SWALE.
 - LOCATION OF FILTRATION CHECK DAMS (IF REQUIRED) TO BE AGREED ON SITE WITH ENGINEER. SETTLEMENT PONDS TO BE CONSTRUCTED IN A MANNER WHERE THEY MAY BE EASILY INFILLED AT A LATER DATE (POST COMPLETION OF THE TURBINE BASE AND HARDSTAND CONSTRUCTION). ONLY SUITABLE MATERIALS EXCAVATED FROM THE POND TO BE USED TO FORM PART OF THE EMBANKMENT AROUND THE POND.
 - OIL/FUEL SHOULD BE STORED WITHIN BUNDED CONTAINMENT STRUCTURES.
 - SILT BAGS WILL BE USED ON SITE AT FIELD DRAIN DISCHARGE LOCATIONS, AS NECESSARY.

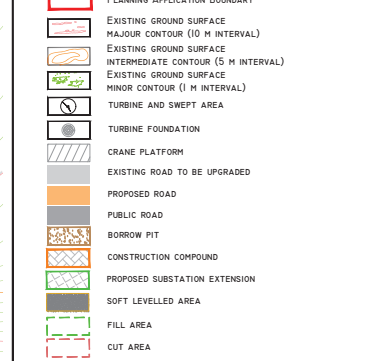
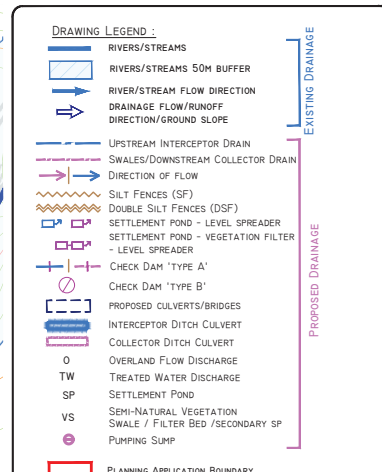
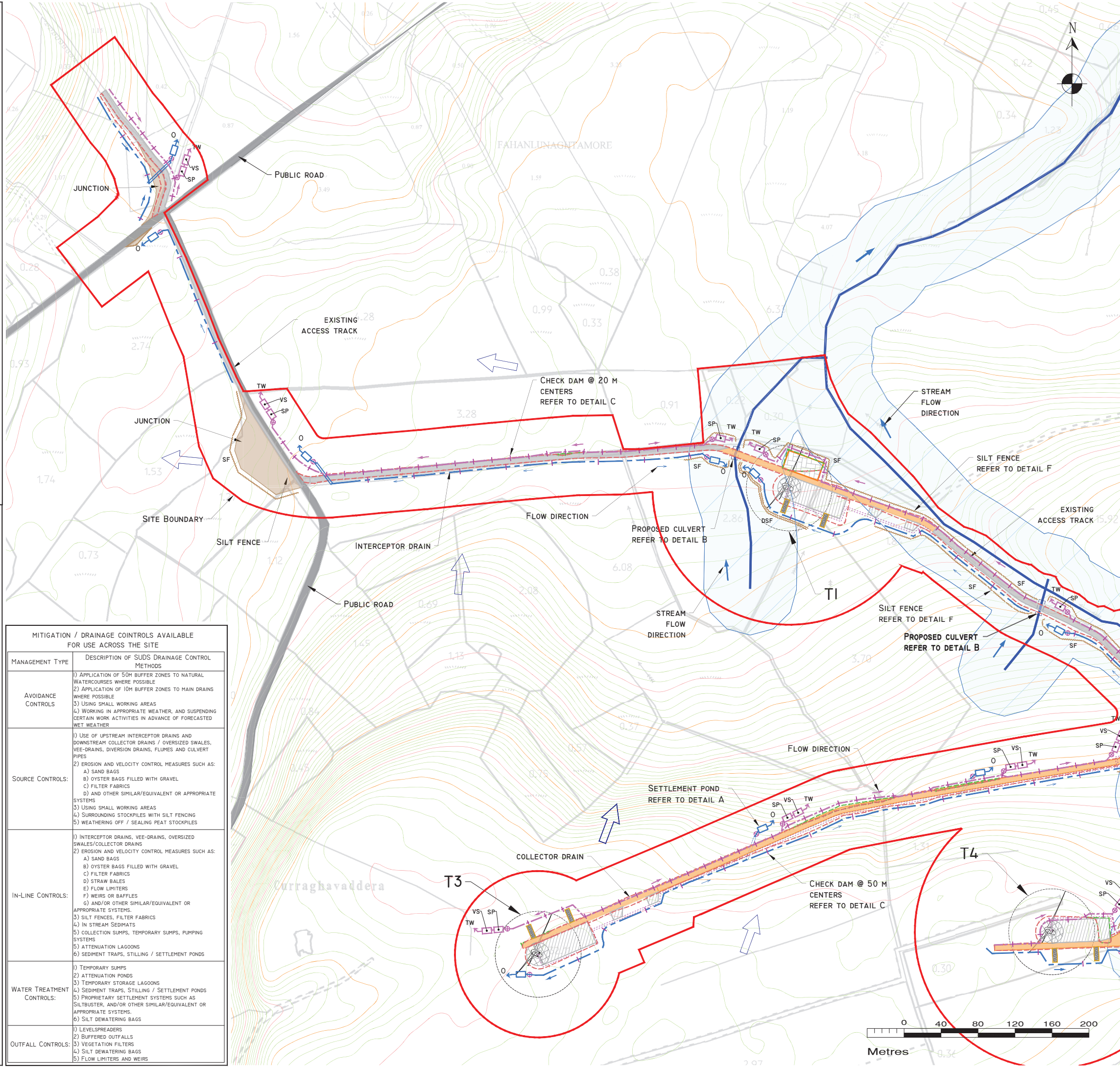

DRAWING NOTES:

- DRAWINGS ISSUED ARE FOR PLANNING APPLICATION PURPOSES ONLY.
- COPYRIGHT, ALL RIGHTS RESERVED. NO PART HERE WITH MAY BE COPIED OR REPRODUCED PARTIALLY OR WHOLLY IN ANY FORM WHATSOEVER WITHOUT THE PRIOR NOTICE OF THE COPYRIGHT OWNER HYDRO-ENVIRONMENTAL SERVICES.
- DO NOT SCALE OFF THIS DRAWING. FIGURED METRIC DIMENSIONS ONLY SHOULD BE TAKEN OFF THIS DRAWING.
- ALL DIMENSIONS ARE IN METRES.

MITIGATION / DRAINAGE COINTROLS AVAILABLE FOR USE ACROSS THE SITE

MANAGEMENT TYPE	DESCRIPTION OF SUDS DRAINAGE CONTROL METHODS
AVOIDANCE CONTROLS	<ol style="list-style-type: none"> APPLICATION OF 50M BUFFER ZONES TO NATURAL WATERCOURSES WHERE POSSIBLE APPLICATION OF 10M BUFFER ZONES TO MAIN DRAINS WHERE POSSIBLE USING SMALL WORKING AREAS WORKING IN APPROPRIATE WEATHER, AND SUSPENDING CERTAIN WORK ACTIVITIES IN ADVANCE OF FORECASTED WET WEATHER
SOURCE CONTROLS:	<ol style="list-style-type: none"> USE OF UPSTREAM INTERCEPTOR DRAINS AND DOWNSTREAM COLLECTOR DRAINS / OVERSIZED SWALES, VEE-DRAINS, DIVERSION DRAINS, FLUMES AND CULVERT PIPES EROSION AND VELOCITY CONTROL MEASURES SUCH AS: <ul style="list-style-type: none"> A) SAND BAGS B) OYSTER BAGS FILLED WITH GRAVEL C) FILTER FABRICS D) STRAW BALES E) FLOW LIMITERS F) WEIRS OR BAFFLES G) AND/OR OTHER SIMILAR/EQUIVALENT OR APPROPRIATE SYSTEMS USING SMALL WORKING AREAS SURROUNDING STOCKPILES WITH SILT FENCING WEATHERING OFF / SEALING PEAT STOCKPILES
IN-LINE CONTROLS:	<ol style="list-style-type: none"> INTERCEPTOR DRAINS, VEE-DRAINS, OVERSIZED SWALES/COLLECTOR DRAINS EROSION AND VELOCITY CONTROL MEASURES SUCH AS: <ul style="list-style-type: none"> A) SAND BAGS B) OYSTER BAGS FILLED WITH GRAVEL C) FILTER FABRICS D) STRAW BALES E) FLOW LIMITERS F) WEIRS OR BAFFLES G) AND/OR OTHER SIMILAR/EQUIVALENT OR APPROPRIATE SYSTEMS SILT FENCES, FILTER FABRICS IN STREAM SEDIMENTS COLLECTION SUMPS, TEMPORARY SUMPS, PUMPING SYSTEMS ATTENUATION LAGOONS SEDIMENT TRAPS, STILLING / SETTLEMENT PONDS
WATER TREATMENT CONTROLS:	<ol style="list-style-type: none"> TEMPORARY SUMPS ATTENUATION PONDS TEMPORARY STORAGE LAGOONS SEDIMENT TRAPS, STILLING / SETTLEMENT PONDS PROPRIETARY SETTLEMENT SYSTEMS SUCH AS SILTBUSTER, AND/OR OTHER SIMILAR/EQUIVALENT OR APPROPRIATE SYSTEMS. SILT DEWATERING BAGS
OUTFALL CONTROLS:	<ol style="list-style-type: none"> LEVELSPREADERS BUFFERED OUTFALLS VEGETATION FILTERS SILT DEWATERING BAGS FLOW LIMITERS AND WEIRS

Ordnance Survey Ireland Licence No. EN 0044721
© Ordnance Survey Ireland/Government of Ireland

Date	Description	Chkd	Signed
Revisions			

HYDRO ENVIRONMENTAL SERVICES

22 Lower Main St
Dungarvan
Co. Waterford
Ireland

tel: +353 (0) 58-44122
tel: +353 (0) 58-44244
email: info@hydroenvironmental.ie
web: www.hydroenvironmental.ie

Client: **MKO**

Job: **SLIEVEACURRY RENEWABLE ENERGY DEVELOPMENT**

Title: **PROPOSED DRAINAGE LAYOUT**

Figure No: **D101**

Drawing No: P1159-4-1121-A1-D101-00B
Sheet Size: A1
Scale: 1:2,000 (A1)
Date: 11/11/2021

Project No.: P1159-4
Drawn By: GD
Checked By: MG

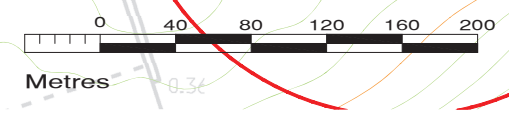

POLLUTION PREVENTION NOTES:

- SITE MANAGEMENT PROPOSALS ARE INTENDED TO ENSURE PROTECTION AGAINST SURFACE WATER AND GROUNDWATER POLLUTION, SURFACE WATER SILTATION, AND STREAM BANK AND LAND EROSION.
- SUITABLE DRAINAGE CONTROL MEASURES SHOULD BE IN PLACE AT ALL TIMES TO PREVENT CONVEYANCE OF SIGNIFICANT VOLUMES OF SILT TO OFF SITE RECEIVING WATERCOURSES.
- SILTY WATER CAN ARISE FROM DEWATERING EXCAVATIONS, EROSION OF EXPOSED/DISTURBED GROUND, EROSION OF TEMPORARY STOCKPILES, PLANT AND WHEEL WASH WATER, RUNOFF FROM SITE ROADS/TRACKS, AND DISTURBANCE OF EXISTING FIELD DRAINS AND DITCHES.

DISCHARGES

- WATER CONTAINING SILT WILL NOT BE PUMPED DIRECTLY TO ANY NATURAL WATERCOURSE. ALL DISCHARGES TO BE MADE OVER OPEN GROUND OR INTO EXISTING FIELD DRAIN WITH SILT TRAP A MINIMUM 20M FROM NEAREST WATERCOURSE UNLESS OTHERWISE STATED.
- NO EXCAVATED MATERIAL IS TO BE STORED WITHIN ANY SURFACE WATER BUFFER ZONE.
- PUMPED WATER WILL BE DIRECTED INTO TRACK SIDE DITCHES AND TREATED IN SETTLEMENT PONDS AND VEGETATION SWALES PRIOR TO OVERLAND DISCHARGE.
- PUMPING OF CLEAN WATER FROM EXCAVATIONS / OR OVER-PUMPING INTO FIELD DRAINS/DITCHES/STREAMS WILL BE COMPLETED IN A MANNER THAT DOES NOT CAUSE SCOUR OR EROSION AT THE POINT OF RELEASE/DISCHARGE. THIS WILL BE DONE BY REDUCING THE FLOW VELOCITIES OR BY USE OF SLASH PLATES, AND OTHER SIMILAR DISCHARGE CONTROLS.
- VEGETATION WILL NOT BE STRIPPED FROM EXISTING FIELD DRAINS/DITCHES UNLESS ABSOLUTELY NECESSARY.

EXCAVATIONS

- WHERE DEEP EXCAVATIONS ARE PROPOSED CUT-OFF DRAINS WILL BE USED TO REDUCE THE AMOUNT OF SURFACE WATER ENTERING THE EXCAVATION. THIS WILL BE THE CASE AROUND TURBINE BASE EXCAVATIONS.

EXPOSED GROUND & STOCKPILES

- THE AMOUNT OF EXPOSED GROUND AND TEMPORARY STOCKPILES OPEN AT ANY ONE TIME WILL BE MINIMISED, AS FAR AS PRACTICABLE.

SITE TRACKS

- USE OF TRACK SIDE SWALES WITH CHECK DAMS, AND/OR FILTRATION CHECK DAMS WILL REDUCE SILT IN RUNOFF WATER AS REQUIRED.
- CHECK DAMS TO BE INSPECTED AND CLEANED REGULARLY.

REFUELLING

- REFUELLING WILL BE COMPLETED IN LINE WITH CEMP REQUIREMENTS AND AWAY FROM FIELD DRAINS / DITCHES AND WATERCOURSES / WATERBODIES.
- SPILL KITS AND DRIP TRAYS WILL BE AVAILABLE ON SITE FOR USE AS REQUIRED.

CONCRETE

- CARE WILL BE TAKEN WHEN COMPLETING CONCRETE WORKS ON SITE TO ENSURE NO DISCHARGES OF CONCRETE OR WASH WATER OCCURS.
- CONCRETE WASH WATER, AND WASTE CONCRETE WILL BE MANAGED APPROPRIATELY ON SITE.

IF WATER POLLUTION IS IDENTIFIED THE FOLLOWING STEPS WOULD BE ADHERED TO:

STOP - WORK IN THE IMMEDIATE AREA SHOULD BE STOPPED AND THE SOURCE OF THE POLLUTION IDENTIFIED.

CONTAIN - THE SOURCE OF THE POLLUTION SHOULD BE BUNDED USING A SUITABLE METHOD. NATURAL WATERCOURSES SHOULD BE TEMPORARILY DIVERTED AROUND THE SOURCE OF POLLUTION.

NOTIFY - THE RELEVANT AUTHORITIES (SITE MANAGER / INLAND FISHERIES IRELAND / NPWS / LOCAL AUTHORITY ETC.) SHOULD BE NOTIFIED IMMEDIATELY TO ENSURE THAT MEASURES CAN BE IMPLEMENTED DOWNSTREAM TO PROTECT FISHERIES AND OTHER SENSITIVE AREAS, IF REQUIRED.

DRAINAGE NOTES:

- ROADWAY SURFACING DESIGN AND CONSTRUCTION TO ENGINEER'S SPECIFICATION.
- SPARE STRAW BALES/SILT FENCING/ OR SIMILAR, TO BE STORED ON SITE. THE LEVEL OF SILT IN RUNOFF DURING CONSTRUCTION IS TO BE MONITORED VISUALLY AND EXCESSIVE SILT LEVELS IN ANY AREA TO BE TEMPORARILY MANAGED BY PLACING SILT FENCES, STRAW BALES / OR SIMILAR OR ADDITIONAL CHECK DAMS AT THE PROBLEM AREAS.
- SUDS SYSTEM TO BE CONSTRUCTED PRIOR TO, OR AT THE SAME TIME AS THE ACCESS TRACKS. INTERIM MEASURES SUCH AS THE PLACEMENT OF STRAW BALES/SILT FENCING/OR SIMILAR APPROVED METHOD OR ADDITIONAL CHECK DAMS AND SILT FENCES TO BE EMPLOYED IN ALL INSTANCES WHERE WORK CARRIES OUT TO CONSTRUCT THE ACCESS TRACKS IS LIKELY TO CAUSE ADVERSE ENVIRONMENTAL EFFECTS THROUGH INCREASED SILT LOADINGS BEING GENERATED DURING THE CONSTRUCTION PHASE.
- SUITABLE PREVENTION MEASURES SHOULD BE IN PLACE AT ALL TIMES TO PREVENT THE CONVEYANCE OF SIGNIFICANT VOLUMES OF SILT TO RECEIVING WATERCOURSES. SEE NOTES ON POLLUTION PREVENTION.
- INTERCEPTOR SWALES / DITCHES TO BE USED TO COLLECT UPSTREAM SURFACE WATER FLOWS. REGULAR CROSS DRAINS / DISCHARGE TO FIELD DITCHES WILL BE REQUIRED TO TRANSFER / DISCHARGE SURFACE WATER IN INTERCEPTOR DRAINS TO SUITABLE FIELD DRAIN OUTFALL POINTS.
- DRAINAGE SWALES / DITCHES TO BE EXCAVATED ADJACENT TO THE ACCESS TRACKS. REGULAR CROSS DRAINS TO BE LOCATED ALONG ACCESS TRACKS TO PREVENT EXCESSIVE VOLUMES OF WATER COLLECTING IN THE SWALES / DITCHES. LOCATIONS OF CROSS DRAINS TO BE AGREED WITH THE ENGINEER ON SITE. SURFACE WATER WILL NOT BE ALLOWED TO DISCHARGE DIRECTLY INTO EXISTING WATERCOURSES.
- WHERE POSSIBLE, A BUFFER ZONE OF >20M TO ANY EXISTING WATERCOURSE WILL BE REQUIRED WHERE OVER LAND DISCHARGES ARE PROPOSED FROM ACCESS TRACK SWALES / DITCHES.
- BATTERS OF ALL PROPOSED SWALES / DITCHES TO HAVE A SLOPE OF BETWEEN 1 : 1.5 TO 1 : 2 DEPENDING UPON DEPTH OF SWALE/DITCH AND WILL BE LEFT AS CUT TO RE-VEGETATE WITH LOCAL SPECIES.
- TRACK SIDE SWALES / DITCHES TO BE SHALLOW WITH MODERATE GRADIENTS TO PREVENT SCOURING. IN STEEP AREAS CHECK DAMS SHOULD BE INSTALLED TO REDUCE FLOW VELOCITIES AND PROVIDE SOURCE CONTROL OF SILT CONTAINMENT. WHERE NECESSARY THESE HAVE BEEN DESIGNATED IN CONJUNCTION WITH SETTLEMENT PONDS AND SILT TRAPS, PRIOR TO DISCHARGE.
- SETTLEMENT PONDS TO BE CONSTRUCTED FOR SILT REMOVAL AT TURBINE BASES AND HARD STAND AREAS. POND SIZES DEPENDS ON CATCHMENT AREA SERVED. SAMPLE POND SIZES SHOWN ON DRAWING D501.
- STRAW BALES / OR SIMILAR AND SILT FENCES TO BE USED ALSO AROUND SPOIL HEAPS TO MITIGATE SILT RUNOFF. SILT FENCES MAY BE REMOVED WHEN SUITABLE VEGETATION COVER IS ESTABLISHED.
- SILT FENCES TO BE PROVIDED ALONG EDGE OF EXISTING WATERCOURSE WHERE WORKS COMES WITHIN <20M OF EDGE OF ANY DITCH / EPHEMERAL CHANNELS.
- SLOPES OF THE SWALES / DITCHES TO BE VEGETATED OR PROTECTED FROM EROSION UNTIL VEGETATION HAS BEEN ESTABLISHED. STRIPPED VEGETATIVE LAYER (PEAT 'SOD' OR 'SCRAW') FROM EXCAVATIONS TO BE STORED LOCALLY AND USED TO LINE SLOPES AND BASE OF SWALES / DITCHES OR LONGITUDINAL MOUNDS OF VEGETATION SWALES AT FIELD DRAIN DISCHARGE POINTS.
- AREAS STRIPPED OF VEGETATION SHOULD BE KEPT TO A MINIMUM.
- CLEAN STONE FLOW CONTROL CHECK DAMS TO BE MADE OF LOCALLY WON / GEOLOGICALLY SIMILAR WELL GRADED STONE. AGGREGATE SIZE FOR STONE CHECK DAMS TO BE TYPICALLY 20- 40MM CLEAN STONE. ON SLOPING SECTIONS OF THE ACCESS TRACKS, 400MM CHECK DAMS TO BE PROTECTED FROM WASHING AWAY THROUGH THE PLACEMENT OF 100M STONE ON THE DOWNHILL FACE OF THE CHECK DAM AND BY WRAPPING IN GEOTEXTILE.
- BUILD UP OF SILT LEVELS AT CHECK DAMS TO BE REMOVED AND DISPOSED OF APPROPRIATELY. SILT LEVELS AT CHECK DAMS TO BE VISUALLY INSPECTED AS PART OF AN ONGOING DRAINAGE MAINTENANCE PROGRAMME DURING THE CONSTRUCTION PHASE. WHERE CHECK DAMS BECOME CLOGGED WITH SILT OR VEGETATION, STONE CHECK DAM TO BE REMOVED AND REPLACED SUBSEQUENT TO THE REMOVAL OF SILT.
- SPACING AND FREQUENCY OF CHECK DAMS WILL BE DEPENDENT UPON LONGITUDINAL GRADIENT OF SWALE.
- LOCATION OF FILTRATION CHECK DAMS (IF REQUIRED) TO BE AGREED ON SITE WITH ENGINEER. SETTLEMENT PONDS TO BE CONSTRUCTED IN A MANNER WHERE THEY MAY BE EASILY INFILLED AT A LATER DATE (POST COMPLETION OF THE TURBINE BASE AND HARDSTAND CONSTRUCTION). ONLY SUITABLE MATERIALS EXCAVATED FROM THE POND TO BE USED TO FORM PART OF THE EMBANKMENT AROUND THE POND.
- OIL/FUEL SHOULD BE STORED WITHIN BUNDED CONTAINMENT STRUCTURES.
- SILT BAGS WILL BE USED ON SITE AT FIELD DRAIN DISCHARGE LOCATIONS, AS NECESSARY.

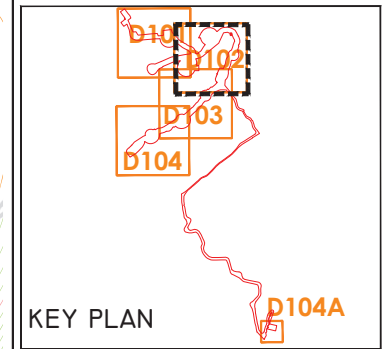
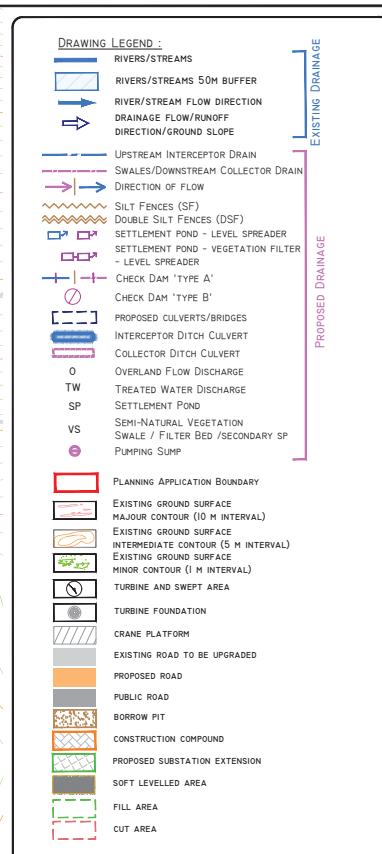
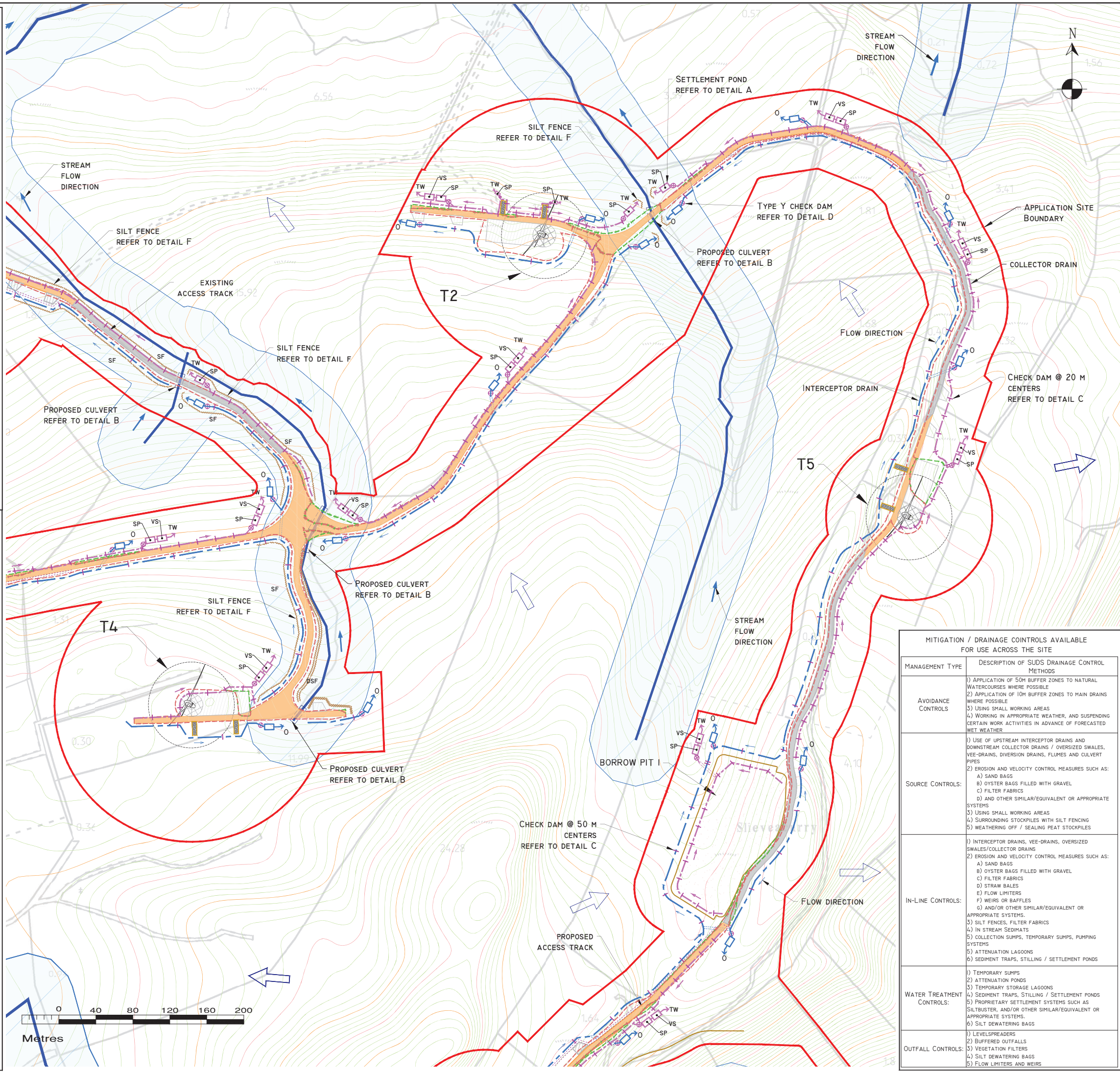

DRAWING NOTES

- DRAWINGS ISSUED ARE FOR PLANNING APPLICATION PURPOSES ONLY.
- COPYRIGHT, ALL RIGHTS RESERVED. NO PART HERE WITH MAY BE COPIED OR REPRODUCED PARTIALLY OR WHOLLY IN ANY FORM WHATSOEVER WITHOUT THE PRIOR NOTICE OF THE COPYRIGHT OWNER HYDRO-ENVIRONMENTAL SERVICES.
- DO NOT SCALE OFF THIS DRAWING. FIGURED METRIC DIMENSIONS ONLY SHOULD BE TAKEN OFF THIS DRAWING.
- ALL DIMENSIONS ARE IN METRES.

Ordnance Survey Ireland Licence No. EN 0044721
© Ordnance Survey Ireland/Government of Ireland

Date	Description	Chkd	Signed

HYDRO ENVIRONMENTAL SERVICES

22 Lower Main St
Dunganan
Co. Waterford
Ireland

tel: +353 (0) 58-44122
tel: +353 (0) 58-44244
email: info@hydroenvironmental.ie
web: www.hydroenvironmental.ie

Client: **MKO**

Job: **SLIEVEACURRY RENEWABLE ENERGY DEVELOPMENT**

Title: **PROPOSED DRAINAGE LAYOUT**

Figure No: **D102**

Drawing No: **P1159-4-112120-A1-D102-00B**

Sheet Size: **A1** Project No.: **P1159-4**

Scale: **1:2,000 (A1)** Drawn By: **GD**

Date: **11/11/2021** Checked By: **MG**

MITIGATION / DRAINAGE CONTROLS AVAILABLE FOR USE ACROSS THE SITE

MANAGEMENT TYPE	DESCRIPTION OF SUDS DRAINAGE CONTROL METHODS
AVOIDANCE CONTROLS	<ol style="list-style-type: none"> APPLICATION OF 50M BUFFER ZONES TO NATURAL WATERCOURSES WHERE POSSIBLE APPLICATION OF 10M BUFFER ZONES TO MAIN DRAINS WHERE POSSIBLE USING SMALL WORKING AREAS WORKING IN APPROPRIATE WEATHER, AND SUSPENDING CERTAIN WORK ACTIVITIES IN ADVANCE OF FORECASTED WEATHER
SOURCE CONTROLS	<ol style="list-style-type: none"> USE OF UPSTREAM INTERCEPTOR DRAINS AND DOWNSTREAM COLLECTOR DRAINS / OVERSIZED SWALES, VEE-DRAINS, DIVERSION DRAINS, FLUMES AND CULVERT PIPES EROSION AND VELOCITY CONTROL MEASURES SUCH AS: <ol style="list-style-type: none"> SAND BAGS OYSTER BAGS FILLED WITH GRAVEL FILTER FABRICS AND OTHER SIMILAR/EQUIVALENT OR APPROPRIATE SYSTEMS USING SMALL WORKING AREAS SURROUNDING STOCKPILES WITH SILT FENCING WEATHERING OFF / SEALING PEAT STOCKPILES
IN-LINE CONTROLS	<ol style="list-style-type: none"> INTERCEPTOR DRAINS, VEE-DRAINS, OVERSIZED SWALES/COLLECTOR DRAINS EROSION AND VELOCITY CONTROL MEASURES SUCH AS: <ol style="list-style-type: none"> SAND BAGS OYSTER BAGS FILLED WITH GRAVEL FILTER FABRICS STRAW BALES FLOW LIMITERS WEIRS OR BAFFLES AND/OR OTHER SIMILAR/EQUIVALENT OR APPROPRIATE SYSTEMS. IN STREAM SEDIMENTS COLLECTION SUMPS, TEMPORARY SUMPS, PUMPING SYSTEMS ATTENUATION LAGOONS SEDIMENT TRAPS, STILLING / SETTLEMENT PONDS
WATER TREATMENT CONTROLS	<ol style="list-style-type: none"> TEMPORARY SUMPS ATTENUATION PONDS TEMPORARY STORAGE LAGOONS SEDIMENT TRAPS, STILLING / SETTLEMENT PONDS PROPRIETARY SETTLEMENT SYSTEMS SUCH AS SILTBUSTER, AND/OR OTHER SIMILAR/EQUIVALENT OR APPROPRIATE SYSTEMS. SILT DEWATERING BAGS
OUTFALL CONTROLS	<ol style="list-style-type: none"> LEVELSPREADERS BUFFERED OUTFALLS VEGETATION FILTERS SILT DEWATERING BAGS FLOW LIMITERS AND WEIRS

POLLUTION PREVENTION NOTES:

- SITE MANAGEMENT PROPOSALS ARE INTENDED TO ENSURE PROTECTION AGAINST SURFACE WATER AND GROUNDWATER POLLUTION, SURFACE WATER SILTATION, AND STREAM BANK AND LAND EROSION.
 - SUITABLE DRAINAGE CONTROL MEASURES SHOULD BE IN PLACE AT ALL TIMES TO PREVENT CONVEYANCE OF SIGNIFICANT VOLUMES OF SILT TO OFF SITE RECEIVING WATERCOURSES.
 - SILTY WATER CAN ARISE FROM DEWATERING EXCAVATIONS, EROSION OF EXPOSED/DISTURBED GROUND, EROSION OF TEMPORARY STOCKPILES, PLANT AND WHEEL WASH WATER, RUNOFF FROM SITE ROADS/TRACKS, AND DISTURBANCE OF EXISTING FIELD DRAINS AND DITCHES.
- DISCHARGES**
- WATER CONTAINING SILT WILL NOT BE PUMPED DIRECTLY TO ANY NATURAL WATERCOURSE. ALL DISCHARGES TO BE MADE OVER OPEN GROUND OR INTO EXISTING FIELD DRAIN WITH SILT TRAP A MINIMUM 20M FROM NEAREST WATERCOURSE UNLESS OTHERWISE STATED.
 - NO EXCAVATED MATERIAL IS TO BE STORED WITHIN ANY SURFACE WATER BUFFER ZONE.
 - PUMPED WATER WILL BE DIRECTED INTO TRACK SIDE DITCHES AND TREATED IN SETTLEMENT PONDS AND VEGETATION SWALES PRIOR TO OVERLAND DISCHARGE.
 - PUMPING OF CLEAN WATER FROM EXCAVATIONS / OR OVER-PUMPING INTO FIELD DRAINS/DITCHES/STREAMS WILL BE COMPLETED IN A MANNER THAT DOES NOT CAUSE SCOUR OR EROSION AT THE POINT OF RELEASE/DISCHARGE. THIS WILL BE DONE BY REDUCING THE FLOW VELOCITIES OR BY USE OF SPLASH PLATES, AND OTHER SIMILAR DISCHARGE CONTROLS.
 - VEGETATION WILL NOT BE STRIPPED FROM EXISTING FIELD DRAINS/DITCHES UNLESS ABSOLUTELY NECESSARY.
- EXCAVATIONS**
- WHERE DEEP EXCAVATIONS ARE PROPOSED CUT-OFF DRAINS WILL BE USED TO REDUCE THE AMOUNT OF SURFACE WATER ENTERING THE EXCAVATION. THIS WILL BE THE CASE AROUND TURBINE BASE EXCAVATIONS.
- EXPOSED GROUND & STOCKPILES**
- THE AMOUNT OF EXPOSED GROUND AND TEMPORARY STOCKPILES OPEN AT ANY ONE TIME WILL BE MINIMISED, AS FAR AS PRACTICABLE.
- SITE TRACKS**
- USE OF TRACK SIDE SWALES WITH CHECK DAMS, AND/OR FILTRATION CHECK DAMS WILL REDUCE SILT IN RUNOFF WATER AS REQUIRED.
 - CHECK DAMS TO BE INSPECTED AND CLEANED REGULARLY.
- REFUELLING**
- REFUELLING WILL BE COMPLETED IN LINE WITH CEMP REQUIREMENTS AND AWAY FROM FIELD DRAINS / DITCHES AND WATERCOURSES / WATERBODIES.
 - SPILL KITS AND DRIP TRAYS WILL BE AVAILABLE ON SITE FOR USE AS REQUIRED.
- CONCRETE**
- CARE WILL BE TAKEN WHEN COMPLETING CONCRETE WORKS ON SITE TO ENSURE NO DISCHARGES OF CONCRETE OR WASH WATER OCCURS.
 - CONCRETE WASH WATER, AND WASTE CONCRETE WILL BE MANAGED APPROPRIATELY ON SITE.
- IF WATER POLLUTION IS IDENTIFIED THE FOLLOWING STEPS WOULD BE ADHERED TO:**
- STOP** - WORK IN THE IMMEDIATE AREA SHOULD BE STOPPED AND THE SOURCE OF THE POLLUTION IDENTIFIED.
- CONTAIN** - THE SOURCE OF THE POLLUTION SHOULD BE BUNDED USING A SUITABLE METHOD. NATURAL WATERCOURSES SHOULD BE TEMPORARILY DIVERTED AROUND THE SOURCE OF POLLUTION.
- NOTIFY** - THE RELEVANT AUTHORITIES (SITE MANAGER / INLAND FISHERIES IRELAND / NPWS / LOCAL AUTHORITY ETC.) SHOULD BE NOTIFIED IMMEDIATELY TO ENSURE THAT MEASURES CAN BE IMPLEMENTED DOWNSTREAM TO PROTECT FISHERIES AND OTHER SENSITIVE AREAS, IF REQUIRED.
- DRAINAGE NOTES:**
- ROADWAY SURFACING DESIGN AND CONSTRUCTION TO ENGINEER'S SPECIFICATION.
 - SPARE STRAW BALES/SILT FENCING/ OR SIMILAR, TO BE STORED ON SITE. THE LEVEL OF SILT IN RUNOFF DURING CONSTRUCTION IS TO BE MONITORED VISUALLY AND EXCESSIVE SILT LEVELS IN ANY AREA TO BE TEMPORARILY MANAGED BY PLACING SILT FENCES, STRAW BALES / OR SIMILAR OR ADDITIONAL CHECK DAMS AT THE PROBLEM AREAS.
 - SUDS SYSTEM TO BE CONSTRUCTED PRIOR TO, OR AT THE SAME TIME AS THE ACCESS TRACKS. INTERIM MEASURES SUCH AS THE PLACEMENT OF STRAW BALES/SILT FENCING/OR SIMILAR APPROVED METHOD OR ADDITIONAL CHECK DAMS AND SILT FENCES TO BE EMPLOYED IN ALL INSTANCES WHERE WORK CARRIES RISK TO CONSTRUCT THE ACCESS TRACKS IS LIKELY TO CAUSE ADVERSE ENVIRONMENTAL EFFECTS THROUGH INCREASED SILT LOADINGS BEING GENERATED DURING THE CONSTRUCTION PHASE.
 - SUITABLE PREVENTION MEASURES SHOULD BE IN PLACE AT ALL TIMES TO PREVENT THE CONVEYANCE OF SIGNIFICANT VOLUMES OF SILT TO RECEIVING WATERCOURSES. SEE NOTES ON POLLUTION PREVENTION.
 - INTERCEPTOR SWALES / DITCHES TO BE USED TO COLLECT UPSTREAM SURFACE WATER FLOWS. REGULAR CROSS DRAINS / DISCHARGE TO FIELD DITCHES WILL BE REQUIRED TO TRANSFER / DISCHARGE SURFACE WATER IN INTERCEPTOR DRAINS TO SUITABLE FIELD DRAIN OUTFALL POINTS.
 - DRAINAGE SWALES / DITCHES TO BE EXCAVATED ADJACENT TO THE ACCESS TRACKS. REGULAR CROSS DRAINS TO BE LOCATED ALONG ACCESS TRACKS TO PREVENT EXCESSIVE VOLUMES OF WATER COLLECTING IN THE SWALES / DITCHES. LOCATIONS OF CROSS DRAINS TO BE AGREED WITH THE ENGINEER ON SITE. SURFACE WATER WILL NOT BE ALLOWED TO DISCHARGE DIRECTLY INTO EXISTING WATERCOURSES.
 - WHERE POSSIBLE, A BUFFER ZONE OF >20M TO ANY EXISTING WATERCOURSE WILL BE REQUIRED WHERE OVER LAND DISCHARGES ARE PROPOSED FROM ACCESS TRACK SWALES / DITCHES.
 - BATTERS OF ALL PROPOSED SWALES / DITCHES TO HAVE A SLOPE OF BETWEEN 1 : 1.5 TO 1 : 2 DEPENDING UPON DEPTH OF SWALE/DITCH AND WILL BE LEFT AS CUT TO RE-VEGETATE WITH LOCAL SPECIES.
 - TRACK SIDE SWALES / DITCHES TO BE SHALLOW WITH MODERATE GRADIENTS TO PREVENT SCOURING. IN STEEP AREAS CHECK DAMS SHOULD BE INSTALLED TO REDUCE FLOW VELOCITIES AND PROVIDE SOURCE CONTROL OF SILT CONTAINMENT. WHERE NECESSARY THESE HAVE BEEN DESIGNATED IN CONJUNCTION WITH SETTLEMENT PONDS AND SILT TRAPS, PRIOR TO DISCHARGE.
 - SETTLEMENT PONDS TO BE CONSTRUCTED FOR SILT REMOVAL AT TURBINE BASES AND HARD STAND AREAS. POND SIZES DEPENDS ON CATCHMENT AREA SERVED. SAMPLE POND SIZES SHOWN ON DRAWING D501.
 - STRAW BALES / OR SIMILAR AND SILT FENCES TO BE USED ALSO AROUND SPOIL HEAPS TO MITIGATE SILT RUNOFF. SILT FENCES MAY BE REMOVED WHEN SUITABLE VEGETATION COVER IS ESTABLISHED.
 - SILT FENCES TO BE PROVIDED ALONG EDGE OF EXISTING WATERCOURSE WHERE WORKS COMES WITHIN <20M OF EDGE OF ANY DITCH / EPHEMERAL CHANNELS.
 - SLOPES OF THE SWALES / DITCHES TO BE VEGETATED OR PROTECTED FROM EROSION UNTIL 'VEGETATION HAS BEEN ESTABLISHED. STRIPPED VEGETATIVE LAYER (PEAT 'SOD' OR 'SCRAW') FROM EXCAVATIONS TO BE STORED LOCALLY AND USED TO LINE SLOPES AND BASE OF SWALES / DITCHES OR LONGITUDINAL MOUNDS OF VEGETATION SWALES AT FIELD DRAIN DISCHARGE POINTS.
 - AREAS STRIPPED OF VEGETATION SHOULD BE KEPT TO A MINIMUM.
 - CLEAN STONE FLOW CONTROL CHECK DAMS TO BE MADE OF LOCALLY WON / GEOLOGICALLY SIMILAR WELL GRADED STONE. AGGREGATE SIZE FOR STONE CHECK DAMS TO BE TYPICALLY 20- 40MM CLEAN STONE. ON SLOPING SECTIONS OF THE ACCESS TRACKS, 40MM CHECK DAMS TO BE PROTECTED FROM WASHING AWAY THROUGH THE PLACEMENT OF 100M STONE ON THE DOWNHILL FACE OF THE CHECK DAM AND BY WRAPPING IN GEOTEXTILE.
 - BUILD UP OF SILT LEVELS AT CHECK DAMS TO BE REMOVED AND DISPOSED OF APPROPRIATELY. SILT LEVELS AT CHECK DAMS TO BE VISUALLY INSPECTED AS PART OF AN ONGOING DRAINAGE MAINTENANCE PROGRAMME DURING THE CONSTRUCTION PHASE. WHERE CHECK DAMS BECOME CLOGGED WITH SILT OR VEGETATION, STONE CHECK DAM TO BE REMOVED AND REPLACED SUBSEQUENT TO THE REMOVAL OF SILT.
 - SPACING AND FREQUENCY OF CHECK DAMS WILL BE DEPENDENT UPON LONGITUDINAL GRADIENT OF SWALE.
 - LOCATION OF FILTRATION CHECK DAMS (IF REQUIRED) TO BE AGREED ON SITE WITH ENGINEER. SETTLEMENT PONDS TO BE CONSTRUCTED IN A MANNER WHERE THEY MAY BE EASILY INFILLED AT A LATER DATE (POST COMPLETION OF THE TURBINE BASE AND HARDSTAND CONSTRUCTION). ONLY SUITABLE MATERIALS EXCAVATED FROM THE POND TO BE USED TO FORM PART OF THE EMBANKMENT AROUND THE POND.
 - OIL/FUEL SHOULD BE STORED WITHIN BUNDED CONTAINMENT STRUCTURES.
 - SILT BAGS WILL BE USED ON SITE AT FIELD DRAIN DISCHARGE LOCATIONS, AS NECESSARY.

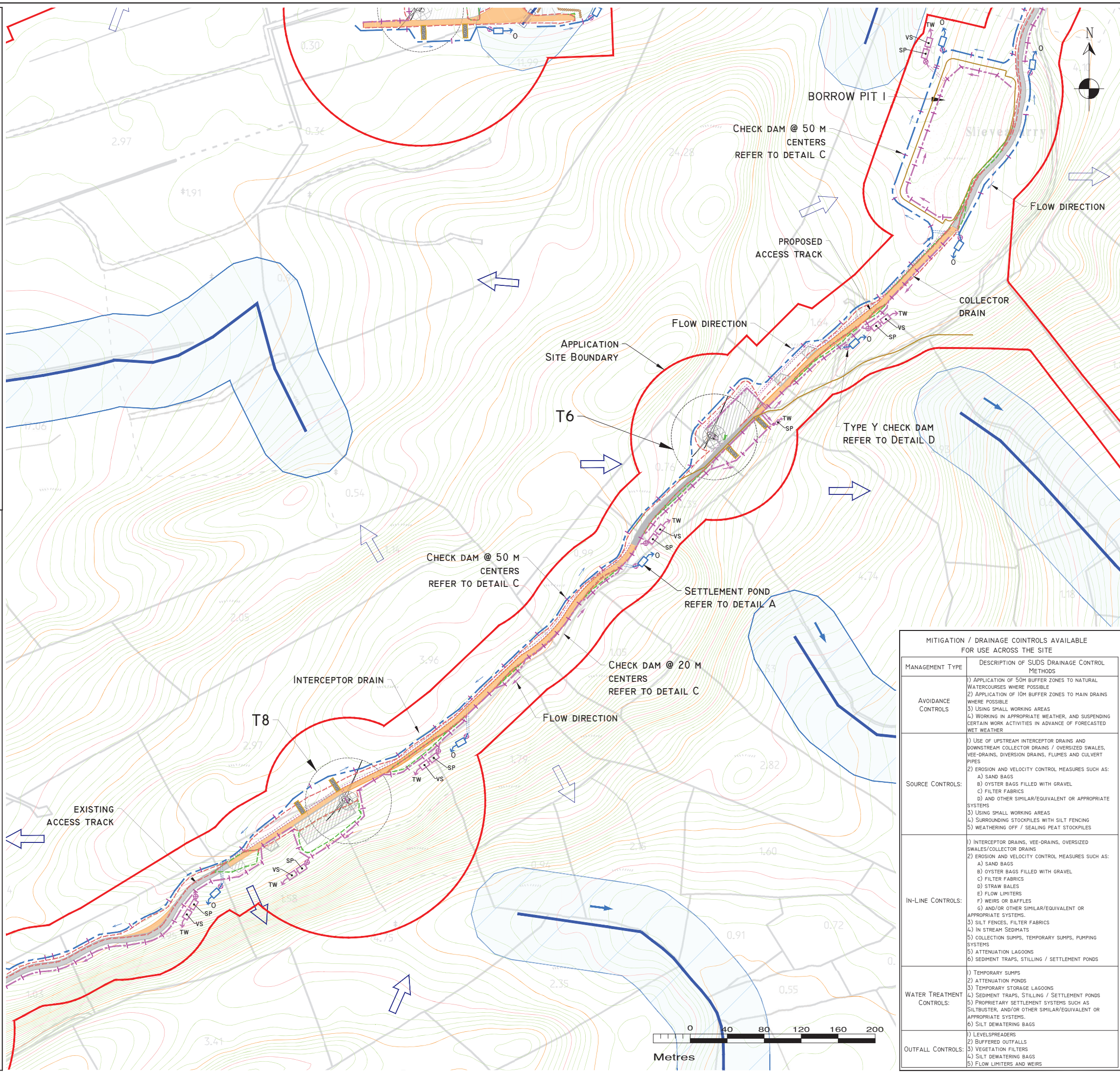

DRAWING LEGEND :

- RIVERS/STREAMS
- RIVERS/STREAMS 50M BUFFER
- RIVER/STREAM FLOW DIRECTION
- DRAINAGE FLOW/RUNOFF DIRECTION/GROUND SLOPE
- UPSTREAM INTERCEPTOR DRAIN
- SWALES/DOWNSTREAM COLLECTOR DRAIN
- DIRECTION OF FLOW
- SILT FENCES (SF)
- DOUBLE SILT FENCES (DSF)
- SETTLEMENT POND - LEVEL SPREADER
- SETTLEMENT POND - VEGETATION FILTER
- LEVEL SPREADER
- CHECK DAM 'TYPE A'
- CHECK DAM 'TYPE B'
- PROPOSED CULVERTS/BRIDGES
- INTERCEPTOR DITCH CULVERT
- COLLECTOR DITCH CULVERT
- OVERLAND FLOW DISCHARGE
- TREATED WATER DISCHARGE
- SETTLEMENT POND
- SEMI-NATURAL VEGETATION SWALE / FILTER BED /SECONDARY SP
- PUMPING SUMP
- PLANNING APPLICATION BOUNDARY
- EXISTING GROUND SURFACE MAJOR CONTOUR (10 M INTERVAL)
- EXISTING GROUND SURFACE INTERMEDIATE CONTOUR (5 M INTERVAL)
- EXISTING GROUND SURFACE MINOR CONTOUR (1 M INTERVAL)
- TURBINE AND SWEEP AREA
- TURBINE FOUNDATION
- CRANE PLATFORM
- EXISTING ROAD TO BE UPGRADED
- PROPOSED ROAD
- PUBLIC ROAD
- BORROW PIT
- CONSTRUCTION COMPOUND
- PROPOSED SUBSTATION EXTENSION
- SOFT LEVELLED AREA
- FILL AREA
- CUT AREA

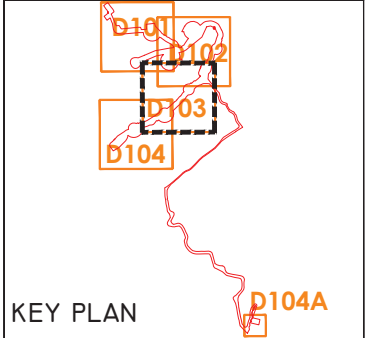

- DRAWING NOTES**
- DRAWINGS ISSUED ARE FOR PLANNING APPLICATION PURPOSES ONLY.
 - COPYRIGHT, ALL RIGHTS RESERVED. NO PART HERE WITH MAY BE COPIED OR REPRODUCED PARTIALLY OR WHOLLY IN ANY FORM WHATSOEVER WITHOUT THE PRIOR NOTICE OF THE COPYRIGHT OWNER HYDRO-ENVIRONMENTAL SERVICES.
 - DO NOT SCALE OFF THIS DRAWING. FIGURED METRIC DIMENSIONS ONLY SHOULD BE TAKEN OFF THIS DRAWING.
 - ALL DIMENSIONS ARE IN METRES.

MITIGATION / DRAINAGE CONTROLS AVAILABLE FOR USE ACROSS THE SITE

MANAGEMENT TYPE	DESCRIPTION OF SUDS DRAINAGE CONTROL METHODS
AVOIDANCE CONTROLS	<ol style="list-style-type: none"> APPLICATION OF 50M BUFFER ZONES TO NATURAL WATERCOURSES WHERE POSSIBLE APPLICATION OF 10M BUFFER ZONES TO MAIN DRAINS WHERE POSSIBLE USING SMALL WORKING AREAS WORKING IN APPROPRIATE WEATHER, AND SUSPENDING CERTAIN WORK ACTIVITIES IN ADVANCE OF FORECASTED WET WEATHER
SOURCE CONTROLS:	<ol style="list-style-type: none"> USE OF UPSTREAM INTERCEPTOR DRAINS AND DOWNSTREAM COLLECTOR DRAINS / OVERSIZED SWALES, VEE-DRAINS, DIVERSION DRAINS, FLUMES AND CULVERT PIPES EROSION AND VELOCITY CONTROL MEASURES SUCH AS: <ol style="list-style-type: none"> SAND BAGS OYSTER BAGS FILLED WITH GRAVEL FILTER FABRICS AND OTHER SIMILAR/EQUIVALENT OR APPROPRIATE SYSTEMS USING SMALL WORKING AREAS SURROUNDING STOCKPILES WITH SILT FENCING WEATHERING OFF / SEALING PEAT STOCKPILES
IN-LINE CONTROLS:	<ol style="list-style-type: none"> INTERCEPTOR DRAINS, VEE-DRAINS, OVERSIZED SWALES/COLLECTOR DRAINS EROSION AND VELOCITY CONTROL MEASURES SUCH AS: <ol style="list-style-type: none"> SAND BAGS OYSTER BAGS FILLED WITH GRAVEL FILTER FABRICS STRAW BALES FLOW LIMITERS WEIRS OR BAFFLES AND/OR OTHER SIMILAR/EQUIVALENT OR APPROPRIATE SYSTEMS. SILT FENCES, FILTER FABRICS IN STREAM SEDIMENTS COLLECTION SUMPS, TEMPORARY SUMPS, PUMPING SYSTEMS ATTENUATION LAGOONS SEDIMENT TRAPS, STILLING / SETTLEMENT PONDS
WATER TREATMENT CONTROLS:	<ol style="list-style-type: none"> TEMPORARY SUMPS ATTENUATION PONDS TEMPORARY STORAGE LAGOONS SEDIMENT TRAPS, STILLING / SETTLEMENT PONDS PROPRIETARY SETTLEMENT SYSTEMS SUCH AS SILTBUSTER, AND/OR OTHER SIMILAR/EQUIVALENT OR APPROPRIATE SYSTEMS. SILT DEWATERING BAGS
OUTFALL CONTROLS:	<ol style="list-style-type: none"> LEVELSPREADERS BUFFERED OUTFALLS VEGETATION FILTERS SILT DEWATERING BAGS FLOW LIMITERS AND WEIRS

Ordnance Survey Ireland Licence No. EN 0044720
© Ordnance Survey Ireland/Government of Ireland

Date	Description	Chkd	Signed

Revisions

HYDRO ENVIRONMENTAL SERVICES

22 Lower Main St
Dungarvan
Co. Waterford
Ireland

tel: +353 (0) 58-44122
tel: +353 (0) 58-44244
email: info@hydroenvironmental.ie
web: www.hydroenvironmental.ie

Client: **MKO**

Job: **SLIEVEACURRY RENEWABLE ENERGY DEVELOPMENT**

Title: **PROPOSED DRAINAGE LAYOUT**

Figure No: **D103**

Drawing No: P1159-4-1121-A1-D103-00B

Sheet Size: A1 Project No.: P1159-4

Scale: 1:2,000 (A1) Drawn By: GD

Date: 11/11/2021 Checked By: MG

POLLUTION PREVENTION NOTES:

- SITE MANAGEMENT PROPOSALS ARE INTENDED TO ENSURE PROTECTION AGAINST SURFACE WATER AND GROUNDWATER POLLUTION, SURFACE WATER SILTATION, AND STREAM BANK AND LAND EROSION.
 - SUITABLE DRAINAGE CONTROL MEASURES SHOULD BE IN PLACE AT ALL TIMES TO PREVENT CONVEYANCE OF SIGNIFICANT VOLUMES OF SILT TO OFF SITE RECEIVING WATERCOURSES.
 - SILTY WATER CAN ARISE FROM DEWATERING EXCAVATIONS, EROSION OF EXPOSED/DISTURBED GROUND, EROSION OF TEMPORARY STOCKPILES, PLANT AND WHEEL WASH WATER, RUNOFF FROM SITE ROADS/TRACKS, AND DISTURBANCE OF EXISTING FIELD DRAINS AND DITCHES.
- DISCHARGES**
- WATER CONTAINING SILT WILL NOT BE PUMPED DIRECTLY TO ANY NATURAL WATERCOURSE. ALL DISCHARGES TO BE MADE OVER OPEN GROUND OR INTO EXISTING FIELD DRAIN WITH SILT TRAP A MINIMUM 20M FROM NEAREST WATERCOURSE UNLESS OTHERWISE STATED.
 - NO EXCAVATED MATERIAL IS TO BE STORED WITHIN ANY SURFACE WATER BUFFER ZONE.
 - PUMPED WATER WILL BE DIRECTED INTO TRACK SIDE DITCHES AND TREATED IN SETTLEMENT PONDS AND VEGETATION SWALES PRIOR TO OVERLAND DISCHARGE.
 - PUMPING OF CLEAN WATER FROM EXCAVATIONS / OR OVER-PUMPING INTO FIELD DRAINS/DITCHES/STREAMS WILL BE COMPLETED IN A MANNER THAT DOES NOT CAUSE SCOUR OR EROSION AT THE POINT OF RELEASE/DISCHARGE. THIS WILL BE DONE BY REDUCING THE FLOW VELOCITIES OR BY USE OF SPLASH FLATES, AND OTHER SIMILAR DISCHARGE CONTROLS.
 - VEGETATION WILL NOT BE STRIPPED FROM EXISTING FIELD DRAINS/DITCHES UNLESS ABSOLUTELY NECESSARY.
- EXCAVATIONS**
- WHERE DEEP EXCAVATIONS ARE PROPOSED CUT-OFF DRAINS WILL BE USED TO REDUCE THE AMOUNT OF SURFACE WATER ENTERING THE EXCAVATION. THIS WILL BE THE CASE AROUND TURBINE BASE EXCAVATIONS.
- EXPOSED GROUND & STOCKPILES**
- THE AMOUNT OF EXPOSED GROUND AND TEMPORARY STOCKPILES OPEN AT ANY ONE TIME WILL BE MINIMISED, AS FAR AS PRACTICABLE.
- SITE TRACKS**
- USE OF TRACK SIDE SWALES WITH CHECK DAMS, AND/OR FILTRATION CHECK DAMS WILL REDUCE SILT IN RUNOFF WATER AS REQUIRED.
 - CHECK DAMS TO BE INSPECTED AND CLEANED REGULARLY.
- REFUELLING**
- REFUELLING WILL BE COMPLETED IN LINE WITH CEMP REQUIREMENTS AND AWAY FROM FIELD DRAINS / DITCHES AND WATERCOURSES / WATERBODIES.
 - SPILL KITS AND DRIP TRAYS WILL BE AVAILABLE ON SITE FOR USE AS REQUIRED.
- CONCRETE**
- CARE WILL BE TAKEN WHEN COMPLETING CONCRETE WORKS ON SITE TO ENSURE NO DISCHARGES OF CONCRETE OR WASH WATER OCCURS.
 - CONCRETE WASH WATER, AND WASTE CONCRETE WILL BE MANAGED APPROPRIATELY ON SITE.
- IF WATER POLLUTION IS IDENTIFIED THE FOLLOWING STEPS WOULD BE ADHERED TO:**
- STOP** - WORK IN THE IMMEDIATE AREA SHOULD BE STOPPED AND THE SOURCE OF THE POLLUTION IDENTIFIED.
- CONTAIN** - THE SOURCE OF THE POLLUTION SHOULD BE BUNDED USING A SUITABLE METHOD. NATURAL WATERCOURSES SHOULD BE TEMPORARILY DIVERTED AROUND THE SOURCE OF POLLUTION.
- NOTIFY** - THE RELEVANT AUTHORITIES (SITE MANAGER / INLAND FISHERIES IRELAND / NPWS / LOCAL AUTHORITY ETC.) SHOULD BE NOTIFIED IMMEDIATELY TO ENSURE THAT MEASURES CAN BE IMPLEMENTED DOWNSTREAM TO PROTECT FISHERIES AND OTHER SENSITIVE AREAS, IF REQUIRED.

- DRAINAGE NOTES:**
- ROADWAY SURFACING DESIGN AND CONSTRUCTION TO ENGINEER'S SPECIFICATION.
 - SPARE STRAW BALES/SILT FENCING/ OR SIMILAR, TO BE STORED ON SITE. THE LEVEL OF SILT IN RUNOFF DURING CONSTRUCTION IS TO BE MONITORED VISUALLY AND EXCESSIVE SILT LEVELS IN ANY AREA TO BE TEMPORARILY MANAGED BY PLACING SILT FENCES, STRAW BALES / OR SIMILAR OR ADDITIONAL CHECK DAMS AT THE PROBLEM AREAS.
 - SUDS SYSTEM TO BE CONSTRUCTED PRIOR TO, OR AT THE SAME TIME AS THE ACCESS TRACKS. INTERIM MEASURES SUCH AS THE PLACEMENT OF STRAW BALES/SILT FENCING/OR SIMILAR APPROVED METHOD OR ADDITIONAL CHECK DAMS AND SILT FENCES TO BE EMPLOYED IN ALL INSTANCES WHERE WORK CARRIES OUT TO CONSTRUCT THE ACCESS TRACKS IS LIKELY TO CAUSE ADVERSE ENVIRONMENTAL EFFECTS THROUGH INCREASED SILT LOADINGS BEING GENERATED DURING THE CONSTRUCTION PHASE.
 - SUITABLE PREVENTION MEASURES SHOULD BE IN PLACE AT ALL TIMES TO PREVENT THE CONVEYANCE OF SIGNIFICANT VOLUMES OF SILT TO RECEIVING WATERCOURSES. SEE NOTES ON POLLUTION PREVENTION.
 - INTERCEPTOR SWALES / DITCHES TO BE USED TO COLLECT UPSTREAM SURFACE WATER FLOWS. REGULAR CROSS DRAINS / DISCHARGE TO FIELD DITCHES WILL BE REQUIRED TO TRANSFER / DISCHARGE SURFACE WATER IN INTERCEPTOR DRAINS TO SUITABLE FIELD DRAIN OUTFALL POINTS.
 - DRAINAGE SWALES / DITCHES TO BE EXCAVATED ADJACENT TO THE ACCESS TRACKS. REGULAR CROSS DRAINS TO BE LOCATED ALONG ACCESS TRACKS TO PREVENT EXCESSIVE VOLUMES OF WATER COLLECTING IN THE SWALES / DITCHES. LOCATIONS OF CROSS DRAINS TO BE AGREED WITH THE ENGINEER ON SITE. SURFACE WATER WILL NOT BE ALLOWED TO DISCHARGE DIRECTLY INTO EXISTING WATERCOURSES.
 - WHERE POSSIBLE, A BUFFER ZONE OF >20M TO ANY EXISTING WATERCOURSE WILL BE REQUIRED WHERE OVER LAND DISCHARGES ARE PROPOSED FROM ACCESS TRACK SWALES / DITCHES.
 - BATTERS OF ALL PROPOSED SWALES / DITCHES TO HAVE A SLOPE OF BETWEEN 1 : 1.5 TO 1 : 2 DEPENDING UPON DEPTH OF SWALE/DITCH AND WILL BE LEFT AS CUT TO RE-VEGETATE WITH LOCAL SPECIES.
 - TRACK SIDE SWALES / DITCHES TO BE SHALLOW WITH MODERATE GRADIENTS TO PREVENT SCOURING. IN STEEP AREAS CHECK DAMS SHOULD BE INSTALLED TO REDUCE FLOW VELOCITIES AND PROVIDE SOURCE CONTROL OF SILT CONTAINMENT. WHERE NECESSARY THESE HAVE BEEN DESIGNATED IN CONJUNCTION WITH SETTLEMENT PONDS AND SILT TRAPS, PRIOR TO DISCHARGE.
 - SETTLEMENT PONDS TO BE CONSTRUCTED FOR SILT REMOVAL AT TURBINE BASES AND HARD STAND AREAS. POND SIZES DEPENDS ON CATCHMENT AREA SERVED. SAMPLE POND SIZES SHOWN ON DRAWING D501.
 - STRAW BALES / OR SIMILAR AND SILT FENCES TO BE USED ALSO AROUND SPOIL HEAPS TO MITIGATE SILT RUNOFF. SILT FENCES MAY BE REMOVED WHEN SUITABLE VEGETATION COVER IS ESTABLISHED.
 - SILT FENCES TO BE PROVIDED ALONG EDGE OF EXISTING WATERCOURSE WHERE WORKS COMES WITHIN <20M OF EDGE OF ANY DITCH / EPHEMERAL CHANNELS.
 - SLOPES OF THE SWALES / DITCHES TO BE VEGETATED OR PROTECTED FROM EROSION UNTIL VEGETATION HAS BEEN ESTABLISHED. STRIPPED VEGETATIVE LAYER (PEAT 'SOD' OR 'SCRAW') FROM EXCAVATIONS TO BE STORED LOCALLY AND USED TO LINE SLOPES AND BASE OF SWALES / DITCHES OR LONGITUDINAL MOUNDS OF VEGETATION SWALES AT FIELD DRAIN DISCHARGE POINTS.
 - AREAS STRIPPED OF VEGETATION SHOULD BE KEPT TO A MINIMUM.
 - CLEAN STONE FLOW CONTROL CHECK DAMS TO BE MADE OF LOCALLY WON / GEOLOGICALLY SIMILAR WELL GRADED STONE. AGGREGATE SIZE FOR STONE CHECK DAMS TO BE TYPICALLY 20- 40MM CLEAN STONE. ON SLOPING SECTIONS OF THE ACCESS TRACKS, 40mm CHECK DAMS TO BE PROTECTED FROM WASHING AWAY THROUGH THE PLACEMENT OF 100mm STONE ON THE DOWNHILL FACE OF THE CHECK DAM AND BY WRAPPING IN GEOTEXTILE.
 - BUILD UP OF SILT LEVELS AT CHECK DAMS TO BE REMOVED AND DISPOSED OF APPROPRIATELY. SILT LEVELS AT CHECK DAMS TO BE VISUALLY INSPECTED AS PART OF AN ONGOING DRAINAGE MAINTENANCE PROGRAMME DURING THE CONSTRUCTION PHASE. WHERE CHECK DAMS BECOME CLOGGED WITH SILT OR VEGETATION, STONE CHECK DAM TO BE REMOVED AND REPLACED SUBSEQUENT TO THE REMOVAL OF SILT.
 - SPACING AND FREQUENCY OF CHECK DAMS WILL BE DEPENDENT UPON LONGITUDINAL GRADIENT OF SWALE.
 - LOCATION OF FILTRATION CHECK DAMS (IF REQUIRED) TO BE AGREED ON SITE WITH ENGINEER. SETTLEMENT PONDS TO BE CONSTRUCTED IN A MANNER WHERE THEY MAY BE EASILY INFILLED AT A LATER DATE (POST COMPLETION OF THE TURBINE BASE AND HARDSTAND CONSTRUCTION). ONLY SUITABLE MATERIALS EXCAVATED FROM THE POND TO BE USED TO FORM PART OF THE EMBANKMENT AROUND THE POND.
 - OIL/FUEL SHOULD BE STORED WITHIN BUNDED CONTAINMENT STRUCTURES.
 - SILT BAGS WILL BE USED ON SITE AT FIELD DRAIN DISCHARGE LOCATIONS, AS NECESSARY.

MITIGATION / DRAINAGE CONTROLS AVAILABLE FOR USE ACROSS THE SITE	
MANAGEMENT TYPE	DESCRIPTION OF SUDS DRAINAGE CONTROL METHODS
AVOIDANCE CONTROLS	1) APPLICATION OF 50M BUFFER ZONES TO NATURAL WATERCOURSES WHERE POSSIBLE 2) APPLICATION OF 10M BUFFER ZONES TO MAIN DRAINS WHERE POSSIBLE 3) USING SMALL WORKING AREAS 4) WORKING IN APPROPRIATE WEATHER, AND SUSPENDING CERTAIN WORK ACTIVITIES IN ADVANCE OF FORECASTED WET WEATHER
SOURCE CONTROLS	1) USE OF UPSTREAM INTERCEPTOR DRAINS AND DOWNSTREAM COLLECTOR DRAINS / OVERSIZED SWALES, VEE-DRAINS, DIVERSION DRAINS, FLUMES AND CULVERT PIPES 2) EROSION AND VELOCITY CONTROL MEASURES SUCH AS: A) SAND BAGS B) OYSTER BAGS FILLED WITH GRAVEL C) FILTER FABRICS D) AND OTHER SIMILAR/EQUIVALENT OR APPROPRIATE SYSTEMS 3) USING SMALL WORKING AREAS 4) SURROUNDING STOCKPILES WITH SILT FENCING 5) WEATHERING OFF / SEALING PEAT STOCKPILES
IN-LINE CONTROLS	1) INTERCEPTOR DRAINS, VEE-DRAINS, OVERSIZED SWALES/COLLECTOR DRAINS 2) EROSION AND VELOCITY CONTROL MEASURES SUCH AS: A) SAND BAGS B) OYSTER BAGS FILLED WITH GRAVEL C) FILTER FABRICS D) STRAW BALES E) FLOW LIMITERS F) WEIRS OR BAFFLES G) AND/OR OTHER SIMILAR/EQUIVALENT OR APPROPRIATE SYSTEMS. 3) SILT FENCES, FILTER FABRICS 4) IN STREAM SEDIMENTS 5) COLLECTION SUMPS, TEMPORARY SUMPS, PUMPING SYSTEMS 6) ATTENUATION LAGOONS 7) SEDIMENT TRAPS, STILLING / SETTLEMENT PONDS
WATER TREATMENT CONTROLS	1) TEMPORARY SUMPS 2) ATTENUATION PONDS 3) TEMPORARY STORAGE LAGOONS 4) SEDIMENT TRAPS, STILLING / SETTLEMENT PONDS 5) PROPRIETARY SETTLEMENT SYSTEMS SUCH AS SILTBUSTER, AND/OR OTHER SIMILAR/EQUIVALENT OR APPROPRIATE SYSTEMS. 6) SILT DEWATERING BAGS
OUTFALL CONTROLS	1) LEVELSPREADERS 2) BUFFERED OUTFALLS 3) VEGETATION FILTERS 4) SILT DEWATERING BAGS 5) FLOW LIMITERS AND WEIRS

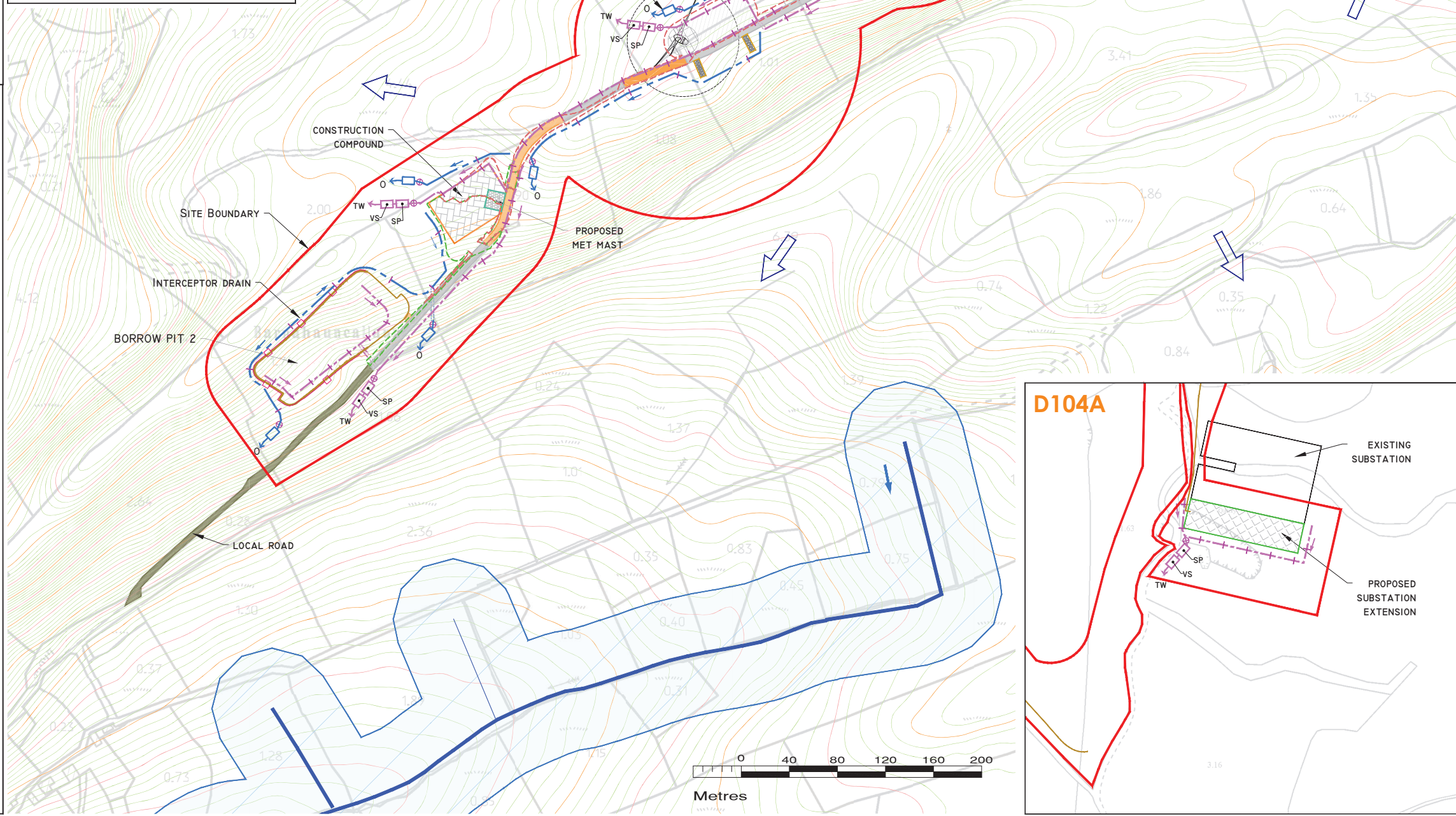

DRAWING LEGEND:

- RIVERS/STREAMS
- RIVERS/STREAMS 50M BUFFER
- RIVER/STREAM FLOW DIRECTION
- DRAINAGE FLOW/RUNOFF DIRECTION/GROUND SLOPE
- UPSTREAM INTERCEPTOR DRAIN
- SWALES/DOWNSTREAM COLLECTOR DRAIN
- DIRECTION OF FLOW
- SILT FENCES (SF)
- DOUBLE SILT FENCES (DSF)
- SETTLEMENT POND - LEVEL SPREADER
- SETTLEMENT POND - VEGETATION FILTER - LEVEL SPREADER
- CHECK DAM 'TYPE A'
- CHECK DAM 'TYPE B'
- PROPOSED CULVERTS/BRIDGES
- INTERCEPTOR DITCH CULVERT
- COLLECTOR DITCH CULVERT
- OVERLAND FLOW DISCHARGE
- TREATED WATER DISCHARGE
- SETTLEMENT POND
- SEMI-NATURAL VEGETATION SWALE / FILTER BED / SECONDARY SP
- PUMPING SUMP

EXISTING DRAINAGE

- PLANNING APPLICATION BOUNDARY
- EXISTING GROUND SURFACE
- MAJOR CONTOUR (10 M INTERVAL)
- EXISTING GROUND SURFACE
- INTERMEDIATE CONTOUR (5 M INTERVAL)
- EXISTING GROUND SURFACE
- MINOR CONTOUR (1 M INTERVAL)
- TURBINE AND SWEEP AREA
- TURBINE FOUNDATION
- CRANE PLATFORM
- EXISTING ROAD TO BE UPGRADED
- PROPOSED ROAD
- PUBLIC ROAD
- BORROW PIT
- CONSTRUCTION COMPOUND
- PROPOSED SUBSTATION EXTENSION
- SOFT LEVELLED AREA
- FILL AREA
- CUT AREA

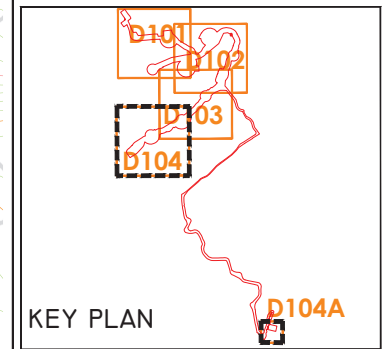

- DRAWING NOTES**
- DRAWINGS ISSUED ARE FOR PLANNING APPLICATION PURPOSES ONLY.
 - COPYRIGHT, ALL RIGHTS RESERVED. NO PART HERE WITH MAY BE COPIED OR REPRODUCED PARTIALLY OR WHOLLY IN ANY FORM WHATSOEVER WITHOUT THE PRIOR NOTICE OF THE COPYRIGHT OWNER HYDRO-ENVIRONMENTAL SERVICES.
 - DO NOT SCALE OFF THIS DRAWING. FIGURED METRIC DIMENSIONS ONLY SHOULD BE TAKEN OFF THIS DRAWING.
 - ALL DIMENSIONS ARE IN METRES.

Ordnance Survey Ireland Licence No. EN 0044720
© Ordnance Survey Ireland/Government of Ireland

Date	Description	Chkd	Signed

Revisions

HYDRO ENVIRONMENTAL SERVICES

22 Lower Main St
Dunganan
Co. Waterford
Ireland

tel: +353 (0) 58-44122
tel: +353 (0) 58-44244
email: info@hydroenvironmental.ie
web: www.hydroenvironmental.ie

Client: MKO

Job: SLIEVEACURRY RENEWABLE ENERGY DEVELOPMENT

Title: PROPOSED DRAINAGE LAYOUT

Figure No: D104

Drawing No: P1159-4-1121-A1-D104-00B
Sheet Size: A1
Scale: 1:2,000 (A1)
Date: 11/11/2021

Project No.: P1159-4
Drawn By: GD
Checked By: MG

PROJECT DESIGN DRAWING NOTES
 1. DRAWINGS ISSUED ARE FOR PLANNING STAGE ONLY.
 2. COPYRIGHT, ALL RIGHTS RESERVED. NO PART HERE WITH MAY BE COPIED OR REPRODUCED PARTIALLY OR WHOLLY IN ANY FORM WHATSOEVER WITHOUT THE PRIOR NOTICE OF THE COPYRIGHT OWNER HYDRO-ENVIRONMENTAL SERVICES.
 3. DO NOT SCALE OFF THIS DRAWING. FIGURED METRIC DIMENSIONS ONLY SHOULD BE TAKEN OFF THIS DRAWING.

DETAIL A1

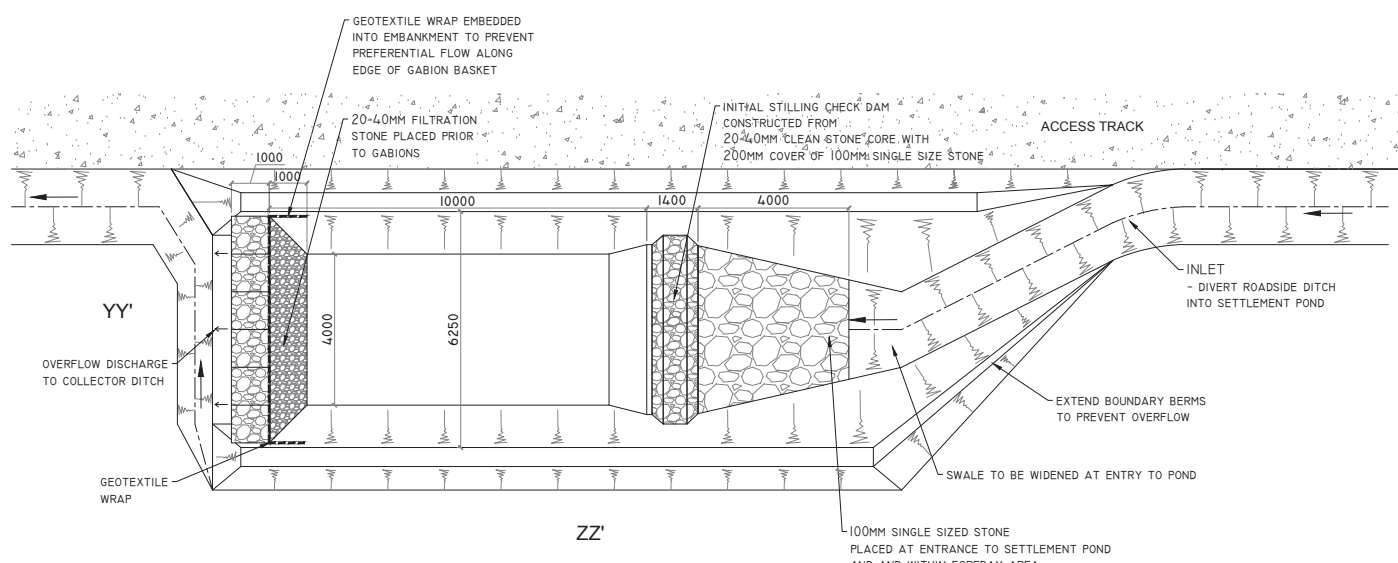

TYPE A - TYPICAL ROAD SIDE SETTLEMENT POND DETAIL
 SCALE 1:200 (NOTE DIMENSIONS VARY DEPENDING ON CATCHMENT SIZE - SEE ATTACHED TABLE)

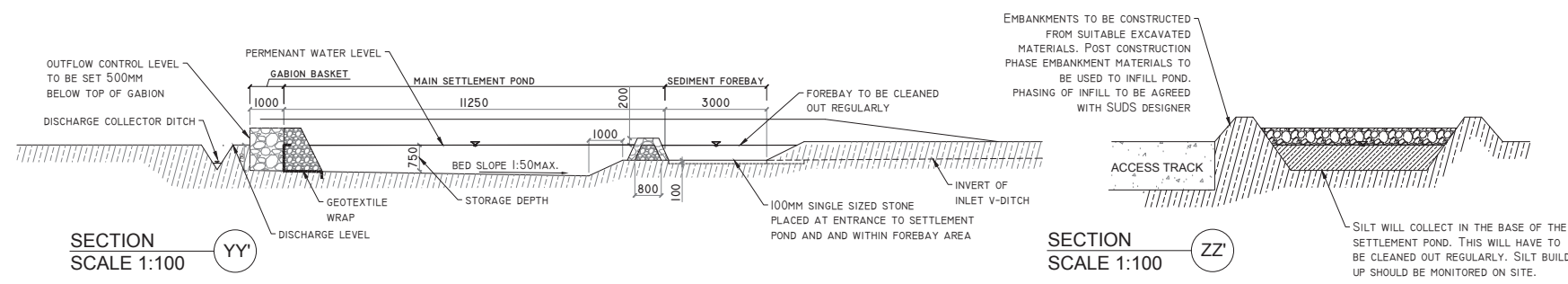

SECTION YY'
 SCALE 1:100

SECTION ZZ'
 SCALE 1:100

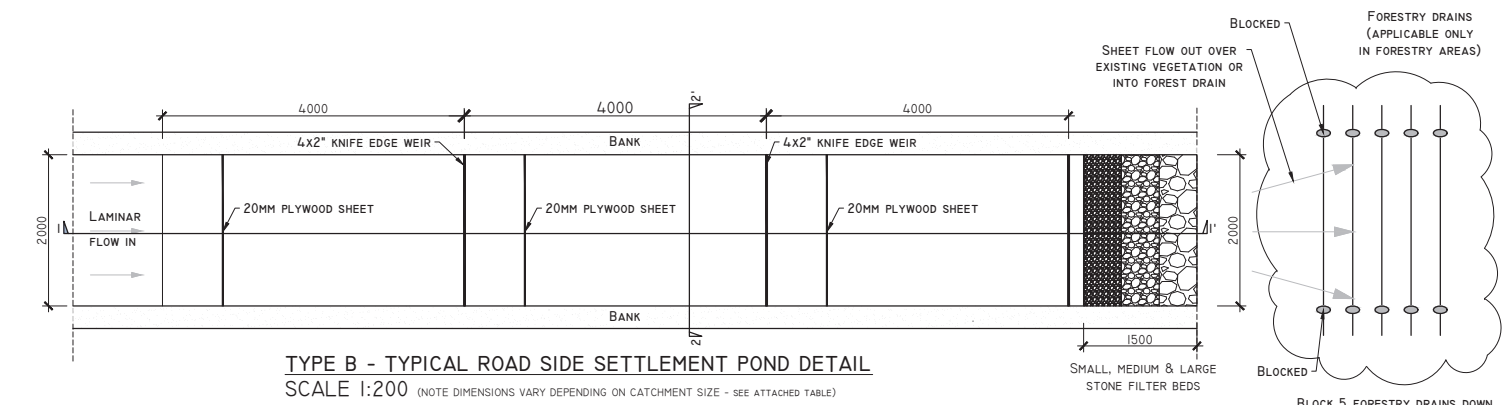

TYPE B - TYPICAL ROAD SIDE SETTLEMENT POND DETAIL
 SCALE 1:200 (NOTE DIMENSIONS VARY DEPENDING ON CATCHMENT SIZE - SEE ATTACHED TABLE)

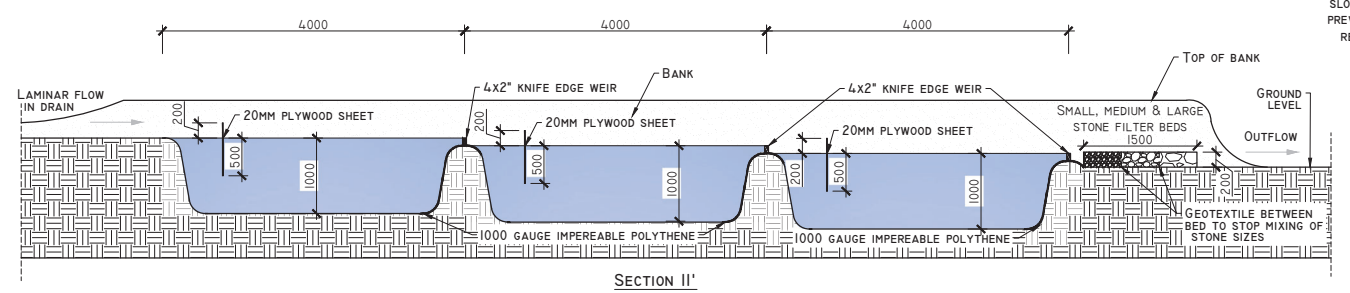

SECTION II'

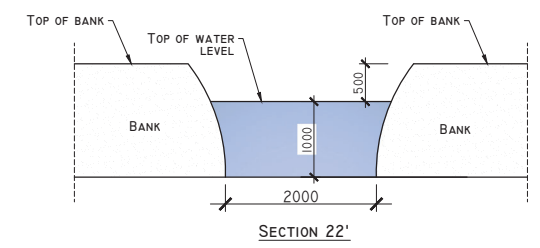

SECTION 22'

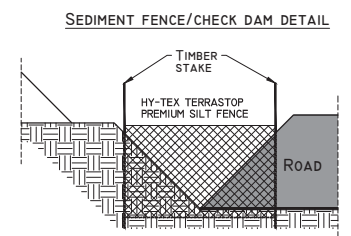

SEDIMENT FENCE/CHECK DAM DETAIL

DETAIL A2

Date	Description	Chkd	Signed

HYDRO ENVIRONMENTAL SERVICES
 22 Lower Main St
 Dunganan
 Co. Waterford
 Ireland

tel: +353 (0) 58 44122
 tel: +353 (0) 58 44244
 email: info@hydroenvironmental.ie
 web: www.hydroenvironmental.ie

Client: MKO

Job: SLIEVEACURRY RENEWABLE ENERGY DEVELOPMENT

Title: DRAINAGE DETAILS I

Figure No: D501

Drawing No: P1159-4-1121-A1-D501-00B

Sheet Size: A1 Project No.: P1159-4

Scale: as shown (A1) Drawn By: MG/GD

Date: 11/11/2021 Checked By: M.G.

DETAIL B

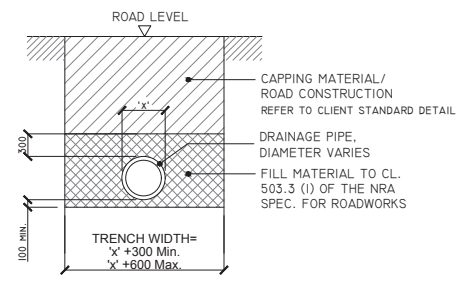

'TYPE A' CULVERT - DRAINAGE CROSSING BENEATH EXCAVATED ROAD
SCALE 1:50

DETAIL BI

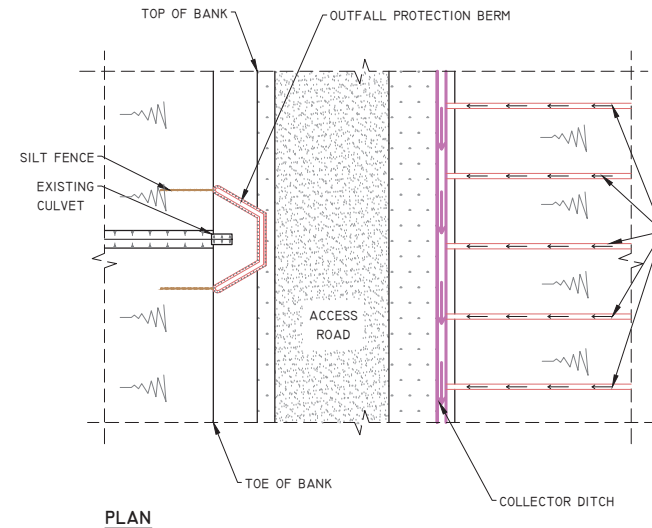

PLAN

CULVERT - OUTFALL PROTECTION DETAIL
SCHEMATIC - NOT TO SCALE

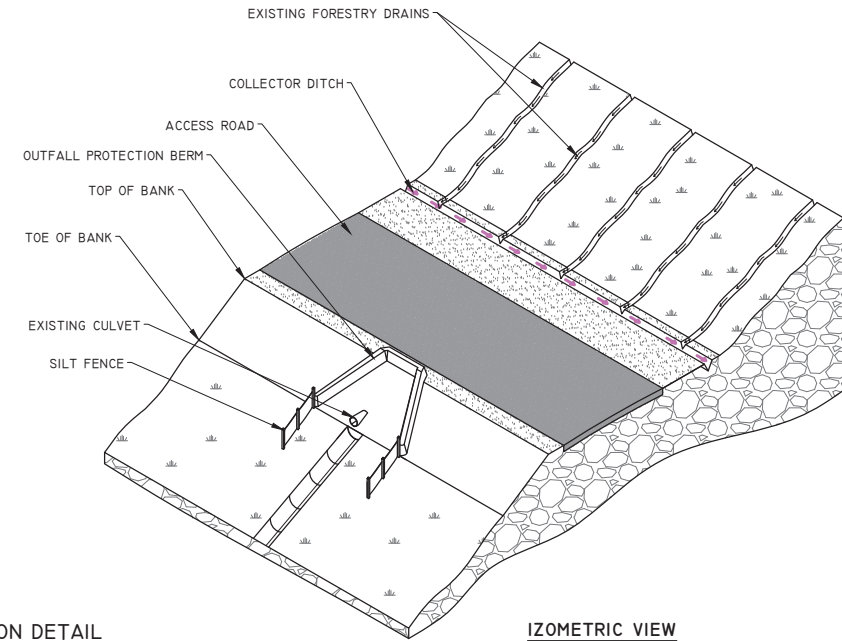

IZOMETRIC VIEW

DETAIL C

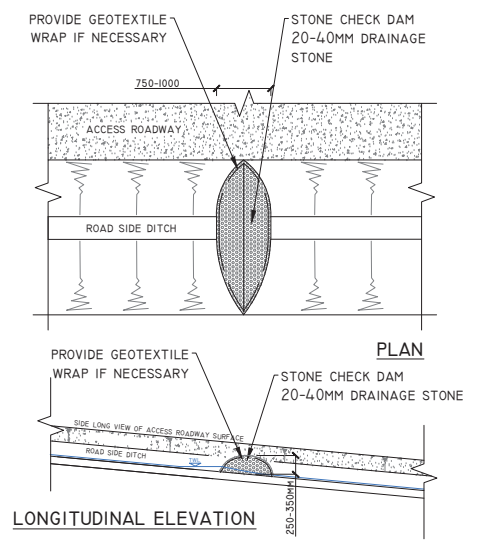

TYPE X - CHECK DAM DETAIL
SCALE 1:50

DETAIL D

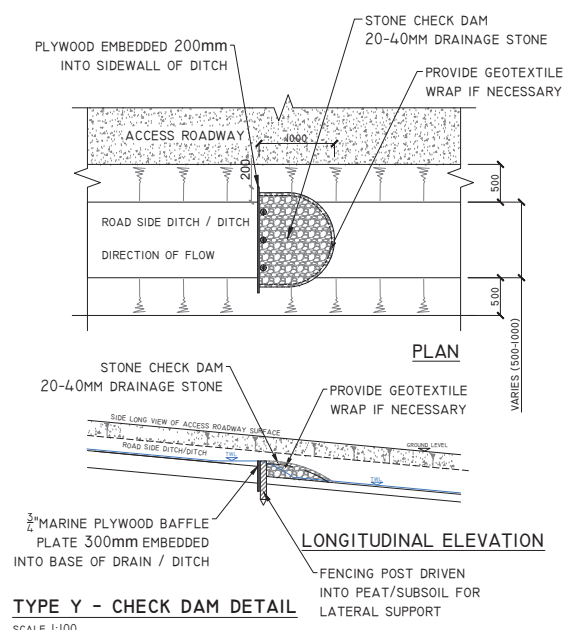

TYPE Y - CHECK DAM DETAIL
SCALE 1:100

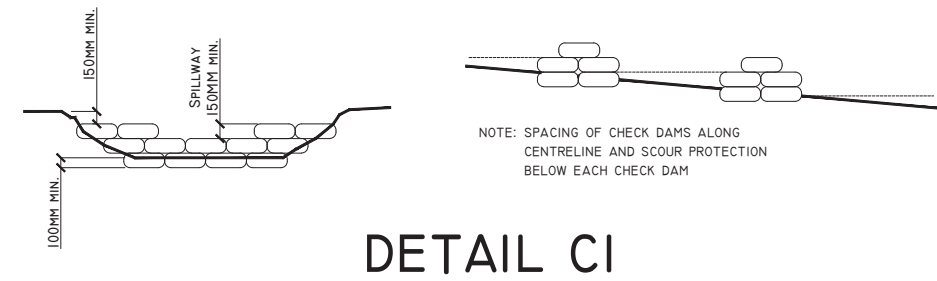

DETAIL CI

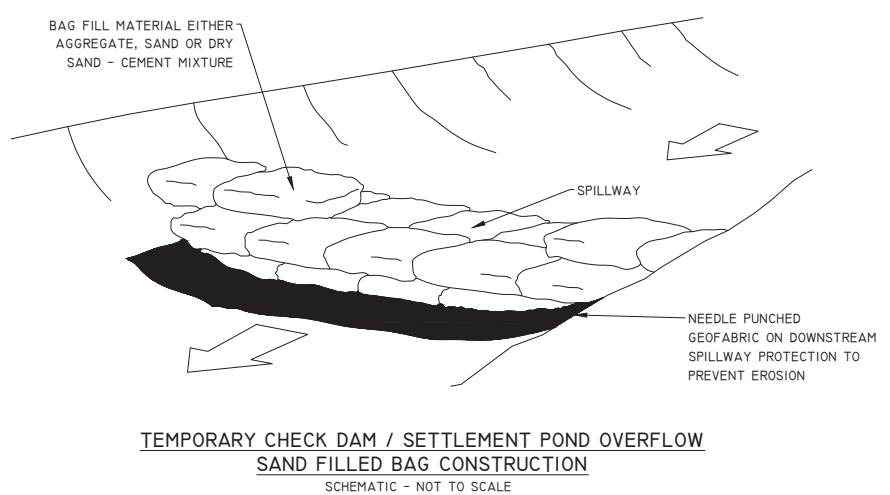

TEMPORARY CHECK DAM / SETTLEMENT POND OVERFLOW
SAND FILLED BAG CONSTRUCTION
SCHEMATIC - NOT TO SCALE

DETAIL C2

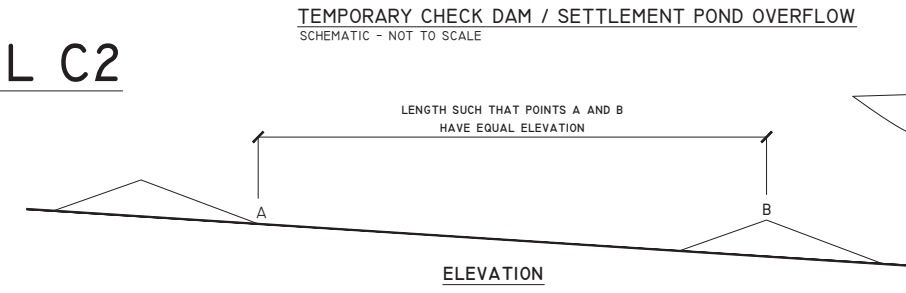

TEMPORARY CHECK DAM / SETTLEMENT POND OVERFLOW
SCHEMATIC - NOT TO SCALE

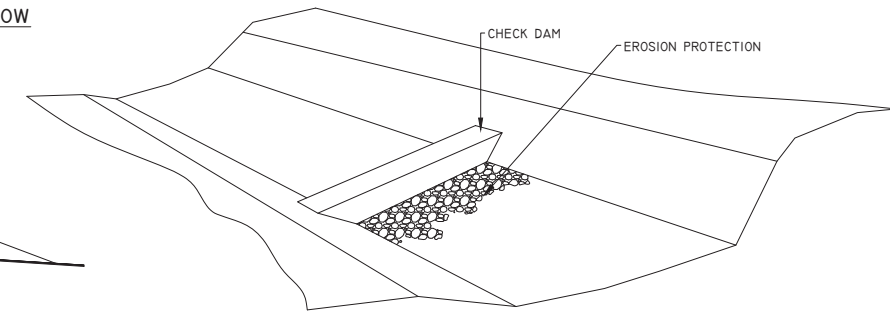

PROJECT DESIGN DRAWING NOTES
1. DRAWINGS ISSUED ARE FOR PLANNING STAGE ONLY.
2. COPYRIGHT, ALL RIGHTS RESERVED. NO PART HERE WITH MAY BE COPIED OR REPRODUCED PARTIALLY OR WHOLLY IN ANY FORM WHATSOEVER WITHOUT THE PRIOR NOTICE OF THE COPYRIGHT OWNER HYDRO-ENVIRONMENTAL SERVICES.
3. DO NOT SCALE OFF THIS DRAWING. FIGURED METRIC DIMENSIONS ONLY SHOULD BE TAKEN OFF THIS DRAWING.

Date	Description	Chkd	Signed

Revisions

HYDRO ENVIRONMENTAL SERVICES
22 Lower Main St
Dungannon
Co. Waterford
Ireland

tel: +353 (0) 58 441722
tel: +353 (0) 58 44244
email: info@hydroenvironmental.ie
web: www.hydroenvironmental.ie

Client: MKO

Job: SLIEVEACURRY RENEWABLE ENERGY DEVELOPMENT

Title: DRAINAGE DETAILS 2

Figure No: D502

Drawing No: P1159-4-1121-A1-D502-00B
Sheet Size: A1 Project No.: P1159-4
Scale: as shown (A1) Drawn By: MG/GD
Date: 11/11/2021 Checked By: M.G.

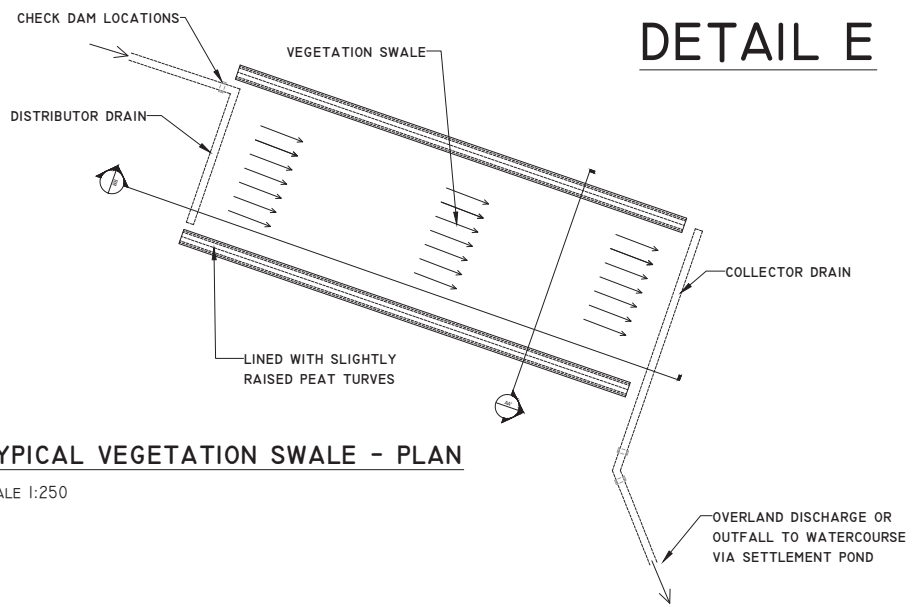

TYPICAL VEGETATION SWALE - PLAN

SCALE 1:250

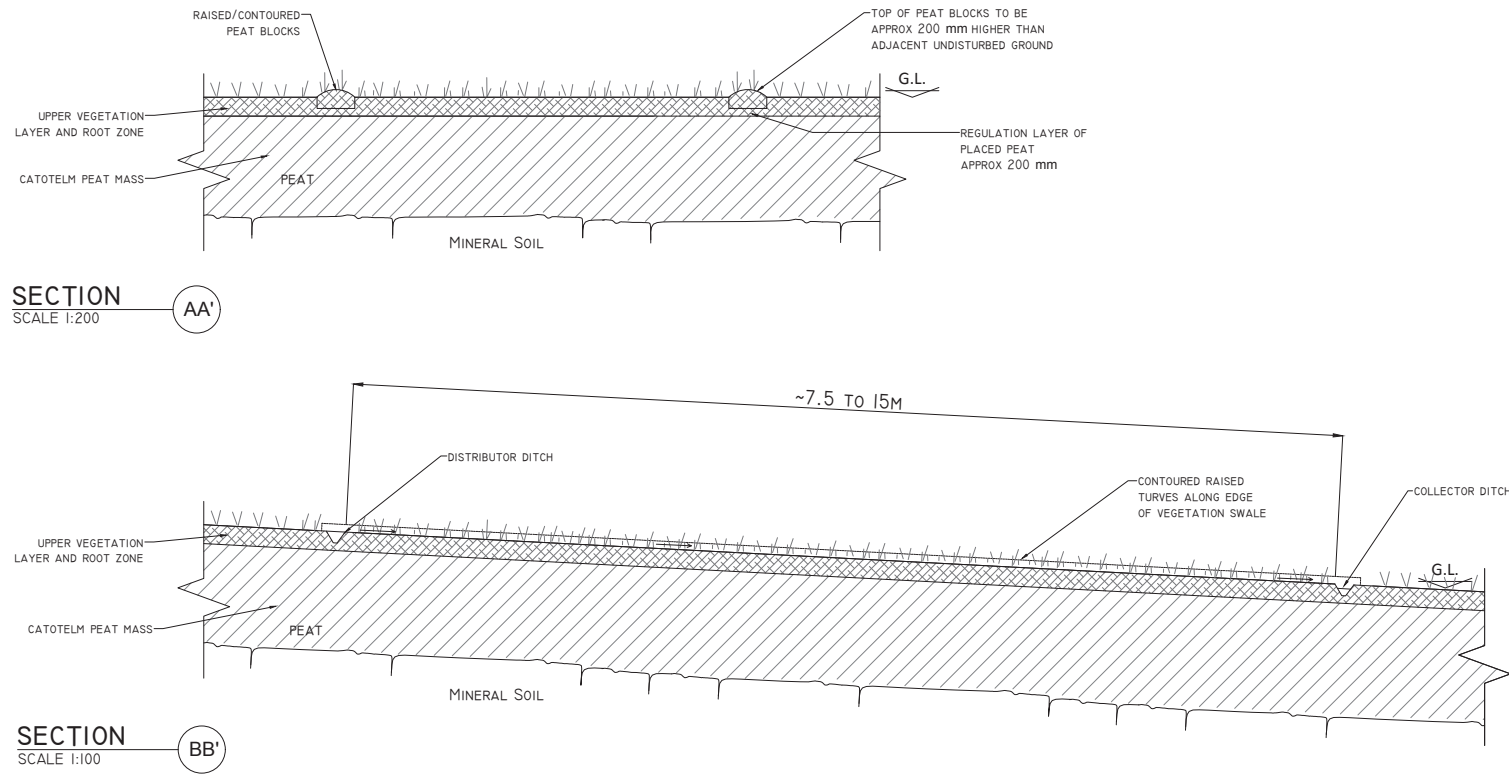

SECTION AA'
SCALE 1:200

SECTION BB'
SCALE 1:100

DETAIL F-I

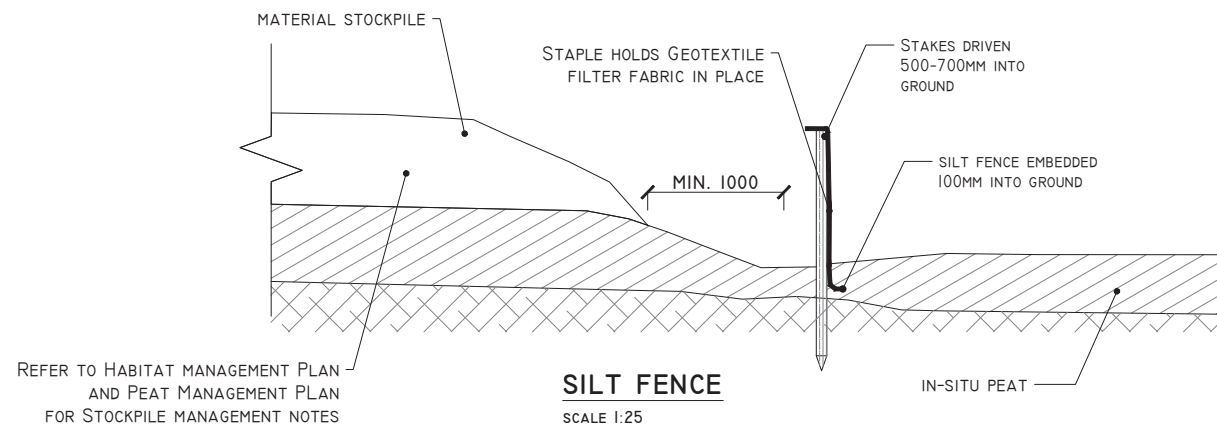

SILT FENCE

SCALE 1:25

DETAIL G

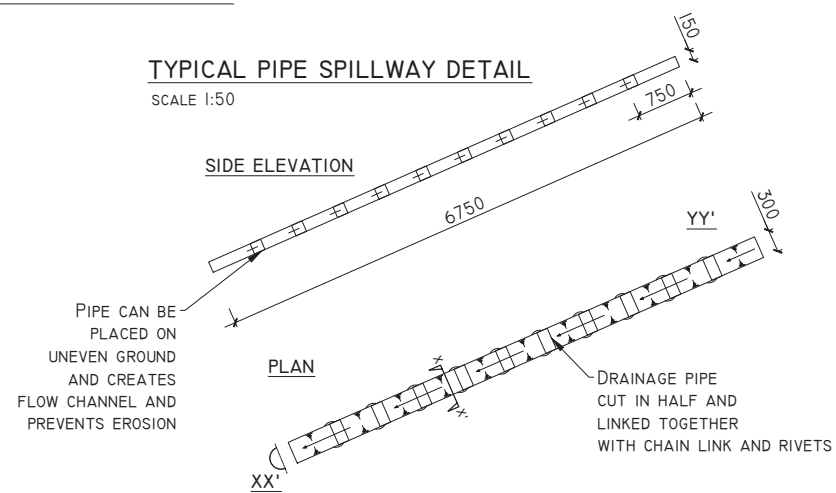

TYPICAL PIPE SPILLWAY DETAIL

SCALE 1:50

DETAIL F-II

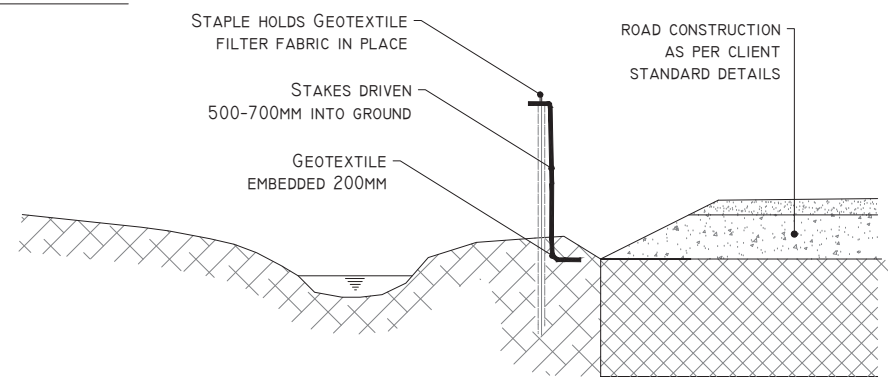

SILT FENCE FOR WATERCOURSE PROTECTION

SCALE 1:25

TYPICAL PIPE SPILLWAY DETAIL

SCHEMATIC - NOT TO SCALE

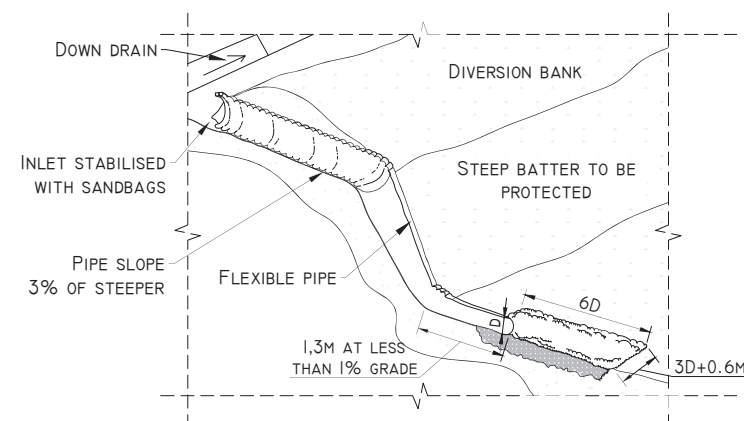

PROJECT DESIGN DRAWING NOTES
1. DRAWINGS ISSUED ARE FOR PLANNING STAGE ONLY.
2. COPYRIGHT, ALL RIGHTS RESERVED. NO PART HERE WITH MAY BE COPIED OR REPRODUCED PARTIALLY OR WHOLLY IN ANY FORM WHATSOEVER WITHOUT THE PRIOR NOTICE OF THE COPYRIGHT OWNER HYDRO-ENVIRONMENTAL SERVICES.
3. DO NOT SCALE OFF THIS DRAWING. FIGURED METRIC DIMENSIONS ONLY SHOULD BE TAKEN OFF THIS DRAWING.

Date	Description	Chkd	Signed
Revisions			

22 Lower Main St
Dungannon
Co. Waterford
Ireland

tel: +353 (0) 58 44122
tel: +353 (0) 58 44244
email: info@hydroenvironmental.ie
web: www.hydroenvironmental.ie

Client: MKO

Job: SLIEVEACURRY RENEWABLE ENERGY DEVELOPMENT

Title: DRAINAGE DETAILS 3

Figure No: D503

Drawing No: P1159-4-1121-A1-D503-00B

Sheet Size: A1 Project No.: P1159-4

Scale: as shown (A1) Drawn By: MG/GD

Date: 11/11/2021 Checked By: M.G.

DETAIL H

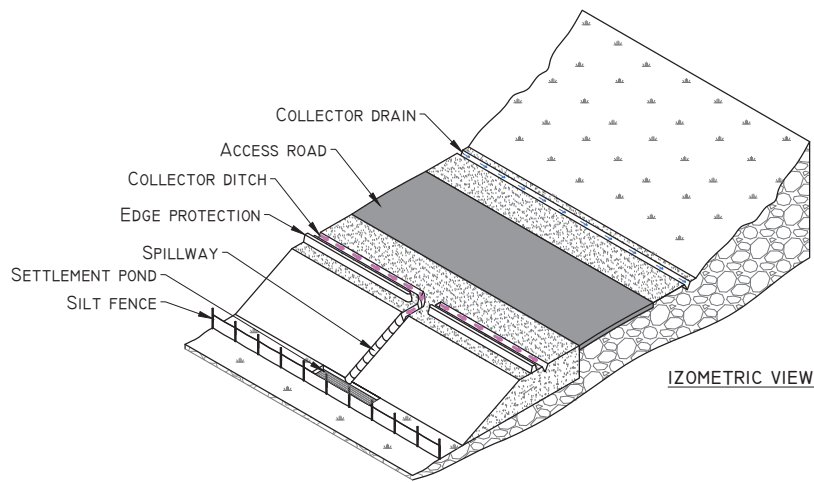
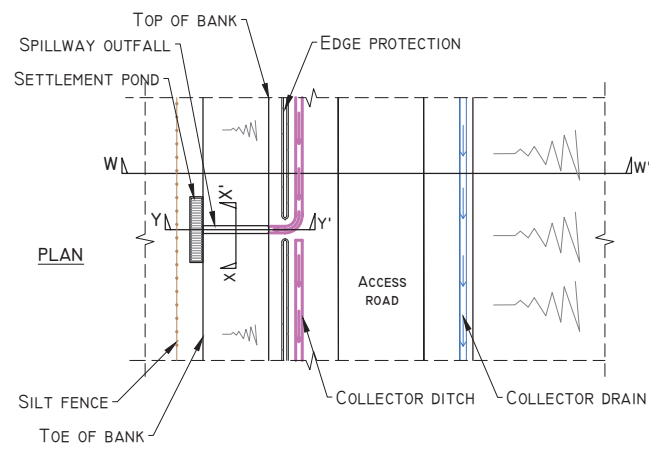

SPILLWAY OUTFALL PLAN
SCHEMATIC - NOT TO SCALE

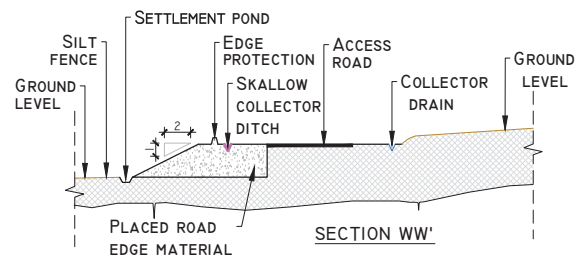

TEMPORARY CONCRETE WASH OUT PIT
SCALE 1:50

PLAN

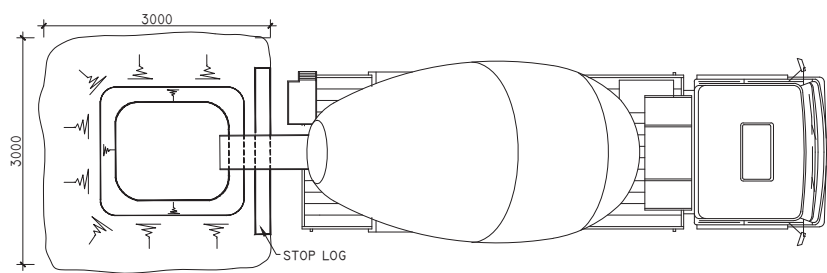

ELEVATION

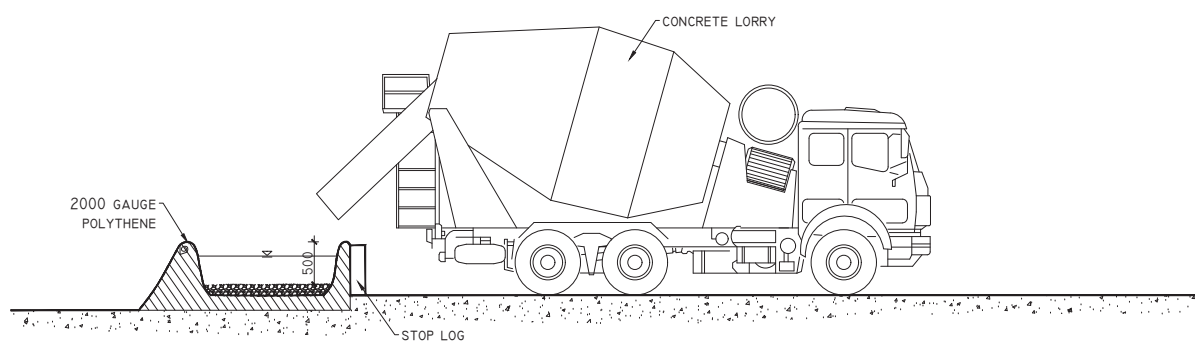

DETAIL I

DETAIL J-1

LEVEL SPREADER DETAIL
SCHEMATIC - NOT TO SCALE

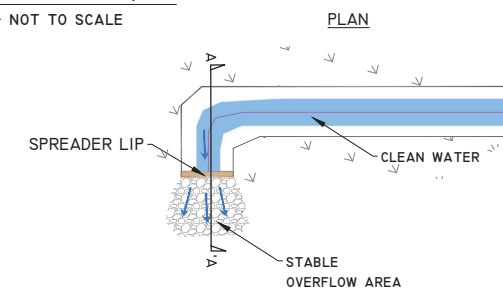
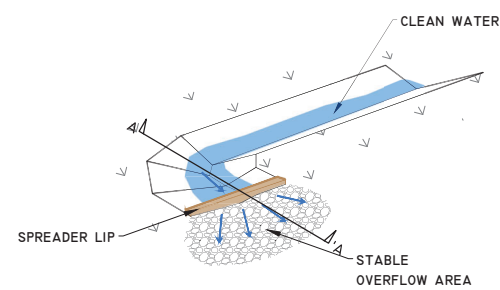

SECTION AA'

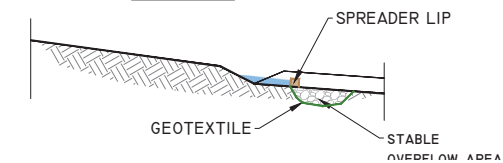

DETAIL J-2

LEVEL SPREADER DETAIL
SCHEMATIC - NOT TO SCALE

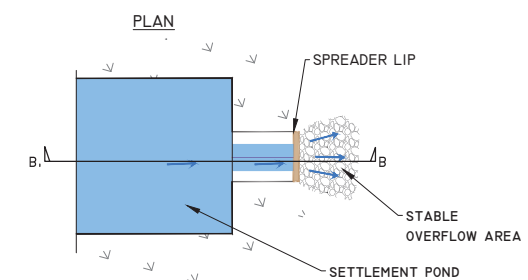
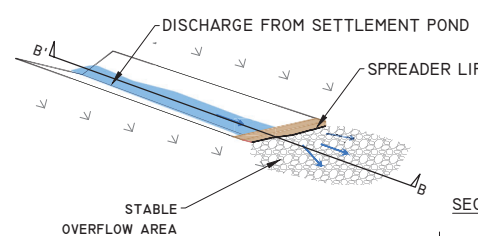

SECTION BB'

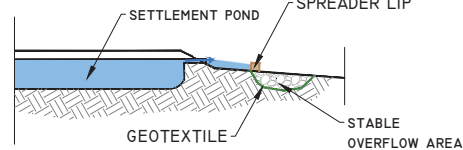

PROJECT DESIGN DRAWING NOTES
1. DRAWINGS ISSUED ARE FOR PLANNING STAGE ONLY.
2. COPYRIGHT, ALL RIGHTS RESERVED. NO PART HERE WITH MAY BE COPIED OR REPRODUCED PARTIALLY OR WHOLLY IN ANY FORM WHATSOEVER WITHOUT THE PRIOR NOTICE OF THE COPYRIGHT OWNER HYDRO-ENVIRONMENTAL SERVICES.
3. DO NOT SCALE OFF THIS DRAWING. FIGURED METRIC DIMENSIONS ONLY SHOULD BE TAKEN OFF THIS DRAWING.

Date	Description	Chkd	Signed

HYDRO ENVIRONMENTAL SERVICES
22 Lower Main St, Danganvan, Co. Waterford, Ireland
tel: +353 (0) 58-441722, +353 (0) 58-44244
email: info@hydroenvironmental.ie, www.hydroenvironmental.ie

Client: MKO

Job: SLIEVEACURRY RENEWABLE ENERGY DEVELOPMENT

Title: DRAINAGE DETAILS 4

Figure No: D504

Drawing No: P1159-4-1121-A1-D504-00B

Sheet Size: A1 Project No.: P1159-4

Scale: as shown (A1) Drawn By: MG/GD

Date: 11/11/2021 Checked By: M.G.