

TO WHOM IT MAY CONCERN

We hereby give permission to Revington Land Ltd. to apply for planning permission for a mixed use development on our lands at Pa Healy Road, Limerick. The extent of the landholding is shown in the attached map. .

Nir Kene Lewis & Edward Clancy
[Signature] *[Signature]* *[Signature]*
John Clancy

Signed,

CLANCEY LEWIS PROPERTIES LTD. PARK RD. LIMERICK.
_____(insert name and address of current owners)_____

Date: 22/3/2019

Attachment: map of relevant lands.

Land Registry compliance map

558707

558940

Area in Red = 2.75 Acres
 = 1.11 Hectares
 F. No. 612418
 PE
 Use Only

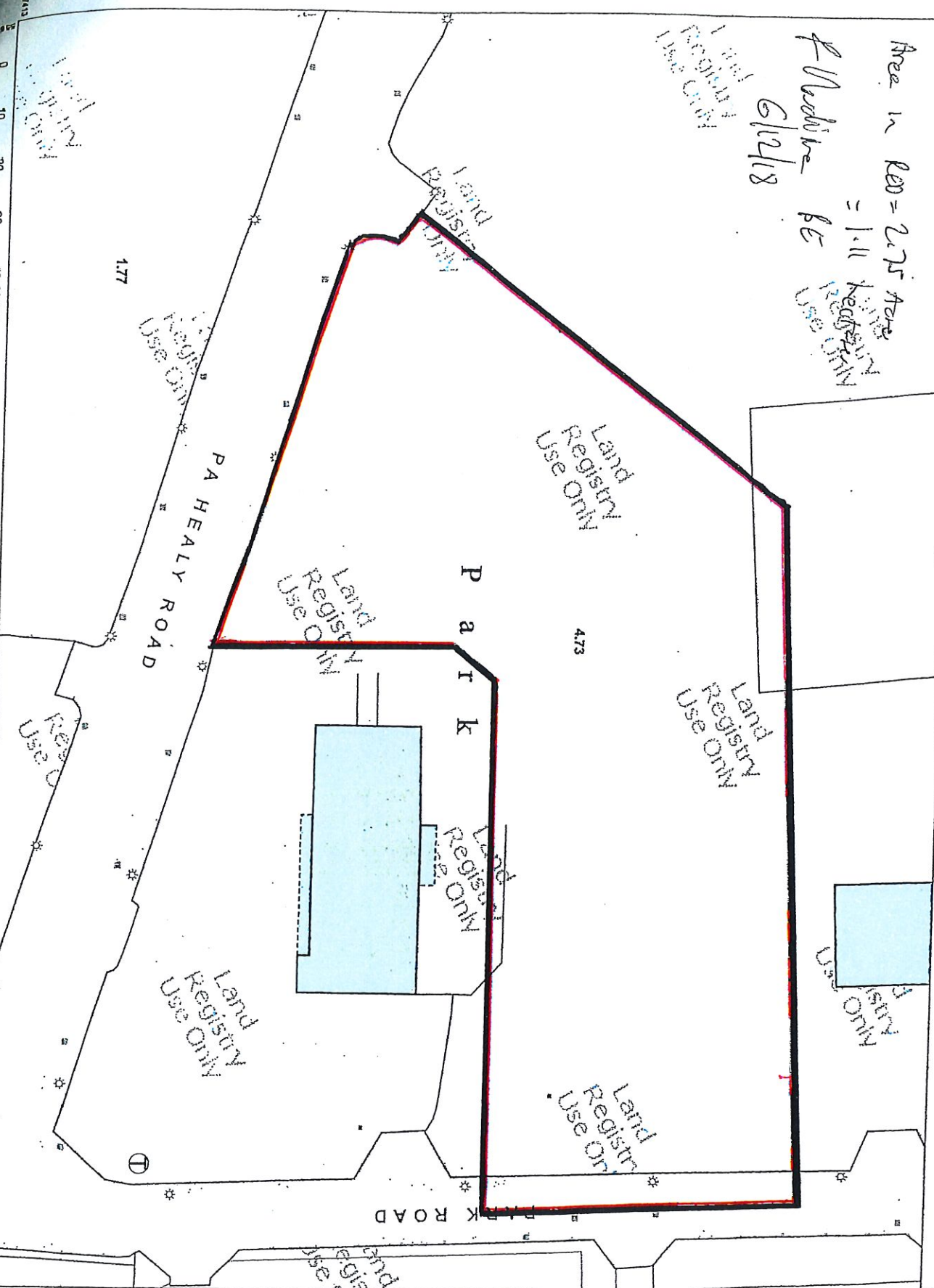

OUTPUT SCALE: 1:1,000

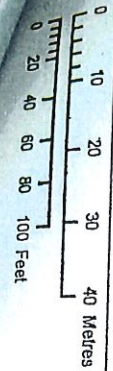

CAPTURE RESOLUTION:
 The map objects are only accurate to the resolution at which they were captured. Output scale is not indicative of data capture scale. Further information is available at: <http://www.osi.ie>, search 'Capture Resolution'

National

CENTRE COORDINATES:
 ITM 558824,657499

PUBLISHED: 20/11/2018
ORDER NO.: 50034957_1

MAP SERIES: 1:1,000
MAP SHEETS: 4682-24

COMPILED AND PUBLISHED BY:
 Ordnance Survey Ireland,
 Phoenix Park,
 Dublin 8,
 Ireland.

Unauthorised reproduction infringes Ordnance Survey Ireland and Government of Ireland copyright.

All rights reserved. No part of this publication may be copied, reproduced or transmitted in any form or by any means without the prior written permission of the copyright owners.

The representation on this map of a road, track or footpath is not evidence of the existence of a right of way.

Ordnance Survey maps never show legal property boundaries, nor do they show ownership of physical features.

© Suirbhéireacht Ordánais Éireann, 2018
 © Ordnance Survey Ireland, 2018
www.osi.ie/copyright

LEGEND:
<http://www.osi.ie>

TO WHOM IT MAY CONCERN

We hereby give permission to Revington Land Ltd. to apply for planning permission for a mixed use development on our lands at Pa Healy Road, Limerick. The extent of the landholding is shown in the attached map. .

M. McE...
PAILASK BURY
Co. Limerick.

Signed,

_____(insert name and address of current owners)_____

Date: 23/3/2019

Attachment: map of relevant lands.

Pat Downes 42 Maypole Park
PAUL DOWNES 30 COGRAN HEIGHTS
John Downes 43 BROOKVIEW AVS CLASHVIEW
Fany Chen 28 Bracken Gardens A. Clod.
Sean Downes 56 Clear Street Limerick

and Registry Compliant Map

MAP 1 OF 2
 Area of lands outlined in red
 = 7.31 acres (2.96 hectares)
 Signed by: *[Signature]*
 Cian O'Laoithe BSc Geomatics, MRICS, MSCSI
 Control Surveys
 OSI Licence No. SU 0003418
 Date: 16-08-18

4.09

MAP 2 OF 2
 Area of lands outlined in red
 = 7.31 acres (2.96 hectares)
 Signed by: *[Signature]*
 Cian O'Laoithe BSc Geomatics, MRICS, MSCSI
 Control Surveys
 OSI Licence No. SU 0003418
 Date: 16-08-18

1.57

Open Well

0.49

P a r k

4.73

P a

PA HEALY ROAD

PA HEALY ROAD

1.77

Donamuck

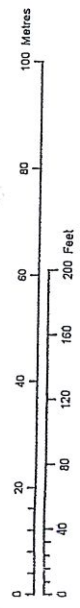

OUTPUT SCALE: 1:1,000

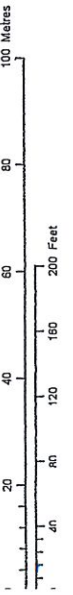

OUTPUT SCALE: 1:1,000

CAPTURE RESOLUTION:
 The map objects are only accurate to the resolution of the capture data. Output scale is not indicative of accuracy. Further information is available at <http://www.osi.ie> search 'Capture Resolution'.

Output scale is not indicative of actual capture accuracy. Further information is available at: <http://www.osi.ie> search 'Capture Resolution'

SEARCH LARGE SCALE LEGEND

