

Rev.	Date	Description
A		

- Legend:**
- **Category ( A, A1, A2, A3 )**  
Those of high quality and value; in such a condition as to be able to make a substantial contribution ( a minimum of 40 years )
  - **Category ( B, B1, B2, B3 )**  
Those of moderate quality and value; those in such a condition as to make a significant contribution ( a minimum of 20 years )
  - **Category ( C, C1, C2, C3 )**  
Those of low quality and value; those in such condition that any existing value would be lost within 10 years and which should, in the current context, be removed for reason of sound arboricultural management
  - **Category ( U )**  
Those in such condition that any existing value would be lost within 10 years and which should, in the current context, be removed for reason of sound arboricultural management

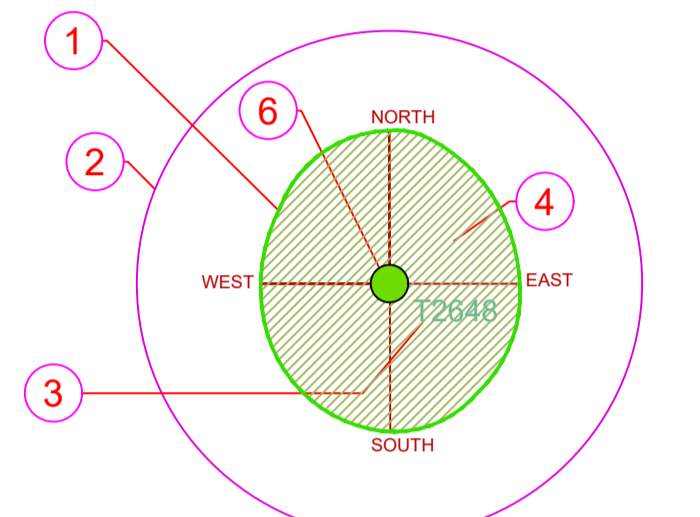

- AGE GROUPINGS**
- Y = YOUNG
  - MA = MIDDLE AGE
  - M = MATURE
  - OM = OVER MATURE
  - V = VETERAN
- 

- EXISTING TREE CANOPY BASED ON DIMENSIONS GATHERED ON SITE IN 4 DIRECTIONS, NORTH, SOUTH, EAST AND WEST
- ROOT PROTECTION ZONE BASED ON 12 TIMES THE (DBH) AT CHEST HEIGHT
- TREE TAG NUMBER
- TREE TO BE RETAINED
- TREE TO BE REMOVED
- TREE CATEGORY BASED ON BS:5837 2012 CRITERIA
- DECIDUOUS TREE CANOPY
- EVERGREEN TREE CANOPY

**01 TABLES BS 5837-2012**

- Key**
- LOCATIONS OF FENCING TO FORM MINIMUM TREE ROOT PROTECTION AREAS
  - SITE BOUNDARY

Client: Estuary View Enterprises 2020 Ltd

Project: BESSBOROUGH Phase 2 'The Farm' Development

Drawing Title: Tree Protection Plan

Drawn By: JL/TC	Checked By: MG	Date: 27/02/22	Scale: 1:250@A1
Drg. No. 7 of 8	CAD File: BBR_TS_001_Rev_02_22.dwg	Rev. C02	

**Arbor Care**  
Unit 1a  
Crossagalla Enterprise Centre  
Ballysimon Road  
Limerick  
Ireland

Phone: +353 (0)863082808  
Fax: +353 (0)61400321  
Email: info@arborcare.ie  
Web: www.arborcare.ie

Dispersed  
Consulting Tree Services

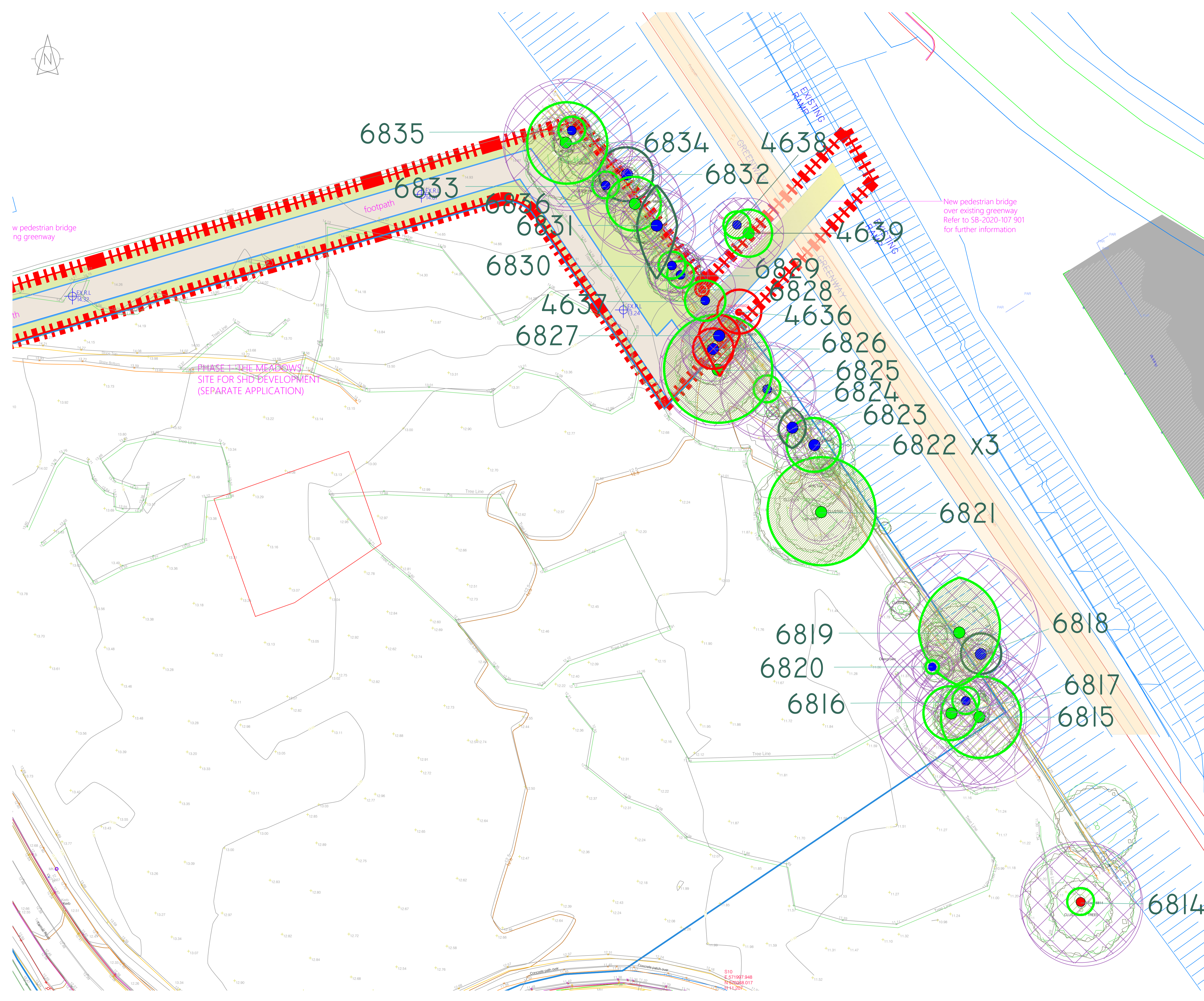

S10  
E 571947 948  
N 578348 017  
H 11.207