

### GROUND FLOOR PLAN C19.2, 19.1 & C20.1

SCALE 1:100

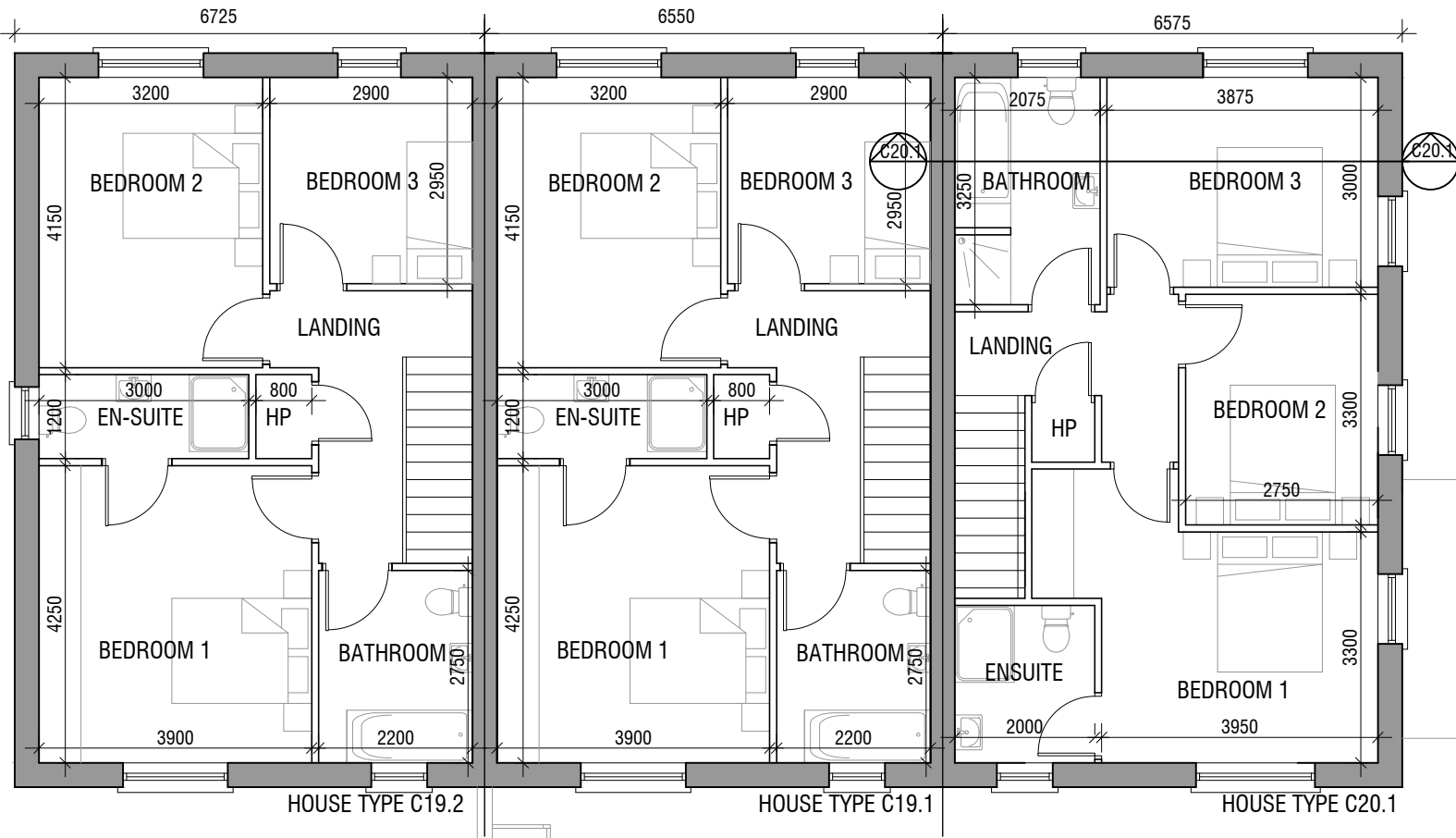

### FIRST FLOOR PLAN C19.2, 19.1 & C20.1

SCALE 1:100

### HOUSE TYPE C20.1/C19.2/C19.1

TERRACE - 3 BEDROOM HOUSE (CORNER)

	(HOUSE C20.1)	(HOUSE C19.1 & 19.2)
GROUND FLOOR	61.2 m <sup>2</sup>	68.9 m <sup>2</sup>
FIRST FLOOR	56.4 m <sup>2</sup>	57.8 m <sup>2</sup>
<b>TOTAL</b>	<b>117.6 m<sup>2</sup> / 1266 ft<sup>2</sup></b>	<b>116.7 m<sup>2</sup> / 1256 ft<sup>2</sup></b>

- PROPOSED MATERIALS
- ROOF: SELECTED BLUE / BLACK TILE & FLAT ROOF MEMBRANE
  - WALLS: BRICK & PAINTED RENDER
  - WINDOWS: GREY OR APPROVED COLOUR
  - DOORS: HARDWOOD / PVC TO SELECTED COLOUR

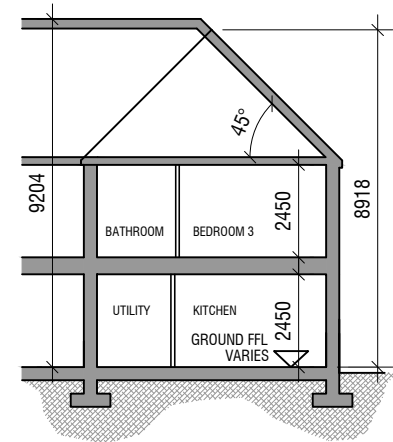

### SECTION C20.1

SCALE 1:200

