

THE COPYRIGHT OF THIS DRAWING IS VESTED WITH C+W O'BRIEN LTD AND MUST NOT BE COPIED OR REPRODUCED WITHOUT THE CONSENT OF THE COMPANY.

FIGURED DIMENSIONS ONLY TO BE TAKEN FROM THIS DRAWING. DO NOT SCALE.
ALL CONTRACTORS MUST VISIT THE SITE AND BE RESPONSIBLE FOR CHECKING ALL SETTING OUT DIMENSIONS AND NOTIFYING THE ARCHITECT OF ANY DISCREPANCIES PRIOR TO ANY MANUFACTURE OR CONSTRUCTION WORK.

ALL C+W O'BRIEN LTD DRAWINGS TO BE READ IN CONJUNCTION WITH THE ARCHITECTURAL NATIONAL BUILDING SPECIFICATION (NBS) PROVIDED FOR THIS PROJECT



00 KEY PLAN (CROSS AREA-B)
1 : 2500

SUBJECT HOUSE TYPE SHOWN IN COLOUR

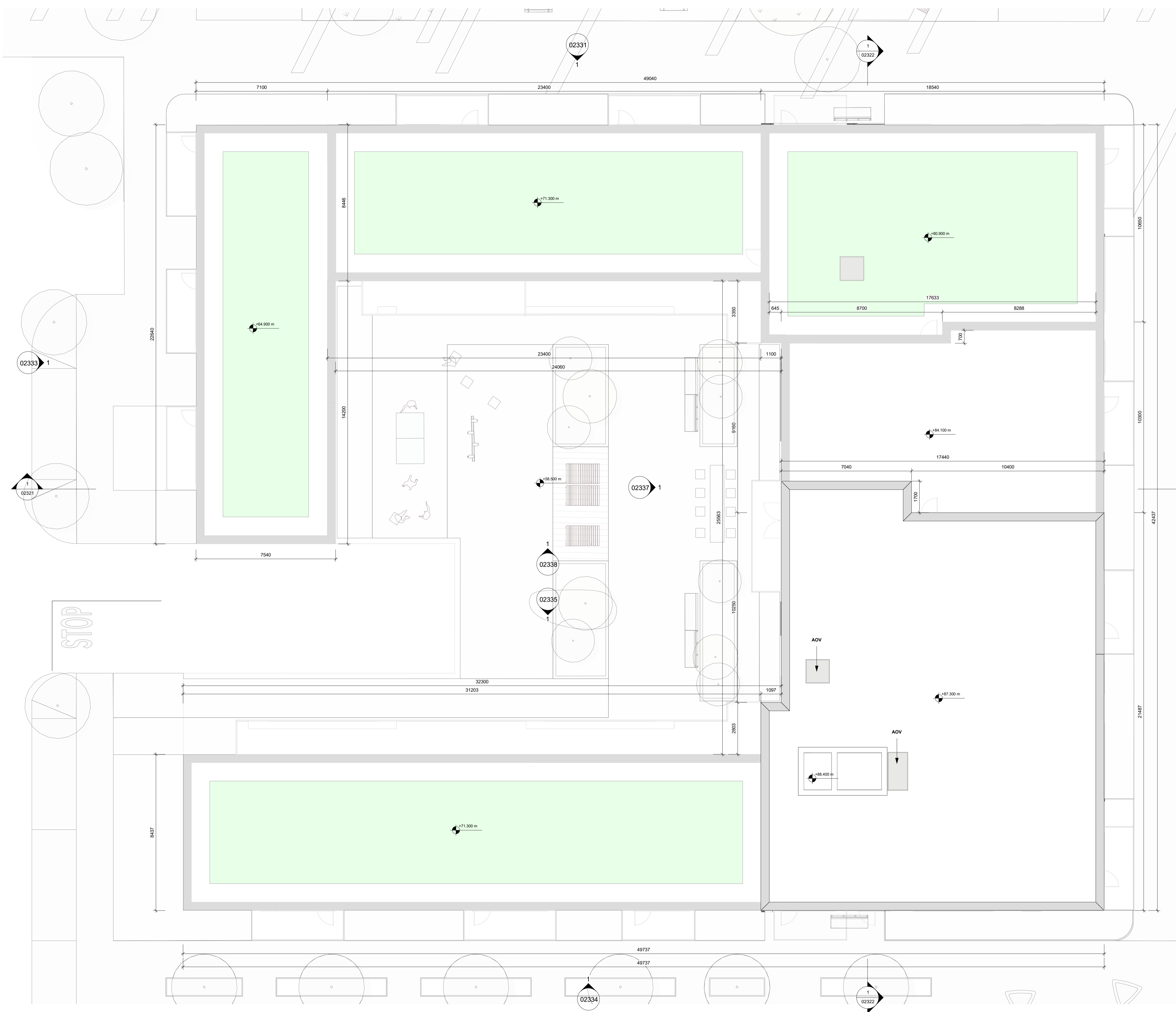

Green Roof. Refer to Landscape Drawings.

Floor Plan Key

- ES - En suite
- ST - Storage
- KLD - Kitchen/Living/Dining
- AOV - Automatic Opening Vent
- HP - Hot Press

GENERAL NOTES

THIS DRAWING TO BE READ IN CONJUNCTION WITH ARCHITECTS DRAWINGS, CONSULTANT ENGINEERS DRAWINGS AND SPECIFICATIONS & LANDSCAPE ARCHITECTS DRAWINGS

SOLAR PANEL POSITION DEPENDS ON HOUSE ORIENTATION THE EXACT LOCATION & ORIENTATION WILL BE DEPENDENT ON FINAL BER RATING. SOLAR PANELS MAY BE OMITTED IN FAVOUR OF ALTERNATIVE RENEWABLE ENERGY SOURCE.

- CHARACTER AREAS:
- A- BARNHILL STREAM
 - B- BARNHILL CROSS
 - C- BARNHILL CRESCENT
 - D- STATION Q SOUTH

P03	Planning Application	27/06/22	CS	DT
P02	Pre App to An Bord Pleanála	15/10/21	CS	DT
P01	First Issue	01/09/21	CS	DT
Rev	Description	Date	Dr	App by

Project Stage
PLANNING

Client:
Alanna Homes and Alcove Ireland Four Ltd.

Project:
Barnhill Garden Village SHD
Barberstown, Barnhill and Passifyoucan,
Clonsilla, Dublin 15.

Drawing Title:
APARTMENT-2-ROOF PLAN

Drawn	Checked	Paper Size	Scale	Date
CS	AM	A1	As indicated	@A1 27/06/22

Project No.	Drawing No.	Revision
PE18119	02310	P03

File Name:
PE18119-CWO-A2-RL-DR-A-02310

Status:
PLANNING STAGE



No.1 Sarsfield Quay, Dublin 7, D07 R9FH
t: 01 518 0170 e: admin@cwoarchitects.ie
Dublin | Cork | Galway | London | UK & Europe +
www.cwoarchitects.ie

Please consider the environment before printing this sheet

1 Roof Plan
1 : 100