

Notes:

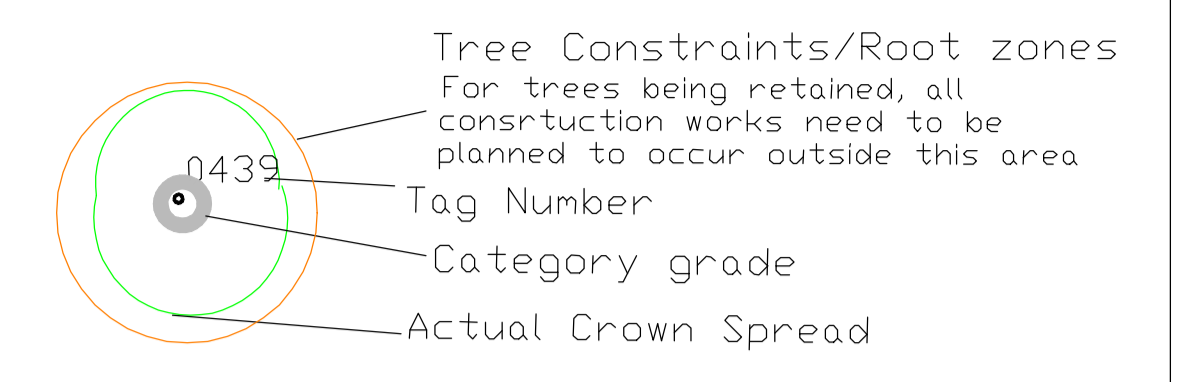

BS5837: 2012 - Category Retention Rating

- Category U Trees- Trees in such a condition that any existing value would be lost within 10 years or being recommended for removal sound arboricultural practice.
- Category A Trees Trees of high quality/value with a min. of 40 years life expectancy.
- Category B Trees Trees of moderate quality/value with a min. of 20 years life expectancy.
- Category C Trees Trees of low quality/value with a min. of 10 years life expectancy.

- Sub Categories
- 1- Mainly Arboricultural values
 - 2 - Mainly Landscape values
 - 3 - Mainly cultural and conservation values.

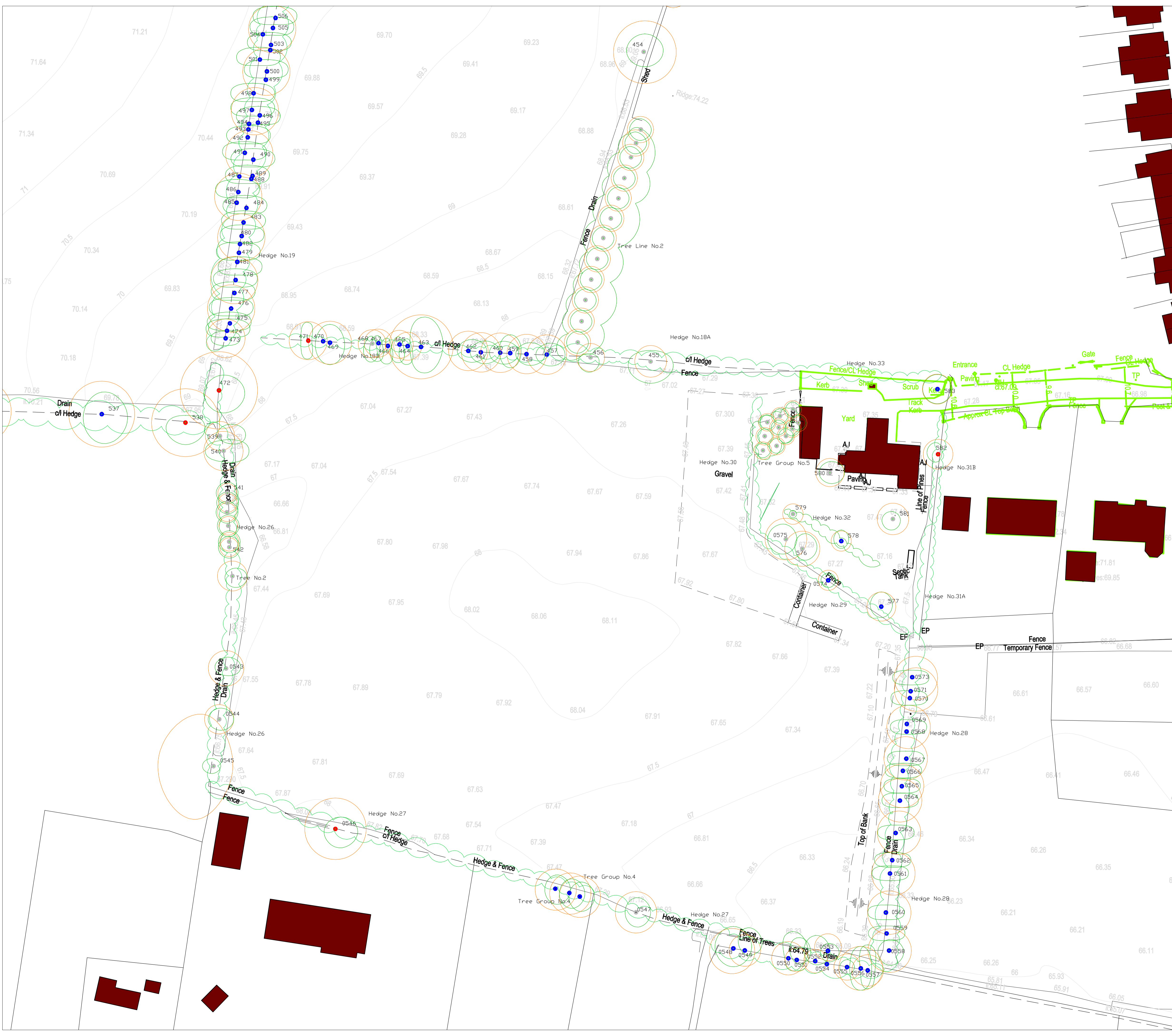

ARBORIST ASSOCIATES LTD. 94 BALLYBAWN COTTAGES, ENNISKERRY, CO. WICKLOW TEL: 01-2742011 / 087-2629589		
TITLE : Tree Constraints Plan		
Site : At Baltrasna & Milltown, Ashbourne, Co. Meath.		
DATE:	Dwg No.ABM001 Part 5 of 5	Scale 1:500 @ A1