

**Part Plan along Bailey Gibson Boundary**

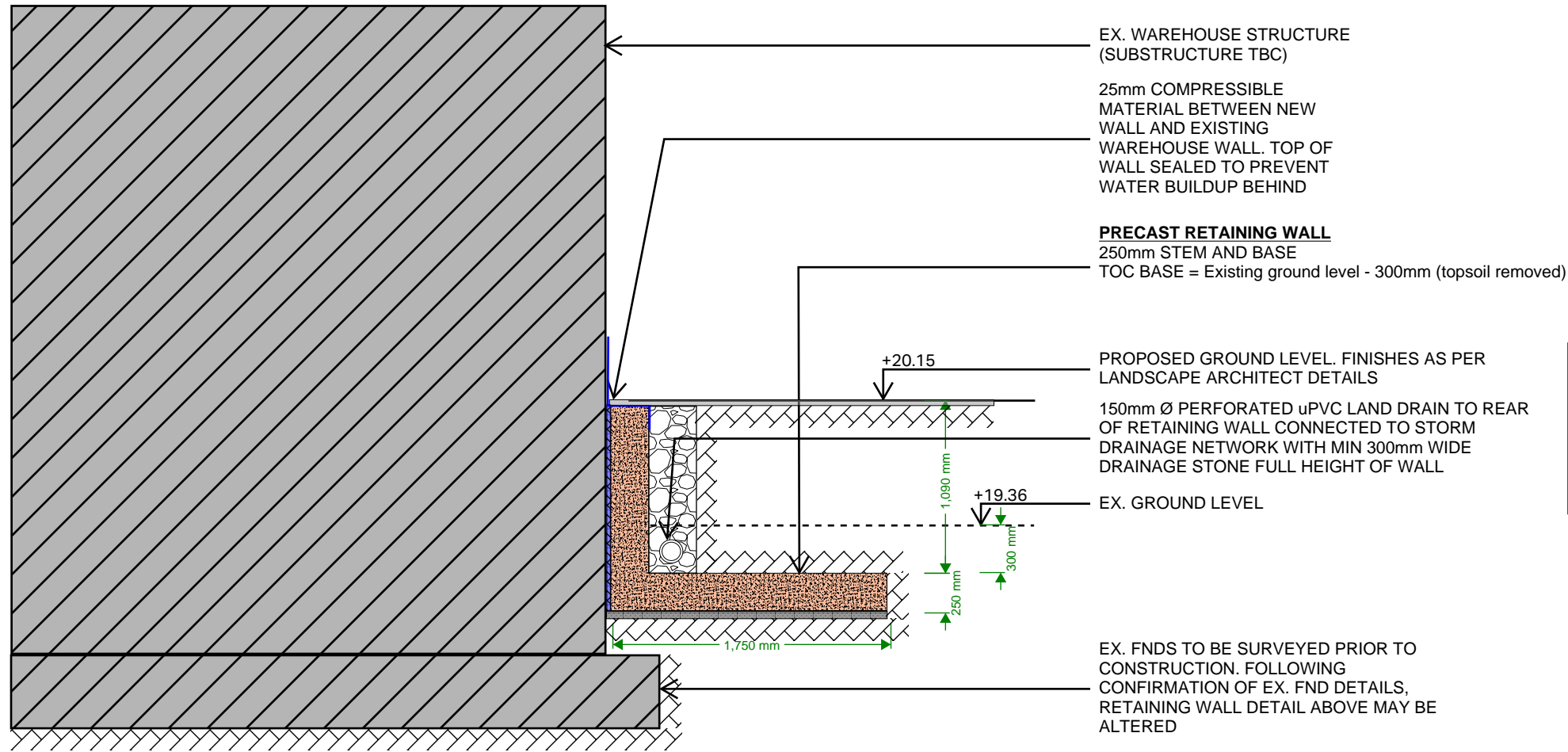

NOTE:  
 LEVELS SHOWN ARE  
 INDICATIVE. PLEASE  
 REFER TO AECOM  
 CIVILS PROPOSED  
 ROAD AND FINISHED  
 FLOOR LEVELS  
 DRAWINGS

**Section Detail**

**Project**

Donore Project,  
 Donore Avenue,  
 Dublin 8.

**Client**

THE LAND DEVELOPMENT AGENCY

**Consultant**

**AECOM**  
 4th Floor, Adelphi Plaza  
 George's Street Upper  
 Dun Laoghaire, Co. Dublin  
 Ireland  
 Fax +353 (0) 1 238 3199  
 Tel +353 (0) 1 238 3100  
 www.aecom.com

**Notes**

- Do not scale from this drawing. Work to figured dimensions only.
- Any discrepancies shall be referred to the Designer before work commences.

**Keyplan**

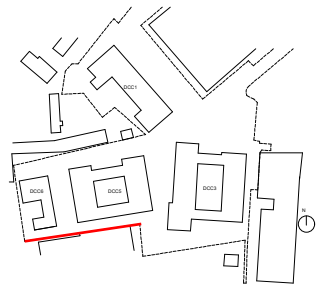

**Issue/Revision**

Rev.	Date	Description	Drw/Chk/Apr
P01	14/09/22	PLANNING ISSUE	CM/IE/IEH

**Purpose Of Issue**

FOR INFORMATION

**Project Number**

60648061

**Sheet Title**

RETAINING WALL ALONG  
 BAILEY GIBSON BOUNDARY

**Sheet Number**

STG-AEC-S1b-ZZ-XX-ZZ-SK-S-000009

Scale: @A1

Rev: P02

This drawing has been prepared for the use of AECOM's client. It may not be used, modified, reproduced or relied upon by third parties, except as agreed by AECOM or as required by law. AECOM accepts no responsibility, and denies any liability whatsoever, to any party that uses, or relies on this drawing without AECOM's express written consent. Do not scale this document. All measurements must be obtained from the stated dimensions.