



APPENDIX 9-3

PUBLIC LIGHTING REPORT

Meath County Council - Viewing Purposes Only!

DATE: 17 August 2022
DESIGNER: Alex Naper
PROJECT No: SES 11222 Rev B
PROJECT NAME: Site B – Healthcare Facilities -Sky Castle Ltd.



Link road designed in accordance with EN13201-2:2015 category P2.

Distributor carriageway designed in accordance with EN13201-2:2015 Category M4. Distributor road a whole designed in accordance with EN13201-2:2015 Category P2.

Distributor road/Link road junction designed in accordance with EN13201-2:2015 Category C3.

Carpark designed in accordance with EN12464-2:2014 Table 5.9.1.

Internal road area designed in accordance with EN13201-2:2015 Category P3.

Rev A: Existing HID luminaires added.

Outdoor Lighting Report

PREPARED BY: Sabre Electrical Services Ltd.
Unit 11,
Bellview Industrial Estate,
Tolka Valley Road,
Dublin 11
Phone Number: 01 8110875
Contact: Graham Sheehan
eMail: graham@sabrelighting.ie

Layout Report

General Data

Dimensions in Metres Angles in Degrees

Calculation Grids

ID	Grid Name	X	Y	X' Length	Y' Length	X' Spacing	Y' Spacing
1	Grid 1	694612.84	738506.27	122.73	354.59	1.50	1.50
2	Grid 2	694678.96	738789.75	39.00	48.00	1.50	1.50
3	Grid 3	694464.62	738844.77	220.48	78.00	1.50	1.50
4	Grid 4	694453.17	738841.42	125.71	66.00	1.50	1.50
5	Grid 5	694552.35	738726.50	102.00	117.00	1.50	1.50

Luminares

Luminaire B Data

Supplier	C U Phosco
Type	E950-28-P4A-730-C550-14W
Lamp(s)	730N
Lamp Flux (klm)	2.08
File Name	E950-28-P4A-730-C0550-14W.ies
Maintenance Factor	0.83
Imax70,80,90(cd/klm)	659.3, 183.1, 0.3
No. in Project	7



Luminaire F Data

Supplier	C U Phosco
Type	P863-128-R4-730-W3-300-40W
Lamp(s)	730SS
Lamp Flux (klm)	5.53
File Name	P863-128-R4-730-W3-300-40W.ies
Maintenance Factor	0.87
Imax70,80,90(cd/klm)	386.2, 27.2, 0.4
No. in Project	10



Luminaire G Data

Supplier	C U Phosco
Type	P862-256-R2E-730-W3-300-76W
Lamp(s)	730SS
Lamp Flux (klm)	10.70
File Name	P862-256-R2E-730-W3-300-76W.ies
Maintenance Factor	0.87
Imax70,80,90(cd/klm)	458.4, 47.0, 0.0
No. in Project	5

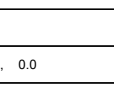

Luminaire H Data

Supplier	C U Phosco
Type	P863-128-F2B-730-W3-300-40W
Lamp(s)	730SS
Lamp Flux (klm)	5.39
File Name	P863-128-F2B-730-W3-300-40W.ies
Maintenance Factor	0.87
Imax70,80,90(cd/klm)	461.8, 61.8, 0.8
No. in Project	1



Luminaire I Data

Supplier	C U Phosco
Type	E950-28-A2A-730-SD0600-26W
Lamp(s)	730SA
Lamp Flux (klm)	3.59
File Name	E950-28-A2A-730-SD0600-26W.ies
Maintenance Factor	0.87
Imax70,80,90(cd/klm)	244.2, 25.7, 14.6
No. in Project	16

Luminaire J Data

Supplier	
Type	2685 SNN-1C#
Lamp(s)	1 ST 150 17500 2000 E40
LampFlux(klm)/Colour	17.50 1950 / 23
File Name	Arc 2685 SNN 1C# 1 ST 150 17500 1950 E 40.ltd
Maintenance Factor	0.75
Imax70,80,90(cd/klm)	352.0, 100.0, 5.0
No. in Project	5

Layout

ID	Type	X	Y	Height	Angle	Tilt	Cant	Out-reach	Target X	Target Y	Target Z
1	G	694691.87	738828.14	10.00	349.00	0.00	0.00	0.50			
2	G	694685.67	738788.92	10.00	349.00	0.00	0.00	0.50			
3	G	694681.16	738749.74	10.00	349.00	0.00	0.00	0.50			
4	G	694675.90	738710.53	10.00	349.00	0.00	0.00	0.50			
5	J	694686.44	738669.51	10.00	174.00	5.00	0.00	2.00			
6	J	694683.59	738647.14	10.00	174.00	5.00	0.00	2.00			
7	J	694681.46	738629.80	10.00	174.00	5.00	0.00	2.00			
8	F	694672.79	738806.75	8.00	80.00	0.00	0.00	0.50			
9	G	694706.53	738807.16	10.00	173.00	0.00	0.00	0.50			
10	F	694643.33	738811.94	8.00	80.00	0.00	0.00	0.50			
11	F	694623.22	738828.28	8.00	245.00	0.00	0.00	0.50			
12	F	694598.06	738828.65	8.00	53.00	0.00	0.00	0.50			
13	F	694577.41	738852.91	8.00	243.00	0.00	0.00	0.50			
14	F	694548.68	738870.90	8.00	243.00	0.00	0.00	0.50			
15	F	694521.13	738876.44	8.00	63.00	0.00	0.00	0.50			
16	F	694484.80	738880.91	8.00	335.00	0.00	0.00	0.50			
17	F	694502.18	738899.80	8.00	243.00	0.00	0.00	0.50			
18	F	694473.40	738905.89	8.00	49.00	0.00	0.00	0.50			
19	H	694465.76	738855.20	8.00	24.00	0.00	0.00	0.50			
20	I	694527.36	738858.50	6.00	20.00	0.00	0.00	0.40			
21	I	694544.14	738845.07	6.00	63.00	0.00	0.00	0.40			
22	I	694595.02	738817.04	6.00	350.00	0.00	0.00	0.40			
23	I	694568.06	738833.79	6.00	63.00	0.00	0.00	0.40			
24	I	694589.94	738791.63	6.00	349.00	0.00	0.00	0.40			
25	I	694586.80	738776.35	6.00	346.00	0.00	0.00	0.40			
26	I	694581.33	738749.05	6.00	337.00	0.00	0.00	0.40			
27	I	694611.31	738743.73	6.00	165.00	0.00	0.00	0.40			
28	I	694614.50	738759.57	6.00	165.00	0.00	0.00	0.40			
29	I	694627.76	738741.54	6.00	165.00	0.00	0.00	0.40			
30	I	694630.86	738757.20	6.00	170.00	0.00	0.00	0.40			
31	B	694577.53	738821.33	6.00	346.00	0.00	0.00	0.40			
32	B	694573.59	738801.91	6.00	346.00	0.00	0.00	0.40			
33	B	694569.82	738782.58	6.00	346.00	0.00	0.00	0.40			
34	I	694599.13	738745.87	6.00	346.00	0.00	0.00	0.40			
35	B	694563.67	738753.40	6.00	347.00	0.00	0.00	0.40			
36	I	694614.09	738811.41	6.00	335.00	0.00	0.00	0.40			

Layout Continued

ID	Type	X	Y	Height	Angle	Tilt	Cant	Out-reach	Target X	Target Y	Target Z
37	I	694604.68	738772.38	6.00	348.00	0.00	0.00	0.40			
38	I	694629.86	738785.15	6.00	261.00	0.00	0.00	0.40			
39	B	694651.09	738772.87	6.00	164.00	0.00	0.00	0.40			
40	B	694648.70	738754.43	6.00	171.00	0.00	0.00	0.40			
41	B	694646.10	738741.48	6.00	170.00	0.00	0.00	0.40			
42	I	694607.95	738788.64	6.00	348.00	0.00	0.00	0.40			
43	J	694679.82	738608.90	10.00	168.00	5.00	0.00	2.00			
44	J	694674.31	738565.09	10.00	182.00	5.00	0.00	2.00			

Meath County Council - Viewing Purposes Only!

Horizontal Illuminance (lux)

Grid 1

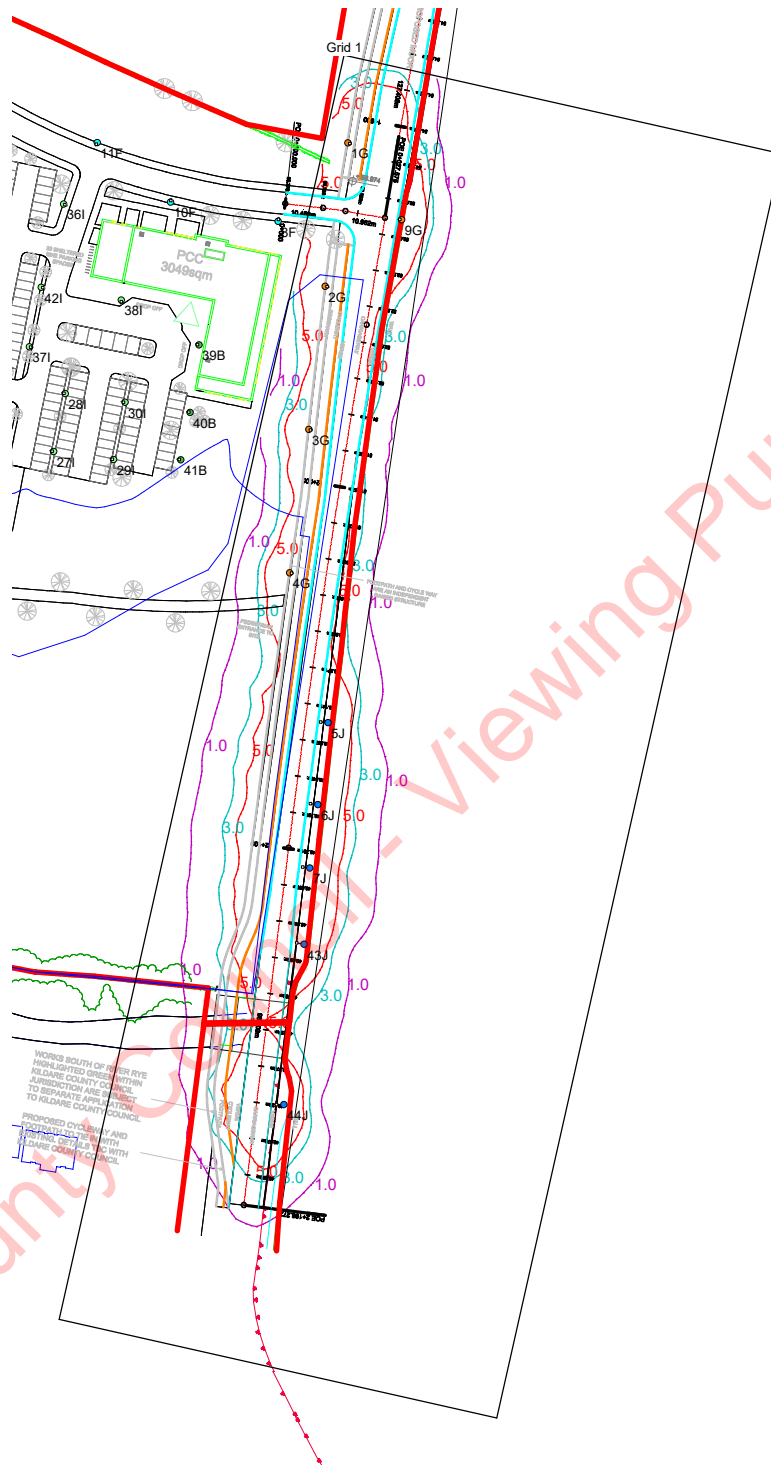

WORKS SOUTH OF FUSSE RYE
HIGHLIGHTED GREEN WITHIN
KILBARE COUNTY COUNCIL
JURISDICTION ARE SUBJECT
TO SEPARATE APPLICATION
TO KILBARE COUNTY COUNCIL

PROPOSED CYCLEWAY AND
FOOTPATH TO BE WITHIN
KILBARE COUNTY COUNCIL

Results

Eav	13.13
Emin	2.65
Emax	34.54
Emin/Emax	0.08
Emin/Eav	0.20

Horizontal Illuminance (lux)

Grid 2

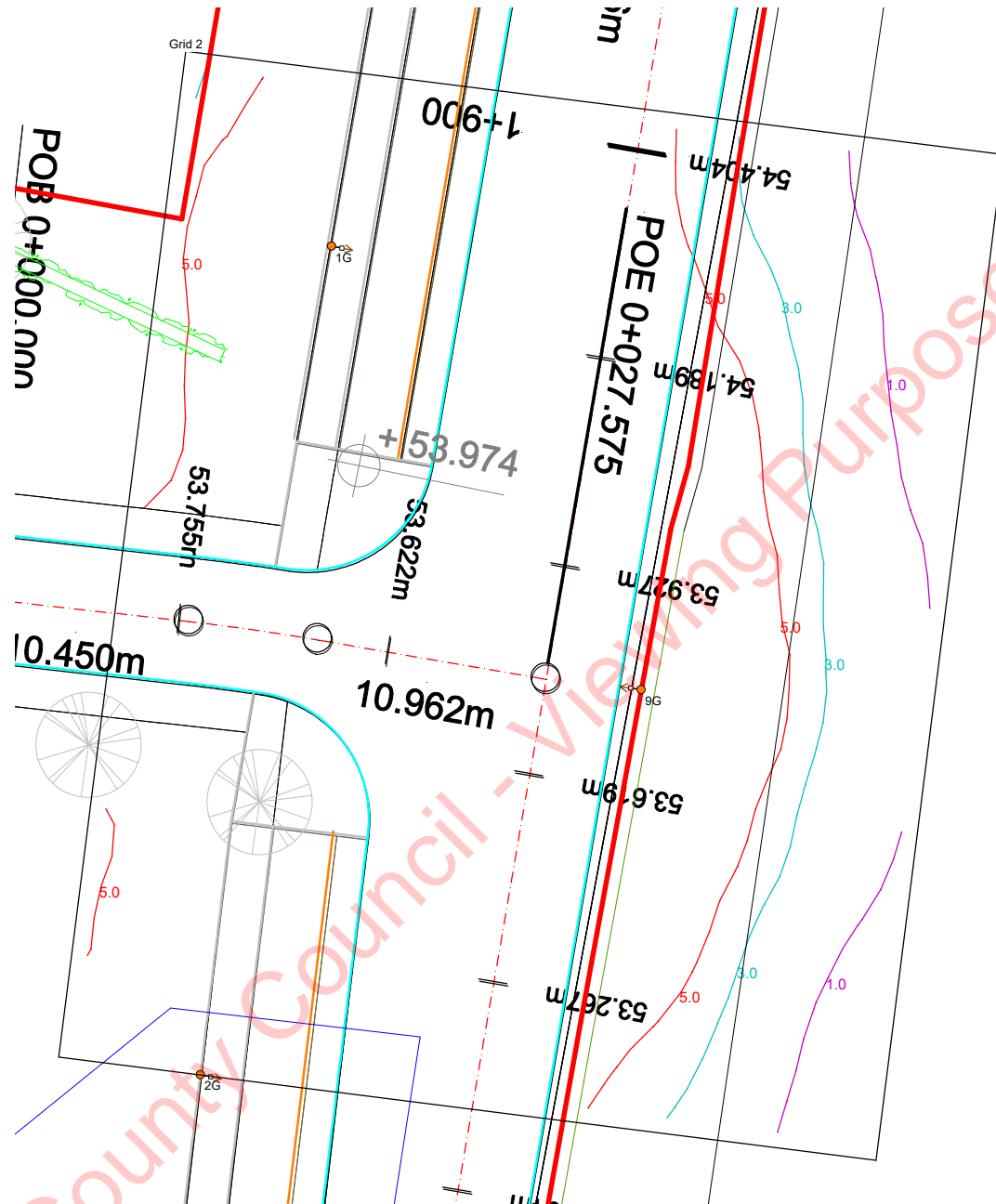

Results

Eav	18.22
Emin	7.22
Emax	25.37
Emin/Emax	0.28
Emin/Eav	0.40

Horizontal Illuminance (lux)

Grid 3



Results

Eav	11.92
Emin	2.94
Emax	23.52
Emin/Emax	0.12
Emin/Eav	0.25

Meath County Council - Viewing Purposes Only!

Horizontal Illuminance (lux)

Grid 4

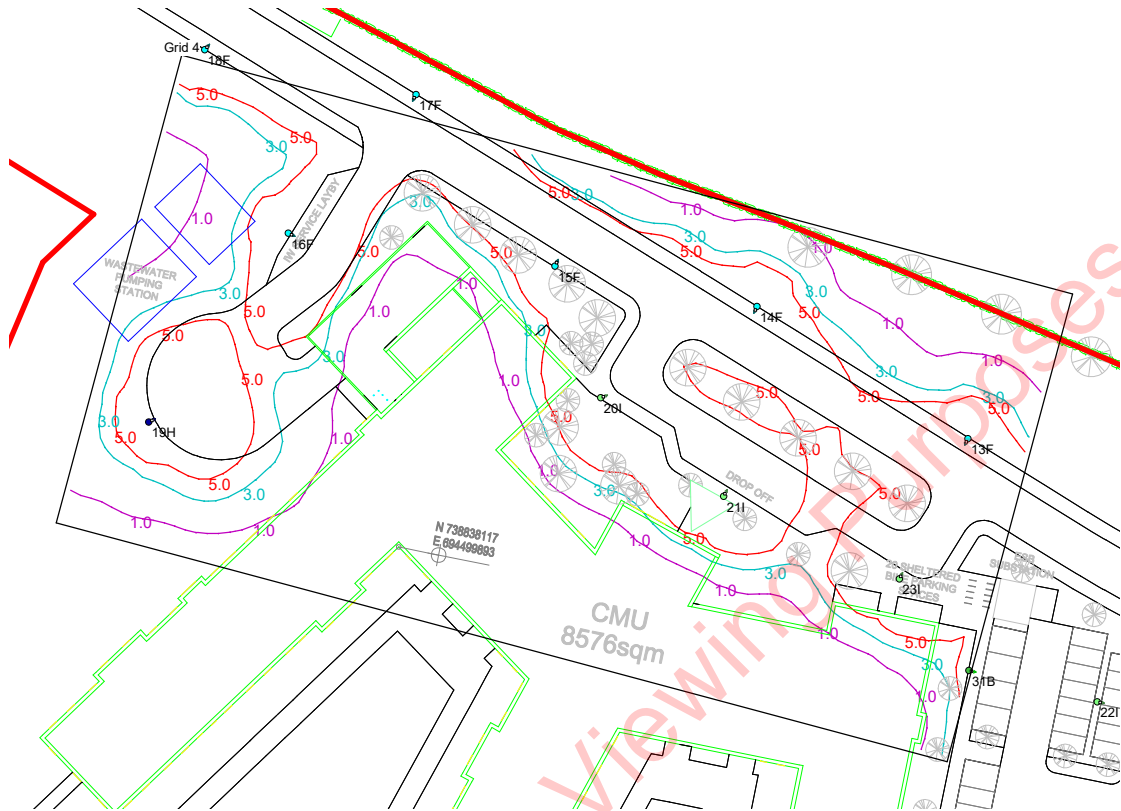

Results

Eav	7.54
Emin	1.50
Emax	21.90
Emin/Emax	0.07
Emin/Eav	0.20

Horizontal Illuminance (lux)

Grid 5

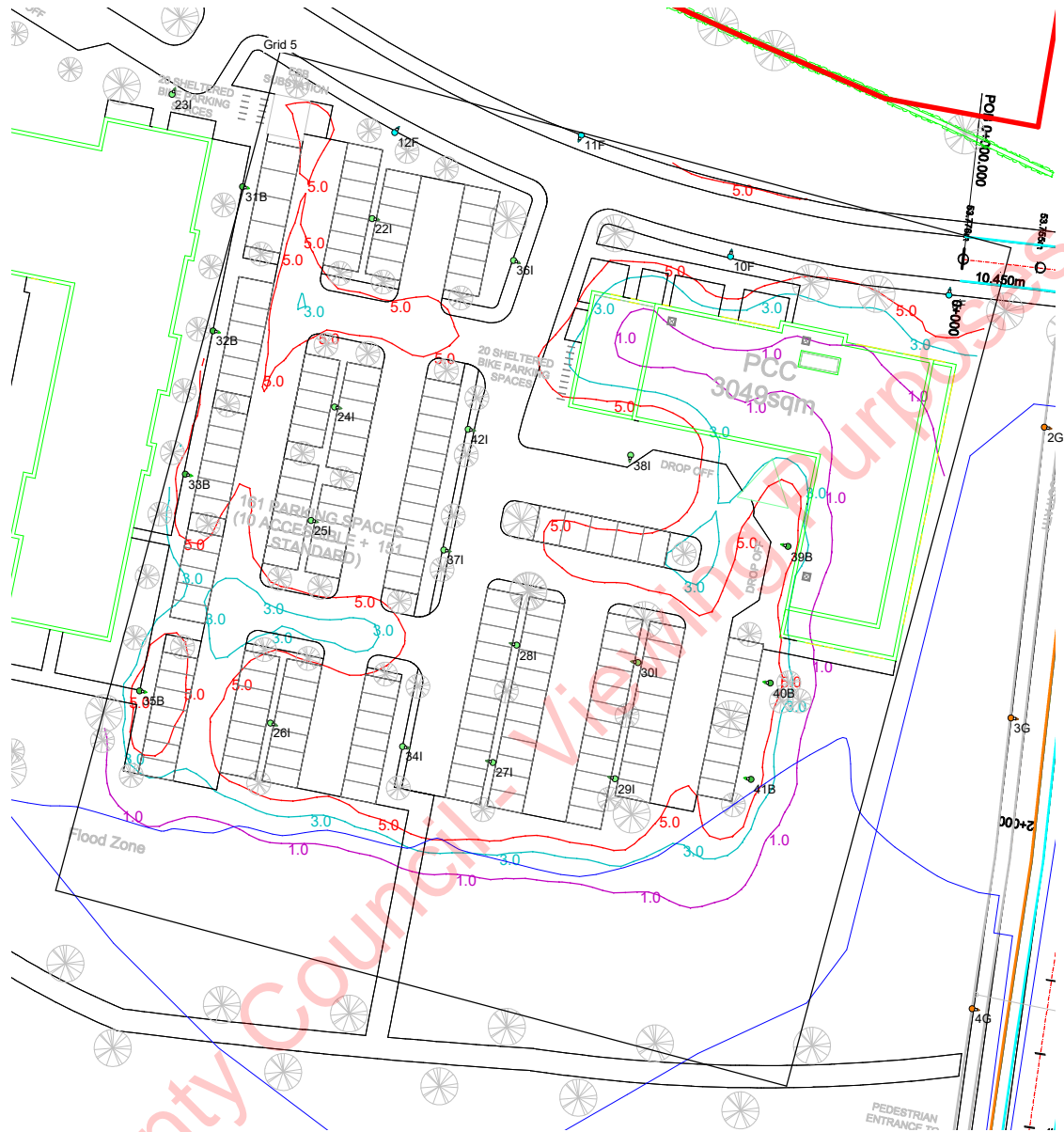

Results

Eav	7.77
Emin	1.93
Emax	17.22
Emin/Emax	0.11
Emin/Eav	0.25