

ALL PLAY EQUIPMENT CERTIFIED  
BY RoSPA (Royal Society for the  
Prevention of Accidents) AND  
CONFORM TO EN1176.

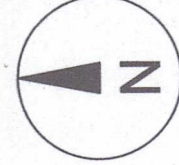

# Play areas

There are 8 designated play areas proposed within the project in accordance with FCC document 'Space for Play', the play areas are as follows:

- Play area A (in POS 5); Caters for Toddlers (up to 5/6 years old), 200 sq.m in size
- Play area B (in POS 4); Caters for Toddlers and young children, 400 sq.m in size
- Play area C (in POS 7); Caters for Toddlers (up to 5/6 years old), 100 sq.m in size
- Play area D (in POS 8); Caters for Toddlers (up to 5/6 years old), 100 sq.m in size
- Play area E (in POS 6); Caters for Toddlers and young children, 400 sq.m in size
- Play area F (in POS 2); Caters for Toddlers (up to 5/6 years old), 100 sq.m in size
- Play area G (in POS 2); Caters for Toddlers and young children, 400 sq.m in size
- Play area H (in POS 3); Caters for Toddlers (up to 5/6 years old), 100 sq.m in size

TOTAL AREA OF PUBLIC PLAY AREAS = 1,800 sq.m

It is proposed that the play equipment is constructed primarily from timber (Robinia Hardwood). Play surface proposed is compacted sand base with loose bark mulch, refer to Detail 16 below.

Suggested supplier of play equipment;

Creative Play Solutions  
Address: Minclon, Rahoon, Galway, H91 NY8K  
Tel: 091 525 709 www.createplay.ie

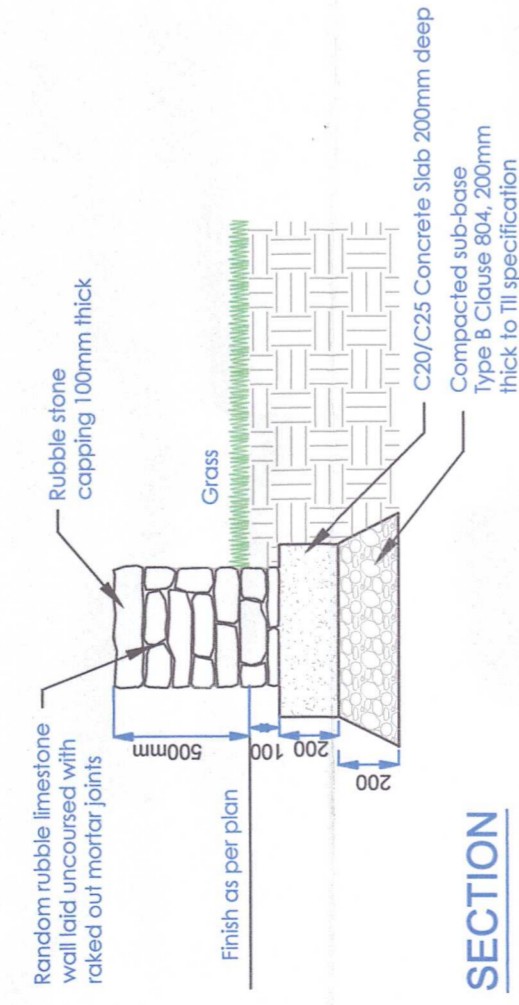

SECTION 1:25

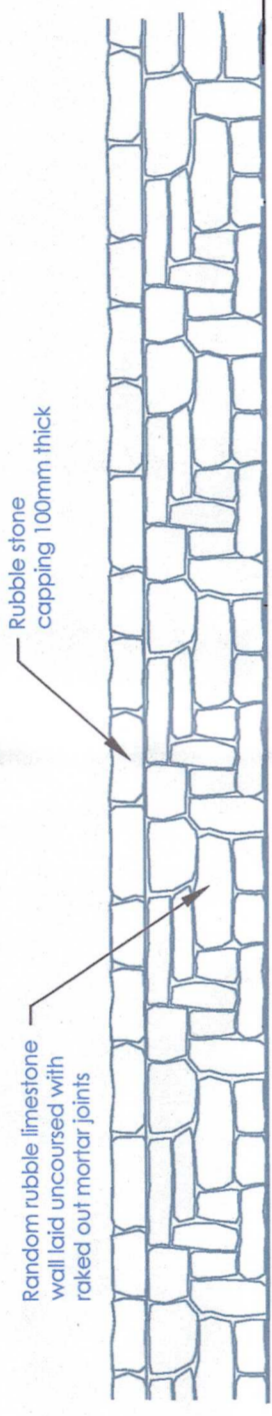

ELEVATION 1:25

## D21 1:25 Detail of low free standing wall to boundary of Public Open Spaces

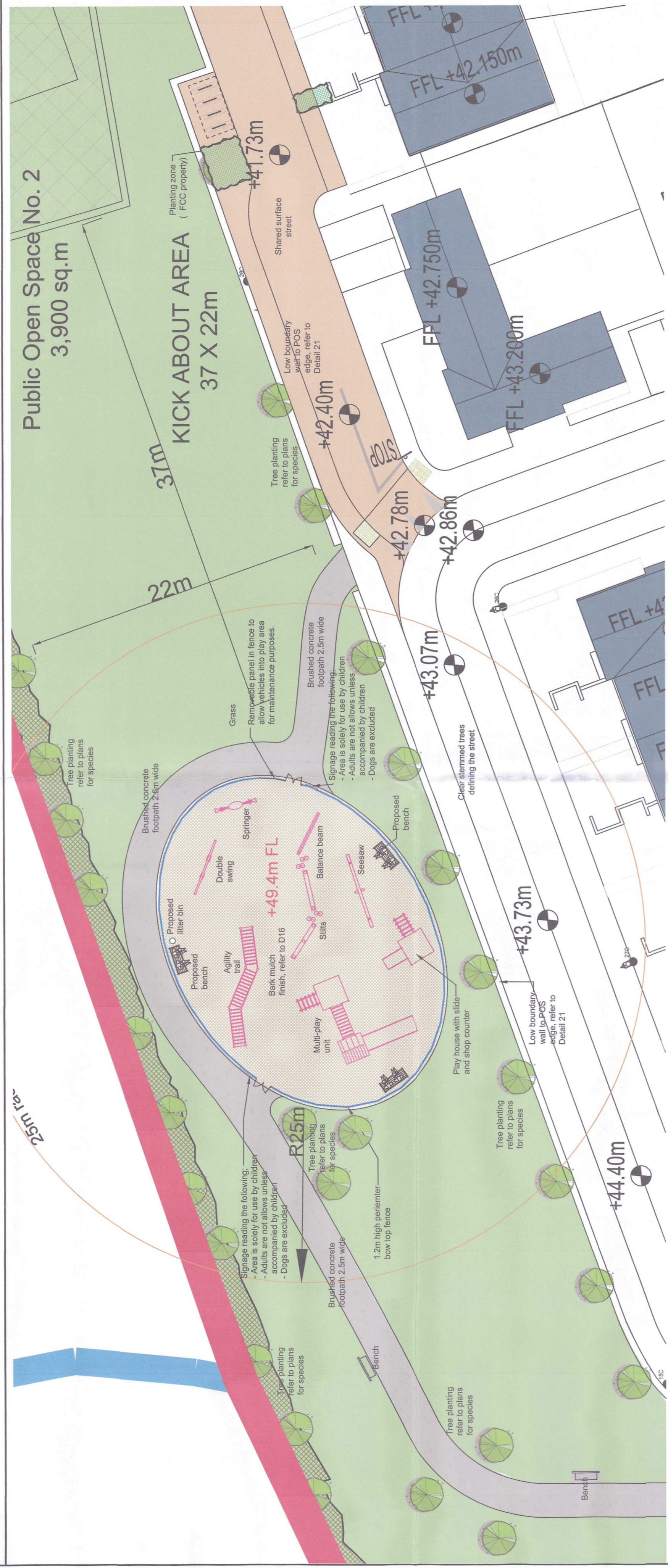

PLAY AREA G ( 400 sq.m)  
1:200 @ A1

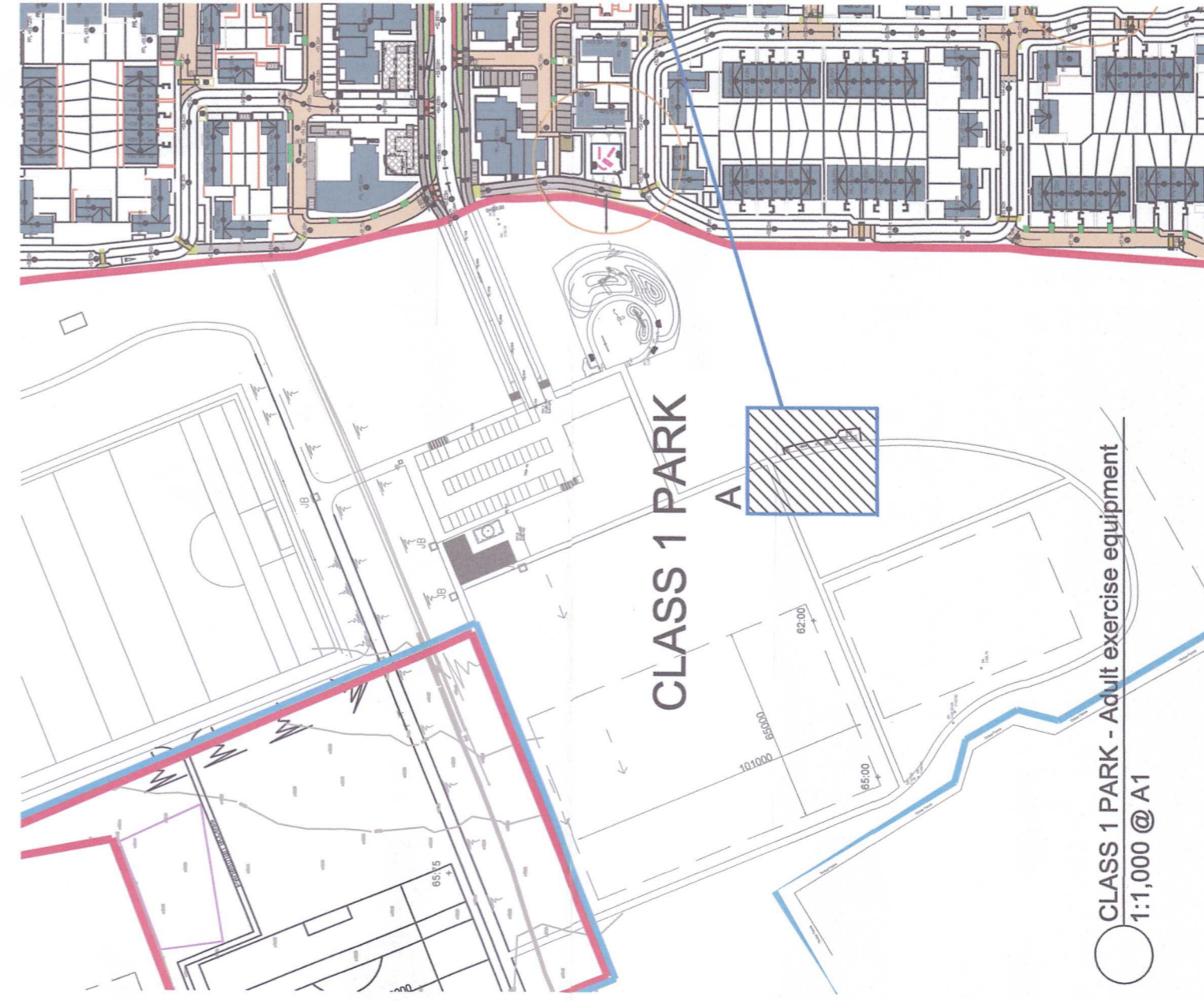

CLASS 1 PARK - Adult exercise equipment  
1:1,000 @ A1

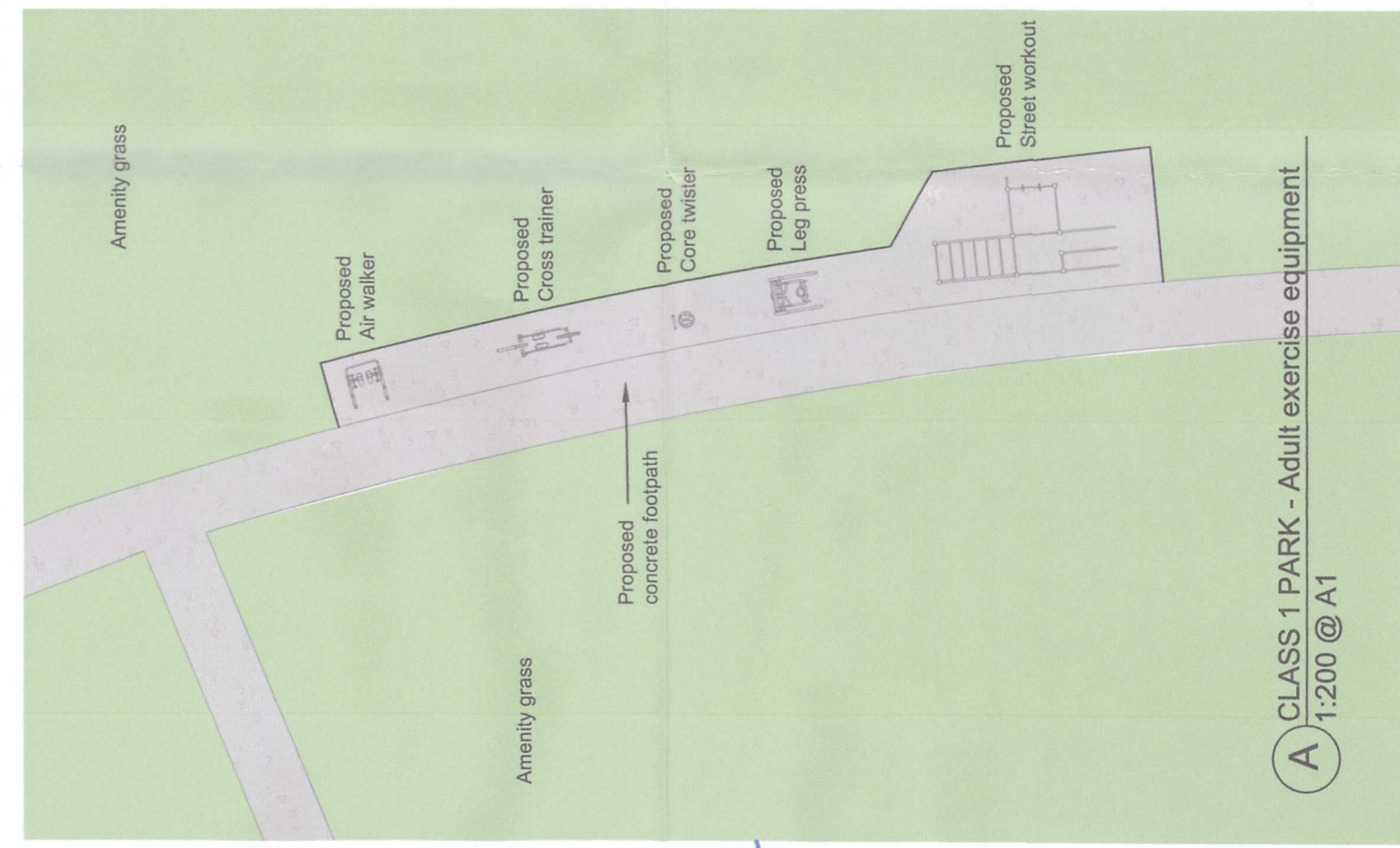

CLASS 1 PARK - Adult exercise equipment  
1:200 @ A1



PUBLIC OPEN SPACE NO. 4 - Adult exercise equipment  
1:200 @ A1

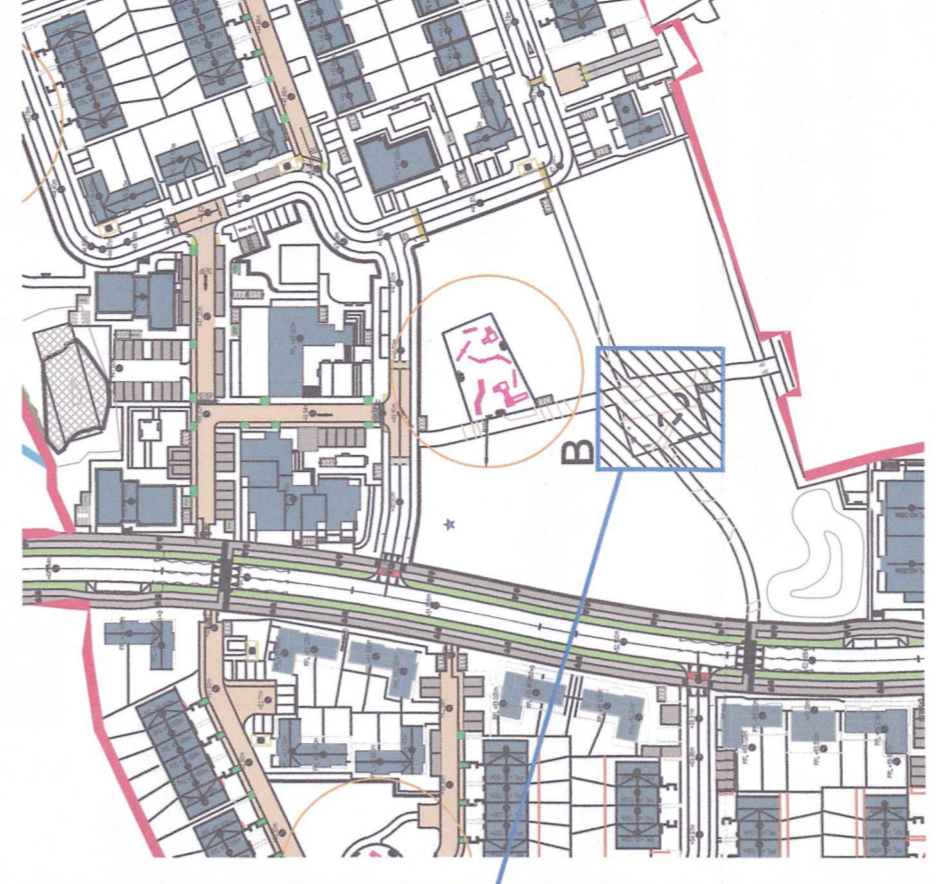

PUBLIC OPEN SPACE NO. 4 - Adult exercise equipment  
1:1,000 @ A1

AN BORD PLEANÁLA

20 MAR 2024

LTR DATED FROM APP  
LDG: 319343-24  
APP: 319343-24



Adult exercise equipment areas

NOT FOR CONSTRUCTION  
All dimensions and quantities shall be checked on site by the Contractor prior to ordering materials and commencing works. Any & all errors or discrepancies shall be brought to the attention of the Contract Administrator immediately.

Project:	North West Balbriggan Residential Development, Balbriggan, Co. Dublin
Client:	Dean Swift Property Holdings
Dwg title:	Play areas details Sheet 3 of 3
Scale:	1:200 @ A1
Chkd:	Ingrid Swan
Date:	12 March 2024
Drawn:	Noranne Scott
Dwg. No:	MAI-019-20-P24
Rev. No.:	

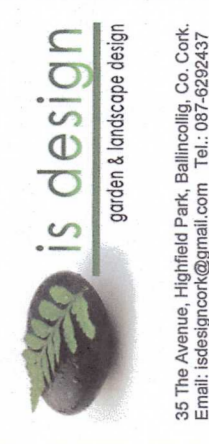

is design  
green & landscape design

55 The Avenue, Inghiread Park, Balbriggan, Co. Dub.  
0181 200 0000  
www.isdesign.ie