

Notes:
 - Do not scale from this drawing. Use figured dimensions in all cases.
 - Verify dimensions on site and report any discrepancies to the Architect immediately.
 - This drawing is to be read in conjunction with the Architect's Specification.
 - © This drawing is copyright and may only be reproduced with the Architect's permission.

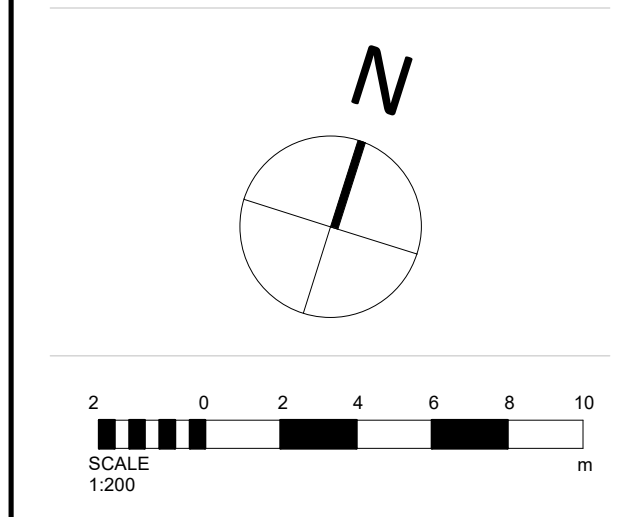
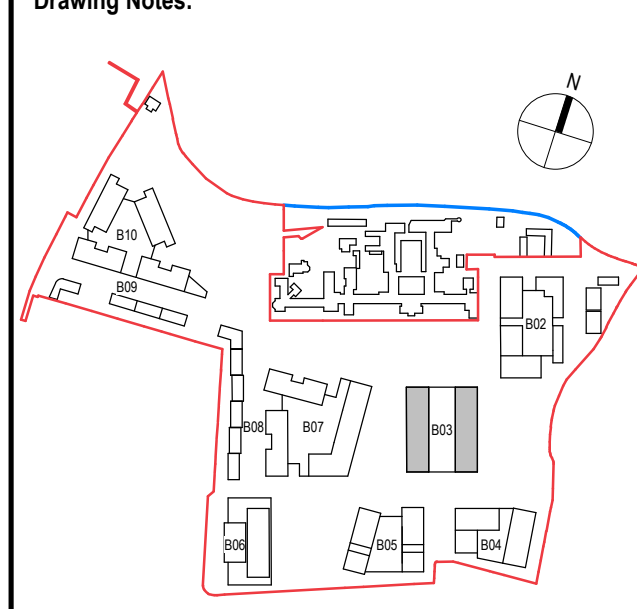

- Planning Legend**
- Site Boundary —
 - Residential Entrance ▲
 - Service Entrance ▲
 - 1B2P ■
 - 2B3P ■
 - 2B4P ■
 - 3B5P ■
 - Amenity ■
 - Restaurant ■
 - Retail ■

Rev.	Date	Drwn	Details of Issue / Revision
P3-S-1	Sept 2024	KP	Part 10 Planning Application
			Issues & Revisions

Dartry Mills,
Dartry Road
Dublin 6,
D06 Y0E3

T: +353 (0)1 498 7000
W: www.reddyarchitecture.com
E: info@reddyarchitecture.com

Applicant Details:
Dún Laoghaire-Rathdown County Council

Agent Details:
Land Development Agency

Project Details:
**Proposed Part 10 Residential Development,
 Dundrum Central Development,
 Dundrum Road,
 Dublin14**

Drawing Title:
Block 03, Fifth Floor, GA Plan

Job No. P19-233D	Sheet Size A1_Landscape	Scale @A1: 1 : 200
Issue Date: Sept 2024	Drawn By: K. Potocka	Reviewed By: R. Quinn

Status P3	Purpose of Issue Part 10 Planning Application
Project - System - Spatial Zone - Level - Type - Originator - Role - Number DCD-02-B03-L05-DR-RAU-AR-1305	Revision P3-S-1