

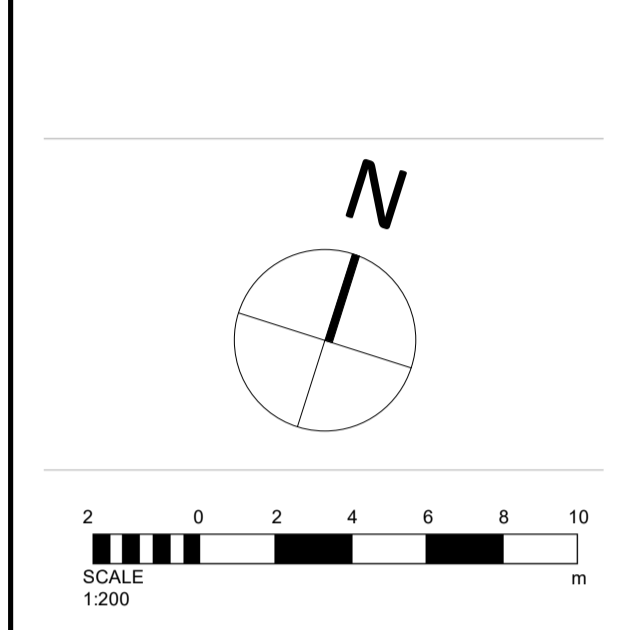

**Notes:**  
 - Do not scale from this drawing. Use figured dimensions in all cases.  
 - Verify dimensions on site and report any discrepancies to the Architect immediately.  
 - This drawing is to be read in conjunction with the Architect's Specification.  
 - © This drawing is copyright and may only be reproduced with the Architect's permission.

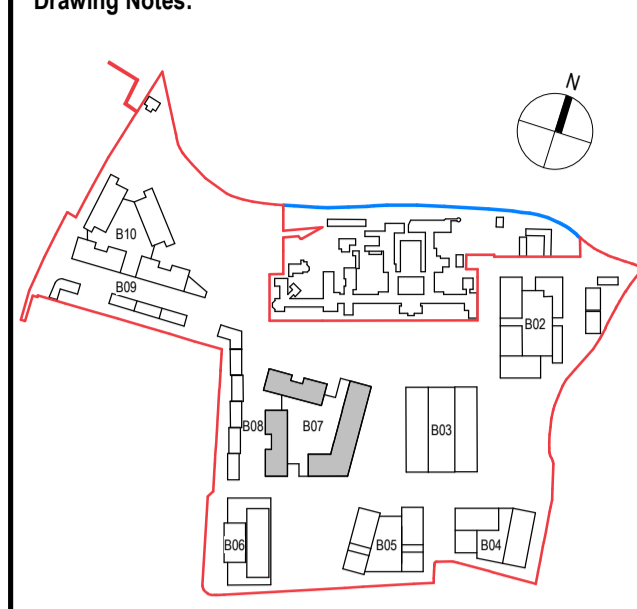

- Planning Legend**
- Site Boundary
  - Residential Entrance
  - Service Entrance
  - Commercial Entrance

- 1B2P
- 2B3P
- 2B4P
- 3B5P
- ASHP
- Bike Store
- BIN STORE
- Comms Room
- ESB SUB-STATION
- Gen. Room
- Letter Boxes
- Meter Room
- Plant
- Plant Room
- Retail
- Retail (Anchor)
- Retail Bin Store
- Sprinkler Room
- Switchroom
- Water Tank Room

Rev.	Date	Drawn	Details of Issue / Revision
P3 S-1	Sept 2024	KP	Part 10 Planning Application

Darity Mills,  
 Darity Road  
 Dublin 6,  
 D06 Y0E3  
 T: +353 (0)1 498 7000  
 W: www.reddyarchitecture.com  
 E: info@reddyarchitecture.com

Applicant Details:  
**Dún Laoghaire-Rathdown County Council**  
 Agent Details:  
**Land Development Agency**

Project Details:  
**Proposed Part 10 Residential Development, Dundrum Central Development, Dundrum Road, Dublin14**  
 Drawing Title:  
**Block 07, Sixth Floor, GA Plan**

Job No. <b>P19-233D</b>	Sheet Size <b>A1_Landscape</b>	Scale @A1: <b>1 : 200</b>
Issue Date: <b>Sept 2024</b>	Drawn By: <b>BG</b>	Reviewed By: <b>RQ</b>
Status <b>P3</b>	Purpose of Issue <b>Part 10 Planning Application</b>	
Project - System - Spatial Zone - Level - Type - Originator - Role - Number <b>DCD-02-B07-L06-DR-RAU-AR-1706</b>		Revision <b>P3 S-1</b>