

**NOTES**

- THIS DRAWING IS TO BE READ IN CONJUNCTION WITH ALL ENGINEERS & ARCHITECTS DRAWINGS FIGURED DIMENSIONS ONLY (NOT SCALING) TO BE USED, WHERE A CONFLICT OF INFORMATION EXISTS OR IF IN ANY DOUBT - ASK.
  - CONSULTANTS TO BE INFORMED IMMEDIATELY OF ANY DISCREPANCIES BEFORE WORK PROCEEDS.
- REFER TO DRAWING C-11001 FOR ROADS FINISHES, MARKINGS AND SIGNAGE.
- REFER TO DRAWING C-11100 FOR ROADS 1 & 2 LONGITUDINAL SECTIONS.
- REFER TO DRAWING C-11101 FOR ROADS 3, 4, 5 LONGITUDINAL SECTIONS.

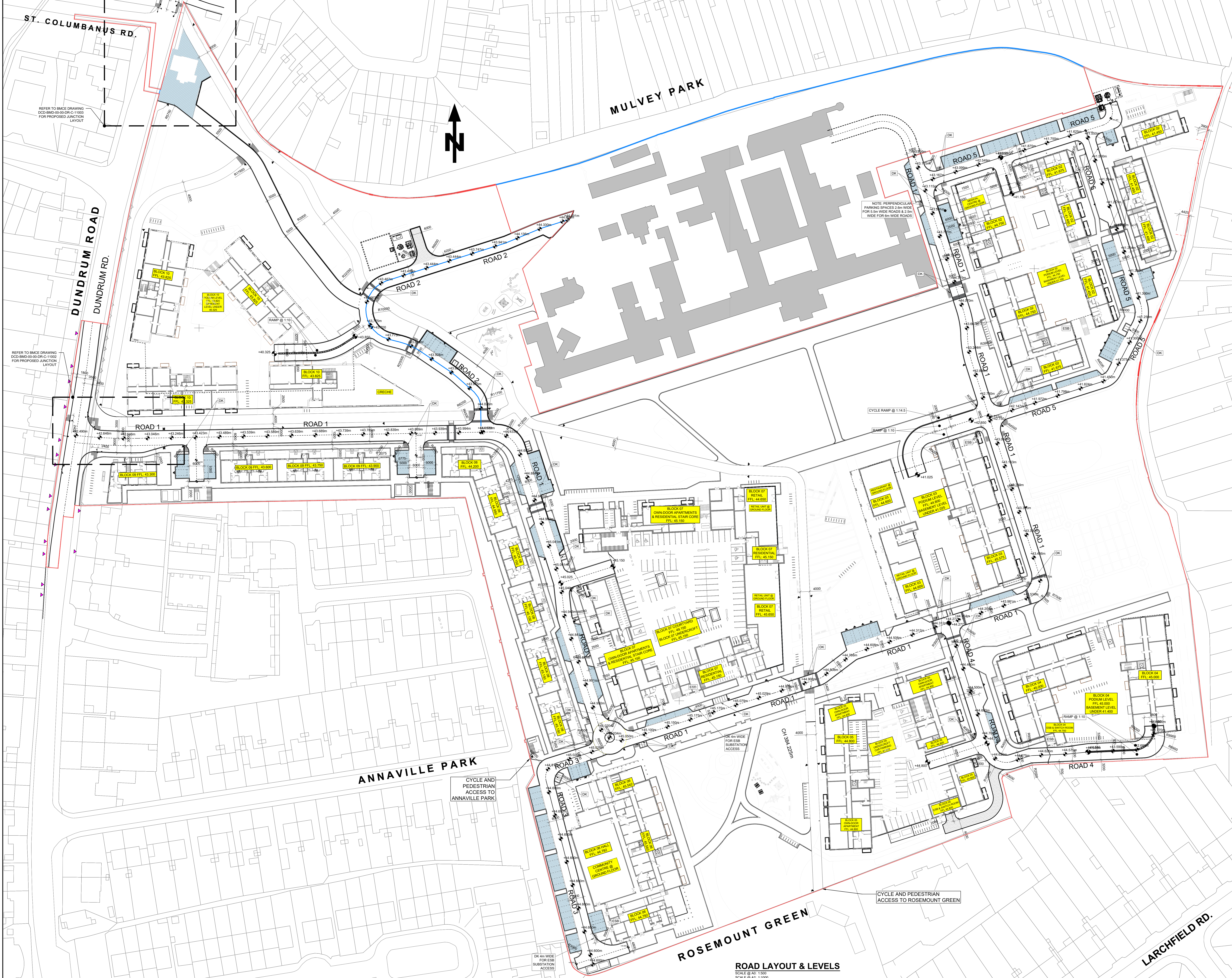

**ROAD LAYOUT & LEVELS**  
SCALE @ A2: 1:500  
SCALE @ A3: 1:1000

P3	05.09.24	ISSUED FOR PLANNING	WK
P2	10.07.24	ISSUED TO LDA FOR COMMENT	WK
P1	06.06.24	ISSUED FOR COMMENT	WK
ISSUE	DATE	DESCRIPTION	BY
Project Engineer: POD		Project Director: JPC	
<b>PLANNING</b>			
DUN LAOGHAIRE-RATHDOWN COUNTY COUNCIL LAND DEVELOPMENT AGENCY			
PROJECT TITLE PROPOSED PART 10 RESIDENTIAL DEVELOPMENT, DUNDRUM CENTRAL DEVELOPMENT, DUNDRUM ROAD, DUBLIN 14.			BM PROJECT No. <b>20.170</b>
REFERENCE	SUITABILITY	REVISION	
DRAWING TITLE <b>ROADS LAYOUT &amp; LEVELS</b>			
DRAWING REFERENCE <b>DCD-BMD-00-00-DR-C-11000</b>	STATUS <b>P3</b>	REVISION	