

NOTES

- THIS DRAWING IS TO BE READ IN CONJUNCTION WITH ALL ENGINEERS & ARCHITECTS' DRAWINGS FIGURED DIMENSIONS ONLY (NOT SCALING) TO BE USED. WHERE A CONFLICT OF INFORMATION EXISTS OR IF IN ANY DOUBT - 'ASK'.
- CONSULTANTS TO BE INFORMED IMMEDIATELY OF ANY DISCREPANCIES BEFORE WORK PROCEEDS.

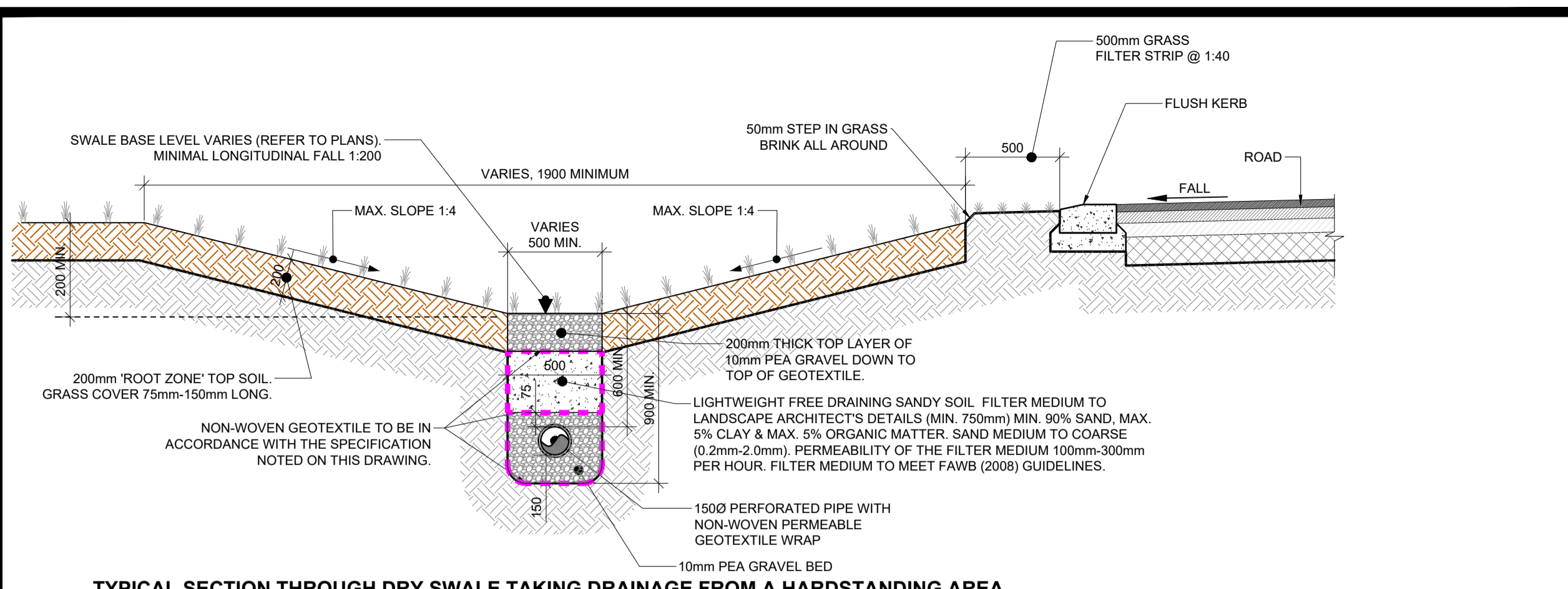

TYPICAL SECTION THROUGH DRY SWALE TAKING DRAINAGE FROM A HARDSTANDING AREA

C1 DETAIL
SCALE @ A1: 1:25
SCALE @ A3: 1:50

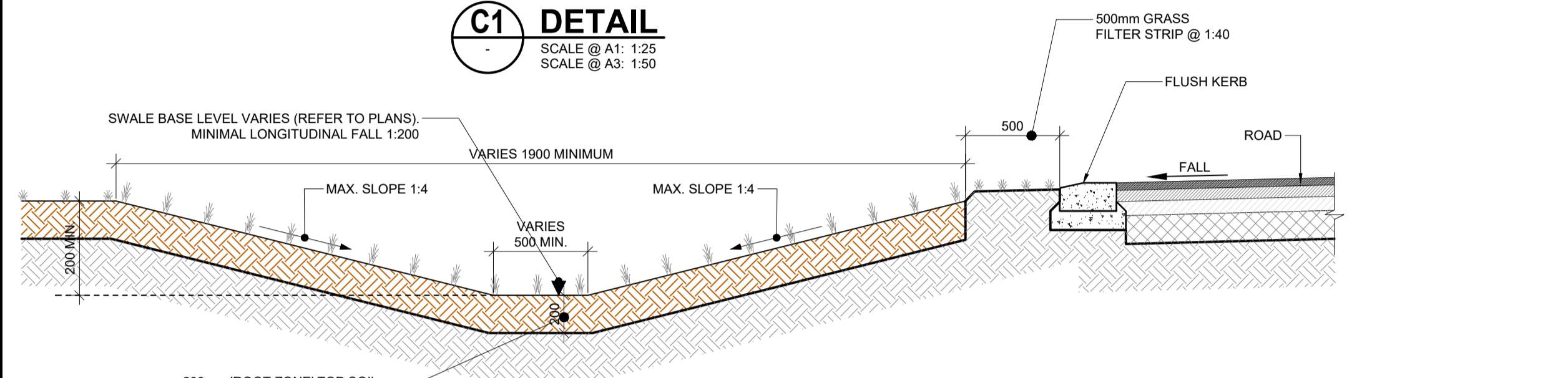

TYPICAL SECTION THROUGH WET SWALE TAKING DRAINAGE FROM A HARDSTANDING AREA

C2 DETAIL
SCALE @ A1: 1:25
SCALE @ A3: 1:50

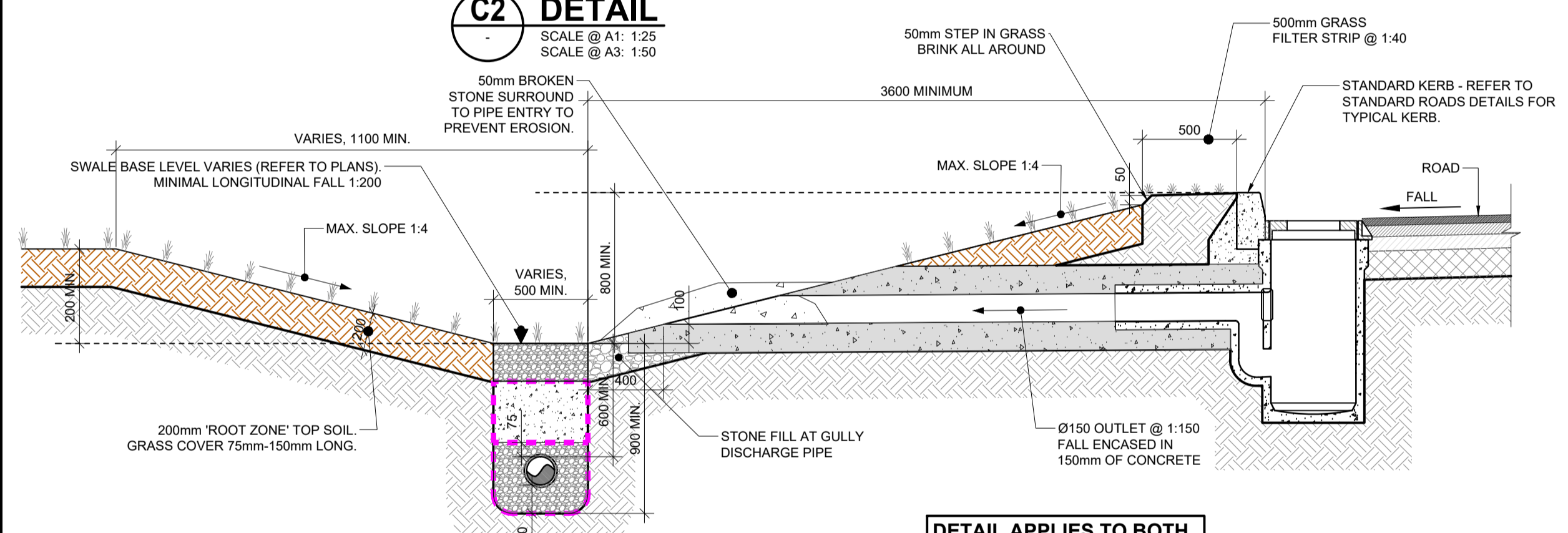

TYPICAL SECTION THROUGH SWALE TAKING DRAINAGE FROM A ROAD GULLY

C3 DETAIL
SCALE @ A1: 1:25
SCALE @ A3: 1:50

DETAIL APPLIES TO BOTH DRY SWALE (DETAIL C1) & WET SWALE (DETAIL C2).

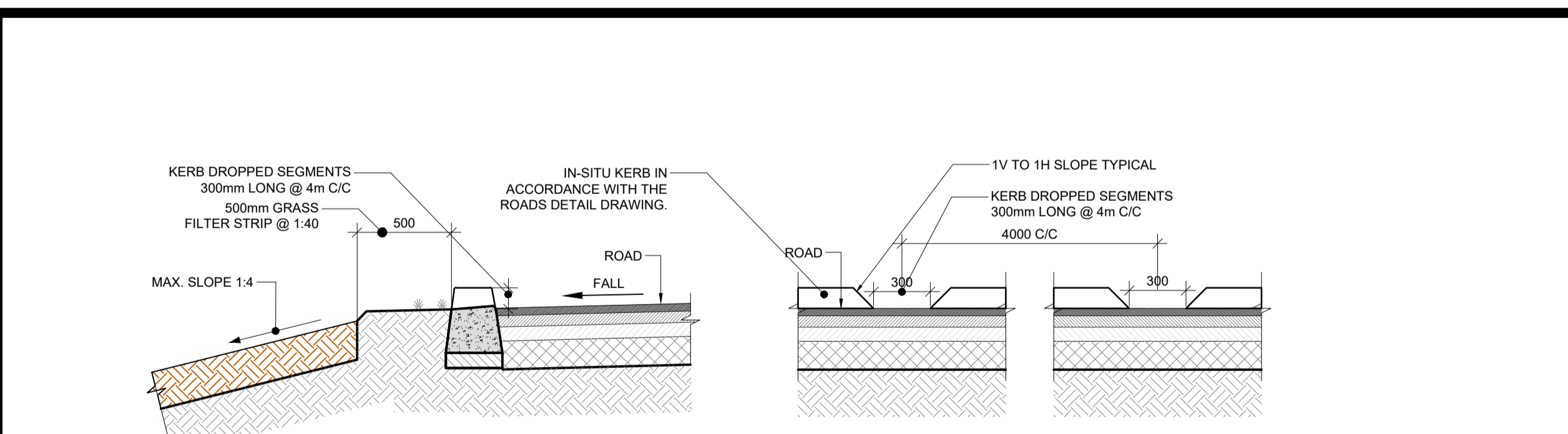

TYPICAL SECTION TYPICAL ELEVATION DROPPED KERB DETAIL @ 4m C/C (ALTERNATIVE TO FLUSH KERB DETAIL FOR OVER-THE-EDGE ROAD DRAINAGE)

F DETAIL
SCALE @ A1: NTS
SCALE @ A3: NTS

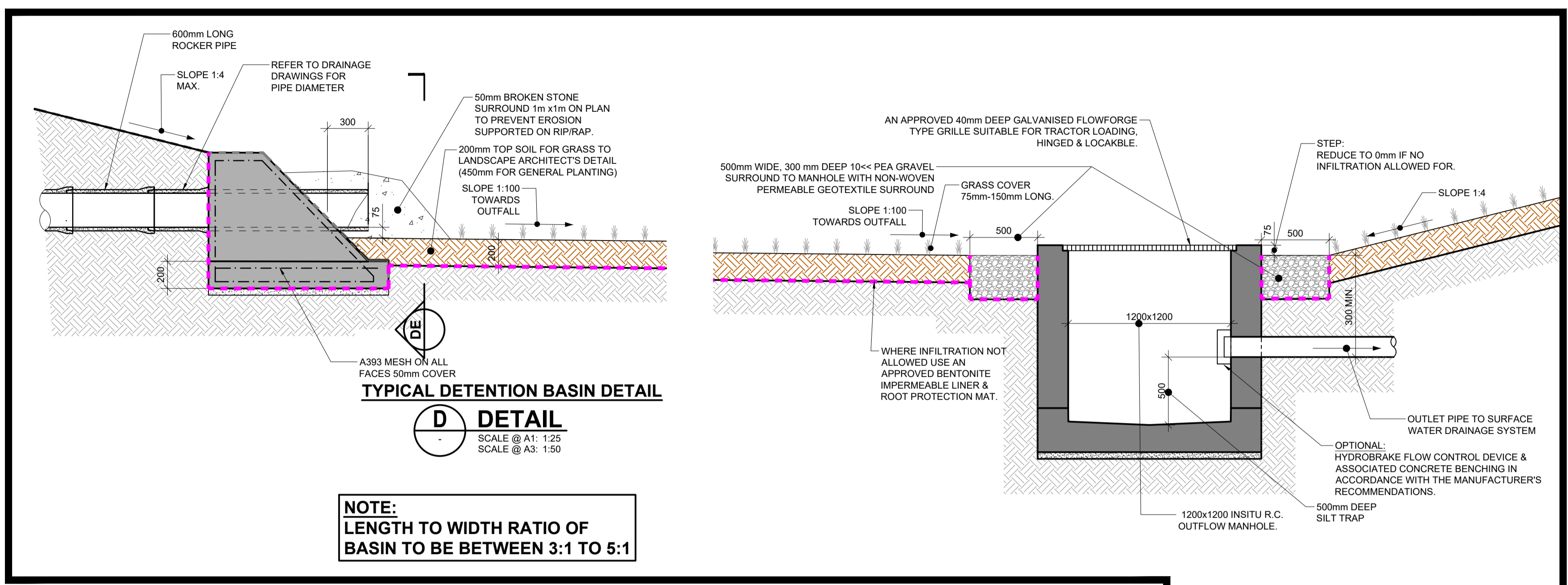

TYPICAL DETENTION BASIN DETAIL

D DETAIL
SCALE @ A1: 1:25
SCALE @ A3: 1:50

NOTE: LENGTH TO WIDTH RATIO OF BASIN TO BE BETWEEN 3:1 TO 5:1

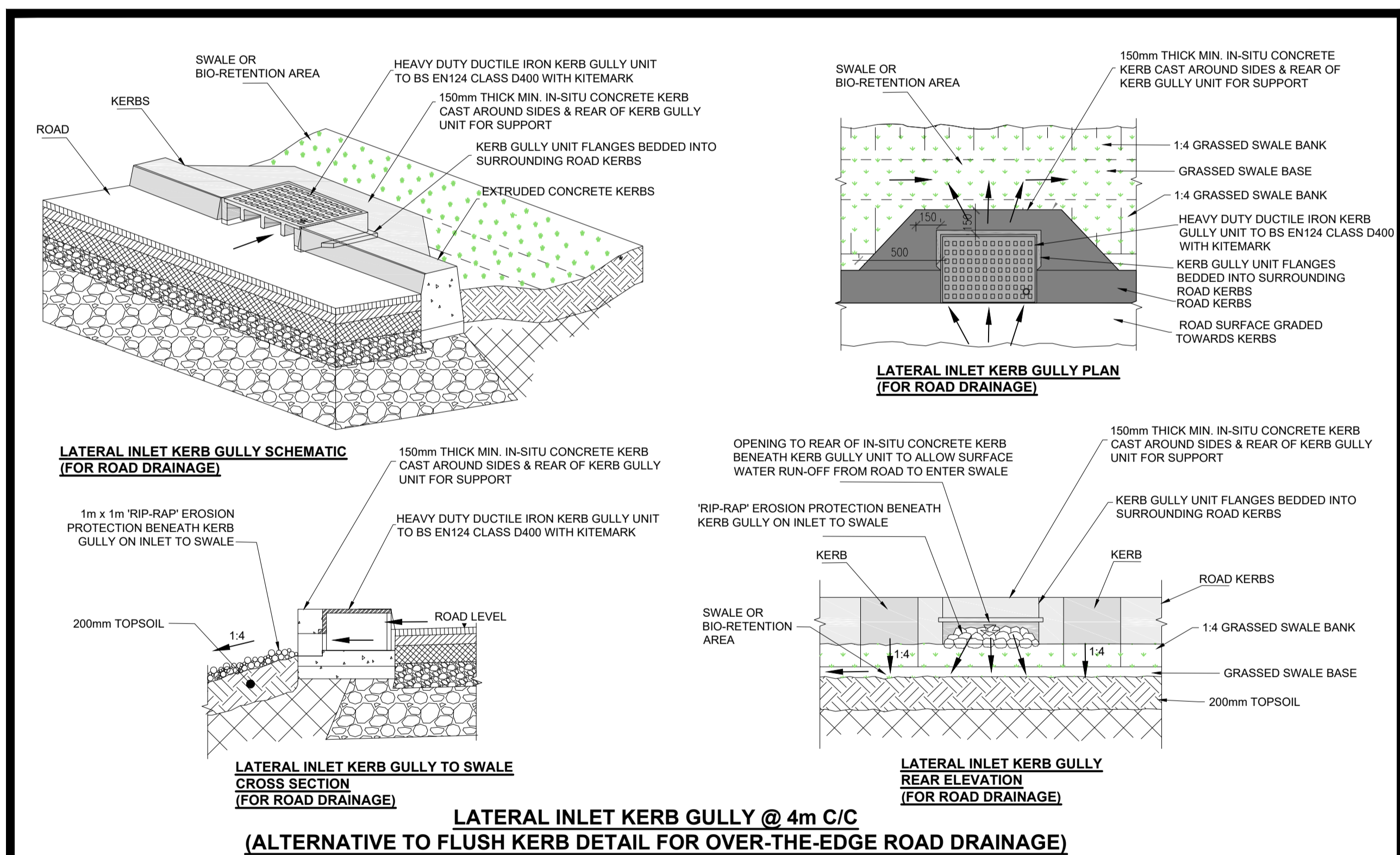

LATERAL INLET KERB GULLY SCHEMATIC (FOR ROAD DRAINAGE)

LATERAL INLET KERB GULLY TO SWALE CROSS SECTION (FOR ROAD DRAINAGE)

LATERAL INLET KERB GULLY @ 4m C/C (ALTERNATIVE TO FLUSH KERB DETAIL FOR OVER-THE-EDGE ROAD DRAINAGE)

E DETAIL
SCALE @ A1: NTS
SCALE @ A3: NTS

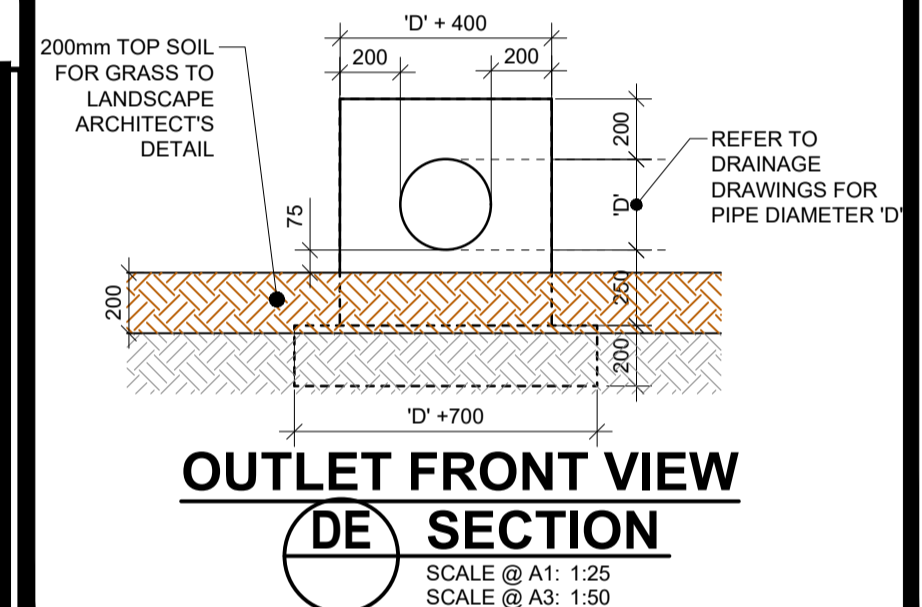

OUTLET FRONT VIEW DE SECTION

SCALE @ A1: 1:25
SCALE @ A3: 1:50

MAINTENANCE OF SWALES & DETENTION BASINS:

- REGULAR GRASS MOWING.
- SEDIMENT REMOVED IF EQUAL OR MORE THAN 25mm DEEP.
- CLEARANCE OF ANY BLOCKAGES TO INLETS & OUTLETS.
- SILT TRAP CLEANING.
- REPAIR COMPACTED OR DAMAGED AREAS.

NON-WOVEN GEOTEXTILE SPECIFICATION. THE GEOTEXTILE SHALL:

- SUSTAIN A TENSILE LOAD OF NOT LESS THAN 5.0kN/m AT BREAK AND HAVE A MINIMUM FAILURE STRAIN OF 10% WHEN DETERMINED IN ACCORDANCE WITH IS EN ISO 10319;
- HAVE A MINIMUM PUNCTURE RESISTANCE OF 1200 N WHEN DETERMINED IN ACCORDANCE WITH IS EN ISO 12236;
- HAVE A SIZE DISTRIBUTION OF PORE OPENINGS SUCH THAT THE APPARENT OPENING SIZE Ø90 WHEN DETERMINED IN ACCORDANCE WITH IS EN ISO 12956, OR OTHER APPROPRIATE TEST, IS LESS THAN 300 MICRONS
- ALLOW WATER TO FLOW THROUGH IT, IN EITHER DIRECTION, NORMAL TO ITS PRINCIPAL PLANE AT A RATE OF NOT LESS THAN 10 l/m²/s, UNDER A CONSTANT HEAD OF WATER OF 100mm AND A MAXIMUM BREAKTHROUGH HEAD OF 50MM WHEN DETERMINED IN ACCORDANCE WITH IS EN ISO 12958.

ISSUE	DATE	DESCRIPTION	MR	MS	POD	JPC
P3	05.09.24	ISSUED FOR PLANNING				
P2	10.07.24	ISSUED TO LDA FOR COMMENT				
P1	06.06.24	ISSUED FOR COMMENT				

PLANNING

BM Dublin Office: Sandwith House, 52-54 Lower Sandwith Street, Dublin 2, Ireland. Tel: (01) 677 3200 Fax: (01) 677 3164
London Office: 12 Mill Street, London SE1 2AY, United Kingdom Tel: (0044) 084 5413 2722
Consulting Engineers, Civil, Structural, Project Management. E-mail: bmce@bmce.ie Web: www.bmce.ie

Barrett Mahony The Institution of Structural Engineers ACEI International Federation of Consulting Engineers

APPLICANT DÚN LAOGHAIRE-RATHDOWN COUNTY COUNCIL	
AGENT LAND DEVELOPMENT AGENCY	
PROJECT TITLE PROPOSED PART 10 RESIDENTIAL DEVELOPMENT, DUNDRUM CENTRAL DEVELOPMENT, DUNDRUM ROAD, DUBLIN 14.	BM PROJECT No. 20.170
MODEL REFERENCE	MODEL REV. SUITABILITY

DRAWING TITLE
SuDS DETAILS. SWALES, DETENTION BASIN & OVER-THE-EDGE ROAD DRAINAGE.

DRAWING No. DCD-BMD-00-00-DR-C-11210	ISSUE P3
--	--------------------