

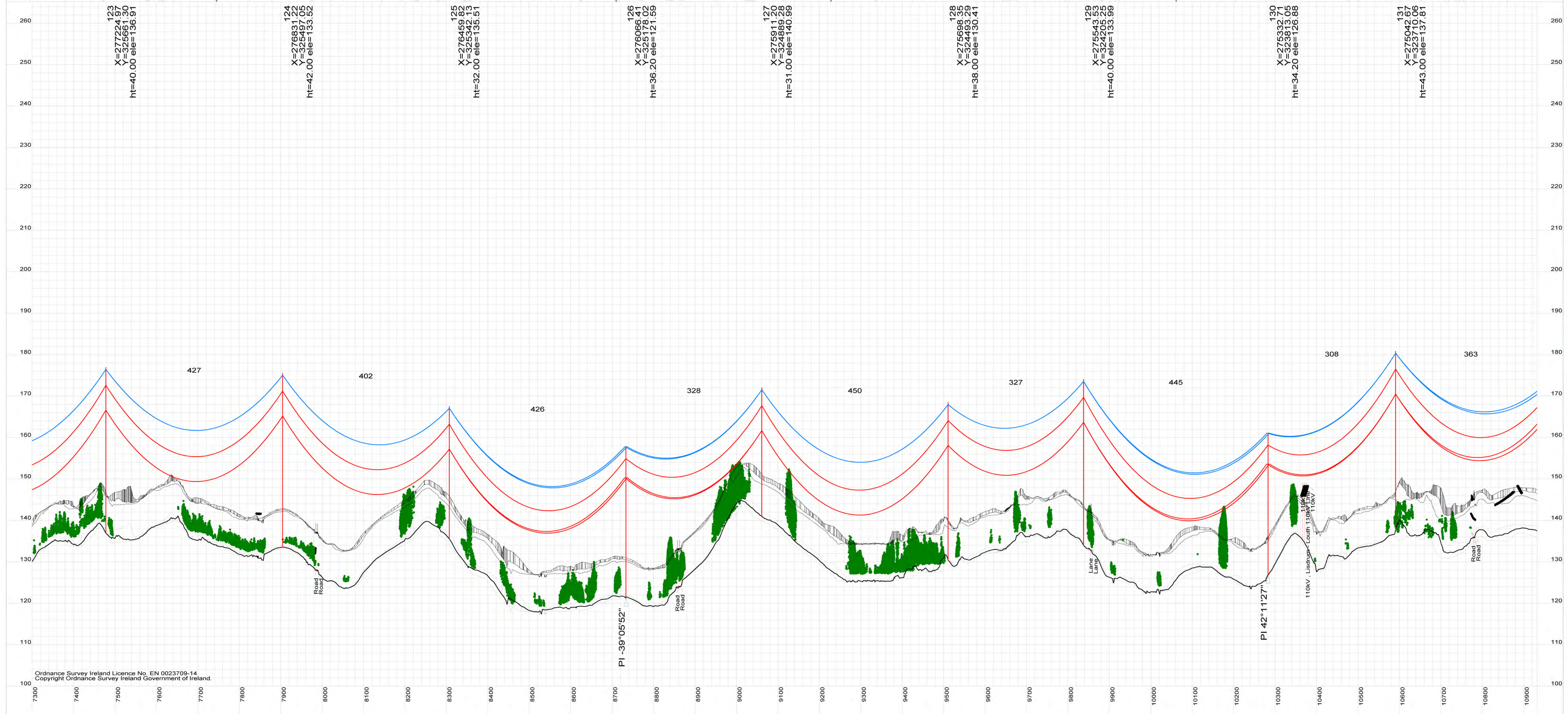

LiDAR data
 flown in October 2013
 (80m)

123 X=277224.97 Y=325661.30 ht=40.00 ele=136.91	124 X=276831.22 Y=325491.05 ht=42.00 ele=135.52	125 X=276459.82 Y=325315.01 ht=32.00 ele=135.01	126 X=276099.02 Y=325141.59 ht=36.20 ele=121.59	127 X=275911.20 Y=324493.28 ht=31.00 ele=140.99	128 X=275698.35 Y=324493.29 ht=38.00 ele=130.41	129 X=275543.25 Y=324205.25 ht=40.00 ele=133.99	130 X=275332.71 Y=323813.05 ht=34.20 ele=126.88	131 X=275042.67 Y=323719.96 ht=43.00 ele=137.81
----------------------------------------------------------	----------------------------------------------------------	----------------------------------------------------------	----------------------------------------------------------	----------------------------------------------------------	----------------------------------------------------------	----------------------------------------------------------	----------------------------------------------------------	----------------------------------------------------------

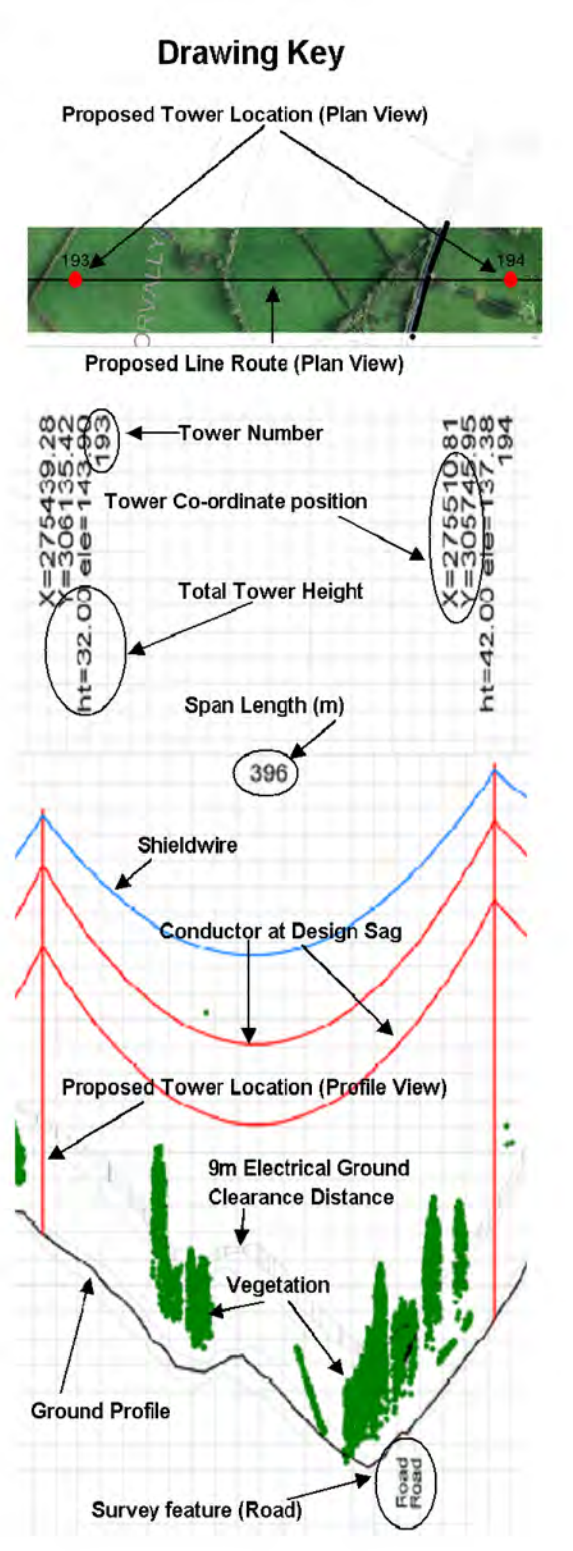

Notes:
 Figured Dimensions only to be taken from this drawing.
 All levels relate to Ordnance Survey Datum at Malin Head

DRAFT

COPYRIGHT © INTERNATIONAL LIMITED
 All rights reserved. No part of this work may be modified or reproduced or copied in any form or by means - graphic, electronic or mechanical, including photocopying, recording, taping or information and retrieval system, or used for any purpose other than its designated purpose, without the written permission of ESB International limited.

ESB INTERNATIONAL
 ESB International
 18/21 Stephen Court, St Stephen's Green, Dublin 2
 Tel: 353 1 703 8000 Email: marketing@esbi.ie Web: www.esbi.ie
 ESB International is a trading name of ESB Engineering & Facility Management Ltd
 Registered Office as above Registered in Ireland No. 155249

PURPOSE OF ISSUE:
 Preliminary unless indicated

For Information Planning
 Client Approval Revised
 ESB Legal Services Tender
 Construction As-Built Drawing

CLIENT:
 EirGrid

PROJECT:
 North South 400kV Interconnection Development

CLIENT:
 Cavan Monaghan Study Area (CMSA) Proposed Line Route Design
 Plan & Profile

DRAWN: J.W	PRODUCED: J.W	VERIFIED: K.C	APPROVED: C.M	APP DATE: Jan 14
CLIENT REF: (Planning Drawing Reference) MT - 005-03			No. of Sheets: 3/32	SIZE: A1
DRAWING NUMBER: PE687 - D141 - 132 - 03 - 003				SCALE: V: 1:500 H: 1:5000
SHEET				REV