

50.0 m Horiz. Scale  
5.0 m Vert. Scale

LiDAR data  
flow in October 2013  
(80m)

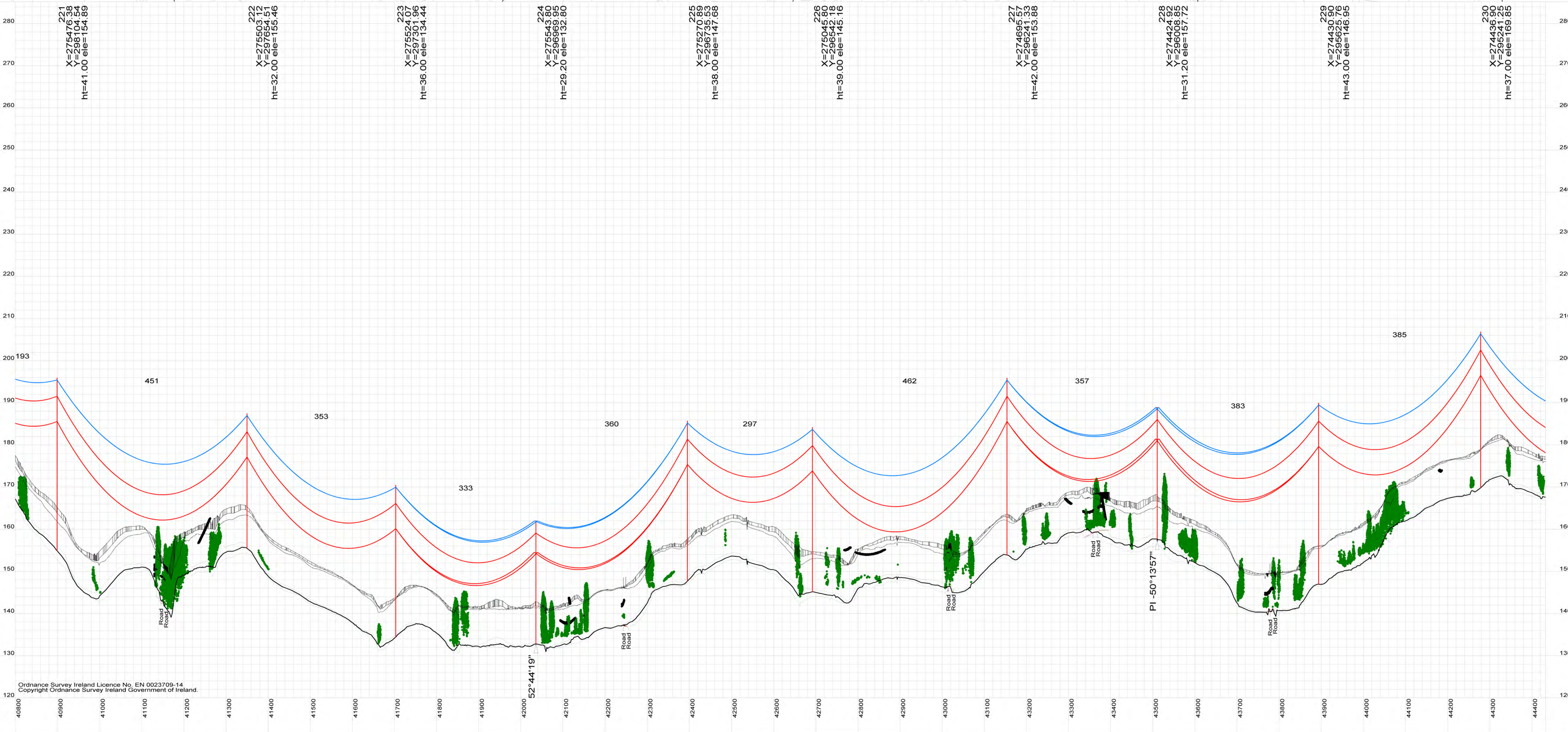

**Drawing Key**

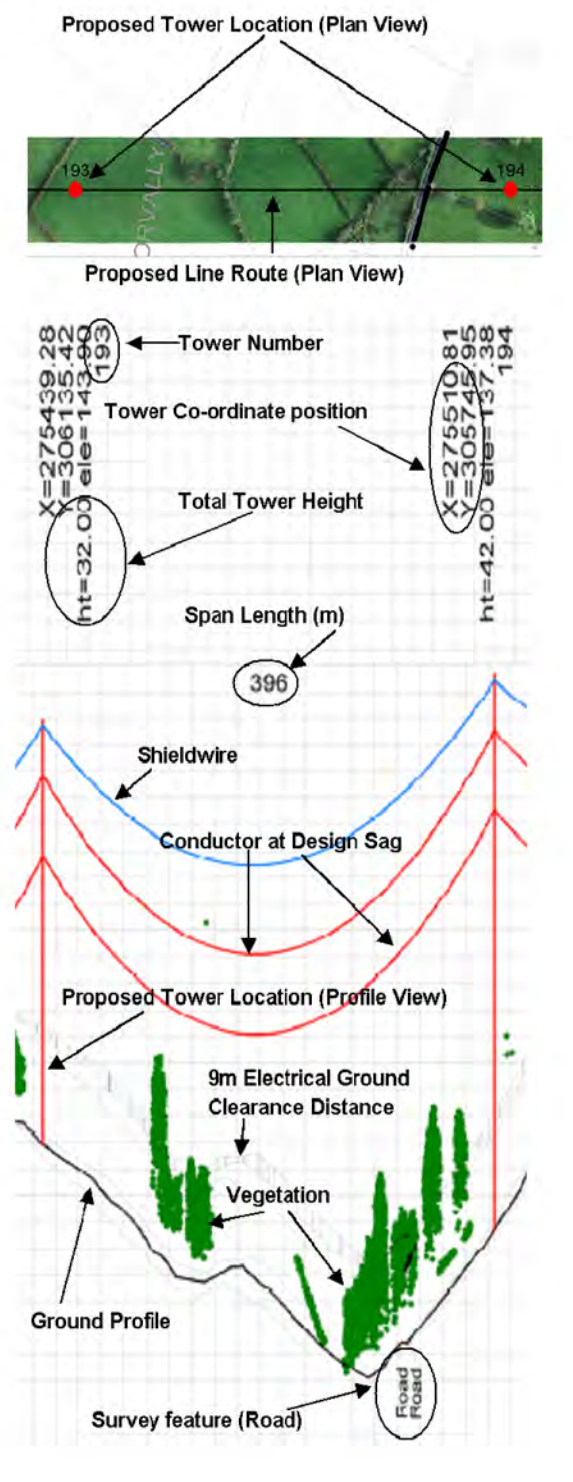

Notes:  
Figured Dimensions only to be taken from this drawing.  
All levels relate to Ordnance Survey Datum at Malin Head

**DRAFT**

COPYRIGHT © INTERNATIONAL LIMITED  
All rights reserved. No part of this work may be modified or reproduced or copied in any form or by means - graphic, electronic or mechanical, including photocopying, recording, taping or information and retrieval system, or used for any purpose other than its designated purpose, without the written permission of ESB International limited.

ESB International  
18/21 Stephen Court, St Stephen's Green, Dublin 2  
Tel: 353 1 703 8000 Email: marketing@esbi.ie Web: www.esbi.ie  
ESB International is a trading name of ESBI Engineering & Facility Management Ltd  
Registered Office as above Registered in Ireland No. 155249

PURPOSE OF ISSUE:  
Preliminary unless indicated

For Information  Planning   
Client Approval  Revised   
ESB Legal Services  Tender   
Construction  As-Built Drawing

CLIENT:  
**EirGrid**

PROJECT:  
**North South 400kV Interconnection Development**

CLIENT:  
**Cavan Monaghan Study Area (CMSA) Proposed Line Route Design**  
**Plan & Profile**

DRAWN: <b>J.W</b>	PRODUCED: <b>J.W</b>	VERIFIED: <b>K.C</b>	APPROVED: <b>C.M</b>	APP DATE: <b>Jan 14</b>
CLIENT REF: (Planning Drawing Reference) <b>MT - 005-013</b>			No. of Sheets: <b>13/32</b>	SIZE: <b>A1</b>
DRAWING NUMBER: <b>PE687 - D141 - 132 - 013 - 003</b>			SCALE: <b>V: 1:500 H: 1:5000</b>	SHEET REV