

**PALISADE FENCING
GENERAL ARRANGEMENT**
SCALE 1:500

Note:
For sections and further details refer to Drawing No: MT-006-004
For Location of Woodland Substation please refer to Drg. No: MT-006-001 & MT-006-002

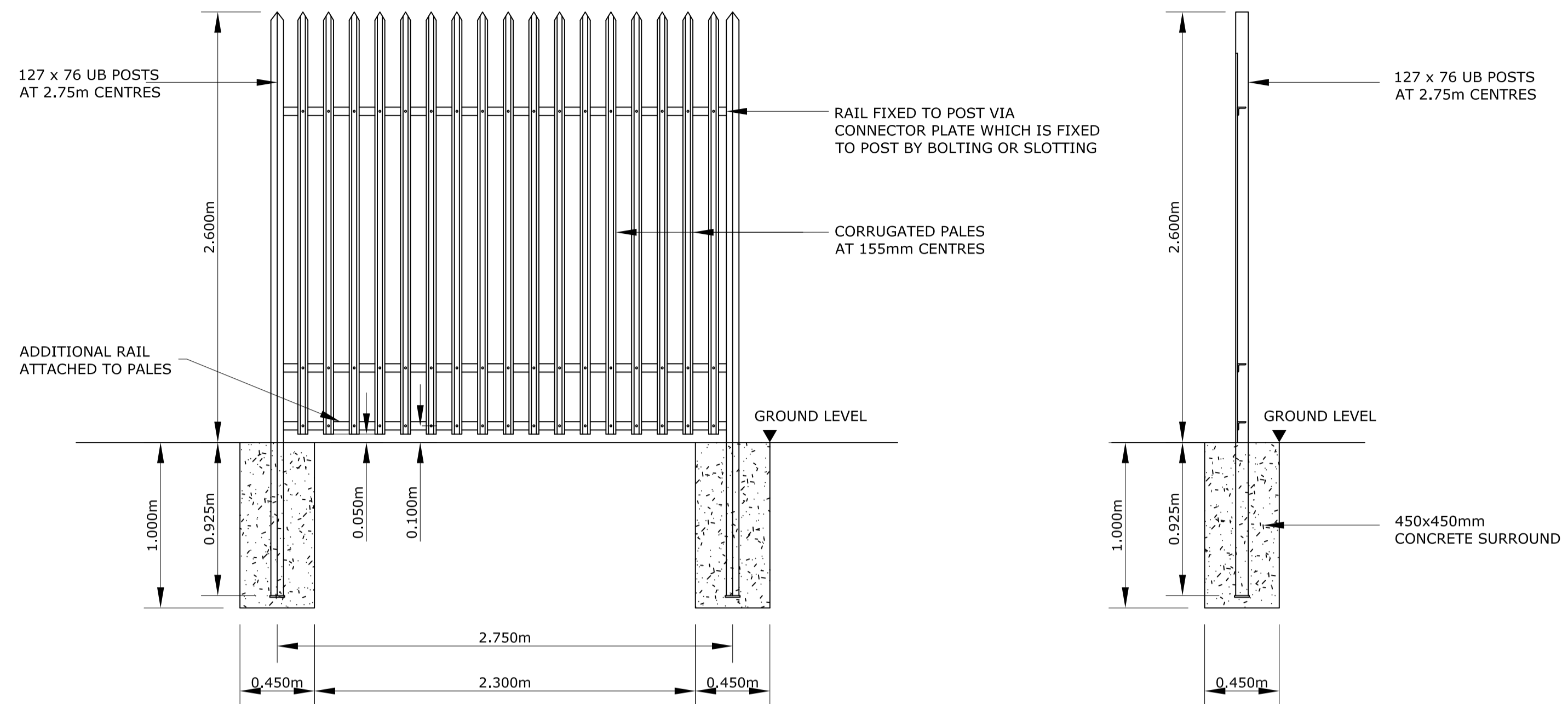

**DETAIL A
TYPICAL ARRANGEMENT OF STEEL PALISADE FENCE**
SCALE 1:25

- Legend:**
- Woodland Substation Planning Area
 - Existing Equipment
 - Proposed Equipment
 - Existing Fencing
 - Existing Fencing to be removed
 - Proposed New Fencing

DRAFT

- NOTES:**
- FIGURED DIMENSIONS ONLY TO BE TAKEN FROM THIS DRAWING.
 - ALL LEVELS SHOWN RELATE TO ORDNANCE SURVEY DATUM AT MALIN HEAD

Rev	Date	Description	By	Chkd.
A	Jan.'14	PLANNING ISSUE	MN	DG

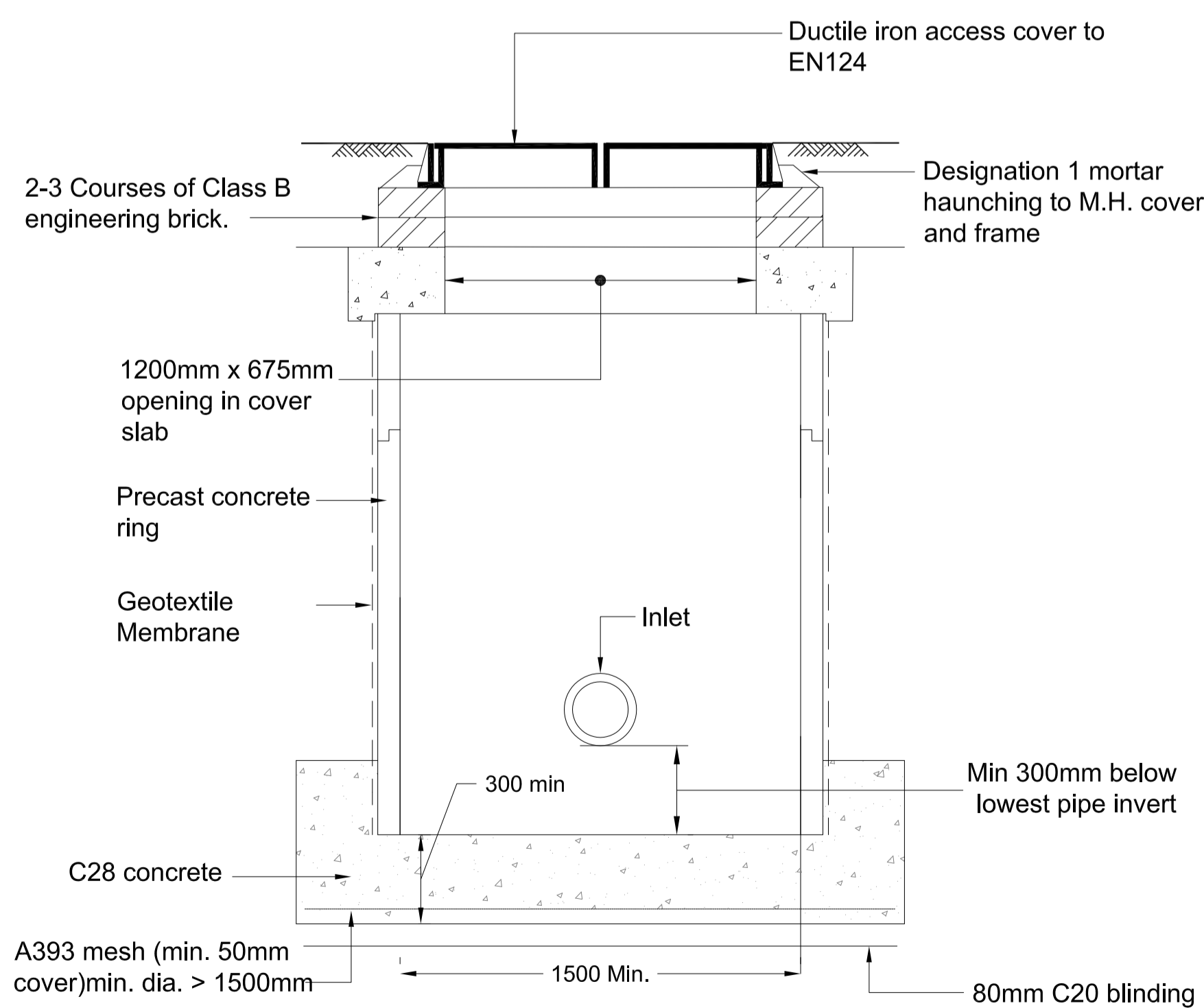

TYPICAL PRECAST MANHOLE DETAIL
SCALE 1:20

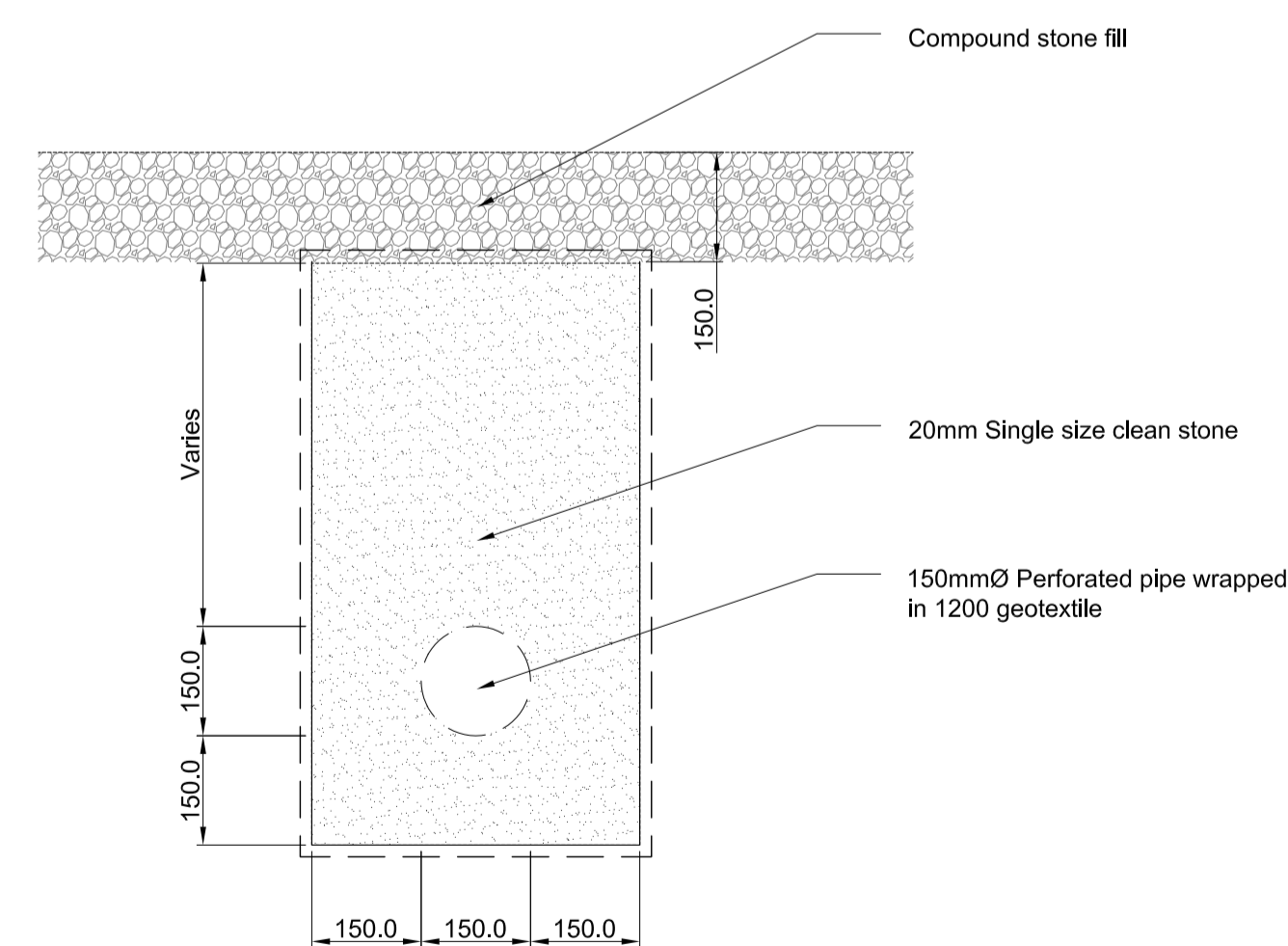

TYPICAL LAND DRAIN DETAIL
Scale 1:10

Note:
For drainage layout refer to Drawing No: MT-006-005

Client:

Project: **NORTH - SOUTH 400 KV INTERCONNECTION DEVELOPMENT**

Title: **MEATH STUDY AREA (MSA) WOODLAND 400 KV SUBSTATION TYPICAL DETAILS**

Scale @ A1: **AS SHOWN**

Prepared by: M. Nolan	Checked: D. Grehan	Date: January 2014
Project Director: D. Grehan		
Planning Dwg. Ref: MT-006-006		

TOBIN
Patrick J. Tobin & Co. Ltd.

TOBIN Consulting Engineers,
Block 10-4, Blanchardstown Corporate Park,
Dublin 15, Ireland.
tel: +353-(0)1-8030406
fax: +353-(0)1-8030409
e-mail: dublin@tobin.ie
www.tobin.ie

TOBIN Consulting Engineers will not be liable for any use of this document for any purpose other than that for which it was originally prepared and intended. Except where specifically and explicitly agreed in writing by TOBIN Consulting Engineers, no copyright holder, no part of this document may be reproduced or transmitted in any form and this document shall not be relied upon by any third party for any purpose.

Drawing No.: **6244-2057** Revision: **A**