

This material is based upon Crown Copyright and is reproduced with the permission of Land & Property Services under delegated authority from the Controller of Her Majesty's Stationery Office. © Crown Copyright & database rights FLA213. Unauthorised reproduction infringes © Crown copyright and may lead to prosecution or civil proceedings.

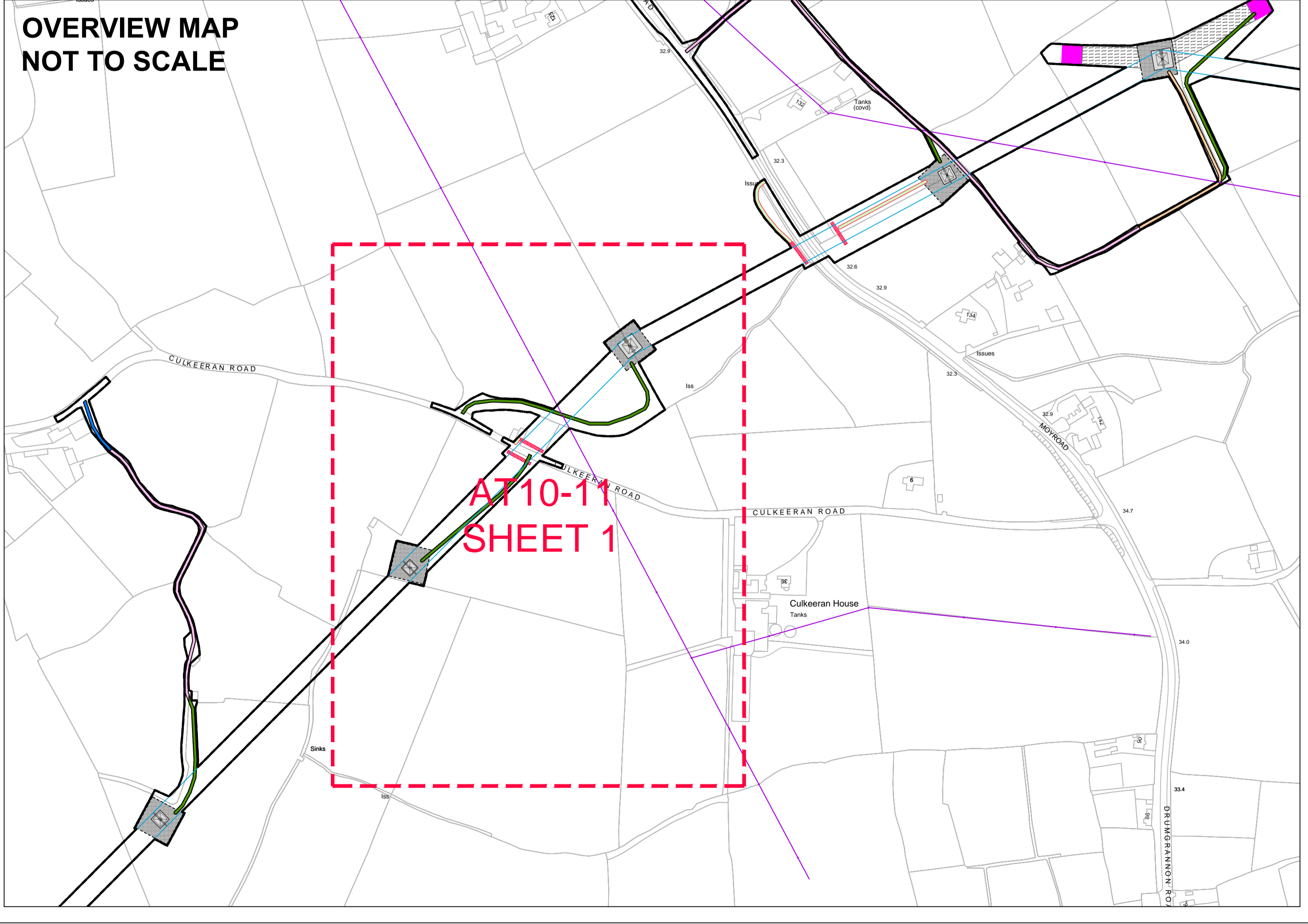
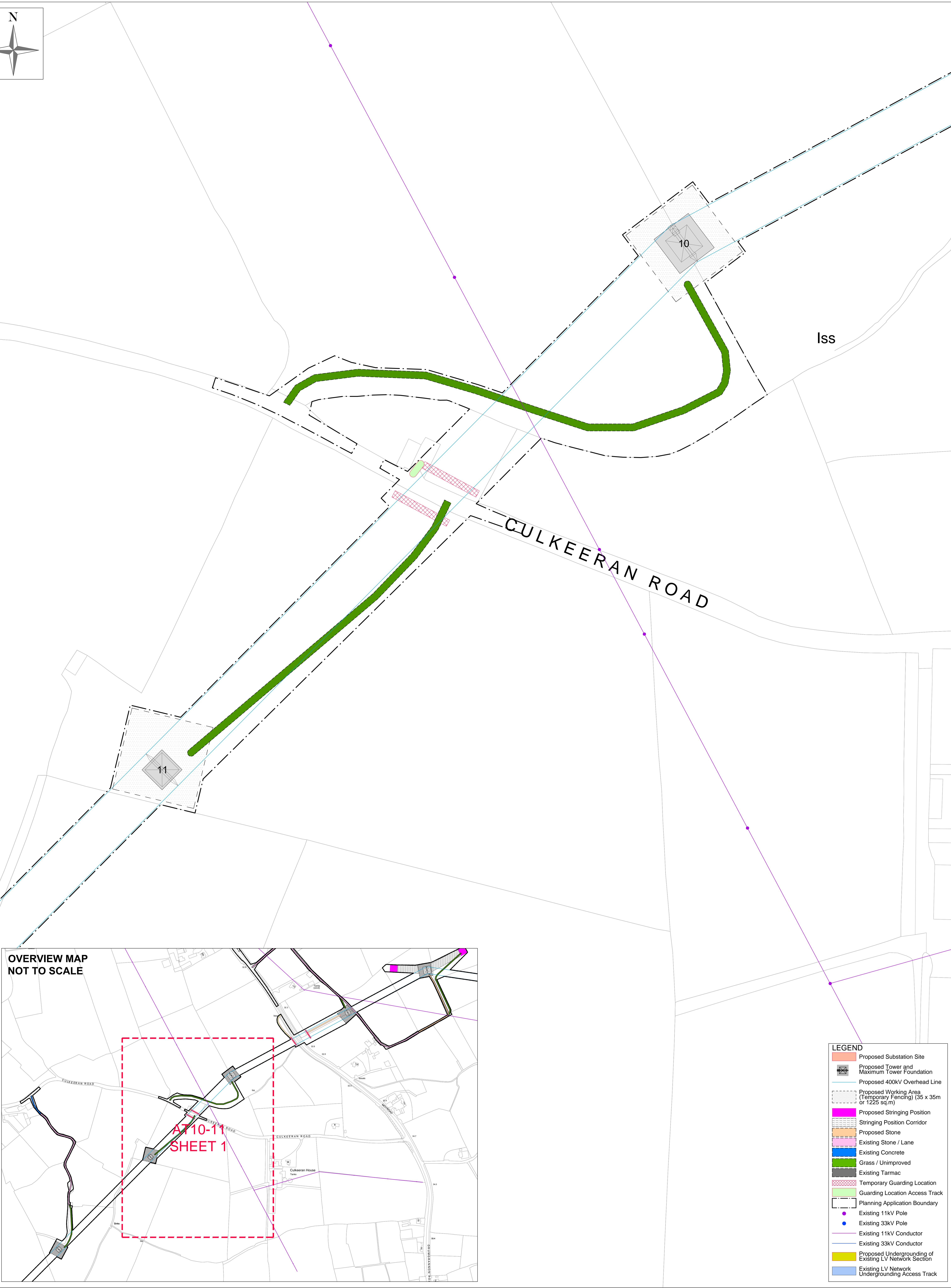

LEGEND	
	Proposed Substation Site
	Proposed Tower and Maximum Tower Foundation
	Proposed 400kV Overhead Line
	Proposed Working Area (Temporary Fencing) (35 x 35m or 1225 sq.m)
	Proposed Stringing Position
	Stringing Position Corridor
	Proposed Stone
	Existing Stone / Lane
	Existing Concrete
	Grass / Unimproved
	Existing Tarmac
	Temporary Guarding Location
	Guarding Location Access Track
	Planning Application Boundary
	Existing 11kV Pole
	Existing 33kV Pole
	Existing 11kV Conductor
	Existing 33kV Conductor
	Proposed Undergrounding of Existing LV Network Section
	Existing LV Network Undergrounding Access Track

Client: 

Project: TYRONE TO CAVAN INTERCONNECTOR

Title: TYRONE TO CAVAN
400kV INTERCONNECTOR PROJECT

ACCESS TRACK 10-11 AT 1:500 SCALE
SHEET 1 OF 1

Design: MH	Drawn: KR
Checked: NIE	App'd: NIE
Date: 10/04/2013	Scale: 1:500 @ A0
No. 60032220/3528/AT10-11/1	