

Issues

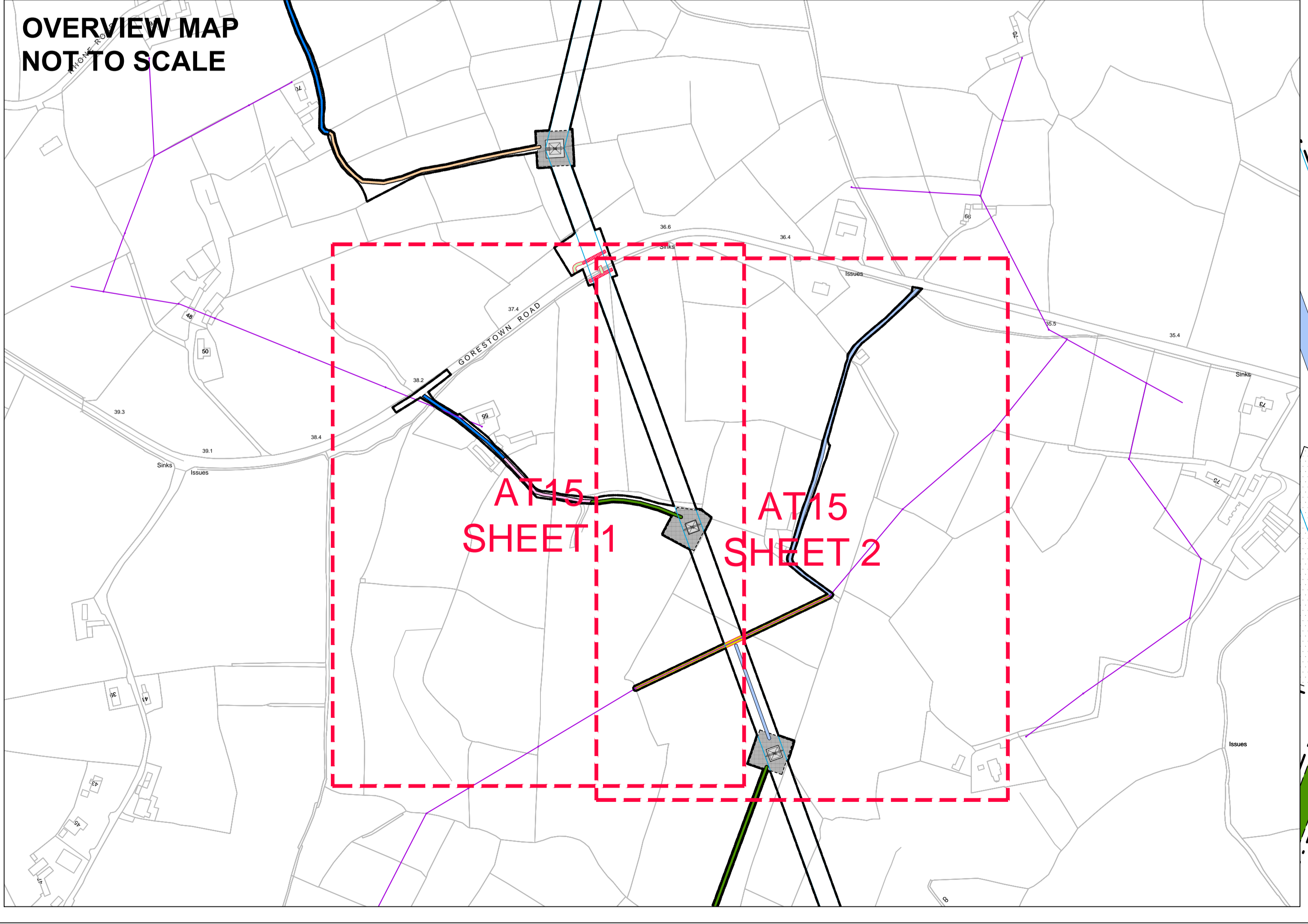
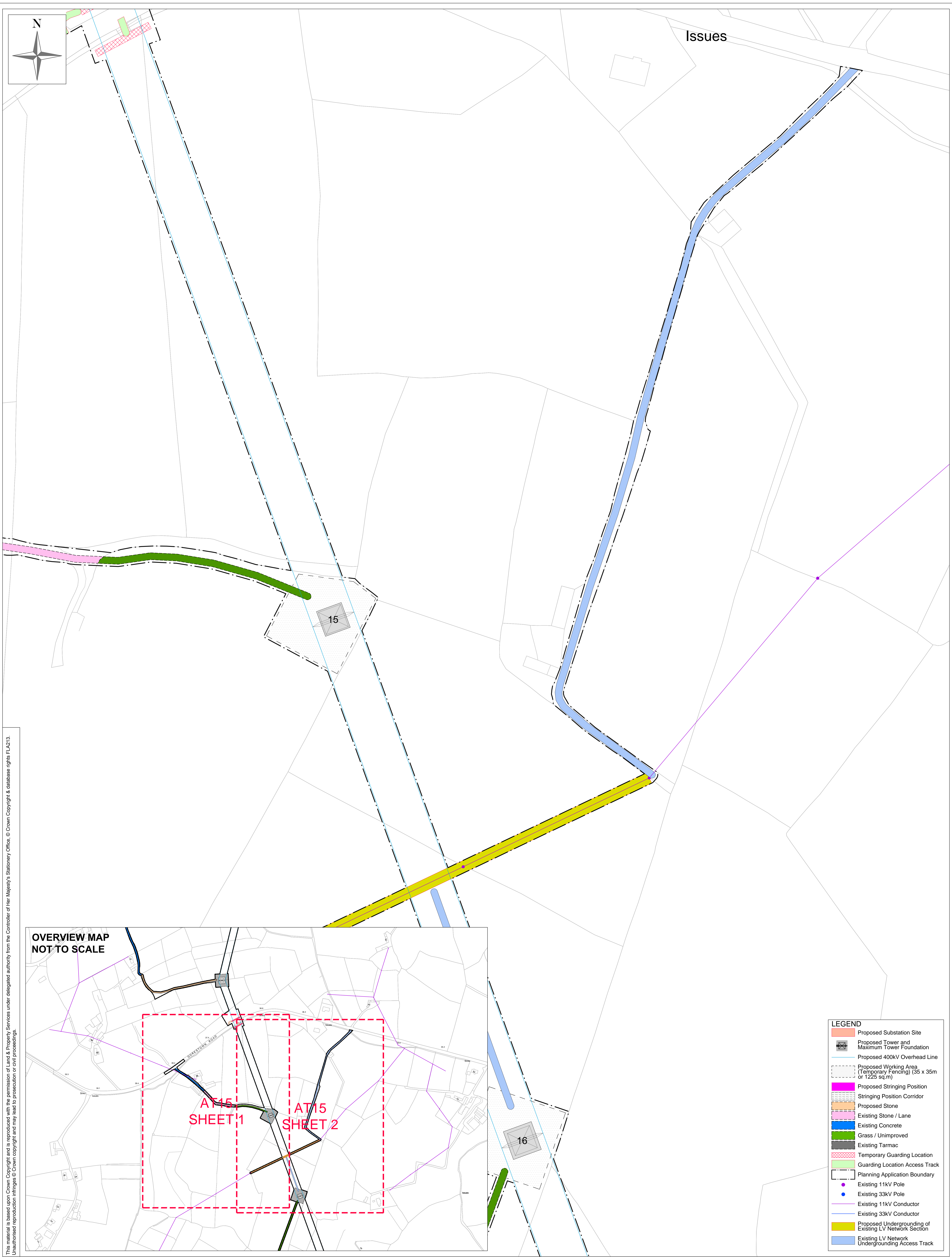

LEGEND

- Proposed Substation Site
- Proposed Tower and Maximum Tower Foundation
- Proposed 400kV Overhead Line
- Proposed Working Area (Temporary Fencing) (35 x 35m or 1225 sq.m)
- Proposed Stringing Position
- Stringing Position Corridor
- Proposed Stone
- Existing Stone / Lane
- Existing Concrete
- Grass / Unimproved
- Existing Tarmac
- Temporary Guarding Location
- Guarding Location Access Track
- Planning Application Boundary
- Existing 11kV Pole
- Existing 33kV Pole
- Existing 11kV Conductor
- Existing 33kV Conductor
- Proposed Undergrounding of Existing LV Network Section
- Existing LV Network
- Undergrounding Access Track

This material is based upon Crown Copyright and is reproduced with the permission of Land & Property Services under delegated authority from the Controller of Her Majesty's Stationery Office. © Crown Copyright & database rights FLA213. Unauthorised reproduction infringes © Crown copyright and may lead to prosecution or civil proceedings.

Client: 

Project: TYRONE TO CAVAN INTERCONNECTOR

Title: TYRONE TO CAVAN
400kV INTERCONNECTOR PROJECT

ACCESS TRACK 15 AT 1:500 SCALE
SHEET 2 OF 2

Design: MH	Drawn: KR
Checked: NIE	App'd: NIE
Date: 10/04/2013	Scale: 1:500 @ A0
No. 60032220/3528/AT15/2	