

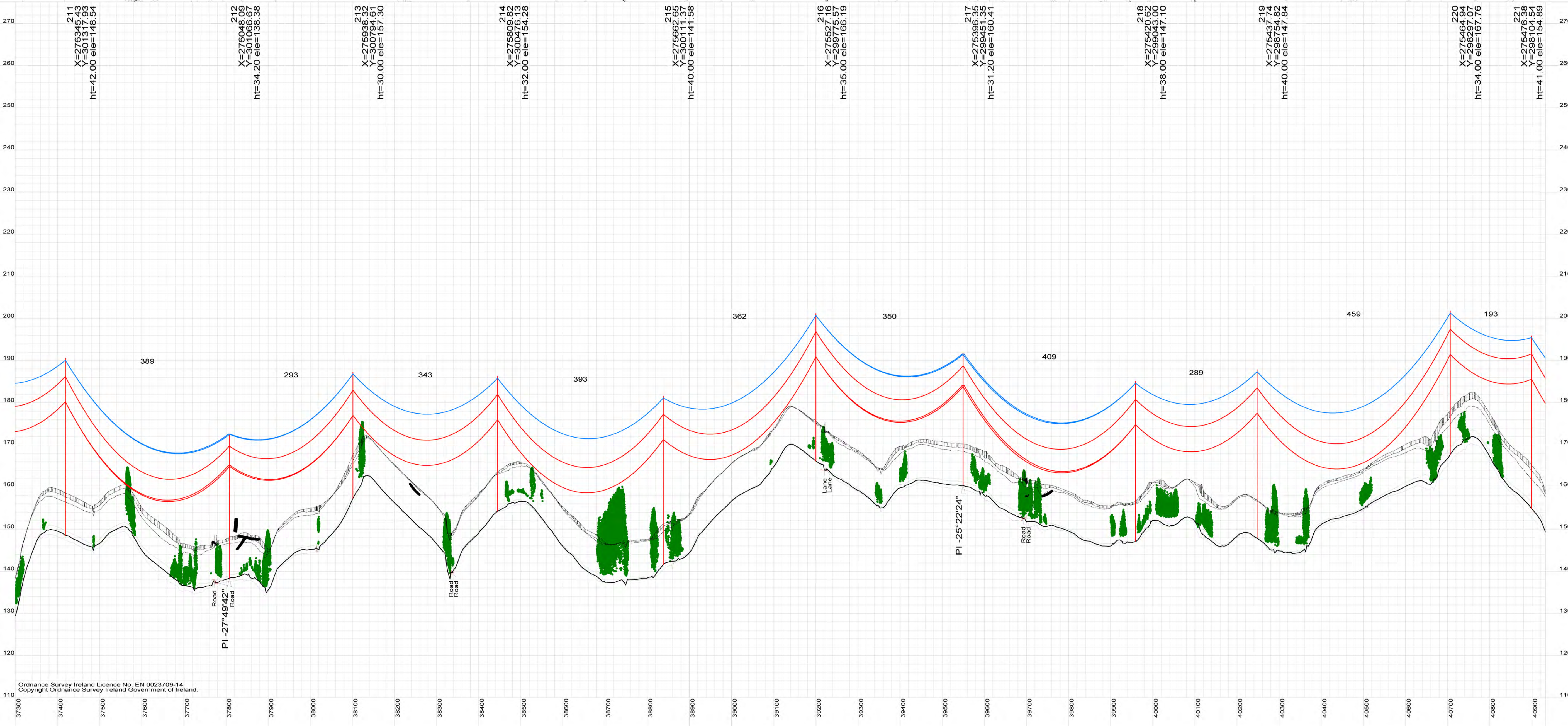

50.0 m Horiz. Scale
5.0 m Vert. Scale

LiDAR data
flown in October 2013
(80m)



Drawing Key

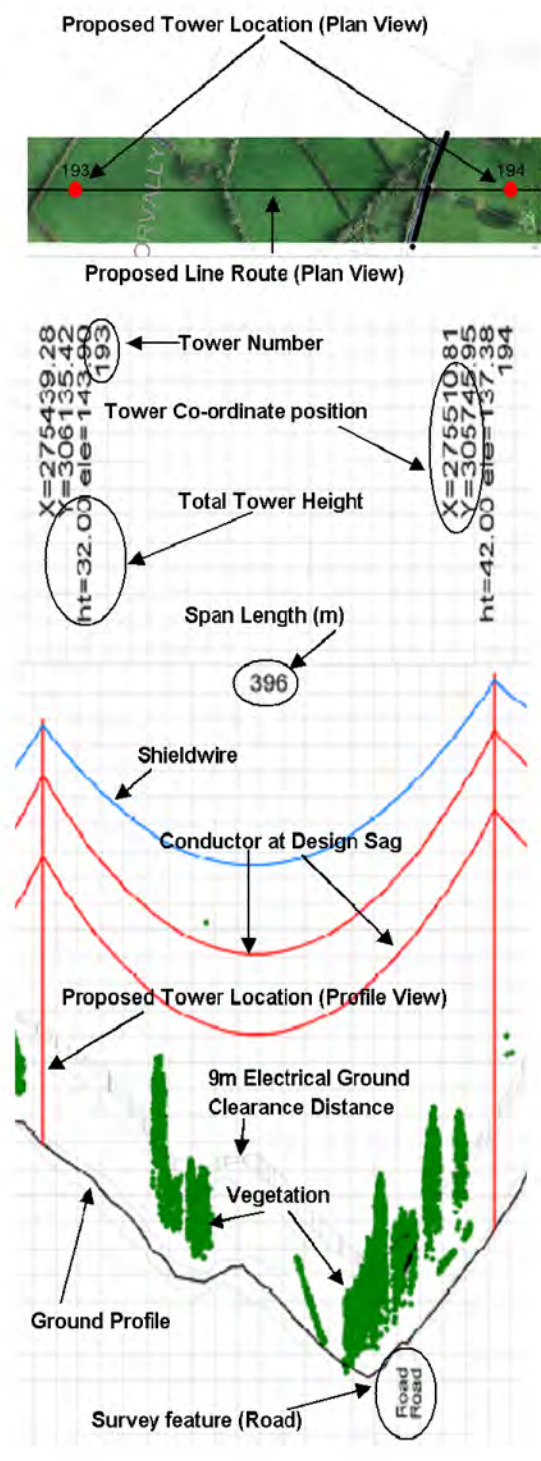

Notes:
Figured Dimensions only to be taken from this drawing.
All levels relate to Ordnance Survey Datum at Malin Head

DRAFT

COPYRIGHT © INTERNATIONAL LIMITED
All rights reserved. No part of this work may be modified or reproduced or copied in any form or by means - graphic, electronic or mechanical, including photocopying, recording, taping or information and retrieval system, or used for any purpose other than its designated purpose, without the written permission of ESB International limited.

ESB INTERNATIONAL
ESB International
18/21 Stephen Court, St Stephen's Green, Dublin 2
Tel: 353 1 703 8000 Email: marketing@esbi.ie Web: www.esbi.ie
ESB International is a trading name of ESBI Engineering & Facility Management Ltd
Registered Office as above Registered in Ireland No. 155249

PURPOSE OF ISSUE:
Preliminary unless indicated

For Information Planning
Client Approval Revised
ESB Legal Services Tender
Construction As-Built Drawing

CLIENT:
EirGrid

PROJECT:
North South 400kV Interconnection Development

CLIENT:
Cavan Monaghan Study Area (CMSA) Proposed Line Route Design
Plan & Profile

DRAWN: J.W	PRODUCED: J.W	VERIFIED: K.C	APPROVED: C.M	APP DATE: Jan 14
CLIENT REF: (Planning Drawing Reference) MT - 005-012			No. of Sheets: 12/32	SIZE: A1
DRAWING NUMBER: PE687 - D141 - 132 - 012 - 003			SCALE: V: 1:500 H: 1:5000	SHEET REV