

View 1
Not To
Scale

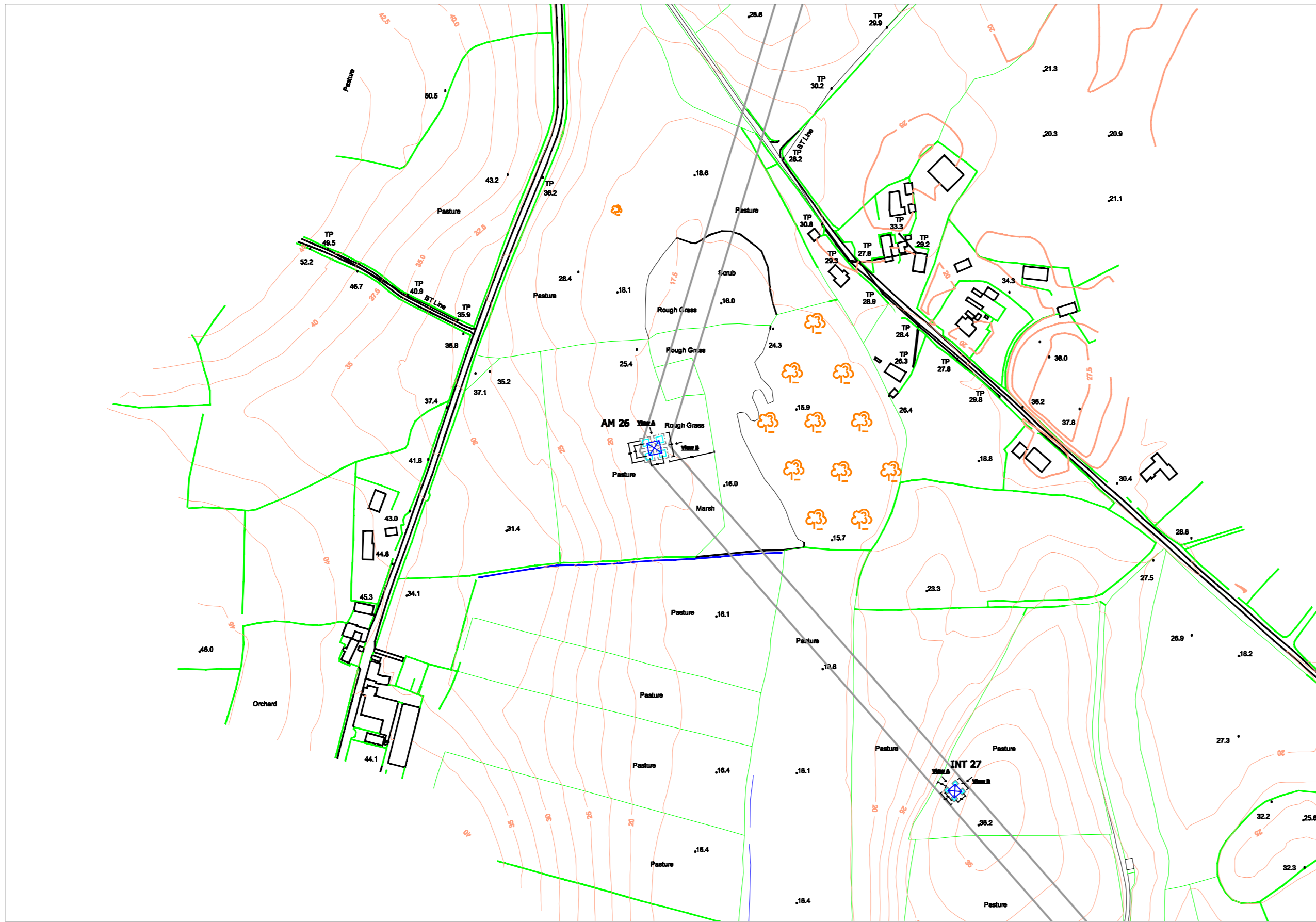

View 2: 1/100

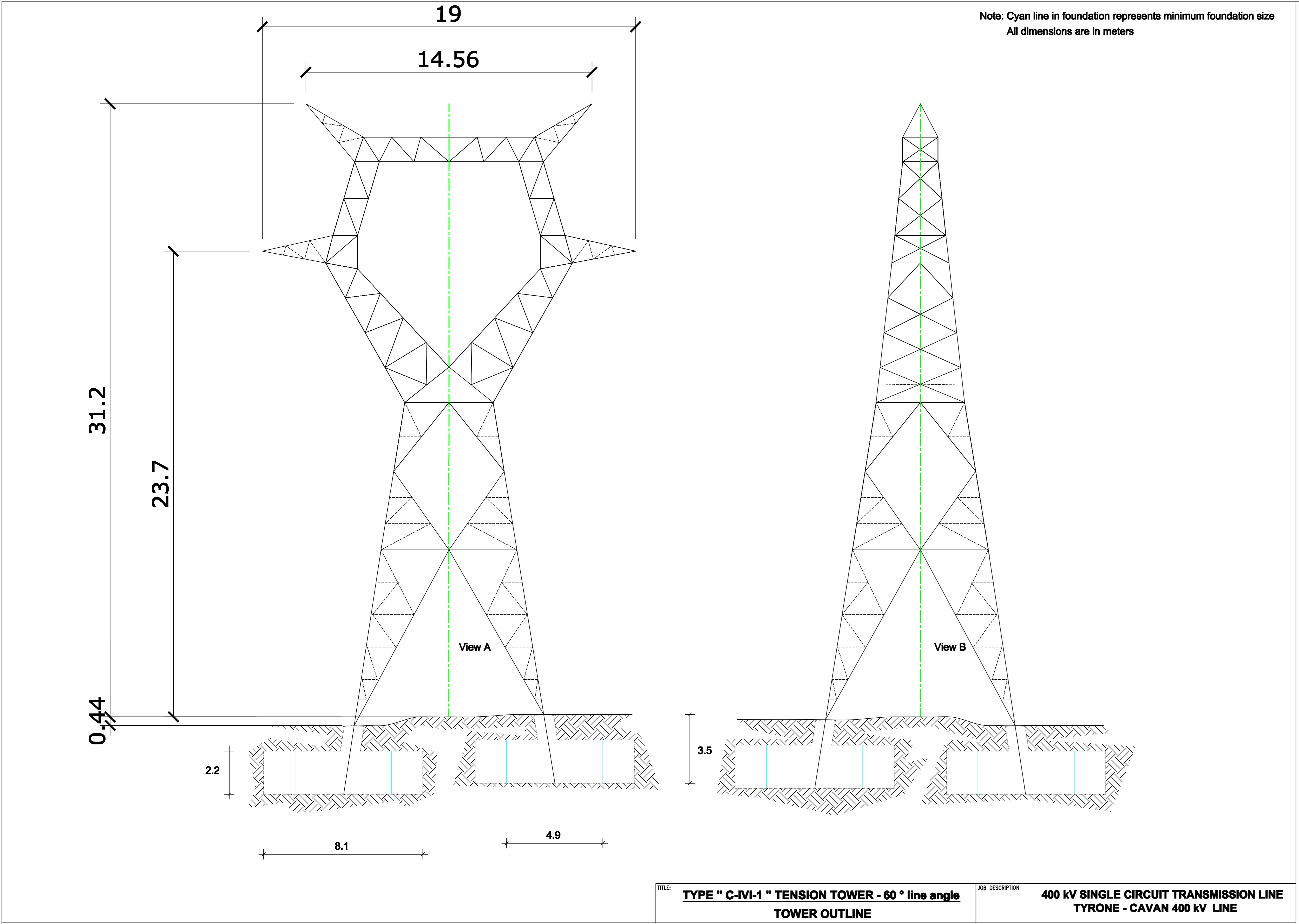

View 3: Not To Scale



View 4: Not To Scale

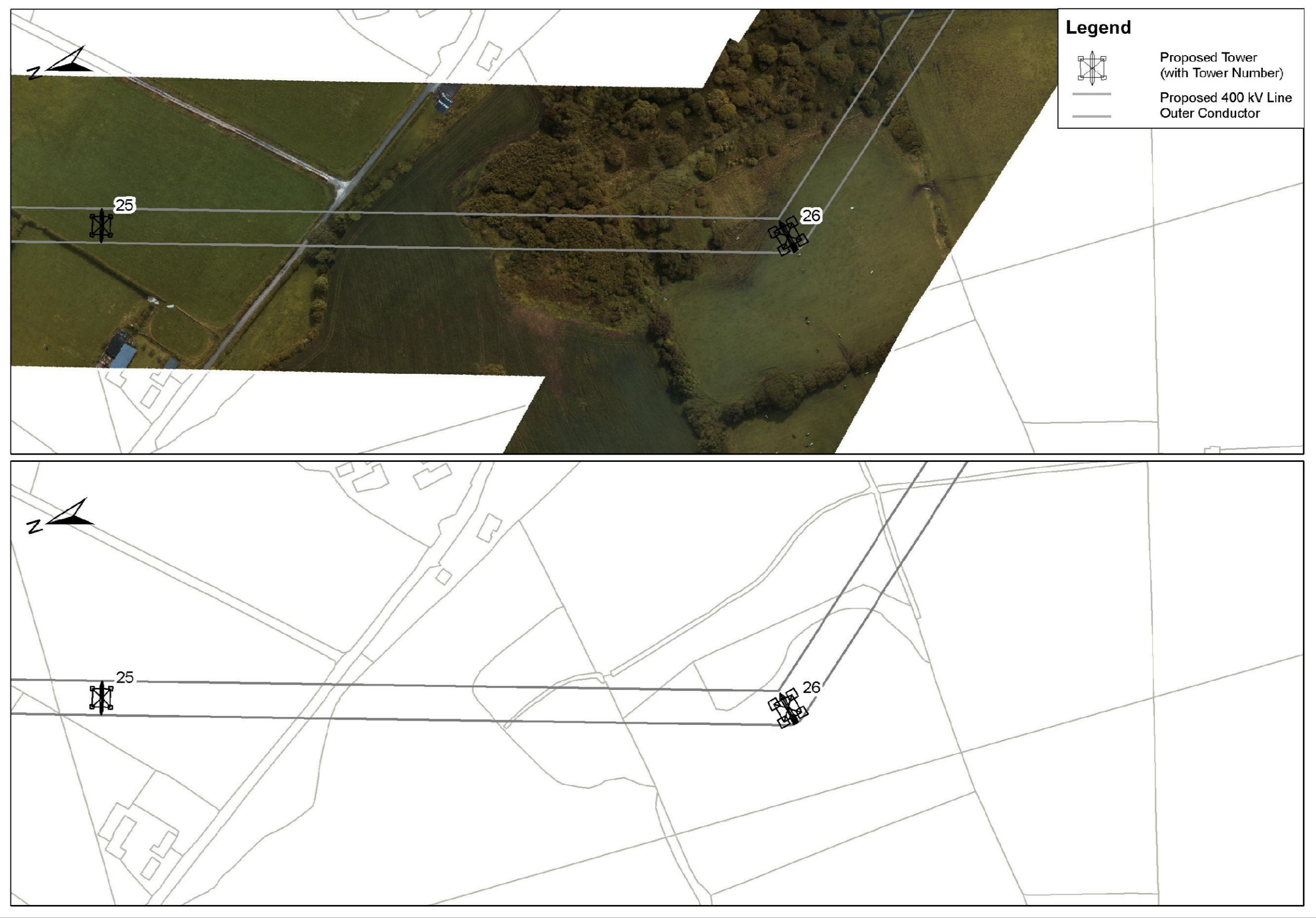

View 5: 1/500

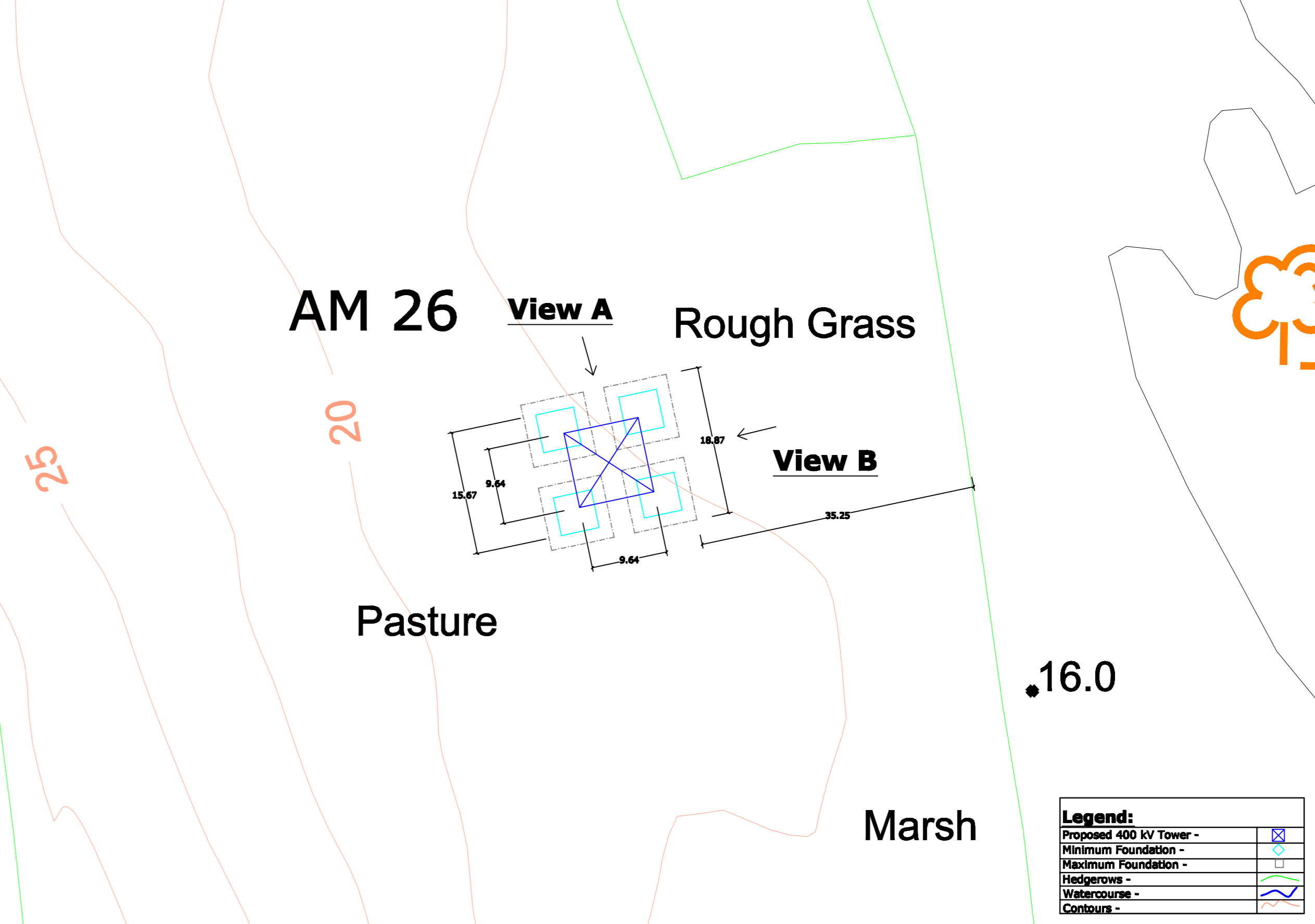

- View 1 - Site Location Map
- View 2 - Tower Drawing
- View 3 - Associated Works Drawing
- View 4 - Overhead Line Route Map
- View 5 - Tower & Foundation Layout

Note:
All foundations and towers are square in plan.

REV.	DATE	ISSUED FOR	AB	AB	AB	AB
PURPOSE OF ISSUE - PRELIMINARY UNLESS INDICATED						
TENDER	APPROVAL	CONSTRUCTION	AS-BUILT	REVISED		
Client: N.I.E.						
Project: Tyrone - Cavan 400 kV Interconnector						
Contract:						
Drawing Title: Proposed 400 kV Line Structure Location No 26 Composite Drawing						
Production Unit: High Voltage						
ES&I Engineering Solutions, Stephen Court, 16-21 St. Stephens Green, Dublin 2, Ireland. Tel: +353 (0)1 708 8000 Fax: +353 (0)1 708 7198 Email: marketing@es-i.ie Web: www.es-i.ie						
ES&I Engineering Solutions is a trading name of ES&I Engineering & Facility Management Limited. Registered Office as above. Registered in Ireland No. 112554						
DRWN	PROJ	CM	JO	APPROV	APPROV	
JW	JW	CM	JO	JO	April 2013	
CLINT REP	REV	102	AD	AD	As Shown	
DRAWING NUMBER: PE687-D141-093-026-000						