

View 1  
Not To  
Scale

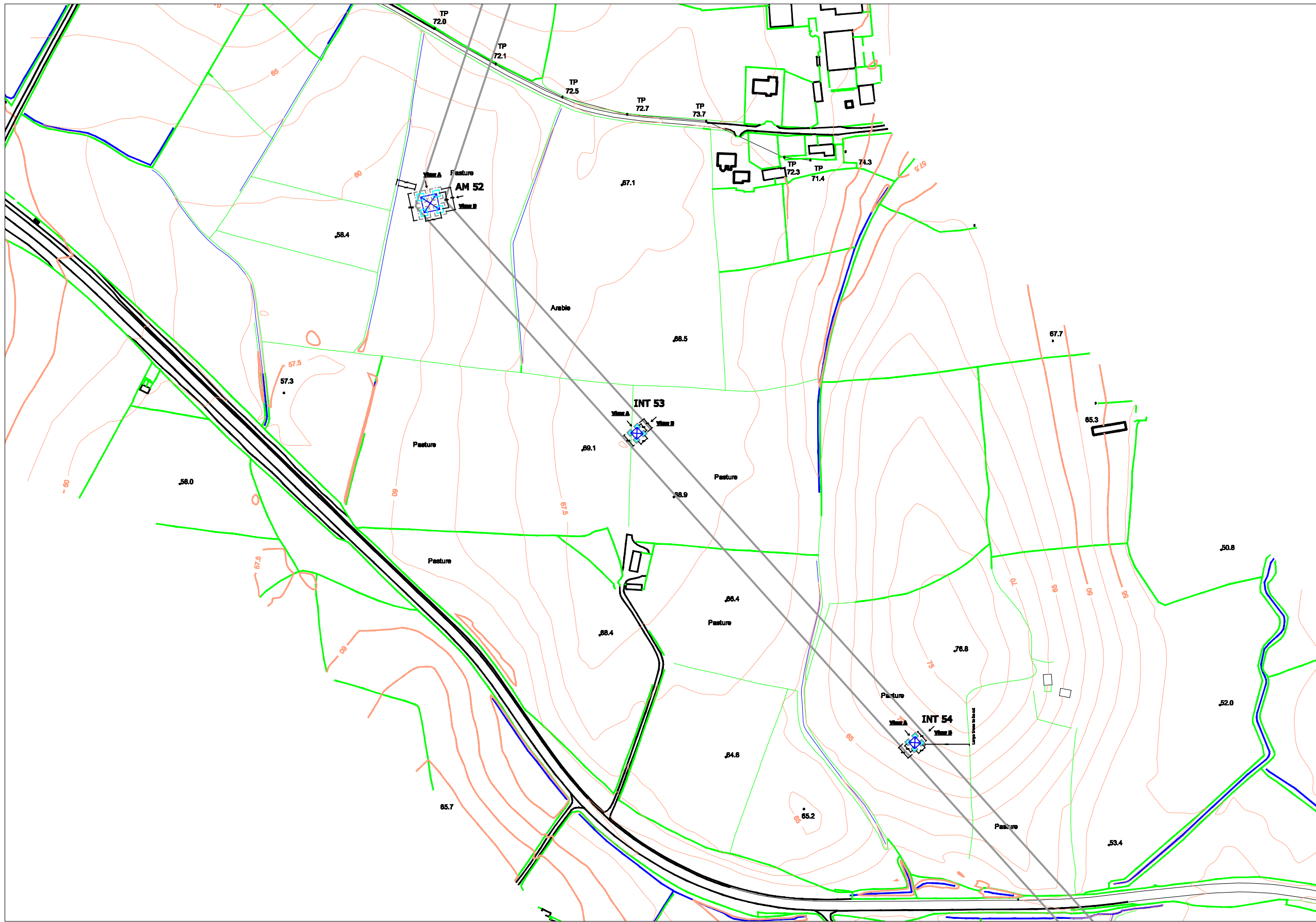

View 2: 1/100

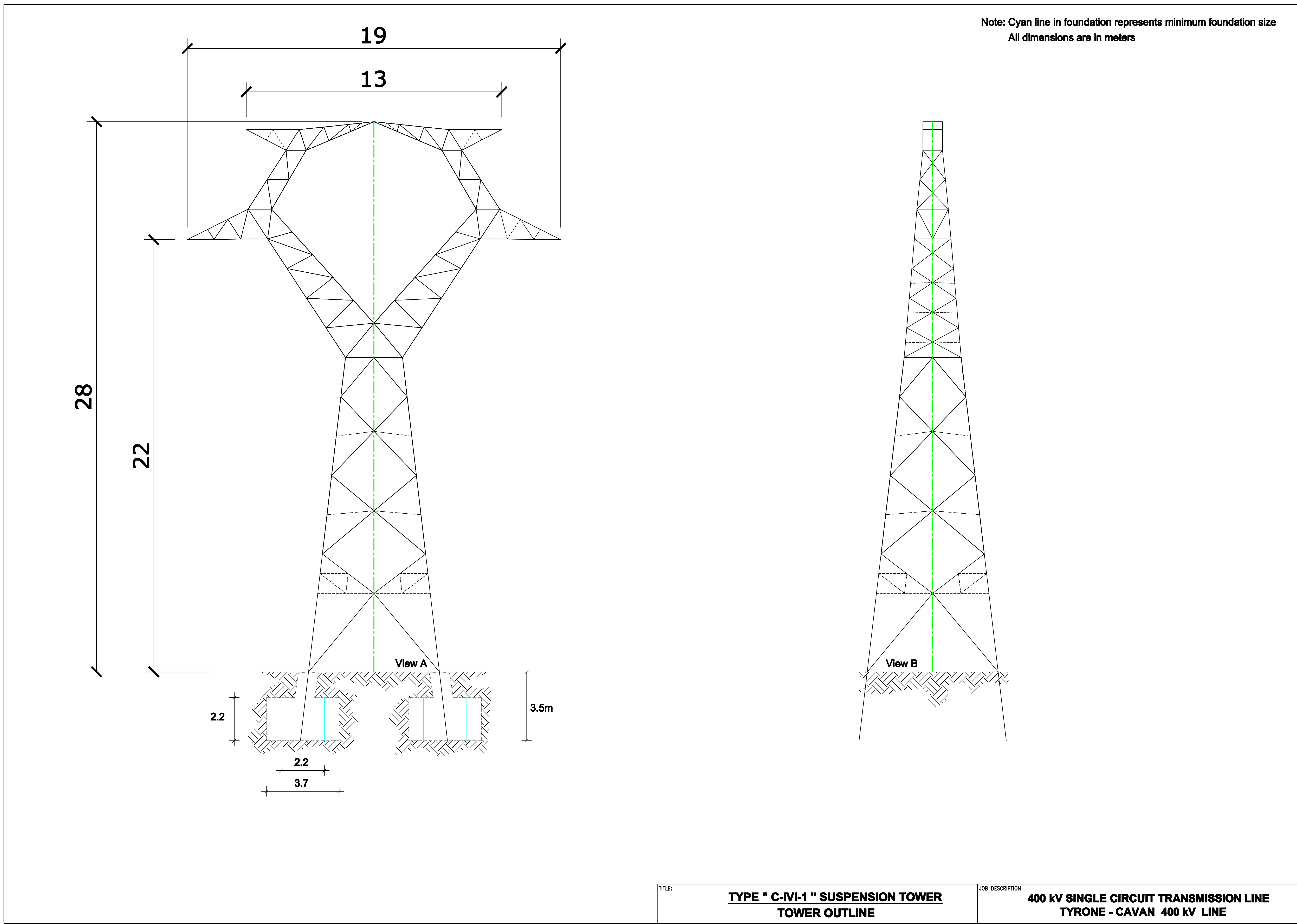

View 3: Not To Scale



View 4: Not To Scale



View 5: 1/500

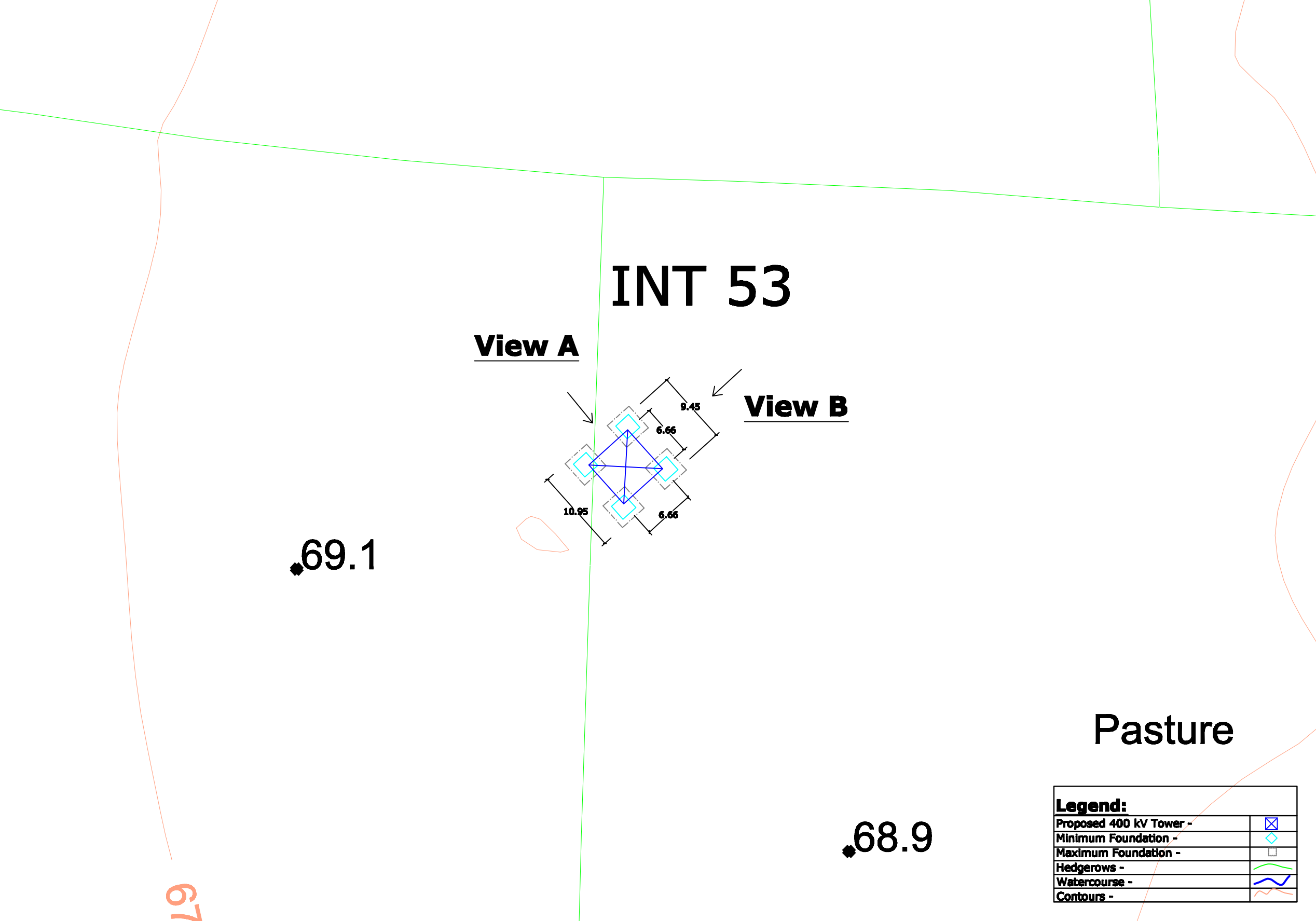

View 1 - Site Location Map  
View 2 - Tower Drawing  
View 3 - Associated Works Drawing  
View 4 - Overhead Line Route Map  
View 5 - Tower & Foundation Layout

**Note:**  
All foundations and towers are square in plan.

REV.	DATE	ISSUED FOR	AS	AB	AS	AS	AS
0	00.00.00	ISSUED FOR					
PURPOSE OF ISSUE - PRELIMINARY UNLESS INDICATED							
TENDER <input type="checkbox"/> CLIENT <input type="checkbox"/> APPROVAL <input type="checkbox"/> CONSTRUCTION <input type="checkbox"/> AS-BUILT <input type="checkbox"/> REVISED <input type="checkbox"/>							
Client: N.I.E.							
Project: Tyrone - Cavan 400 kV Interconnector							
Contract:							
Drawing Title: Proposed 400 kV Line Structure Location No 53 Composite Drawing							
Production Unit: High Voltage							
<b>ESP International</b> ESP Energy Innovation							
ESP Engineering Solutions, Stephen Court, 16-21 St. Stephens Green, Dublin 2, Ireland. Tel: +353 (0)1 700 8000 Fax: +353 (0)1 700 7198 Email: marketing@esp.ie Web: www.esp.ie ESP Engineering Solutions is a trading name of ESP Engineering & Facility Management Limited. Registered Office as above. Registered in Ireland No. 102546							
OWNER	PROJECT	DESIGN	APPROVED	DATE			
JW	JW	CM	JD	April 2013			
CHECKED	REVISED	DATE	BY	DATE			
102	AD	102	AD	As Shown			
DRAWING NUMBER					REVISED		
PE687-D141-093-053-000							