

Our Case Number: ABP-317660-23

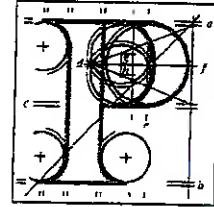

An
Bord
Pleanála

Liam Smyth
Kimmage Grove
Kimmage
Dublin 6W
D6W H299

Date: 06 September 2023

Re: Busconnects Kimmage to city centre core bus corridor scheme
Kimmage, Dublin

Dear Sir / Madam,

An Bord Pleanála has received your recent submission in relation to the above-mentioned proposed road development and will take it into consideration in its determination of the matter. Please accept this letter as a receipt for the fee of €50 that you have paid.

Please note that the proposed road development shall not be carried out unless the Board has approved it or approved it with modifications.

The Board has also received an application for confirmation of a compulsory purchase order which relates to this proposed road development. The Board has absolute discretion to hold an oral hearing in respect of any application before it, in accordance with section 218 of the Planning and Development Act 2000, as amended. Accordingly, the Board will inform you in due course on this matter. The Board shall also make a decision on both applications at the same time.

If you have any queries in relation to this matter please contact the undersigned officer of the Board at laps@pleanala.ie

Please quote the above-mentioned An Bord Pleanála reference number in any correspondence or telephone contact with the Board.

Yours faithfully,

Eimear Reilly
Executive Officer
Direct Line: 01-8737184

HA02A

Tel	Tel	(01) 858 8100
Glaó Áitiúil	LoCall	1800 275 175
Facs	Fax	(01) 872 2684
Láithreán Gréasáin	Website	www.pleanala.ie
Riomhphost	Email	bord@pleanala.ie

64 Sráid Maoilbhríde	84 Marlborough Street
Baile Átha Cliath 1	Dublin 1
D01 V902	D01 V902

L Smyth
Kimmage Grove,
Kimmage,
D6wh299
25th August 2023

KIMMAGE TO CITY CENTRE CORE BUS CORRIDOR SCHEMELANDSCAPING AND URBAN REALM

I am in agreement with proposal subject to observations being addressed

Drawing Reference:

BCIDD-ROT-ENV_LA-0011_ML_00-DR-LL-0003 Sheet 3 of 14 (general note to entire route)

There are existing telephone / light / sign poles which are poorly located which prevent two way traffic due to minimum distance between poles & boundary wall to footpath. It is an particularly an issue when meeting with prams or wheelchairs The concrete foot paths have been shown as yellow indicating no amendment to locations. These poles should be repositioned while the improvement works are underway. Suggest survey carried out to determine locations to full layout (sheet 1 – 14) and correct amend within layouts. See below photo for example



BCIDD-ROT-ENV_LA-0011_ML_00-DR-LL-0004 Sheet 4 of 14 (general note to entire route)

There are existing telephone / light / sign poles which are poorly located which prevent two way walking traffic due to minimum distance between poles & boundary wall to the footpath. The concrete foot paths have been shown as yellow indicating no amendment to locations. This poles should be repositioned while the works are underway. These poles should be repositioned while the

improvement works are underway. Suggest survey carried out to determine locations to full layout (sheet 1 – 14) and correct amend within layouts. See below photo for example.

BCIDD-ROT-ENV_LA-0011_ML_00-DR-LL-0005 Sheet 4 of 14 (general note to entire route)

There are existing telephone / light / sign poles which are poorly located which prevent two way walking traffic due to minimum distance between poles & boundary wall to the footpath. Suggest survey carried out to determine locations to full layout (sheet 1 – 14) and correct amend within layouts.



BCIDD-ROT-ENV_LA-0011_ML_00-DR-LL-0001- 14 Sheet 1 of 14 (general note to entire route)

More ambitious provisions of new trees should be provided while works are underway to promote sustainability. Existing trees outside boundary line of works have been included which suggest more trees are being installed than it appears until legend is read. Works outside red line is not relevant and they should be not be included on the application as it appears to overstates trees actually being provided.

There has been already lost opportunities to provide more tress on Sundrive Rd & Parnell Road footpaths / pedestrian crossing improvements where mass concrete has been provided where there was an opportunity to increase tree provisions within the city.

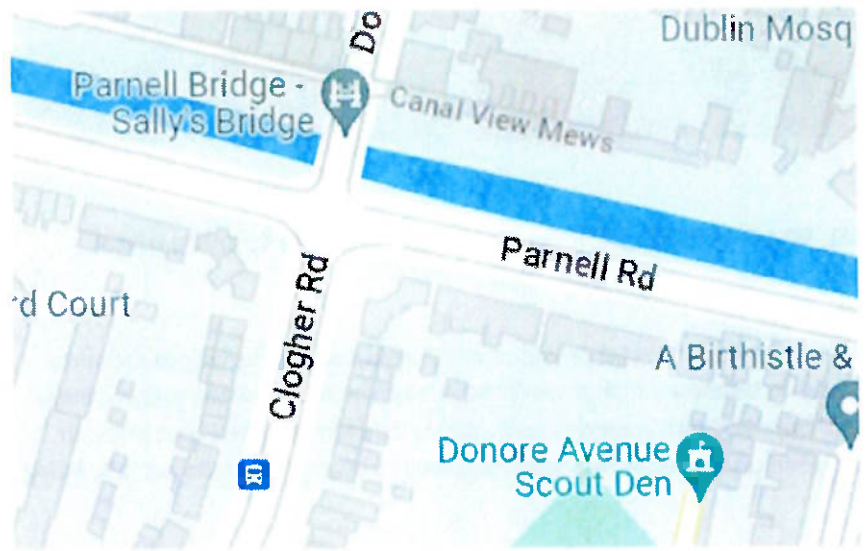
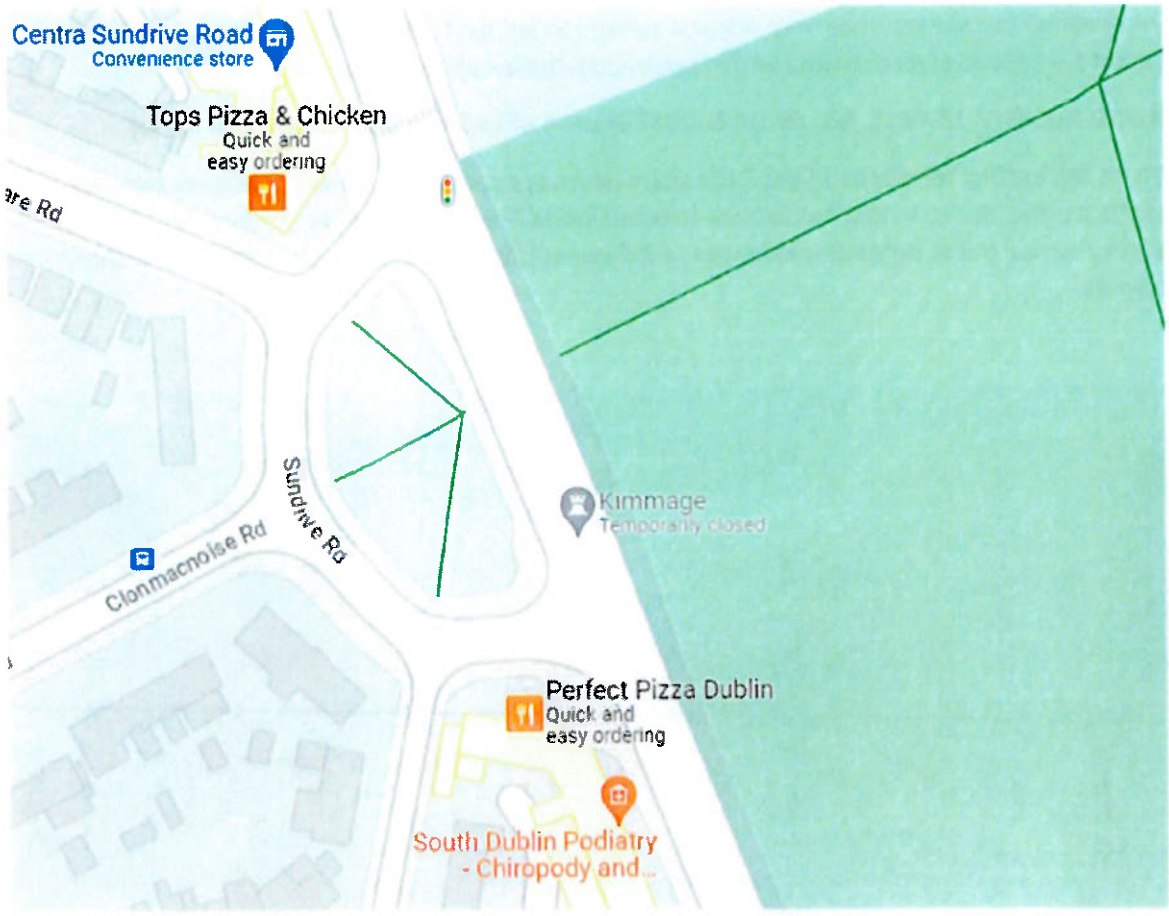

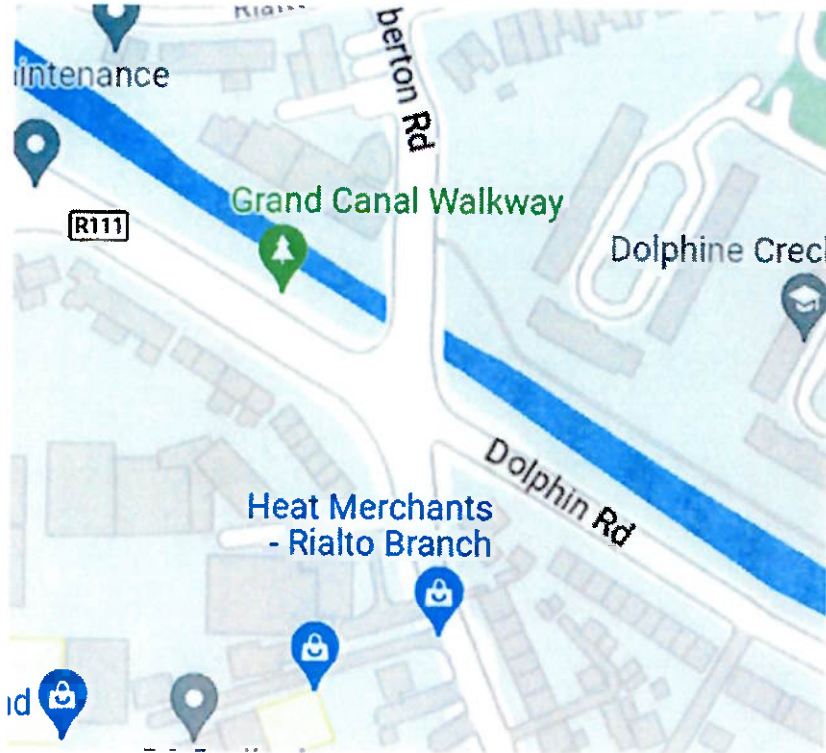

BCIDD-ROT-ENV_LA-0011_ML_00-DR-LL-0003 Sheet 3 of 4

There are less tree provisions being provided to Lower Kimmage Road / Sundrive Rd road junction than was shown in the preferred route PDF issued previously. Suggest increasing.

<https://busconnects.ie/wp-content/uploads/2022/03/11-kimmage-to-cc-preferred-route-19220-fa-web.pdf>

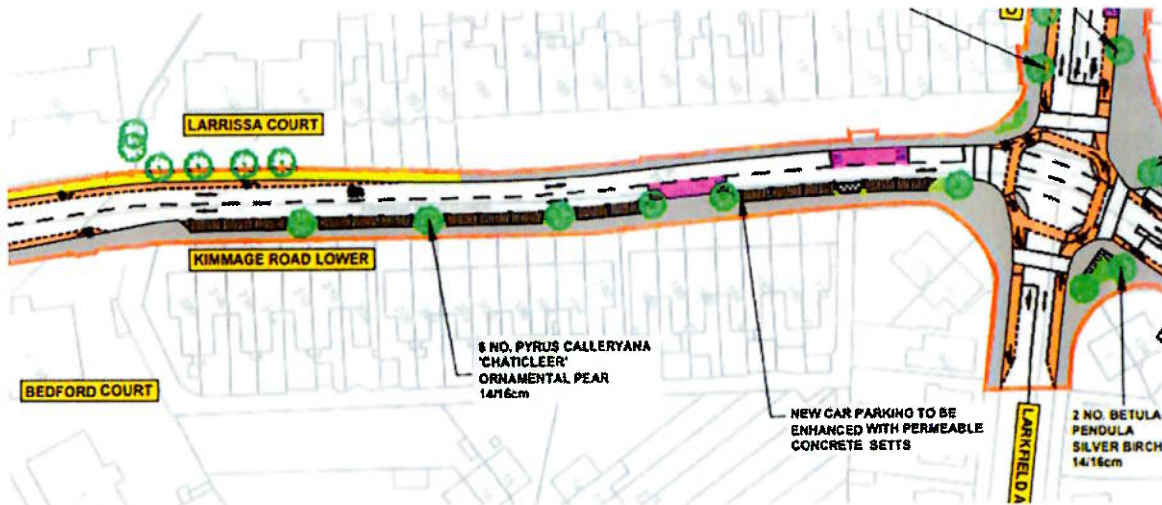

BCIDD-ROT-ENV_LA-0011_ML_00-DR-LL-0003 03 Sheet 3 of 14

There is an opportunity to provide high quality amenity space to Sundrive Road / Lower Kimmage junction and surround. Granite / stone paving should be used to promote foot traffic / community . sustainability and more ambitious public landscaping / street furniture should be provided.

BCIDD-ROT-ENV_LA-0011_ML_00-DR-LL-0006 Sheet 6 of 14

As above, granite paving and more ambitious public landscaping / street furniture should be provided.